

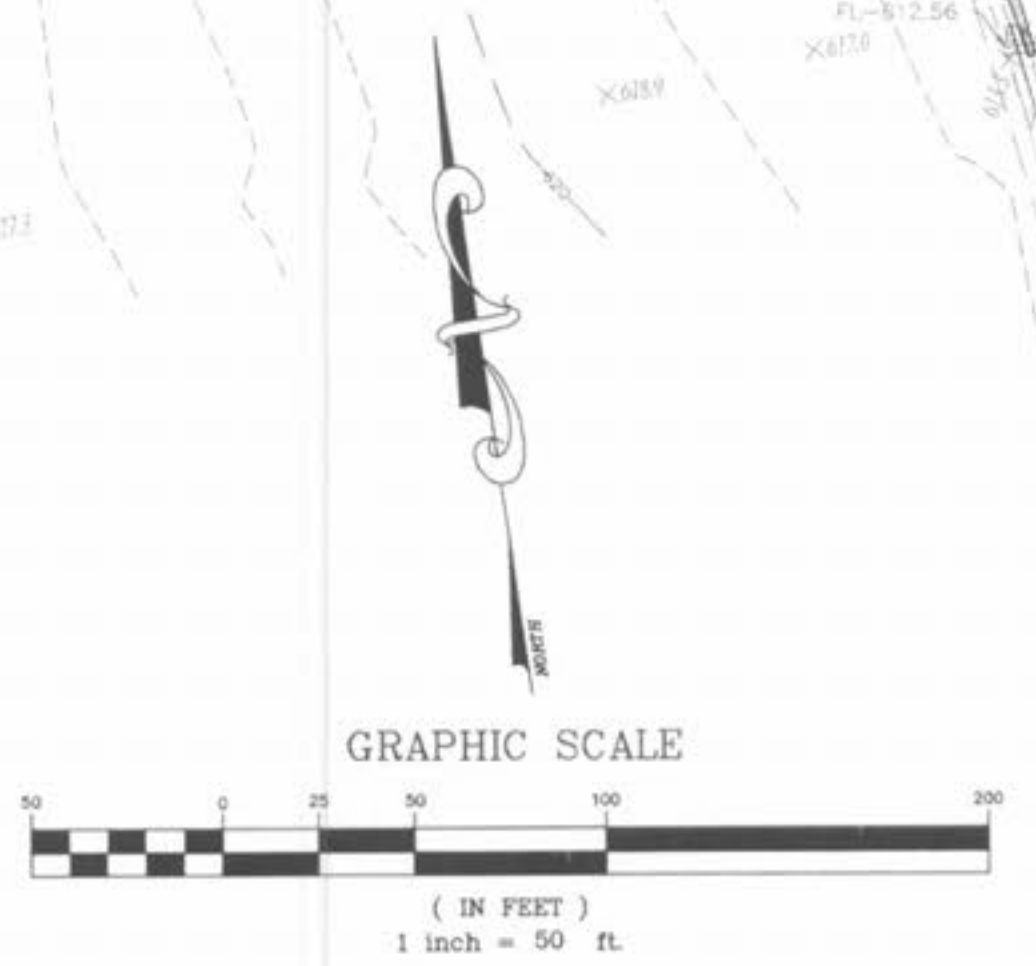

MATCHLINE SHEET 2.2

NOTE:
ALL AREA INLETS ARE TO
BE OPENED ON ALL SIDES
UNLESS NOTED OTHERWISE.



ISSUE	REMARKS/DATE
10	CITY COMMENTS/02-03-06
11	CITY COMMENTS/02-15-06
12	DCSD COMMENTS/09-28-05
13	DCSD COMMENTS/10-13-05
14	DCSD AND CITY COMMENTS/11-14-05
15	CITY COMMENTS/11-22-05
16	CITY COMMENTS/12-09-05
17	WATER DISTRICT #2 COMMENTS/01-17-06
18	DEVELOPER REVISIONS/01-24-06

PREPARED FOR:
CMB RHODES, L.L.C.
5091 New Baumgartner Road
St. Louis, Missouri 63129
(314) 487-6717

PREPARED BY:
THE STERLING CO.
ENGINEERS & SURVEYORS
5095 NEW BAUMGARTNER ROAD
ST. LOUIS, MISSOURI 63129
(314) 487-6440 or 487-6449
E-Mail: Sterling@sterling-eng-survey.com

PROJECT:	COUNTRYSHIRE		
DRAWN:	L.G.	DESIGNED:	J.C.M.
CHECKED:	97	CHECKED:	97
SHEET TITLE:	GRADING PLAN		
NO.	02	12	311
M.S.D.			SHEET
P#			2.1
OF			