

Drawing name: K:\0212311 RHODES TRACT\DWG\IMPROVEMENTS\2311Street.dwg Plotted on: Feb 20, 2006 12:45pm Plotted by: Igreen

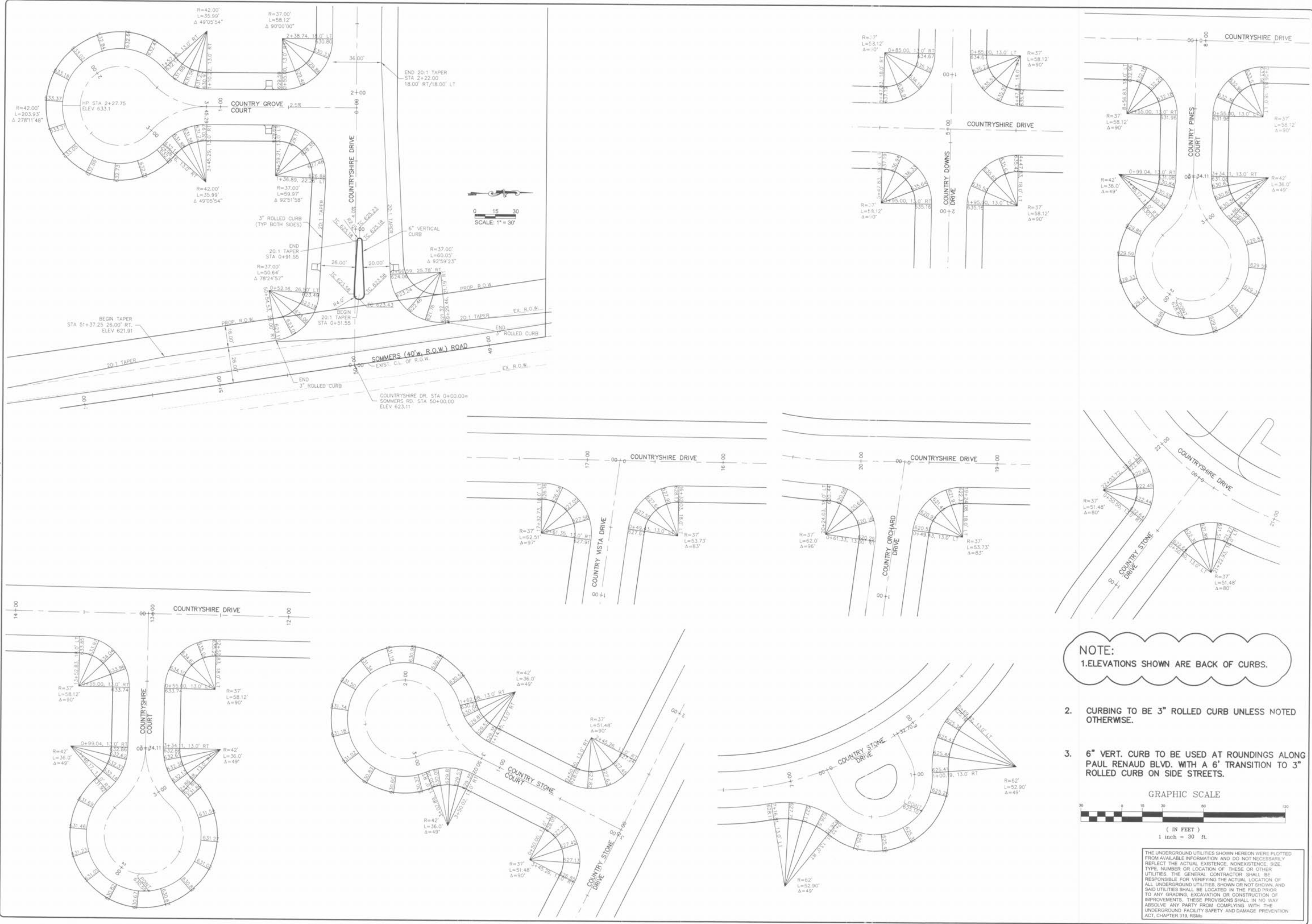

NOTE:
1. ELEVATIONS SHOWN ARE BACK OF CURBS.

- 2. CURBING TO BE 3" ROLLED CURB UNLESS NOTED OTHERWISE.
- 3. 6" VERT. CURB TO BE USED AT ROUNDINGS ALONG PAUL RENAUD BLVD. WITH A 6' TRANSITION TO 3" ROLLED CURB ON SIDE STREETS.

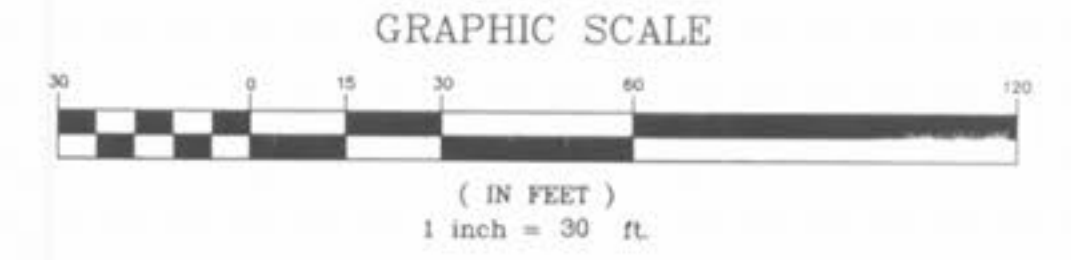

THE UNDERGROUND UTILITIES SHOWN HEREON WERE PLOTTED FROM AVAILABLE INFORMATION AND DO NOT NECESSARILY REFLECT THE ACTUAL EXISTENCE, NONEXISTENCE, SIZE, TYPE, NUMBER OR LOCATION OF THESE OR OTHER UTILITIES. THE GENERAL CONTRACTOR SHALL BE RESPONSIBLE FOR VERIFYING THE ACTUAL LOCATION OF ALL UNDERGROUND UTILITIES, SHOWN OR NOT SHOWN, AND SAID UTILITIES SHALL BE LOCATED IN THE FIELD PRIOR TO ANY GRADING, EXCAVATION OR CONSTRUCTION OF IMPROVEMENTS. THESE PROVISIONS SHALL IN NO WAY ABSOLVE ANY PARTY FROM COMPLYING WITH THE UNDERGROUND FACILITY SAFETY AND DAMAGE PREVENTION ACT, CHAPTER 319, RSMo.

ISSUE	REMARKS/DATE
10	CITY COMMENTS 02-09-06
11	CITY COMMENTS 02-15-06
3	DCSD COMMENTS 09-28-05
4	DCSD COMMENTS 10-13-05
5	DCSD AND CITY COMMENTS 11-14-05
6	CITY COMMENTS 11-22-05
7	CITY COMMENTS 12-30-05
8	WATER DISTRICT #2 COMMENTS 01-17-06
9	DEVELOPER REVISIONS 01-24-06

PREPARED FOR:
CMB RHODES, L.L.C.
 5091 NEW BAUMGARTNER ROAD
 ST. LOUIS, MISSOURI 63129
 (314) 487-6717

ENGINEER:
STERLING CO.
 ENGINEERS & SURVEYORS
 5055 NEW BAUMGARTNER ROAD
 ST. LOUIS, MISSOURI 63129
 (314) 487-0440 FAX 487-8844
 E-Mail: Sterling@sterling-eng-srv.com

PROJECT:	COUNTRYSHIRE
DRAWN:	LG
DESIGNED:	JCM
CHECKED:	JM
SHEET TITLE:	WARPIING
NO:	02 12 311
M.S.D.:	SHEET
P#:	13.1
DIGITAL FILE LOCATION:	OF

BASE MAP