

Drawing name: K:\0212311 RHODES TRACT\dwg IMPROVEMENTS\2311Street.dwg Plotted on: Dec 04, 2006 - 7:22am Plotted by: jernold

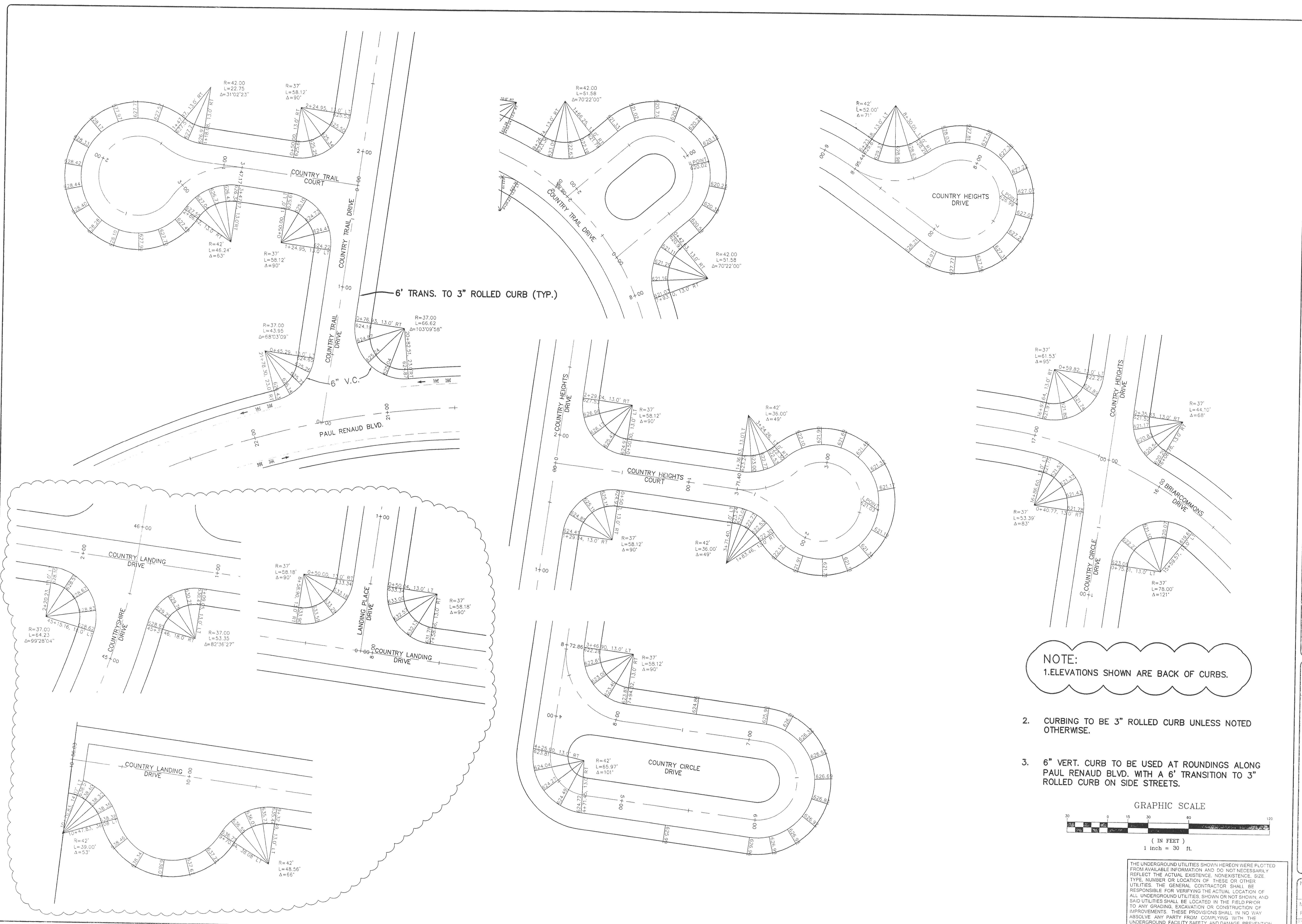

6" TRANS. TO 3" ROLLED CURB (TYP.)

6" V.C.

NOTE:
1. ELEVATIONS SHOWN ARE BACK OF CURBS.

- CURBING TO BE 3" ROLLED CURB UNLESS NOTED OTHERWISE.
- 6" VERT. CURB TO BE USED AT ROUNDINGS ALONG PAUL RENAUD BLVD. WITH A 6' TRANSITION TO 3" ROLLED CURB ON SIDE STREETS.

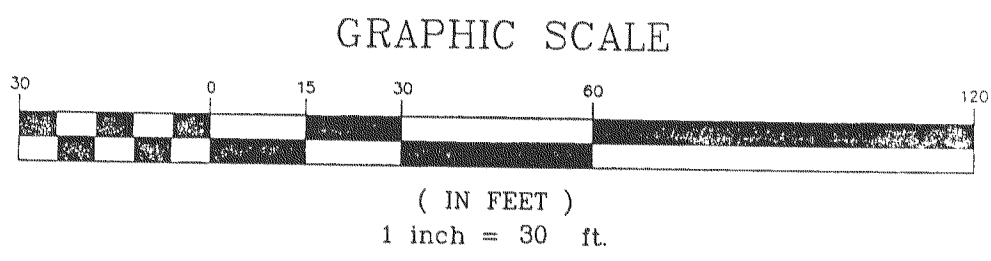

THE UNDERGROUND UTILITIES SHOWN HEREON WERE PLOTTED FROM AVAILABLE INFORMATION AND DO NOT NECESSARILY REFLECT THE ACTUAL EXISTENCE, NONEXISTENCE, SIZE, TYPE, NUMBER OR LOCATION OF THESE OR OTHER UTILITIES. THE GENERAL CONTRACTOR SHALL BE RESPONSIBLE FOR VERIFYING THE ACTUAL LOCATION OF ALL UNDERGROUND UTILITIES SHOWN OR NOT SHOWN, AND SAID UTILITIES SHALL BE LOCATED IN THE FIELD PRIOR TO ANY GRADING, EXCAVATION OR CONSTRUCTION OF IMPROVEMENTS. THESE PROVISIONS SHALL IN NO WAY ABSOLVE ANY PARTY FROM COMPLYING WITH THE UNDERGROUND FACILITY SAFETY AND DAMAGE PREVENTION ACT, CHAPTER 319, RSMo.

ISSUE	REMARKS/DATE
10	CITY COMMENTS 02-03-06
11	CITY COMMENTS 02-15-06
12	DCSD COMMENT 09-29-06
13	REVISED PER DEVELOPMENT COMMENTS 11-06-06
14	12-1-06 REVISED CITY COMMENTS
6	CITY COMMENTS 11-22-05
7	CITY COMMENTS 12-30-05
8	WATER DISTRICT #2 COMMENTS 01-17-06
9	DEVELOPER REVISIONS 01-24-06

PREPARED FOR:

STERLING CO.
ENGINEERS & SURVEYORS
5055 NEW BALMARTINE ROAD
ST. LOUIS, MISSOURI 63124
(314) 487-0440 FAX 487-8944
E-Mail: Sterling@sterling-eng-srv.com

12/4/06

PREPARED BY: *Mullins*

CMB RHODES, L.L.C.
P.O. Box 511038
St. Louis, MO 63151-1038
(314) 487-6717

PROJECT:	COUNTRYSHIRE
DRAWN:	DESIGNED:
CHECKED:	WARPING
SHEET TITLE:	
NO.	02 12 311
M.S.D.	SHEET
DATE:	13.3
OF	