

TYPE	MANUFACTURER & CATALOG NO.	LAMPS
A	SUN VALLEY LIGHTING CTRN-11-250WPS	250W-HP
B	SAYD C-3527-40A	150 PAR/PL
D	SECURITY LIGHTING SYSTEMS REPT-100MH-MT-EX	MOONBURD

- FIXTURE "D" TO BE INSTALLED IN A SEPARATE CONDUIT AND ON A SEPARATE CIRCUIT (LO-12)
- ELECTRICAL PLAN NOTES:
1. LIGHT CIRCUIT TO "LO" PANEL USING CIRCUITS SHOWN. MINIMUM 1" SCH. 40 PVC CONDUIT, MINIMUM #8 AWG CONDUCTORS THROUGHOUT CIRCUIT.
  2. BOTH LIGHT FIXTURES MOUNT ON THE SAME POLE. THEY ARE SHOWN SEPARATELY HERE FOR CIRCUIT CLARIFICATION.
  3. INSTALL HOUSE SIDE SHIELD TO SCREEN LIGHTS FROM ADJACENT PROPERTY.

PROGRESS POINT COURT  
(PRIVATE STREET)

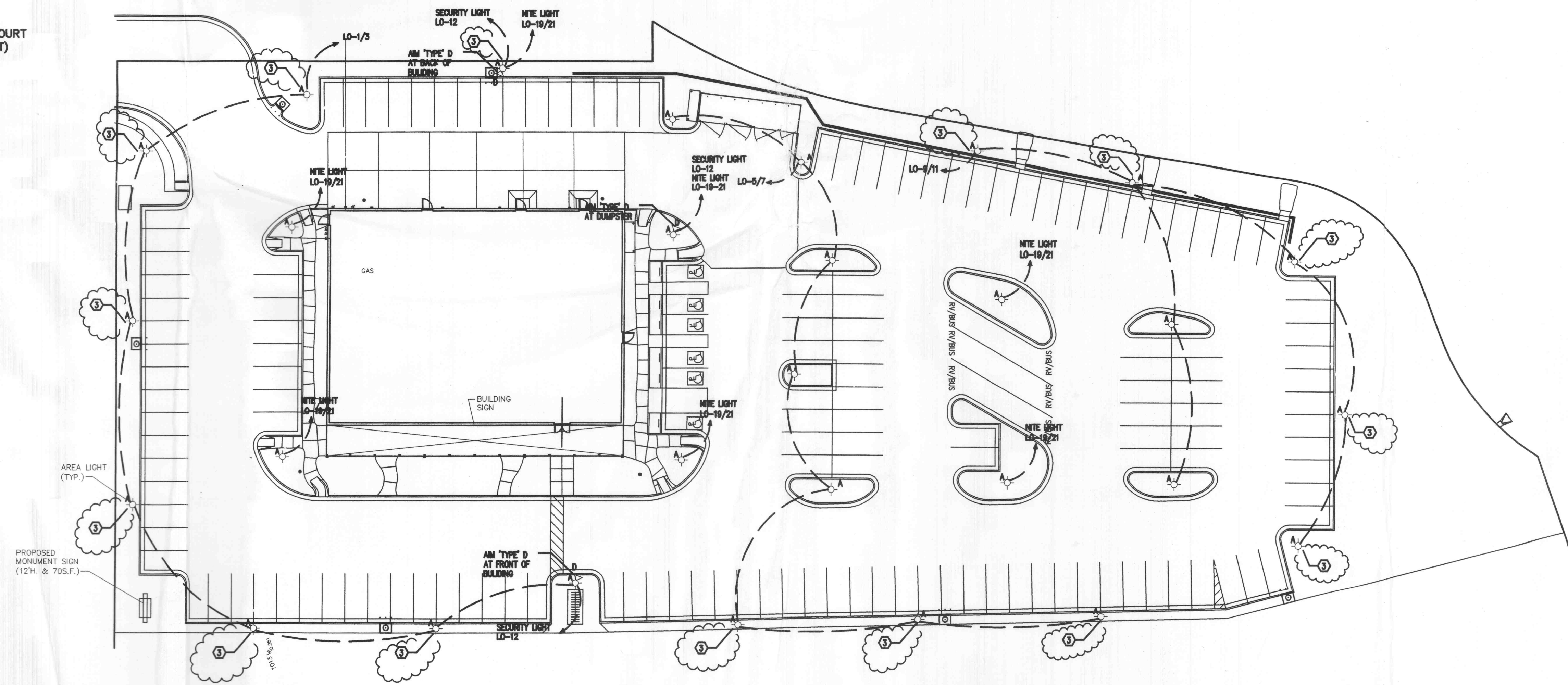

(SCALE: 1" = 20' - 0")

SITE PLAN

CRACKER BARREL  
OLD COUNTRY STORE  
Hwy. 40/64 and Hwy. K, NEQ  
0 Fallon, MO

These construction documents are the exclusive property of Cracker Barrel Old Country Store, Inc. The information shown may not be used, or the drawings reproduced without written permission of Cracker Barrel Old Country Store, Inc.

Cracker Barrel  
Old Country Store, Inc. P.O. Box 787  
Hartmann Drive, Lebanon, Tn. 37087

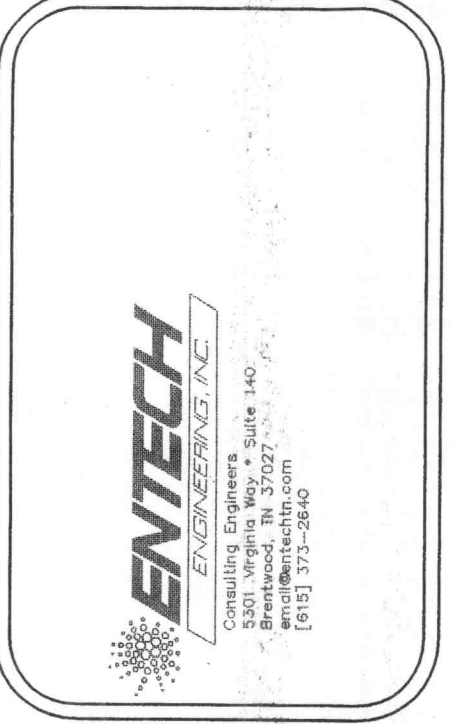

ELECTRICAL  
SITE PLAN

DATE: 4/18/03

PROJECT NO.	REVISIONS
11/10/03	Δ
11/14/03	Δ

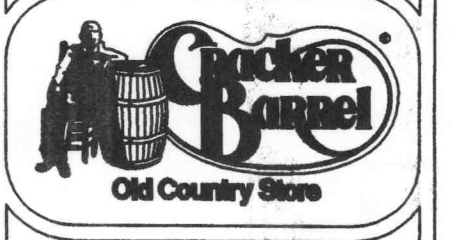

ES1  
CB 194-02