

INTERSTATE HIGHWAY 70

NOTE: RIP RAP SHOWN AT FLARED ENDS WILL BE EVALUATED IN THE FIELD AFTER INSTALLATION FOR EFFECTIVENESS AND FIELD MODIFIED IF NECESSARY TO REDUCE EROSION ON AND OFF SITE.

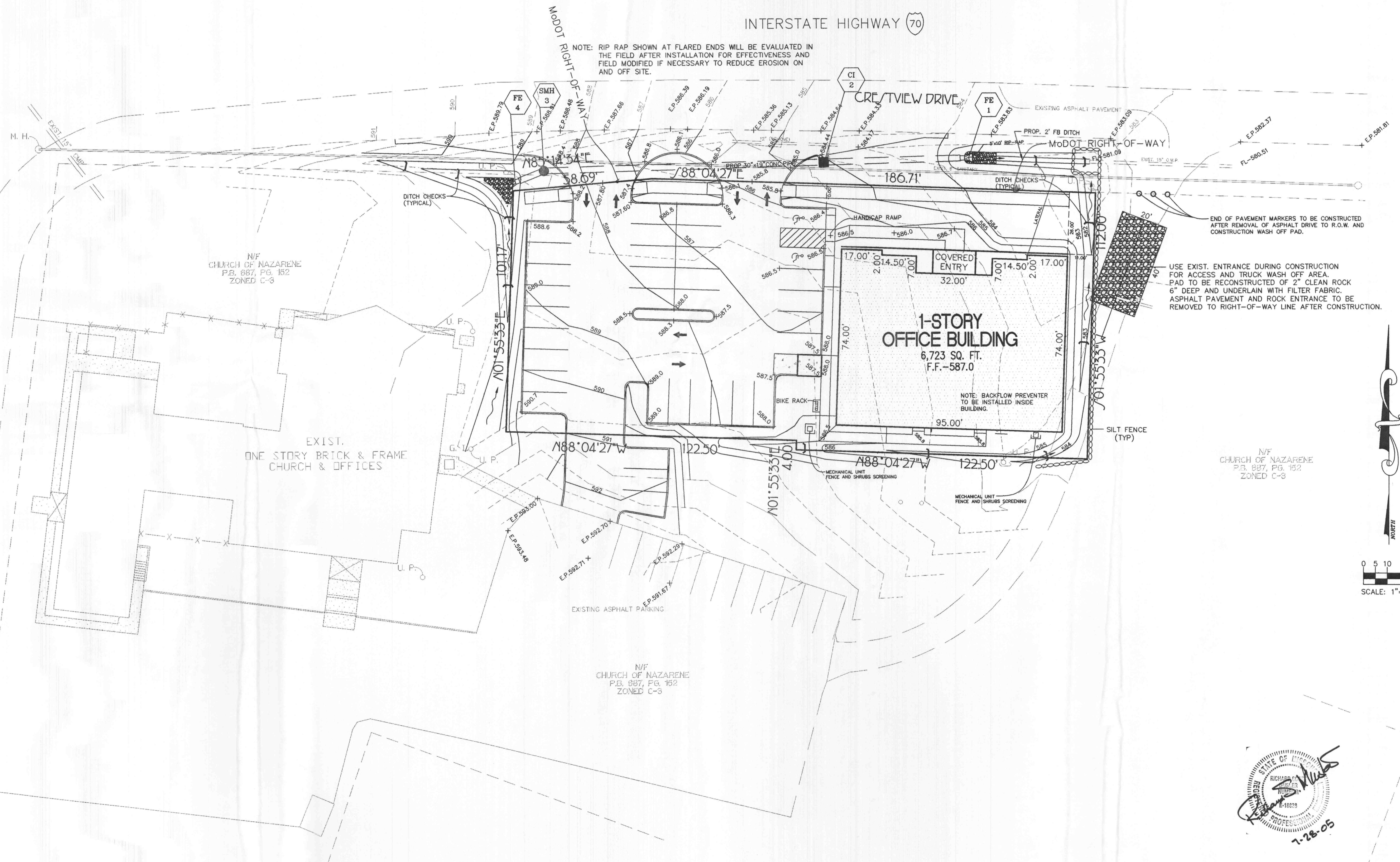

END OF PAVEMENT MARKERS TO BE CONSTRUCTED AFTER REMOVAL OF ASPHALT DRIVE TO R.O.W. AND CONSTRUCTION WASH OFF PAD.

USE EXIST. ENTRANCE DURING CONSTRUCTION FOR ACCESS AND TRUCK WASH OFF AREA. PAD TO BE RECONSTRUCTED OF 2" CLEAN ROCK 6" DEEP AND UNDERLAIN WITH FILTER FABRIC. ASPHALT PAVEMENT AND ROCK ENTRANCE TO BE REMOVED TO RIGHT-OF-WAY LINE AFTER CONSTRUCTION.

N/F CHURCH OF NAZARENE
P.B. 887, PG. 152
ZONED C-3

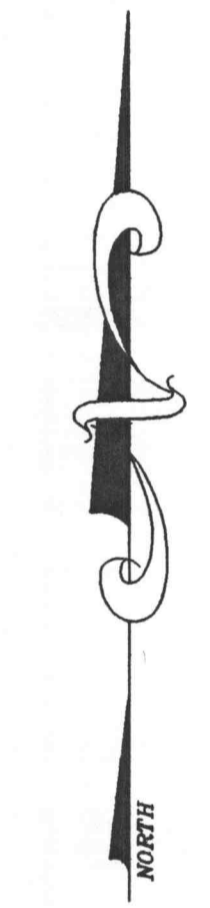

0 5 10 20
SCALE: 1"=20'

PROFESSIONAL ENGINEER
RICHARD J. WILSON
E-18229
1-28-05