

NOTE:  
2,500 PSI, PRE-CAST, AIR ENTRAINED CONCRETE, 6" H x 9" W x 7" L, CENTERED ON PARKING STALL. PROVIDE CHAMFERED CORNERS AND DRAINAGE SLOTS ON THE UNDERSIDE. PROVIDE MFG. STANDARD CONCRETE ANCHORS, OR #4 STEEL REINFORCING ROD STAKES OF SUFFICIENT LENGTH TO PENETRATE THE ROCK BASE PLUS 4", TWO PER WHEEL STOP.

**PRECAST WHEEL STOP**  
(n.t.s.)

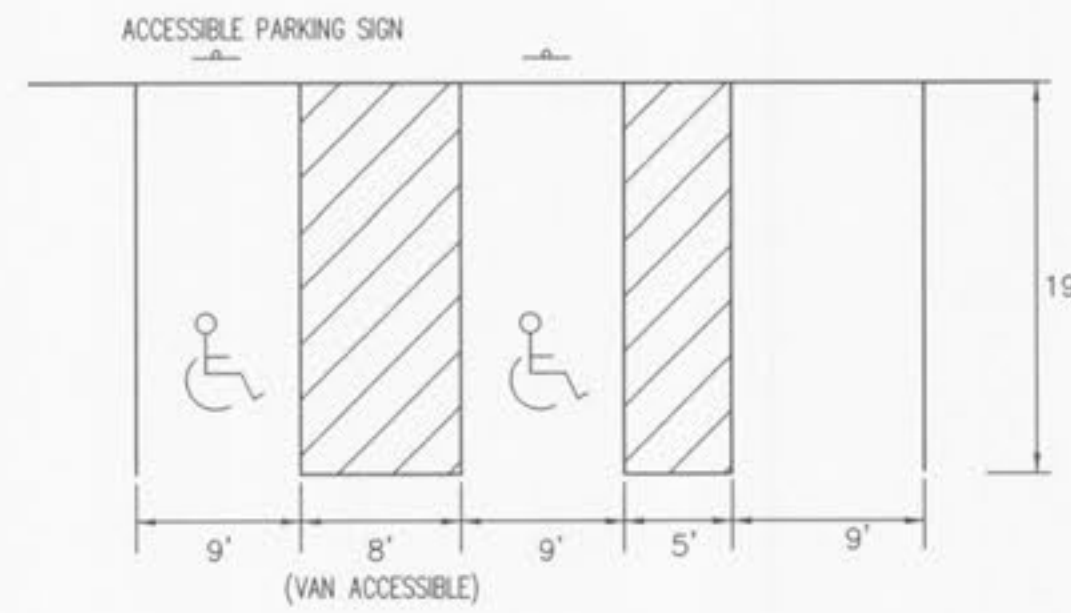

**HANDICAP SIGN**  
(n.t.s.)



**TYPICAL PARKING STALLS**  
(n.t.s.)



**ACCESSIBLE PARKING SIGN**  
(n.t.s.)

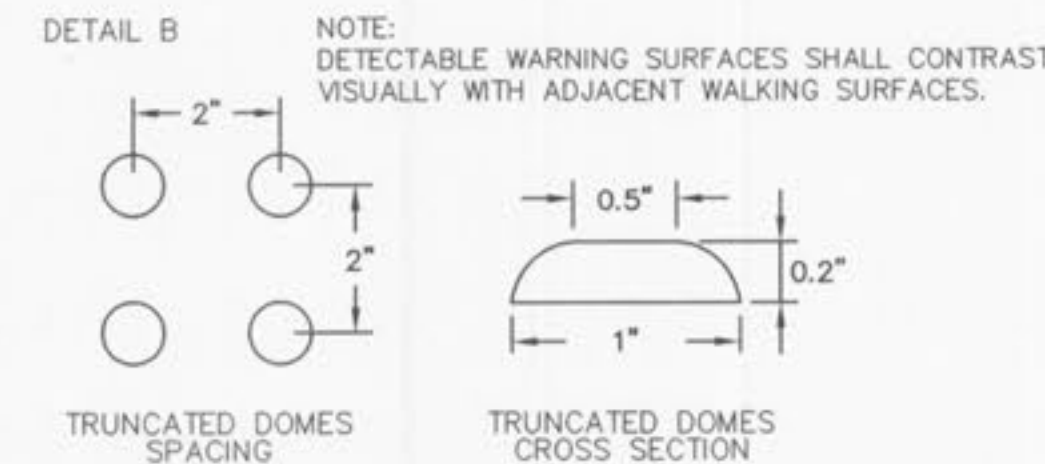
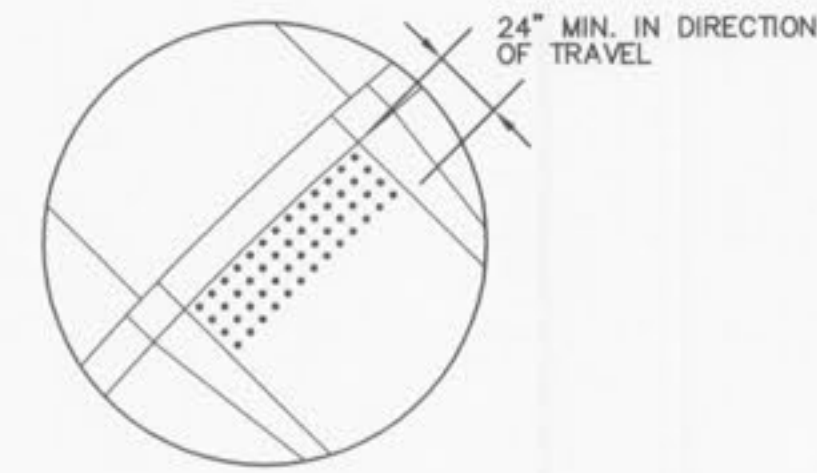

**DETECTABLE WARNING AT SIDEWALK RAMPS**  
(n.t.s.)

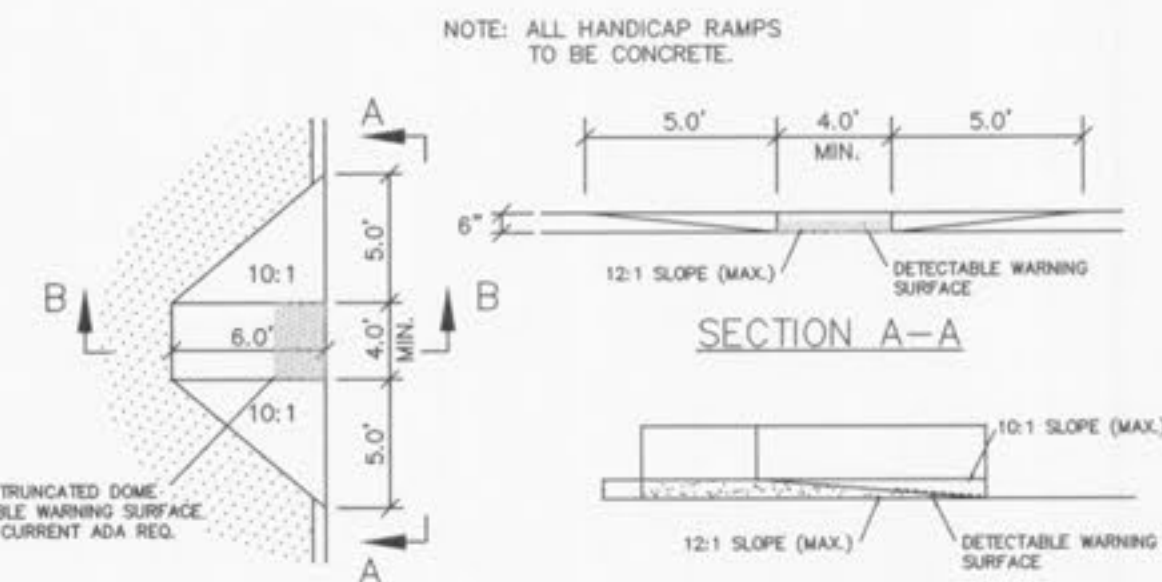

**PLAN HANDICAP RAMP DETAIL**  
(n.t.s.)

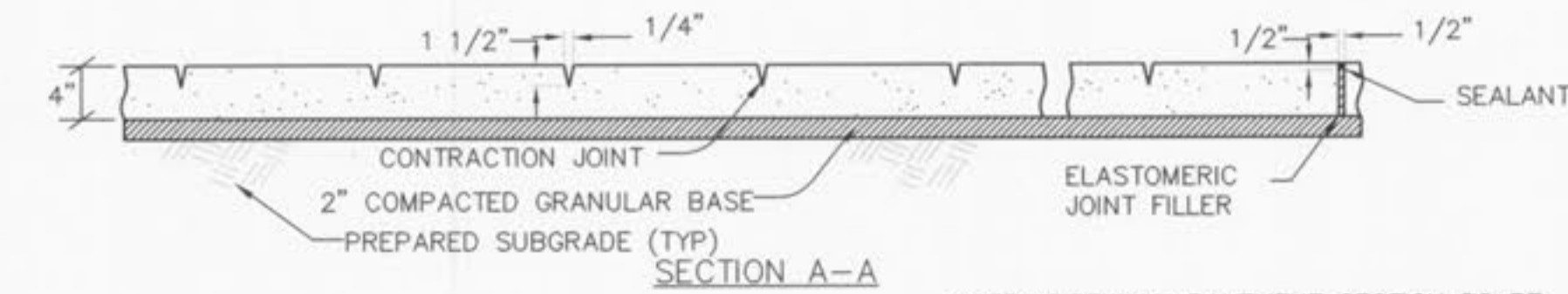
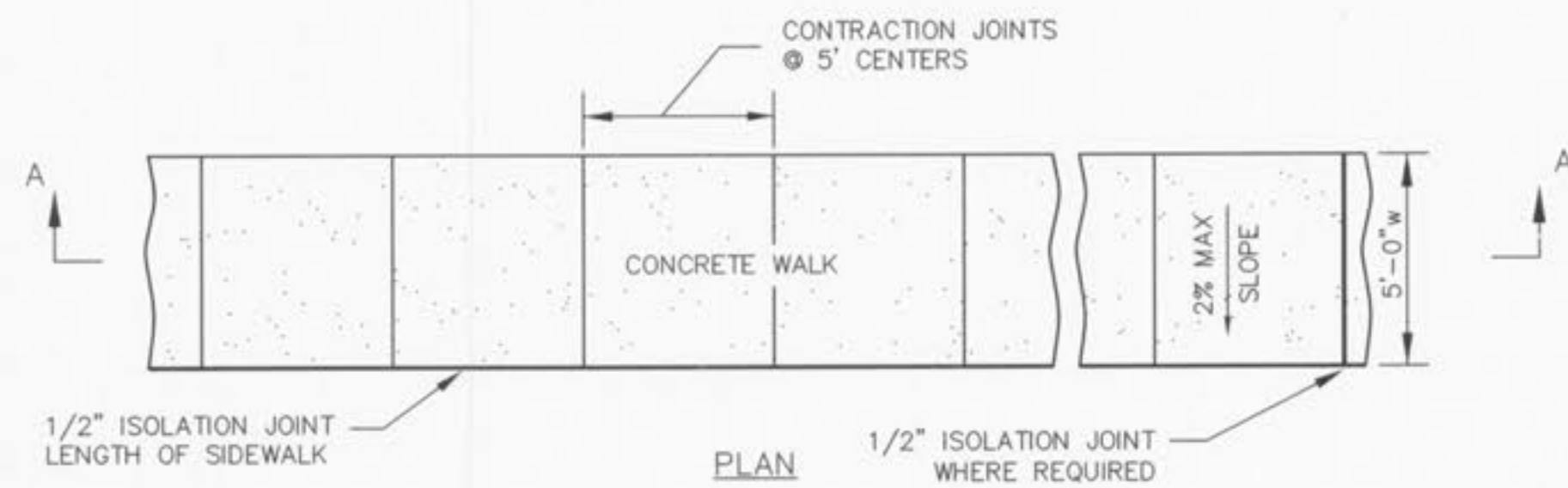

NOTE: SIDEWALK PAVEMENT SECTION TO BE UTILIZED AT BIKE RACK LOCATIONS.

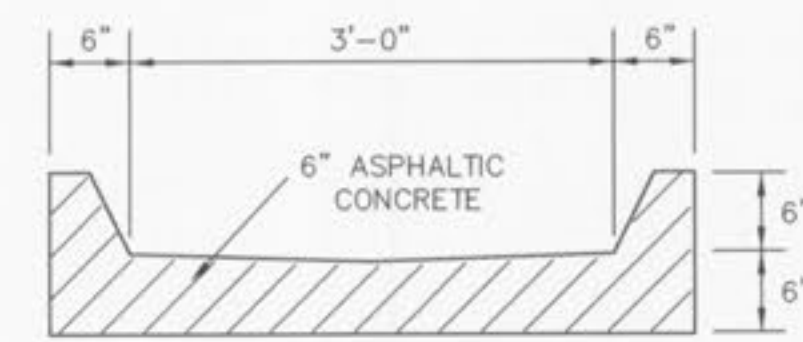

**SECTION VIEW**

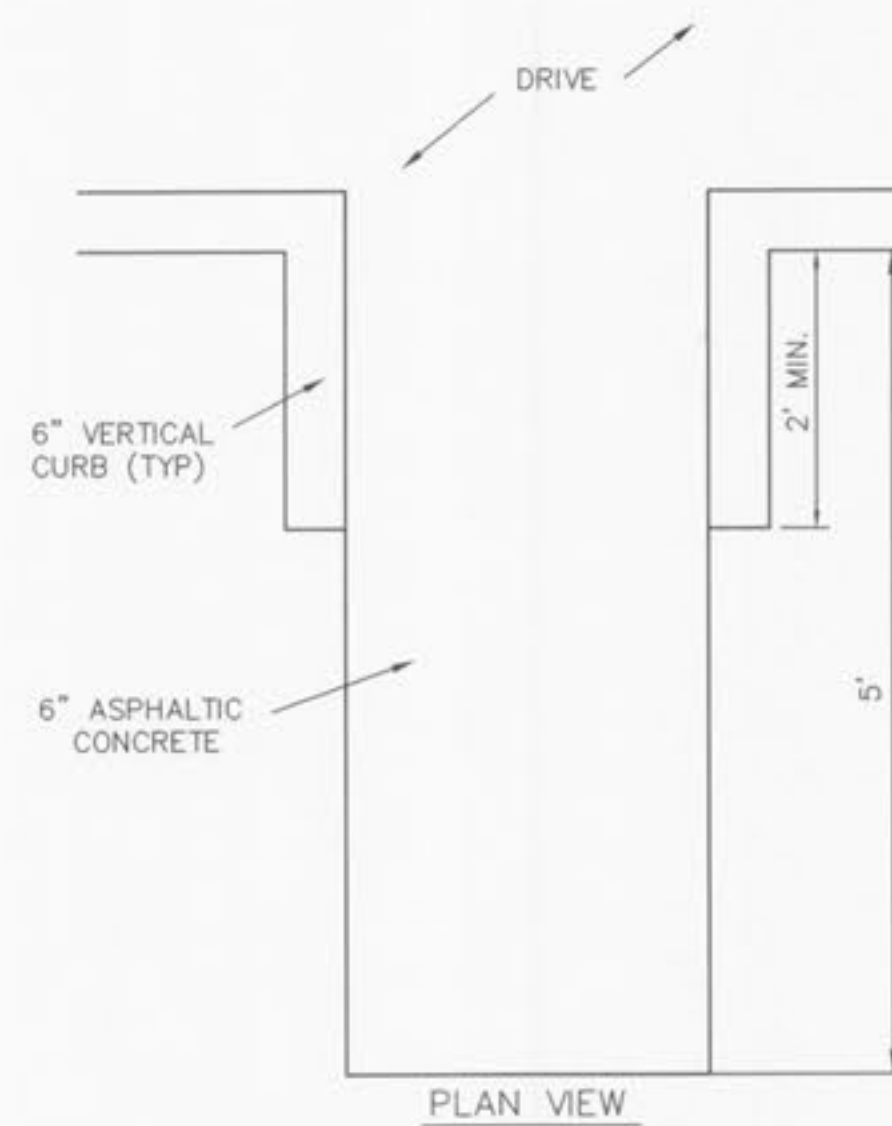

**TYPICAL FLUME DETAIL**  
(n.t.s.)

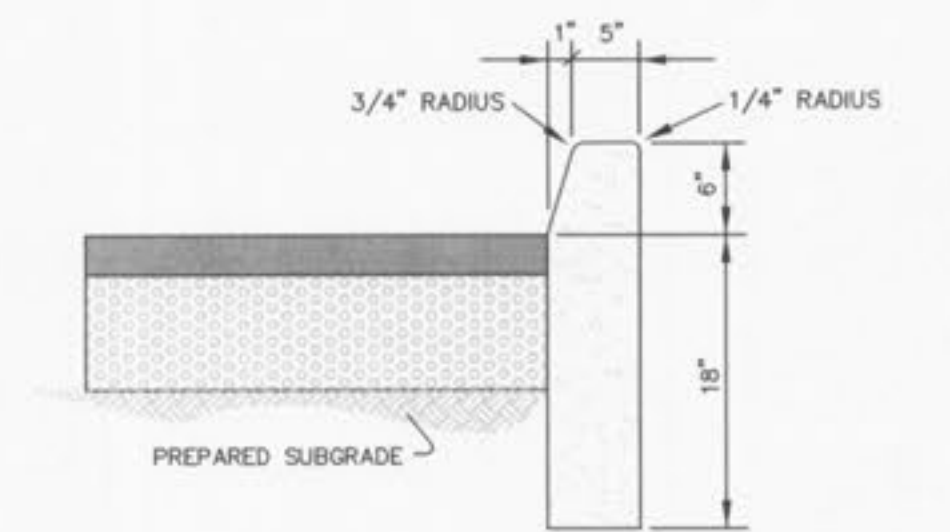

**TYPE "S" CURB & PAVEMENT DETAIL**  
(n.t.s.)

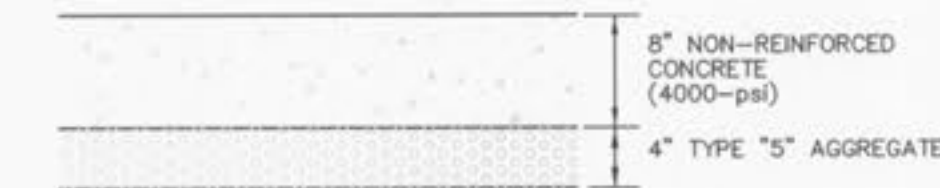

**CONCRETE PAVEMENT DETAIL**

NOTE: CONCRETE PAVEMENT DETAIL TO BE USED AT ALL ENTRANCES AND TRASH ENCLOSURE. ALL NON REINFORCED CONCRETE SHALL BE 4,000 P.S.I. AT 28 DAYS.



**ASPHALT PAVEMENT DETAIL**

ON-SITE

(n.t.s.)

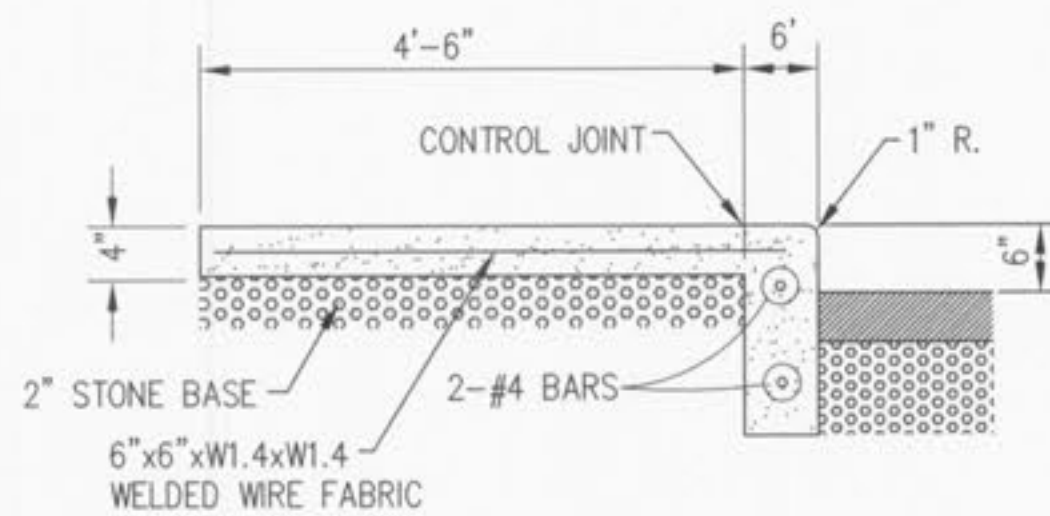

NOTE: EXPANSION JOINT MATERIAL SHALL BE INSTALLED IN THE WALK FOR ITS FULL WIDTH AND DEPTH AT INTERVALS OF APPROX. 20'. CONTROL JOINTS AT INTERVALS OF 1.0' TIMES ITS WIDTH.

**INTEGRAL SIDEWALK/CURB**

- △ CITY APPROVAL 02/01/11
- △ CITY COMMENTS 01/26/11
- △ CITY COMMENTS 01/13/11

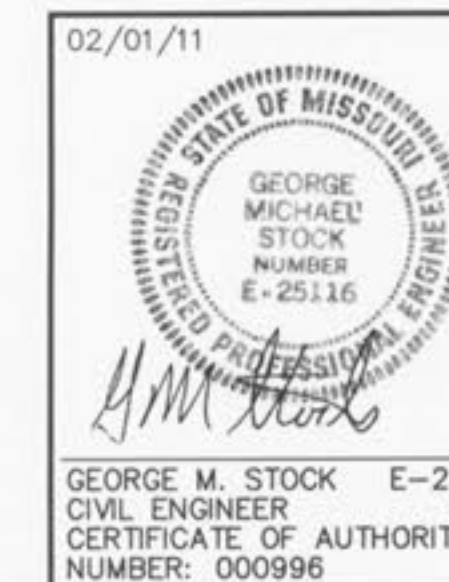

GEORGE M. STOCK E-25116  
CIVIL ENGINEER  
CERTIFICATE OF AUTHORITY  
NUMBER: 000996

**THE CROSSING AT RIVERSIDE CENTRE**

**CONSTRUCTION DETAILS**



257 Chesterfield Business Parkway  
St. Louis, MO 63005  
PH. (636) 530-9100  
FAX (636) 530-9130  
e-mail: general@stockassoc.com  
Web: www.stockassoc.com

DATE: 02/01/11	DATE CHECKED BY: G.M.S.	DATE: 12/21/10	DATE: 12/21/10	DATE: 12/21/10	DATE: 12/21/10
DRAWN BY: P.R.G.	DATE: 12/21/10	CHECKED BY: G.M.S.	DATE: 12/21/10	DATE: 12/21/10	DATE: 12/21/10
JOB NUMBER: 210-4626			SHEET: C12		