

NOTE: STRIPING AND PAINT SHALL BE PER MoDOT SPECIFICATIONS.

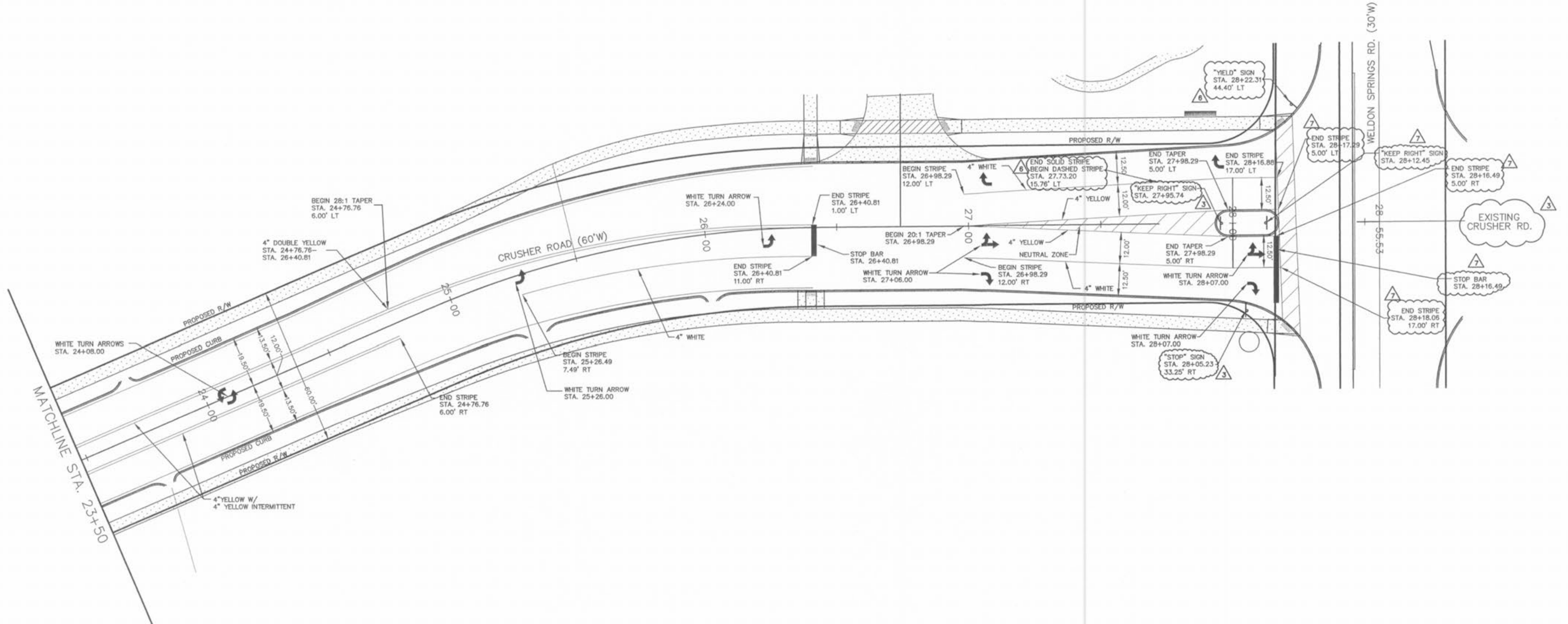

- △ PER CITY OF O'FALLON COMMENTS 01/04/06
- △ PER CITY OF O'FALLON COMMENTS 11/22/05
- △ PER CITY OF O'FALLON COMMENTS 06/06/03
- △ PER CITY OF O'FALLON COMMENTS 03/12/03
- △ PER CITY OF O'FALLON COMMENTS 06/27/02

PREPARED FOR:
HENNESSEY DEVELOPMENT
 9904 CLAYTON RD.
 SUITE 122
 ST. LOUIS, MO. 63124
 PH. (314) 991-1248
 FAX (314) 991-0964

CITY OF O'FALLON FILE NO.
31.01.01

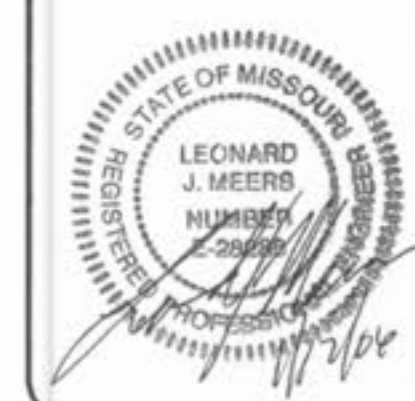

CRUSHER ROAD	
PAVEMENT STRIPING	
J. R. GRIMES	
CONSULTING ENGINEERS, INC.	
12300 OLD TESSON ROAD SUITE 3000 ST. LOUIS, MO. 63128 PH. (314) 849-6100 FAX (314) 849-6100	
DRAWN BY: JLW	DATE: 11/07/01
CHECKED BY: JRG	DATE: 11/07/01
JOB NUMBER: 675E	SHEET: C17

J:\0675E\PLANS\CL7-STRIPING.dwg, PLOT, 11/11/2006 9:03:46 AM, jghnk