

CONCRETE PAVEMENT DETAIL DRIVEWAYS
NOTE: CONCRETE IS TO BE 6 SACK, AIR-ENTRAINED MAX AND 4000 p.s.i. AT 28 DAYS

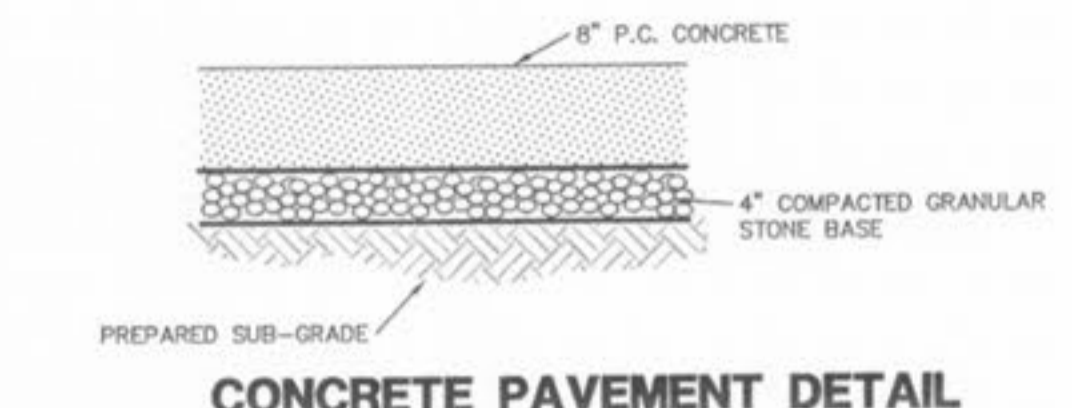

CONCRETE PAVEMENT DETAIL ROADWAY
NOTE: CONCRETE IS TO BE 6 SACK, AIR-ENTRAINED MAX AND 4000 p.s.i. AT 28 DAYS

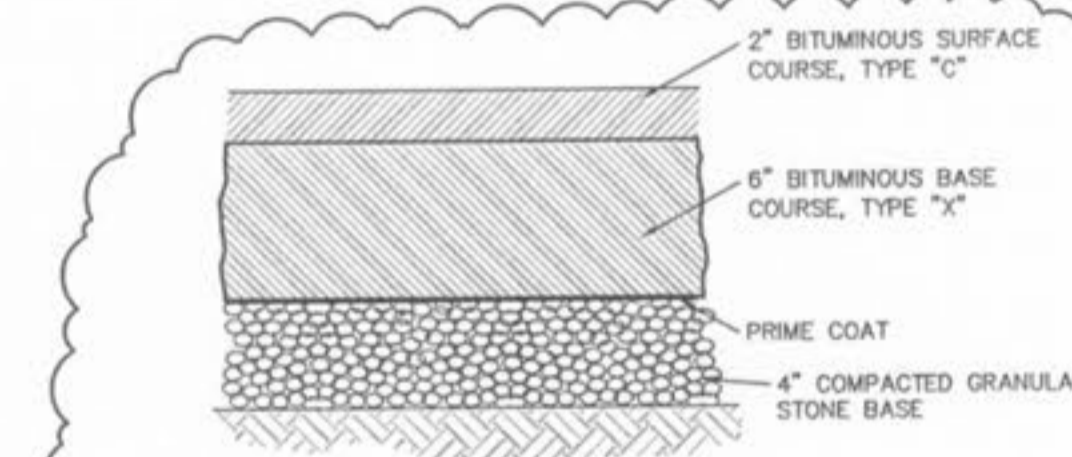

ASPHALT PAVEMENT WELDON SPRINGS ROAD SHOULDER

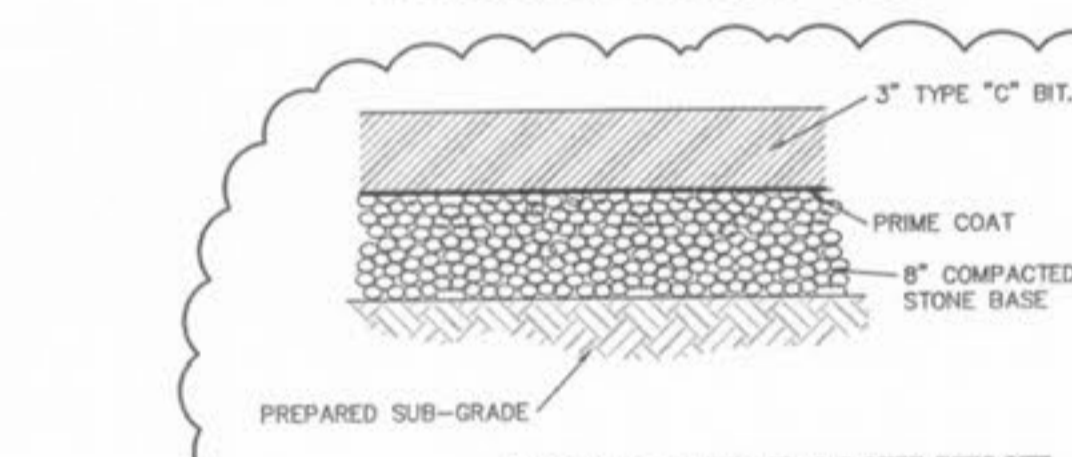

ASPHALT PAVEMENT DRIVEWAYS & TEMPORARY TURNAROUND

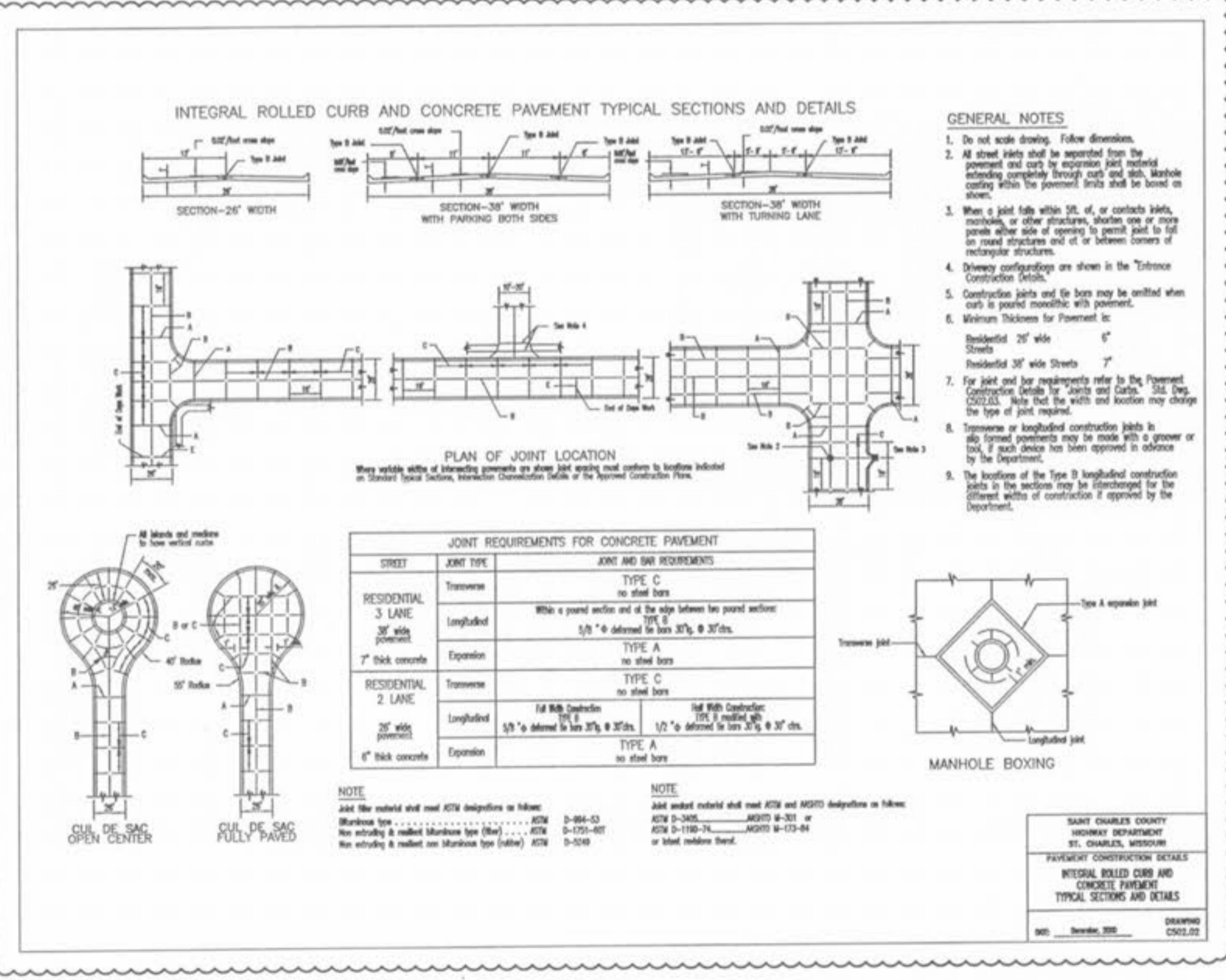

GENERAL NOTES
1. Do not scale drawing. Follow dimensions.
2. Construction joints shall be located in the pavement and curb by expansion joint material extending completely through curb and into concrete within the pavement slabs shall be based on:
3. When a joint falls within 50% of a contact joint, manhole, or other structure, slabs shall be cast in one piece with the curb and into concrete within the pavement slabs shall be based on:
4. Slab configurations are shown in the 'Entrance Construction Details'.
5. Construction joints and for bores may be omitted when curb is poured monolithically with pavement.
6. Minimum thickness for pavement is:
7. For joint and bar requirements refer to the 'Pavement Construction Details for Curb and Gutter'. See the 'CONCRETE' notes for details on joint and bar requirements. Note that the width and location may change the type of joint required.
8. Transverse or longitudinal construction joints in the pavement shall be made with a groove or hole. If each choice has been approved in advance by the Department.
9. The location of the Type B longitudinal construction joints in the sections may be staggered for the different widths of construction if approved by the Department.

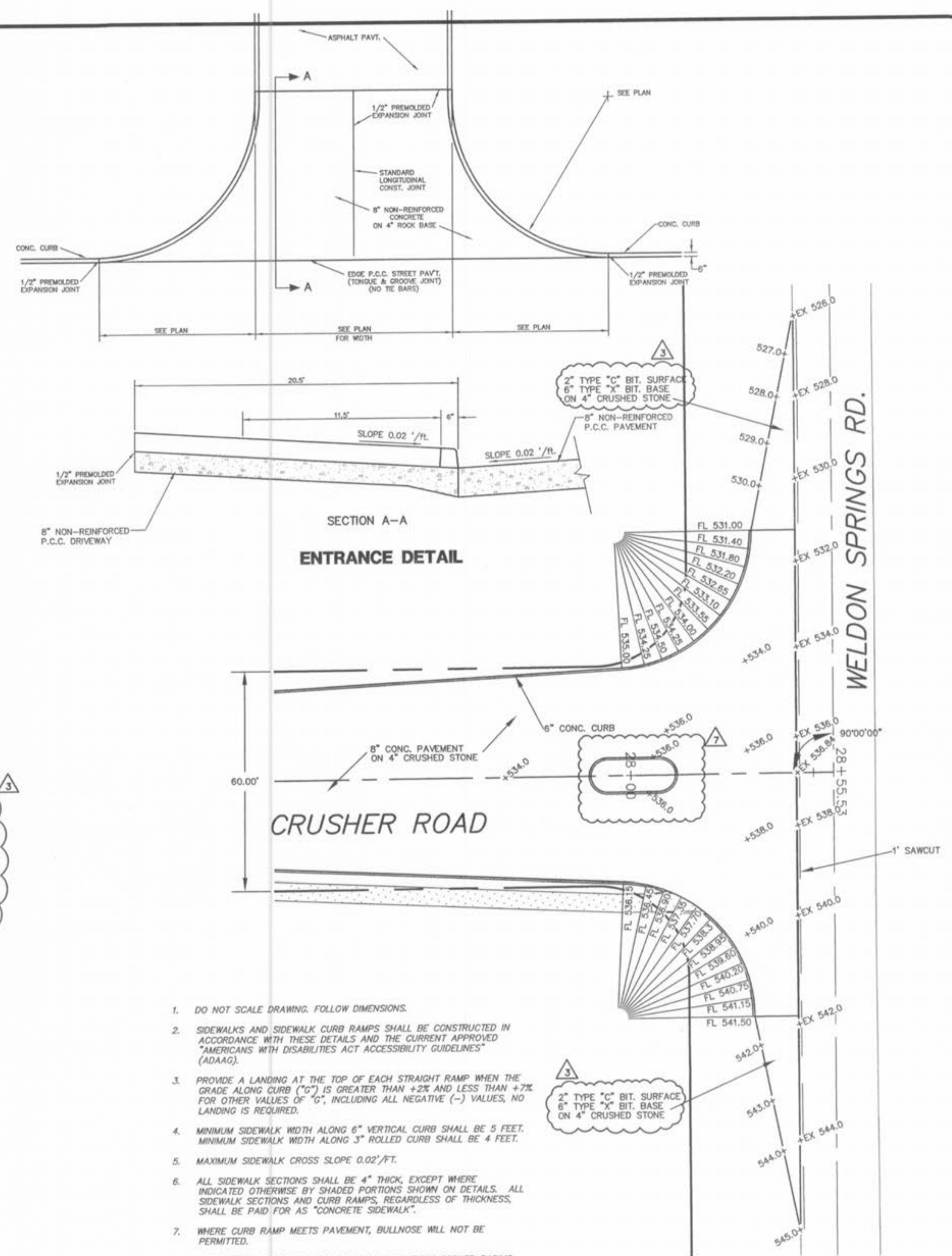

- DO NOT SCALE DRAWING. FOLLOW DIMENSIONS.
- SIDEWALKS AND SIDEWALK CURB RAMPS SHALL BE CONSTRUCTED IN ACCORDANCE WITH THESE DETAILS AND THE CURRENT APPROVED "AMERICANS WITH DISABILITIES ACT ACCESSIBILITY GUIDELINES" (ADAAG).
- PROVIDE A LANDING AT THE TOP OF EACH STRAIGHT RAMP WHEN THE GRADE ALONG CURB ("G") IS GREATER THAN +2% AND LESS THAN +7%. FOR OTHER VALUES OF "G", INCLUDING ALL NEGATIVE (-) VALUES, NO LANDING IS REQUIRED.
- MINIMUM SIDEWALK WIDTH ALONG 6" VERTICAL CURB SHALL BE 5 FEET. MINIMUM SIDEWALK WIDTH ALONG 3" ROLLED CURB SHALL BE 4 FEET.
- MAXIMUM SIDEWALK CROSS SLOPE 0.02%/FT.
- ALL SIDEWALK SECTIONS SHALL BE 4" THICK, EXCEPT WHERE INDICATED OTHERWISE BY SHADED PORTIONS SHOWN ON DETAILS. ALL SIDEWALK SECTIONS AND CURB RAMPS, REGARDLESS OF THICKNESS, SHALL BE PAID FOR AS "CONCRETE SIDEWALK".
- WHERE CURB RAMP MEETS PAVEMENT, BULLNOSE WILL NOT BE PERMITTED.
- CONSTRUCT A DIAGONAL RAMP WHEN THE MAXIMUM CORNER RADIUS ALLOWED FOR A STRAIGHT RAMP IS EXCEEDED.
- IF INTEGRAL CONCRETE CURB IS CONSTRUCTED, STRIKE A DUMMY JOINT ACROSS BOTTOM OF RAMP AT CURB LINE. IF CONCRETE CURB IS DOWNE-ON, BLOCK OUT PAVEMENT TO PROVIDE FULL DEPTH CURB ACROSS RAMP FROM OUTER POINT OF CURB TAPER TO OUTER POINT OF CURB TAPER.
- FOR SIDEWALK LOCATIONS ON CUL-DE-SACS, REFER TO "PAVEMENT CONSTRUCTION DETAILS".
- FOR PAVEMENT LONGITUDINAL AND TRANSVERSE JOINTS AND DOWEL AND THE BAR REQUIREMENTS AND DIMENSIONS, REFER TO THE PAVEMENT CONSTRUCTION DETAILS FOR "JOINTS AND CURBS". STANDARD DRAWING CS02.03.
- FOR ROADWAY CROSS SLOPES, PAVEMENT TYPES, AND THICKNESSES, REFER TO "STANDARD TYPICAL SECTION".
- PAVING SHALL BE PER ST. CHARLES COUNTY PAVING SPECIFICATIONS UNLESS OTHERWISE NOTED.

INTERSECTION OF CRUSHER ROAD & WELDON SPRINGS RD. WARPING DETAIL

- PER CITY OF O'FALLON COMMENTS 01/04/06
- PER CITY OF O'FALLON COMMENTS 11/22/05
- PER CITY OF O'FALLON COMMENTS 06/06/03
- PER CITY OF O'FALLON COMMENTS 03/12/03
- PER CITY OF O'FALLON COMMENTS 08/27/02

"G" GRADE ALONG CURB (%)	"X" MIN. LENGTH OF RAMP SLOPE (L.F.)
NEGATIVE (-) VALUES	6
0 TO +1	7
+1.01 TO +2	8
+2.01 TO +3	10
+3.01 TO +4	12
GREATER THAN +4	15

NOTE: POSITIVE (+) "G" - PROCEEDING AWAY FROM INTERSECTION AND UP A GRADE.
NEGATIVE (-) "G" - PROCEEDING AWAY FROM INTERSECTION AND DOWN A GRADE.

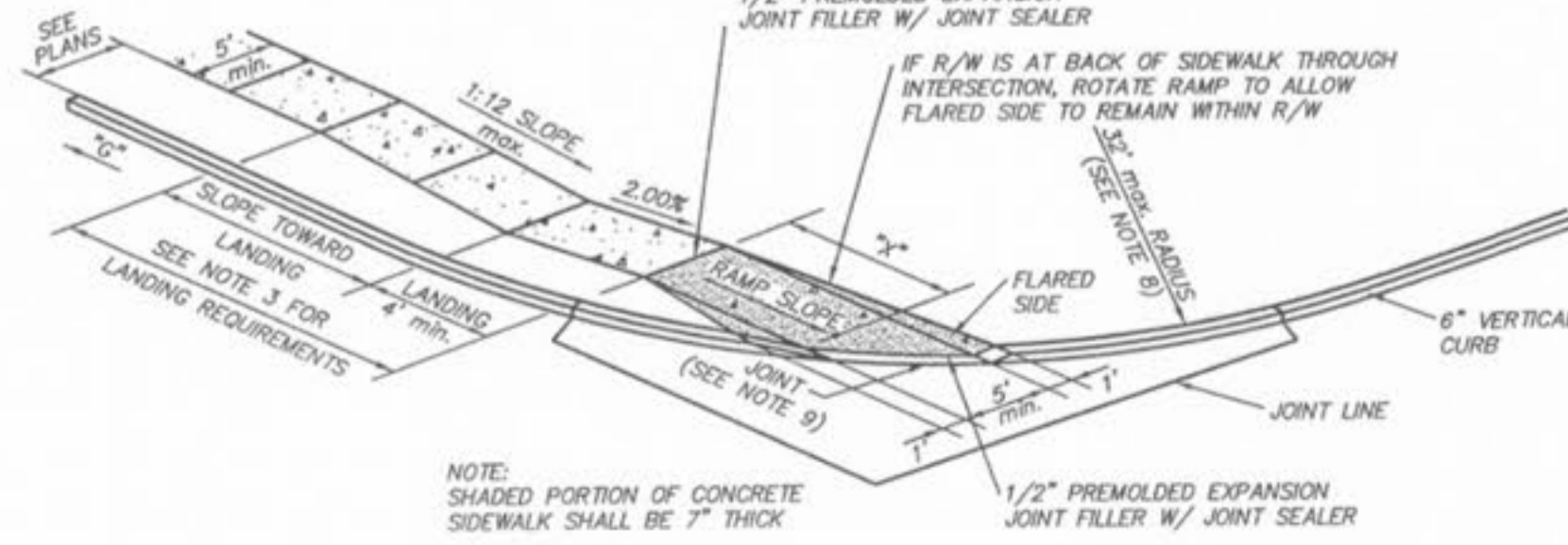

STRAIGHT CURB RAMP (TYPE 2)

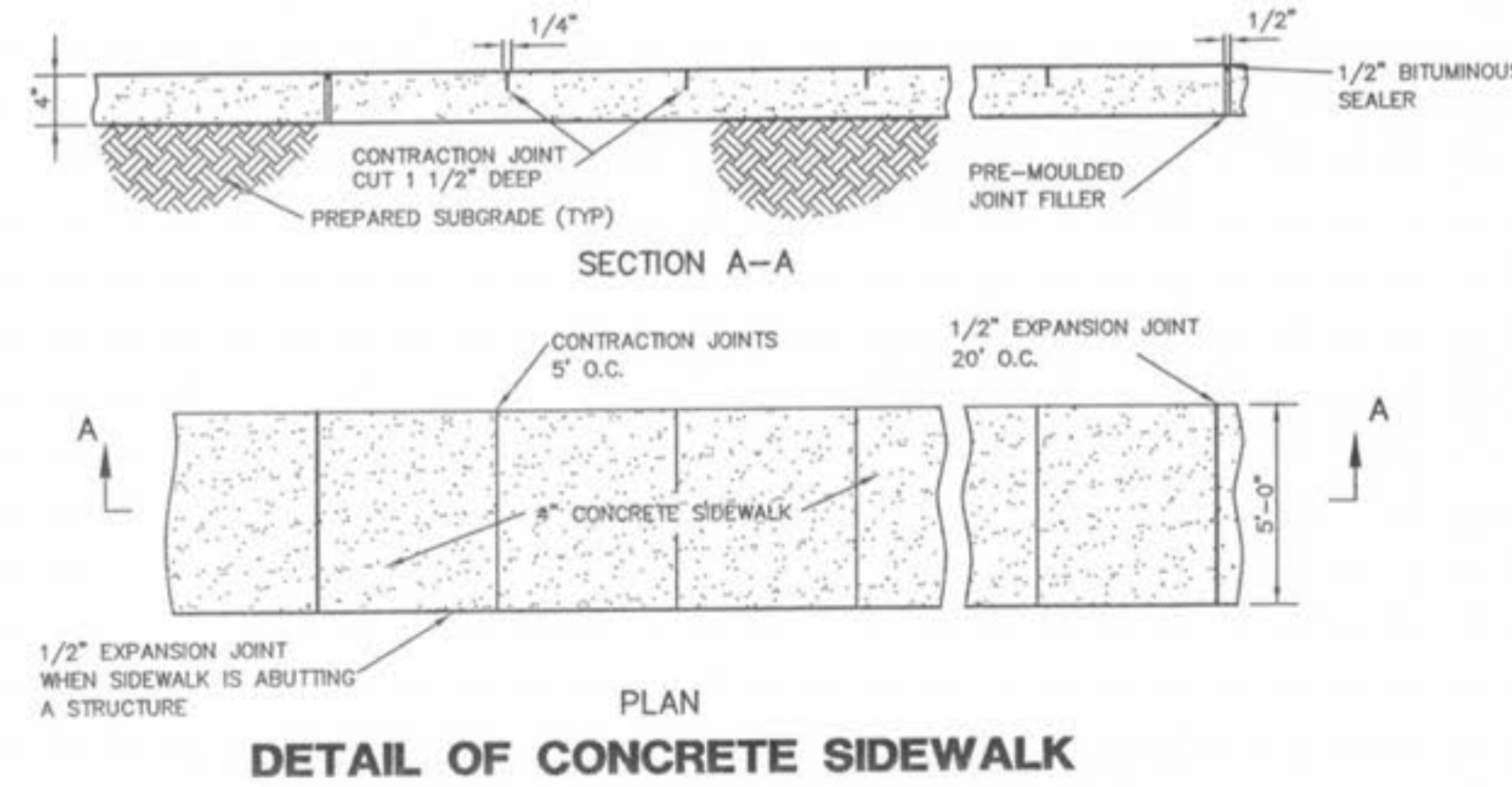

DETAIL OF CONCRETE SIDEWALK

CITY OF O'FALLON FILE NO. 31.01.01

PREPARED FOR:
HENNESSEY DEVELOPMENT
9904 CLAYTON RD.
SUITE 122
ST. LOUIS, MO. 63124
PH. (314) 991-1248
FAX (314) 991-0964

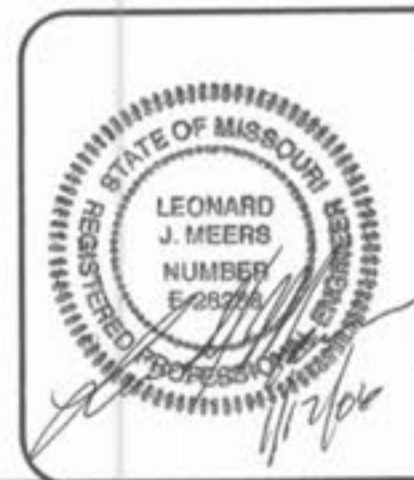

CRUSHER ROAD PAVEMENT DETAILS

J. R. GRIMES CONSULTING ENGINEERS, INC.
12300 OLD TESSON ROAD
SUITE 3000
ST. LOUIS, MO. 63128
PH. (314) 849-6100
FAX (314) 849-6010

DRAWN BY:	DATE:	CHECKED BY:	DATE:	JOB NUMBER:	SHEET:
JLW	11/07/01	JRG	11/07/01	675E	C18