

PARK RIDGE DRIVE
(26' WIDE STREET)

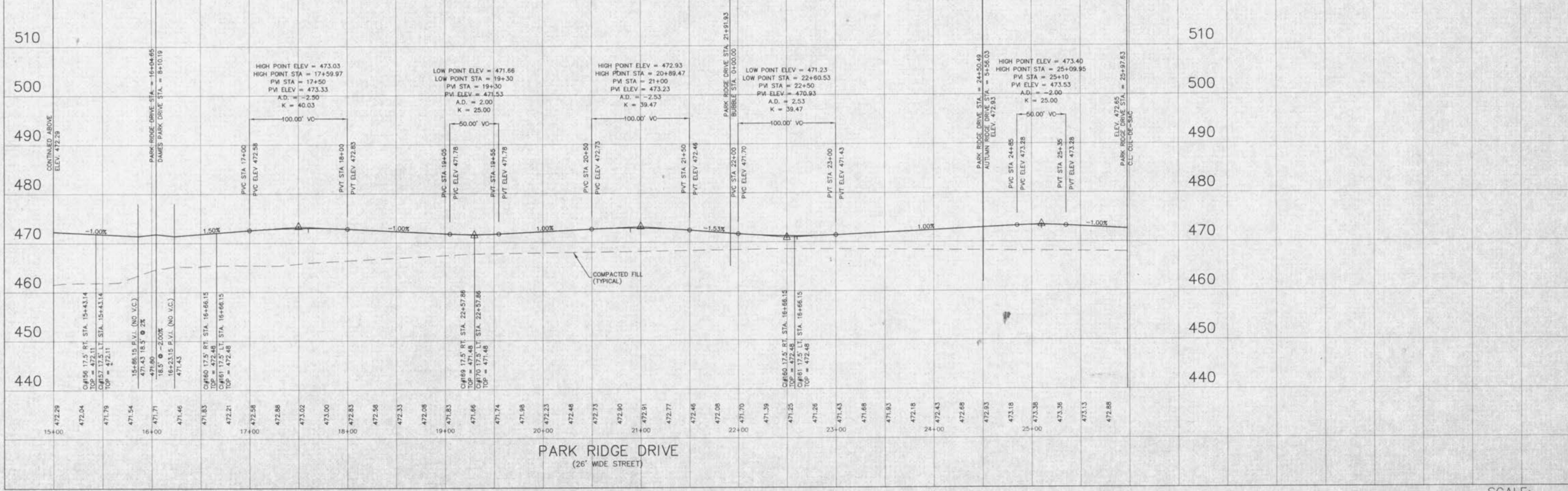

PARK RIDGE DRIVE
(26' WIDE STREET)

UNDERGROUND UTILITIES HAVE BEEN PLOTTED FROM AVAILABLE INFORMATION AND THEREFORE THEIR LOCATIONS SHALL BE CONSIDERED APPROXIMATE ONLY. THE VERIFICATION OF THE LOCATION OF ALL UNDERGROUND UTILITIES, EITHER SHOWN OR NOT SHOWN ON THESE PLANS SHALL BE THE RESPONSIBILITY OF THE CONTRACTOR, AND SHALL BE LOCATED PRIOR TO ANY GRADING OR CONSTRUCTION OF THE IMPROVEMENTS.

SCALE:
VERTICAL : 1" = 10'
HORIZONTAL : 1" = 50'

E:\proj\98001\101\98001.dwg, Sun Oct 15 09:18:23 2000, STA 26.dwg