

REVISED : 10-13-00 CITY  
 REVISED : 10-25-00 CITY  
 REVISED : 11-02-00 CITY  
 REVISED : 11-09-00 CITY  
 REVISED : 11-16-00 CORP OF ENGR

DRAINAGE AREA MAP  
**THE ESTATES AT DAMES PARK**  
**THE VILLAS AT DAMES PARK**  
 SEPT. 5, 2000 98-9946A

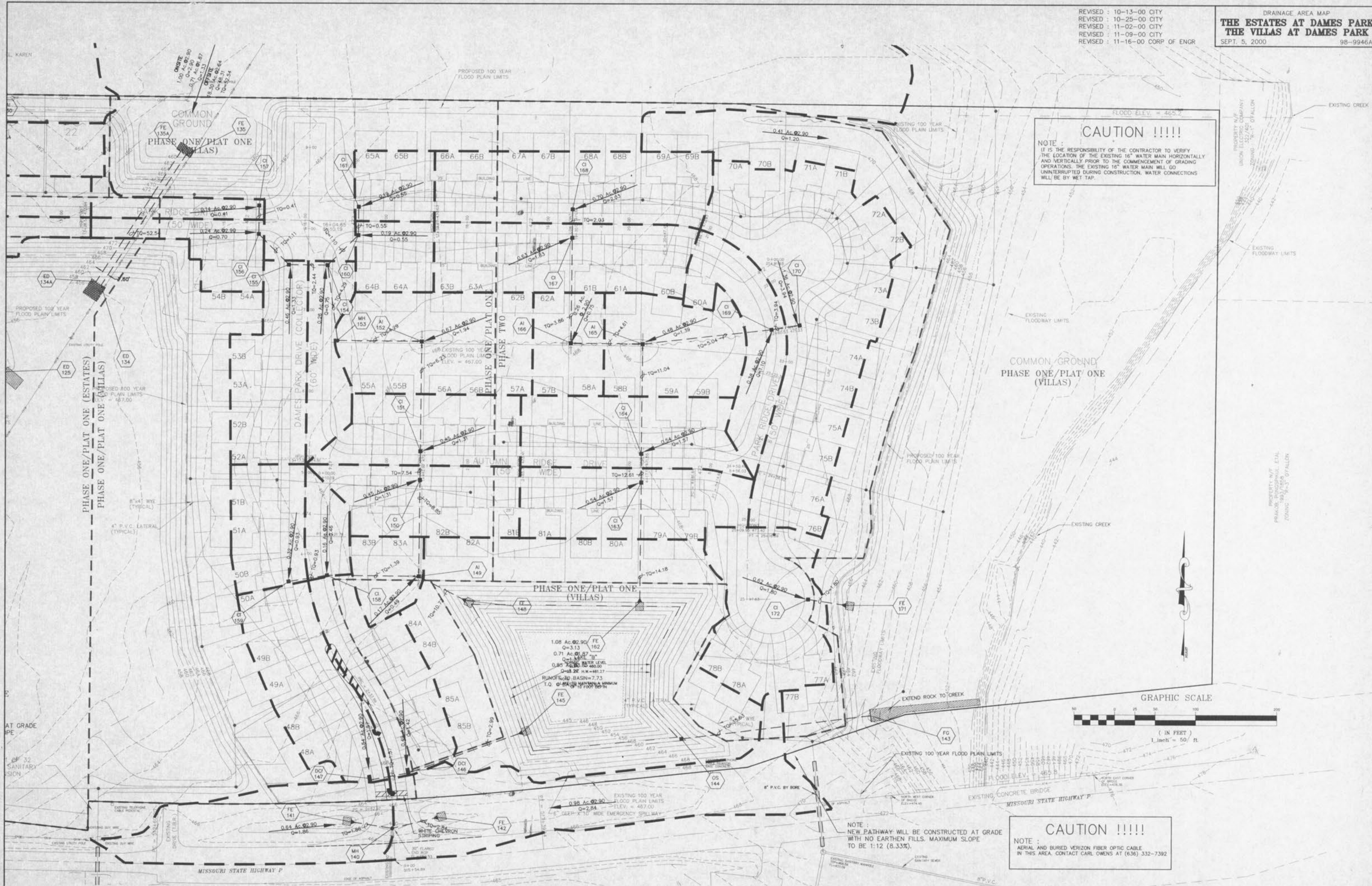

**CAUTION !!!!!**  
 NOTE :  
 IT IS THE RESPONSIBILITY OF THE CONTRACTOR TO VERIFY THE LOCATION OF THE EXISTING 16" WATER MAIN HORIZONTALLY AND VERTICALLY PRIOR TO THE COMMENCEMENT OF GRADING OPERATIONS. THE EXISTING 16" WATER MAIN WILL GO UNINTERRUPTED DURING CONSTRUCTION. WATER CONNECTIONS WILL BE BY WET TAP.

COMMON GROUND  
 PHASE ONE/PLAT ONE  
 (VILLAS)

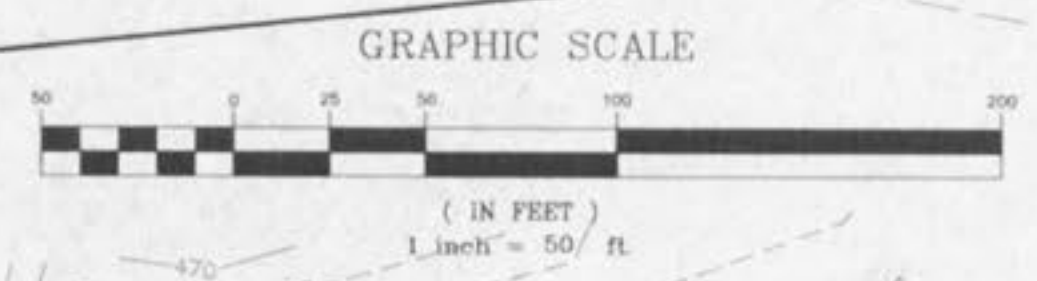

NOTE :  
 NEW PATHWAY WILL BE CONSTRUCTED AT GRADE WITH NO EARTHEN FILLS. MAXIMUM SLOPE TO BE 1:12 (8.33%).

**CAUTION !!!!!**  
 NOTE :  
 AERIAL AND BURIED VERIZON FIBER OPTIC CABLE IN THIS AREA. CONTACT CARL OWENS AT (636) 332-7392

**NOTE: THIS PLAN IS FOR DRAINAGE AREA PURPOSES ONLY! NOT FOR CONSTRUCTION!**

UNDERGROUND UTILITIES HAVE BEEN PLOTTED FROM AVAILABLE INFORMATION AND THEREFORE THEIR LOCATIONS SHALL BE CONSIDERED APPROXIMATE ONLY. THE VERIFICATION OF ALL UNDERGROUND UTILITIES, EITHER SHOWN OR NOT SHOWN ON THESE PLANS SHALL BE THE RESPONSIBILITY OF THE CONTRACTOR, AND SHALL BE LOCATED PRIOR TO ANY GRADING OR CONSTRUCTION OF THE IMPROVEMENTS.

E:\proj\2000\101139-46-00.dwg Thu Nov 18 13:45:21 2000 511.30 84"