

SEE WWW.ARMOR-TILE.COM FOR SPECIFICATIONS AND INSTALLATION NOTES.

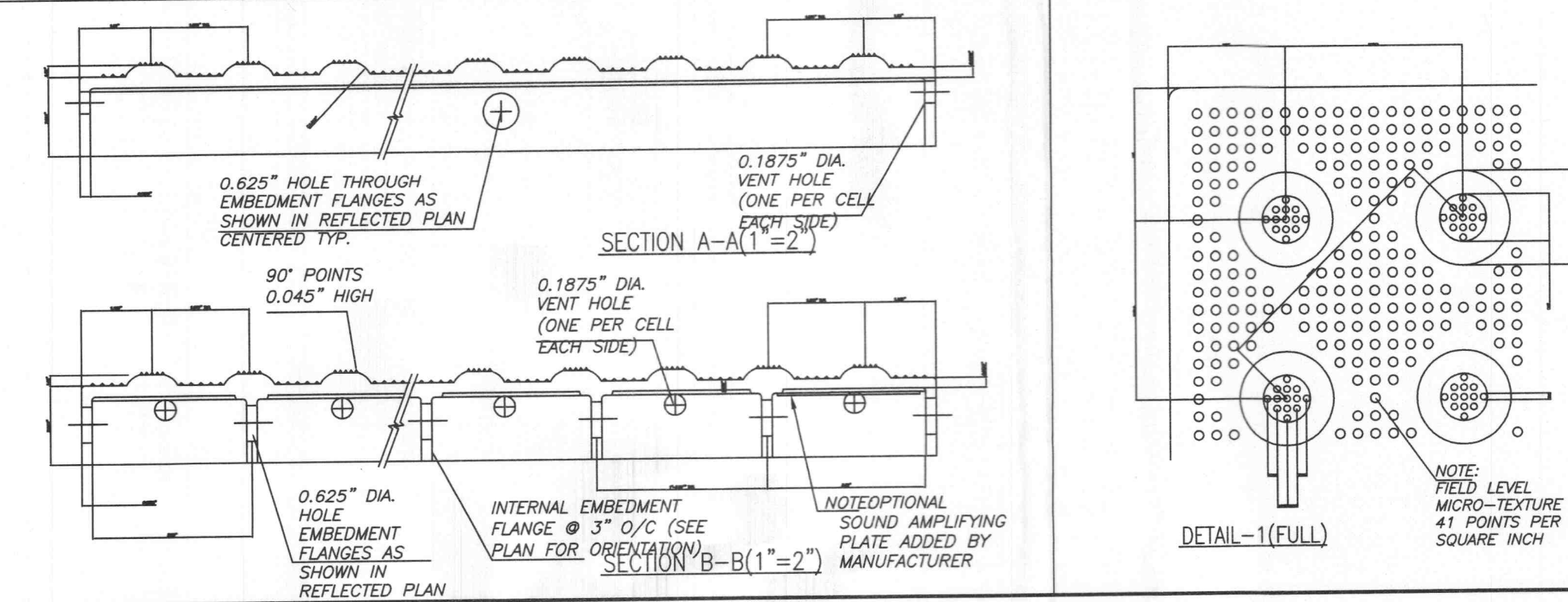
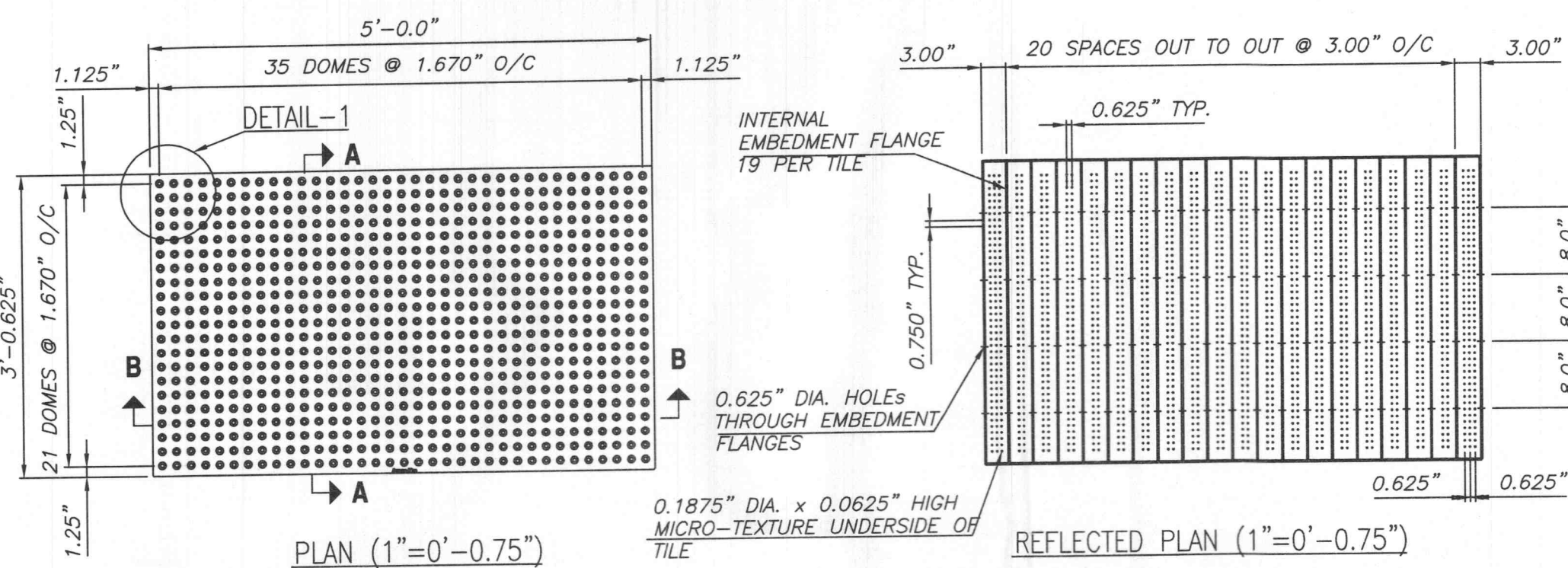

NOTES:  
 1. ALL DIMENSIONS ARE IN INCHES.  
 2. UNITS ARE CONSTRUCTED FROM HIGH DENSITY POLYETHYLENE PLASTIC WITH UV INHIBITORS.  
 3. MEDIA CARTRIDGES CAN BE INTERCHANGED WITH GEOTRIP SERIES AS SITE CONDITIONS CHANGE.  
 4. LOW PROFILE FILTER ARE ALSO AVAILABLE FOR SHALLOW CATCH BASINS.  
 5. CUSTOM SIZES ARE AVAILABLE TO FIT MOST APPLICATIONS. PLEASE CALL A DISTRIBUTOR NEAR YOU FOR DETAILS.  
 6. OPTIONAL TDG TRASH GUARD AVAILABLE.  
 7. DUAL STAGE AND DUAL CAPACITY FILTERS ALSO AVAILABLE.  
 8. DIM "A" AND "B" CAN BE TRIMMED TO FIT.  
 9. CUSTOM INSTALL BRACKETS ARE AVAILABLE AS NEEDED.

| MODEL # | A*    | B*    | C     | D     | E    | F    | G*     | DEPTH  |
|---------|-------|-------|-------|-------|------|------|--------|--------|
| TR12    | 12.00 | 13.00 | 11.00 | 11.00 | 6.75 | 3.75 | 5.5    | 1      |
| TR12PR  | 13.00 | 11.00 | 11.00 | 6.75  | 3.75 | 5.5  | 1      | 1      |
| TR18    | 18.00 | 14.00 | 14.00 | 6.75  | 3.75 | 10.5 | 1      | 1      |
| TR18PR  | 20.00 | 17.00 | 17.00 | 10.5  | 7.25 | 10.5 | 1      | 1      |
| TR24    | 24.00 | 17.00 | 17.00 | 10.5  | 7.25 | 10.5 | 1      | 1      |
| TR24PR  | 26.00 | 21.00 | 21.00 | 14.0  | 11.0 | 13.0 | 1      | 1      |
| TR24RD  | 26.00 | 21.00 | 14.0  | 11.0  | 13.0 | 1    | 1      | 1      |
| TR2436  | 26.00 | 38.00 | 17.00 | 30.00 | 10.5 | 7.25 | 10.5   | 2      |
| TR30    | 30.00 | 33.00 | 21.00 | 21.00 | 14.0 | 11.0 | 13.0   | 1      |
| TR36    | 40.00 | 40.00 | 34.00 | 34.00 | 10.5 | 7.25 | 10.5   | 4      |
| TR36PR  | 40.00 | 34.00 | 34.00 | 14.0  | 11.0 | 22.0 | 1-TALL | 1      |
| TR2448  | 26.00 | 52.00 | 21.00 | 42.00 | 14.0 | 11.0 | 13.0   | 2      |
| TR4848  | 52.00 | 52.00 | 42.00 | 42.00 | 24.0 | 20.0 | 22.0   | 1-TALL |

NOTES:  
 1. ALL DIMENSIONS ARE IN FEET. CUSTOM SIZES ALSO AVAILABLE.  
 2. UNITS ARE CONSTRUCTED FROM HIGH DENSITY POLYETHYLENE PLASTIC WITH UV INHIBITORS. OVER 40% RECYCLED CONTENT.  
 3. DISPOSABLE MEDIA-PAK IS CONSTRUCTED OF DURABLE GEOTEXTILE FABRIC, WOVEN WITH PERFORATED POLYPROPYLENE.  
 4. MEDIA-PAK CASE IS CONSTRUCTED USING 8 GAUGE TYPE 304 STAINLESS STEEL.  
 5. FILTER BODY IS SECURED TO INSIDE WALL USING (2) 1/4" THICK BRACKETS PER SECTION. ATTACHED USING 3/8" X 3" EXPANSION ANCHOR BOLTS.  
 6. OPTIONAL STORMWEB, DESIGNED FOR CAPTURING LARGER TRASH AND DEBRIS.  
 7. FILTER MEDIA IS NON-HAZARDOUS PER EPA AND OSHA STANDARDS.  
 8. FILTER SHALL BE INSTALLED AND MAINTAINED IN ACCORDANCE WITH MANUFACTURER RECOMMENDATIONS.  
 9. PLEASE REFER TO MANUFACTURER RECOMMENDATIONS FOR AN APPROVED MAINTENANCE PROGRAM.

| MODEL # | A*    |
|---------|-------|
| TRC2    | 2.00  |
| TRC2.5  | 2.50  |
| TRC3    | 3.00  |
| TRC3.5  | 3.50  |
| TRC4    | 4.00  |
| TRC5    | 5.00  |
| TRC6    | 6.00  |
| TRC7    | 7.00  |
| TRC8    | 8.00  |
| TRC9    | 9.00  |
| TRC10   | 10.00 |
| TRC12   | 12.00 |
| TRC14   | 14.00 |
| TRC21   | 21.00 |
| TRC28   | 28.00 |

WWW.Armor-Tile.COM  
**ENGINEERED PLASTICS**  
 © 2006 ENGINEERED PLASTICS. CONFIDENTIAL AND PROPRIETARY DOCUMENT. ANY ONE OR MORE OF THE FOLLOWING PATENTS MAY APPLY:  
 U.S. PATENT NO. 5,303,669, 5,775,835, 6,448,790, AND 6,895,622; IS. CAN. PATENT NO. 2,335,532, 2,070,884. US PATENTS PENDING.  
 © KENNETH E. SZEKELY

**MATERIAL LIST**

| DESCRIPTION  | PART NO.      | QTY |
|--------------|---------------|-----|
| 1 ARMOR-TILE | ADA-C-3660-1* | 1   |

\*\* COLOR CODE  
 YELLOW (Y), RED (RD), BLACK (BK), DARK GREY (DG), LIGHT GREY (LG), WHITE (WH), OCRE YELLOW (OY), BLUE (BL), COLORED RED (CR), CUSTOM COLORS AVAILABLE.

NO: DATE REVISION APPR.

SCALE

DESIGNED BY: K.S. DATE: 08/30  
 DRAWN BY: D.G. DATE: 2/22/2006

PROJECT NUMBER: DETECTABLE WARNING SURFACE  
 PART NO: ADA-C-3660-1\*

**Armor-Tile® ADA**  
 SOUND AMPLIFYING DETECTABLE/TACTILE WARNING SURFACE TILE

**Armor-Tile®**  
 DETECTABLE/TACTILE WARNING SURFACE TILE  
 36" x 60" CAST IN PLACE INLINE DOME TACTILE TILE  
 PLANS AND DETAILS

DATE: ADA-C-3660 REV: 0

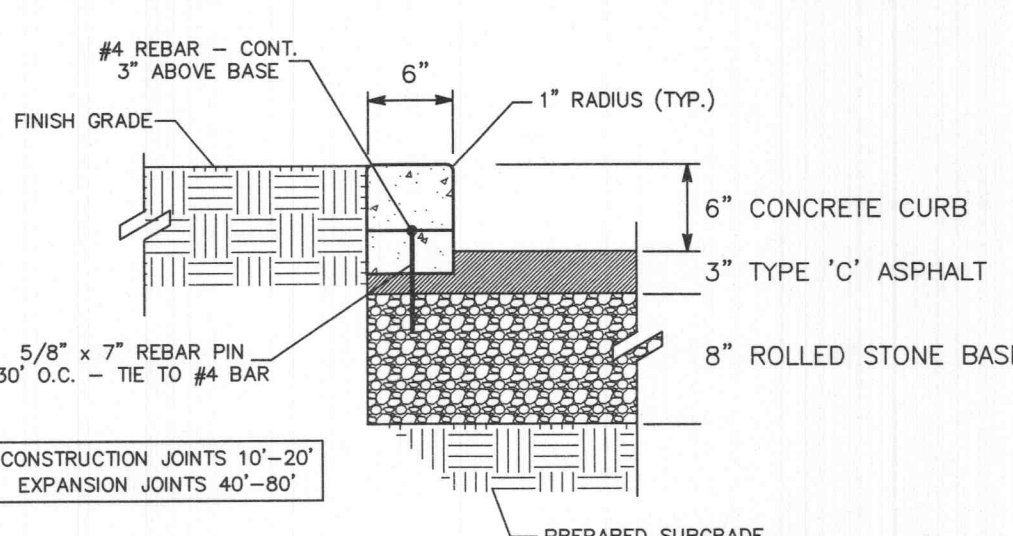

CONSTRUCTION JOINTS 10'-20'  
 EXPANSION JOINTS 40'-80'

\* WITHIN PARKING LOT ONLY  
 \* TO BE PERMA CURB BRAND

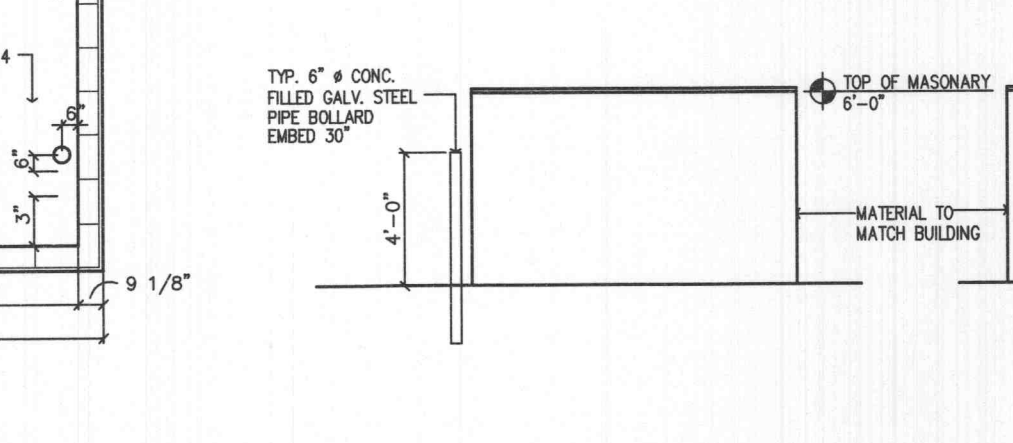
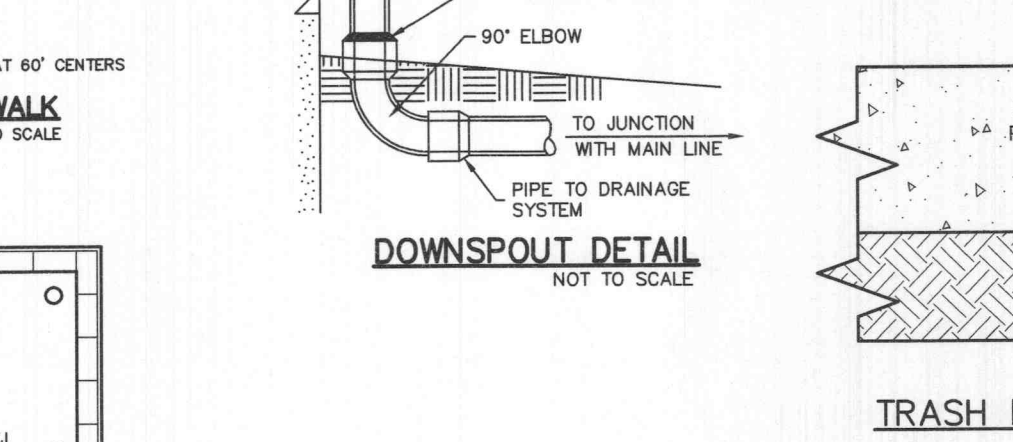
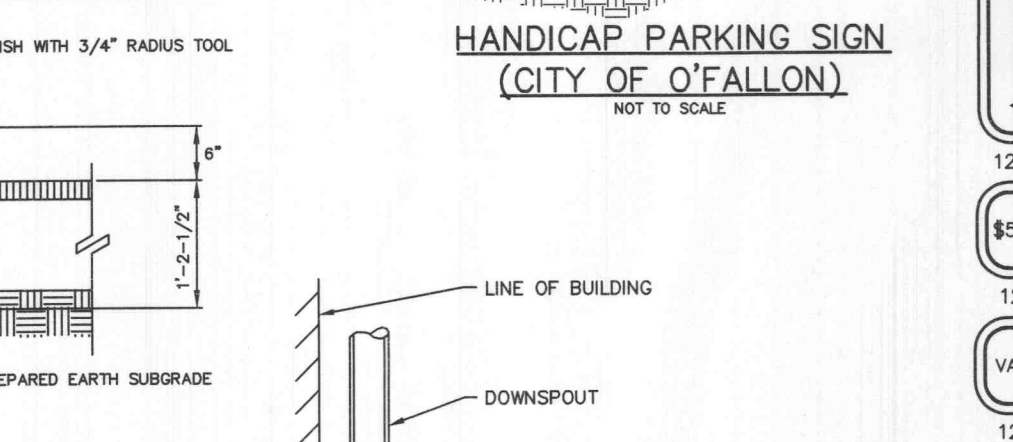
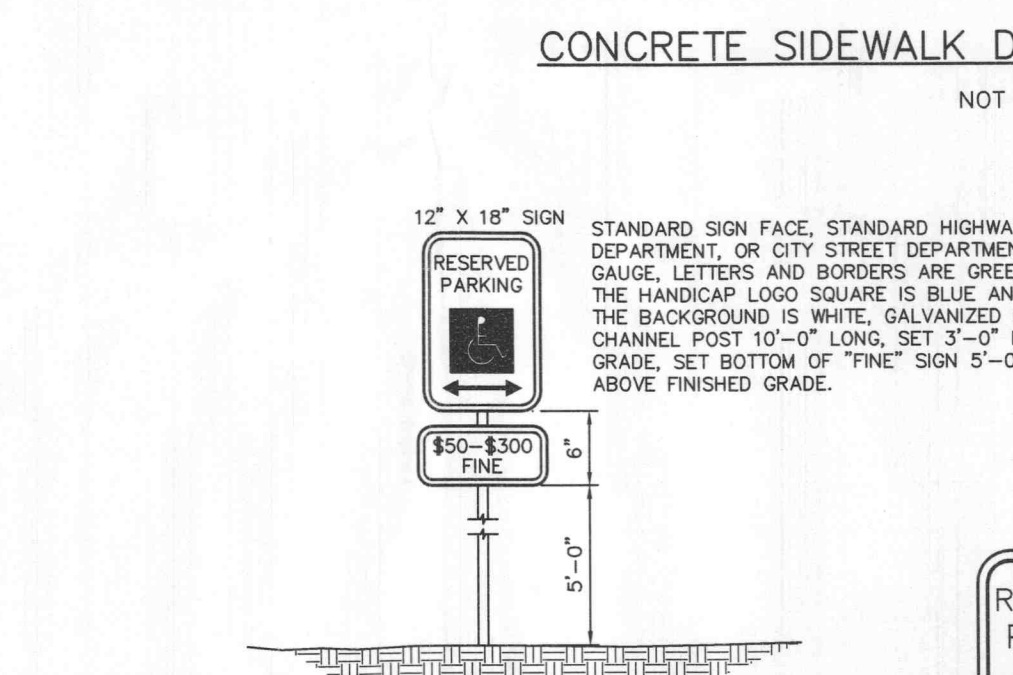
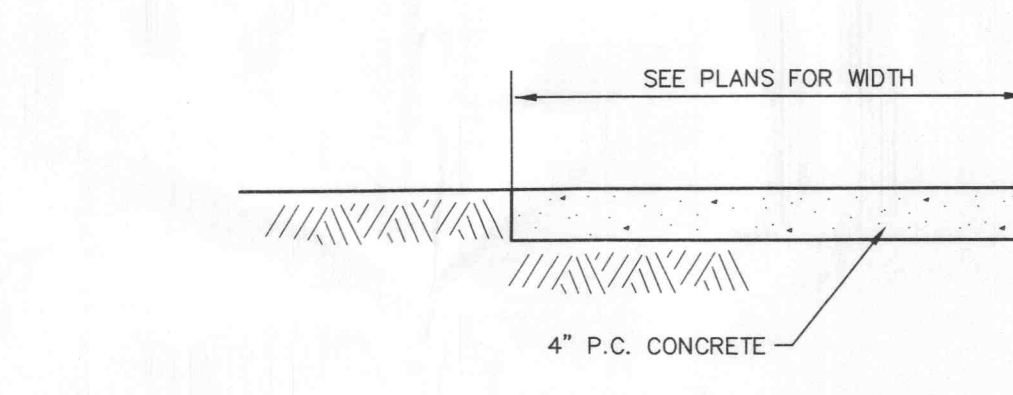
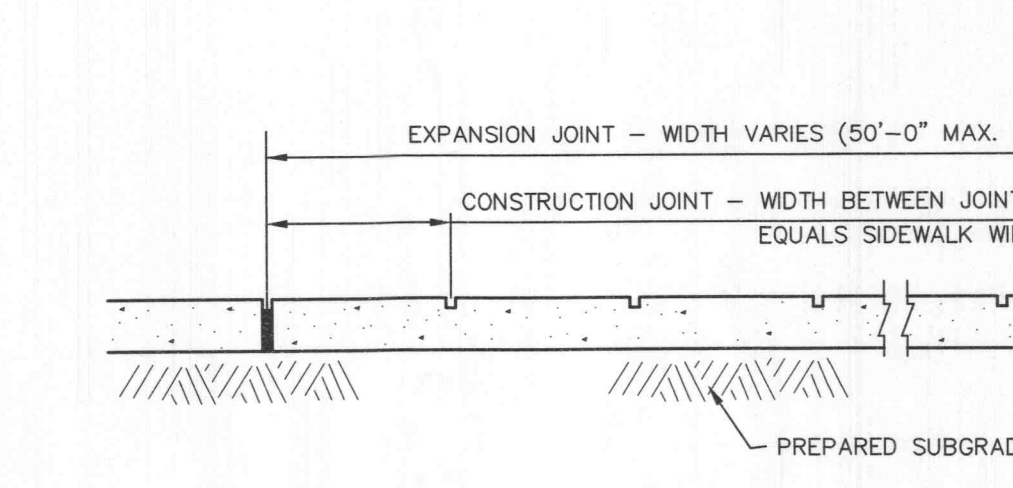
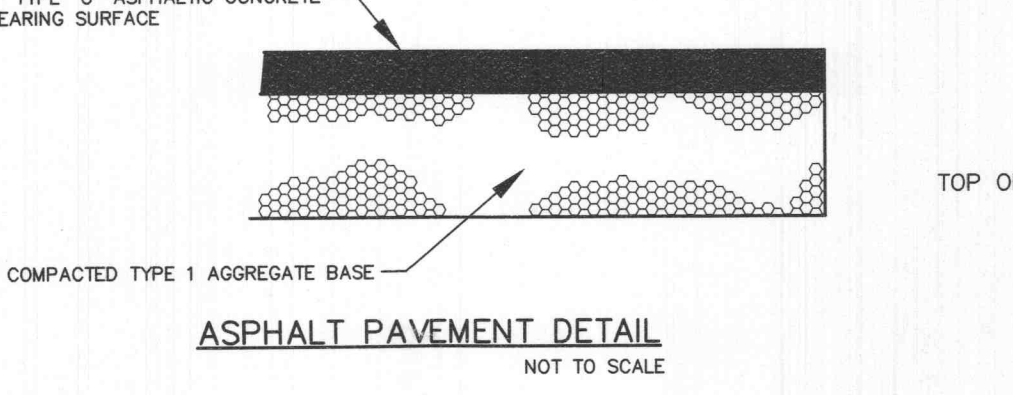

1. TRASH ENCLOSURE PLAN NOT TO SCALE  
 2. ELEVATION NOT TO SCALE  
 3. ELEVATION NOT TO SCALE

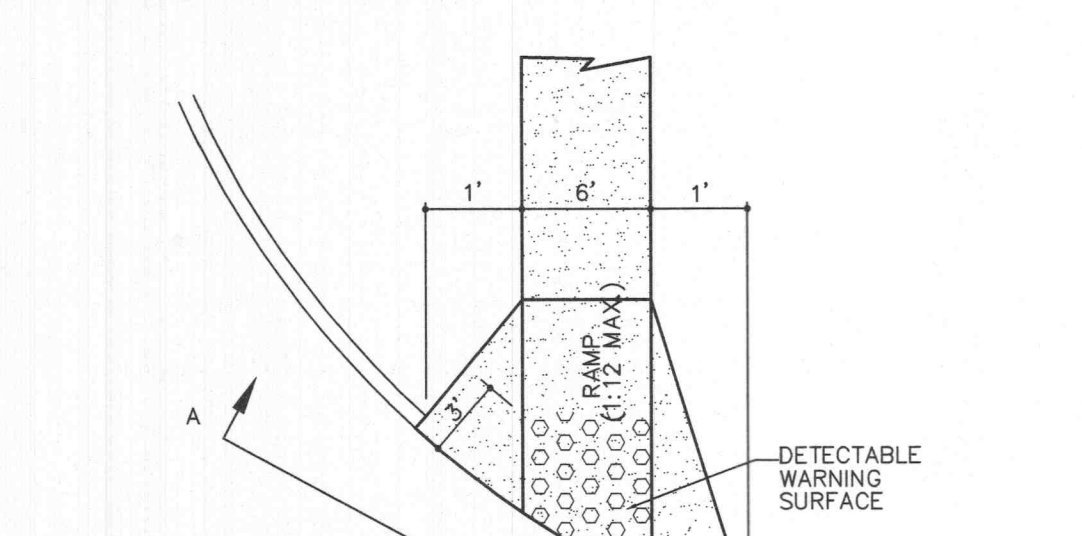

FLARED SIDE RAMP (1:12 MAX.) FLARED SIDE

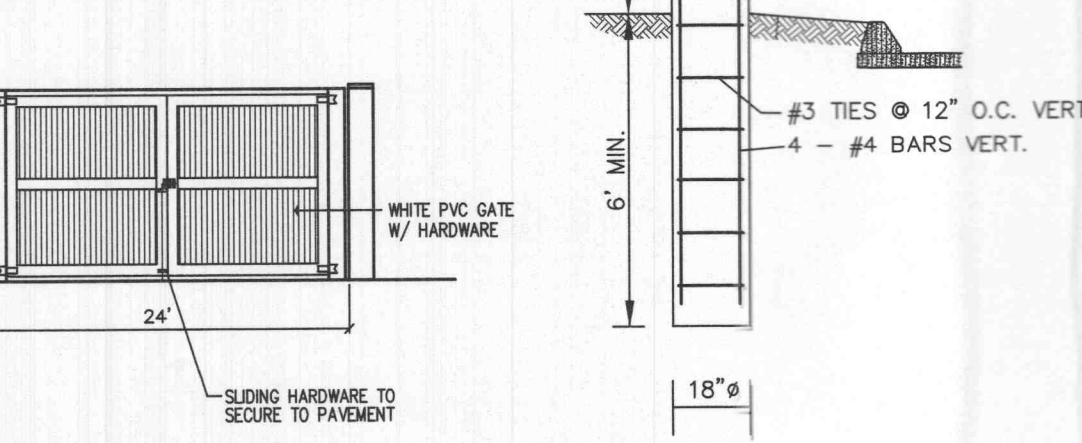
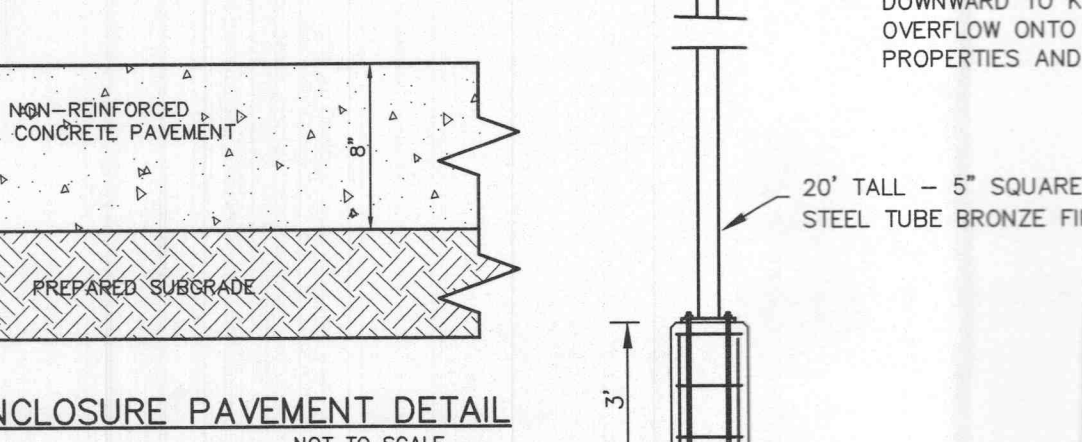
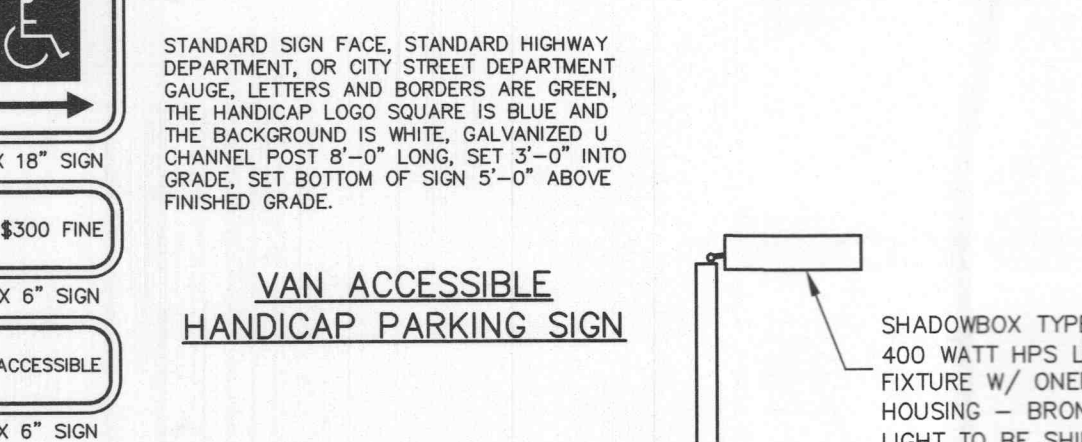
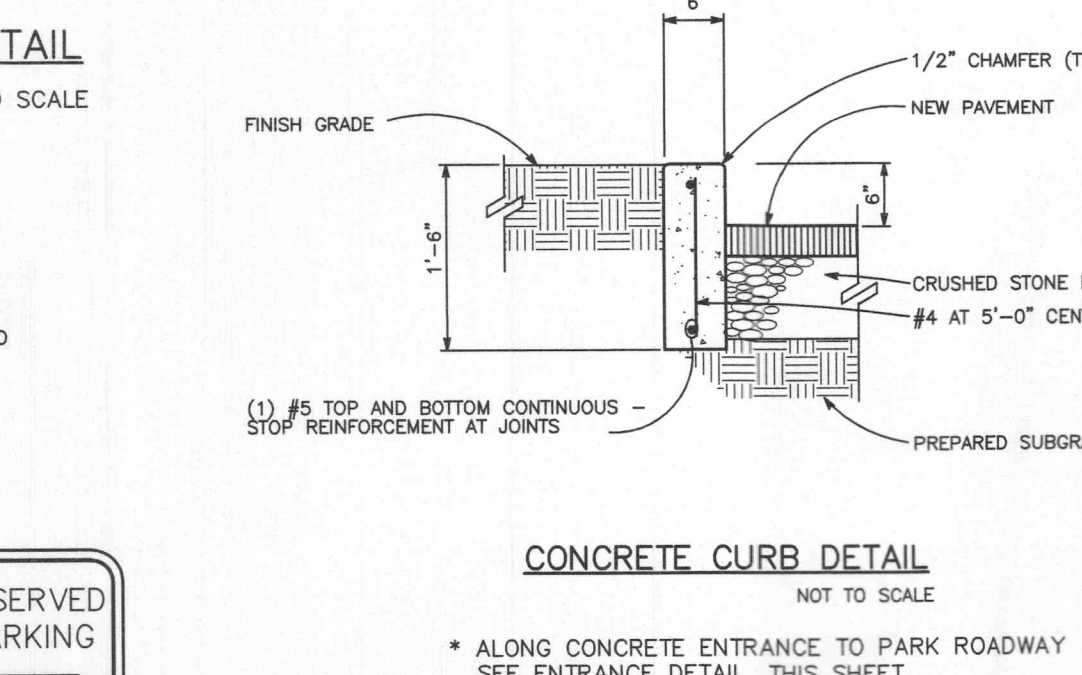
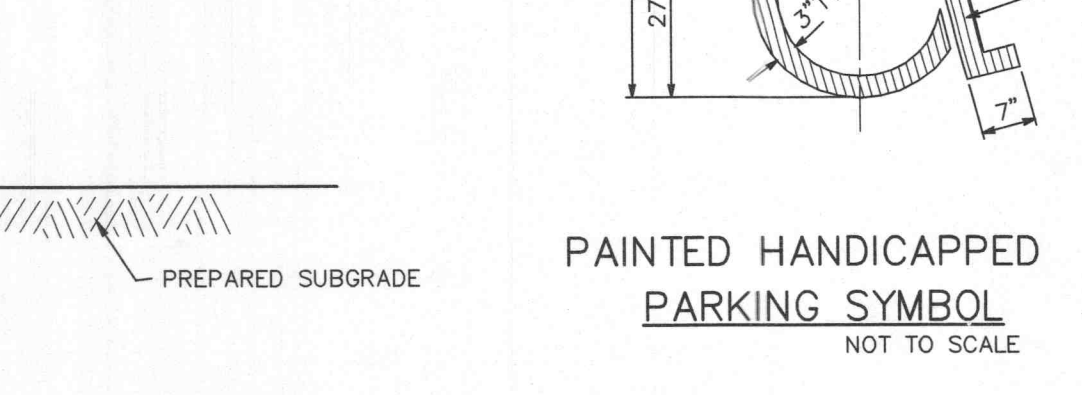
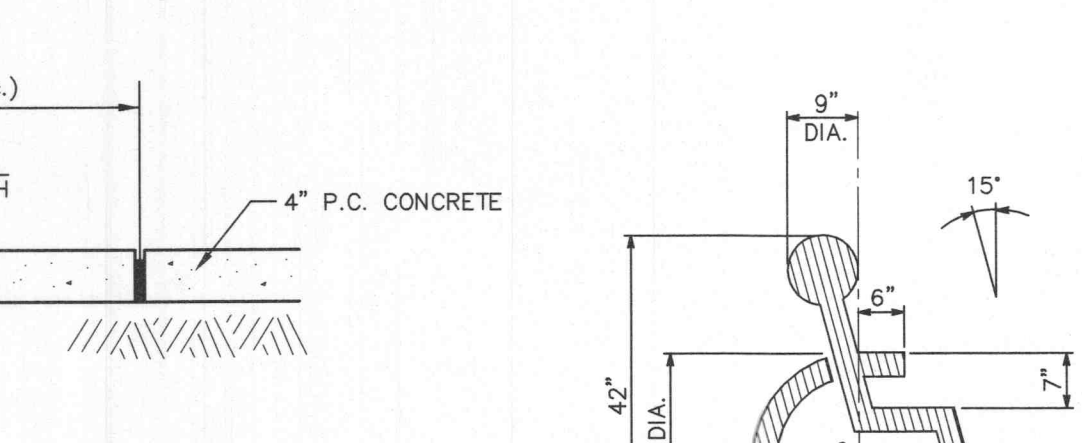
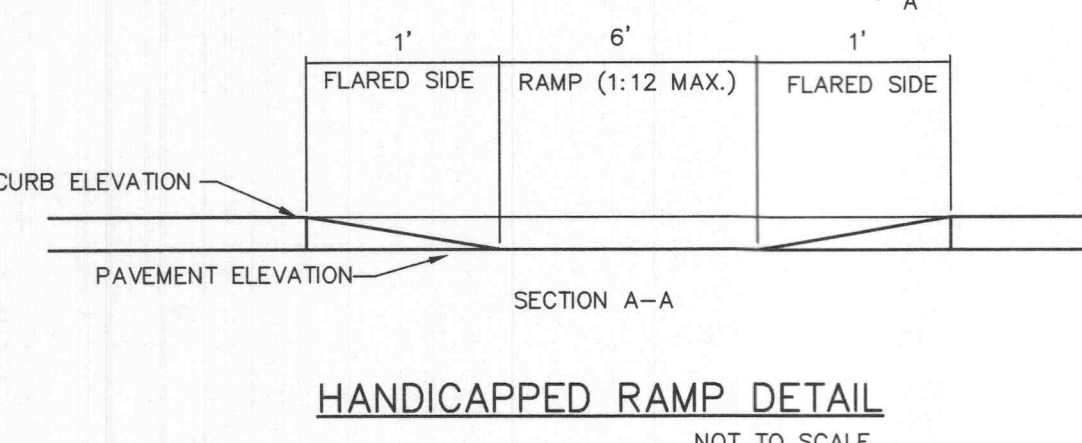

1. TRASH ENCLOSURE PLAN NOT TO SCALE  
 2. ELEVATION NOT TO SCALE  
 3. ELEVATION NOT TO SCALE

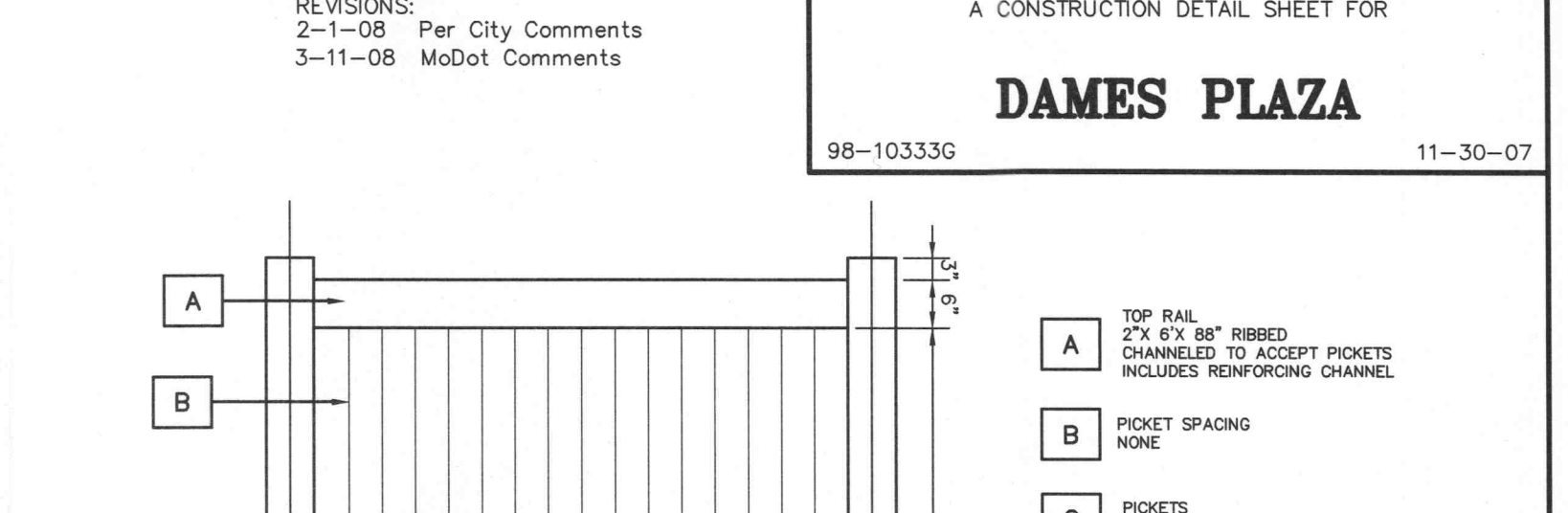

CONC. SIDEWALK  
 ASPHALT PAVEMENT TO BE FLUSH W/ WALK (SEE PLAN FOR DISTANCE)  
 CONC. WHEELSTOP (TYP.)

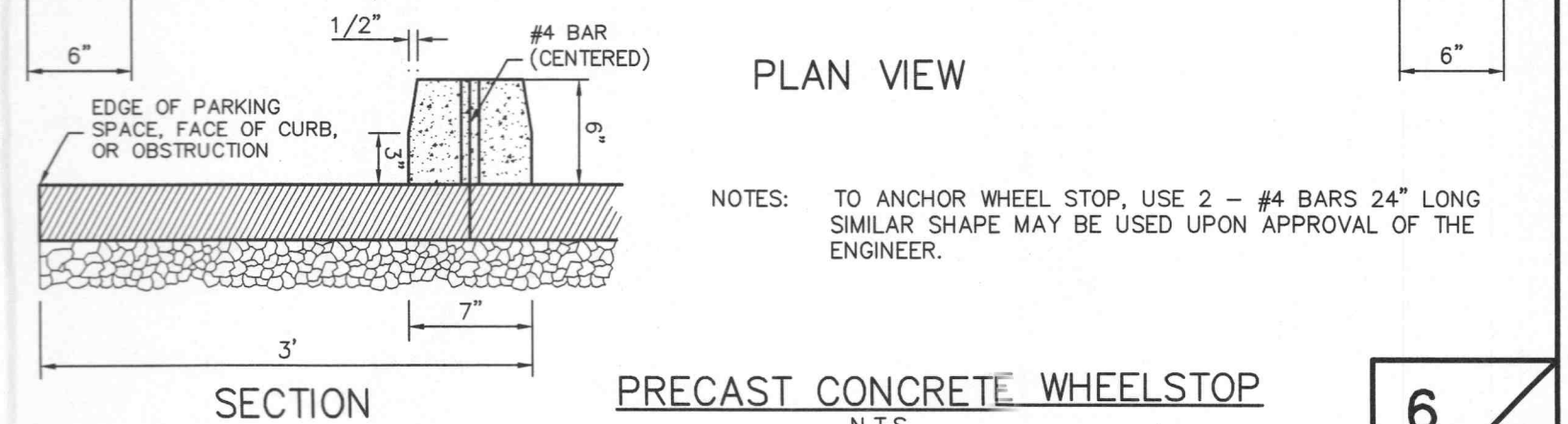
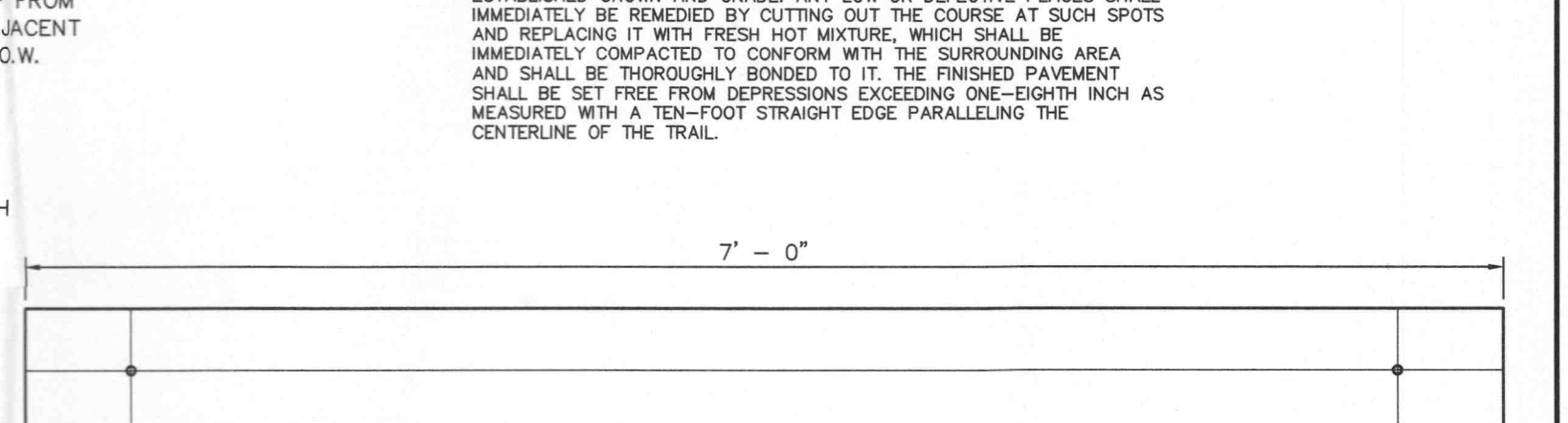
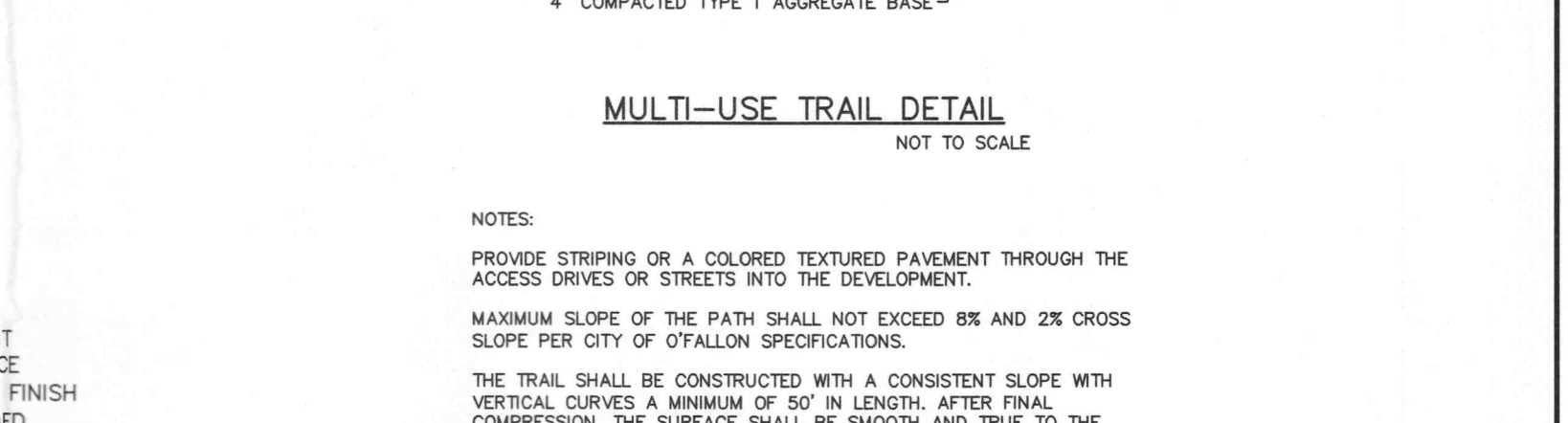
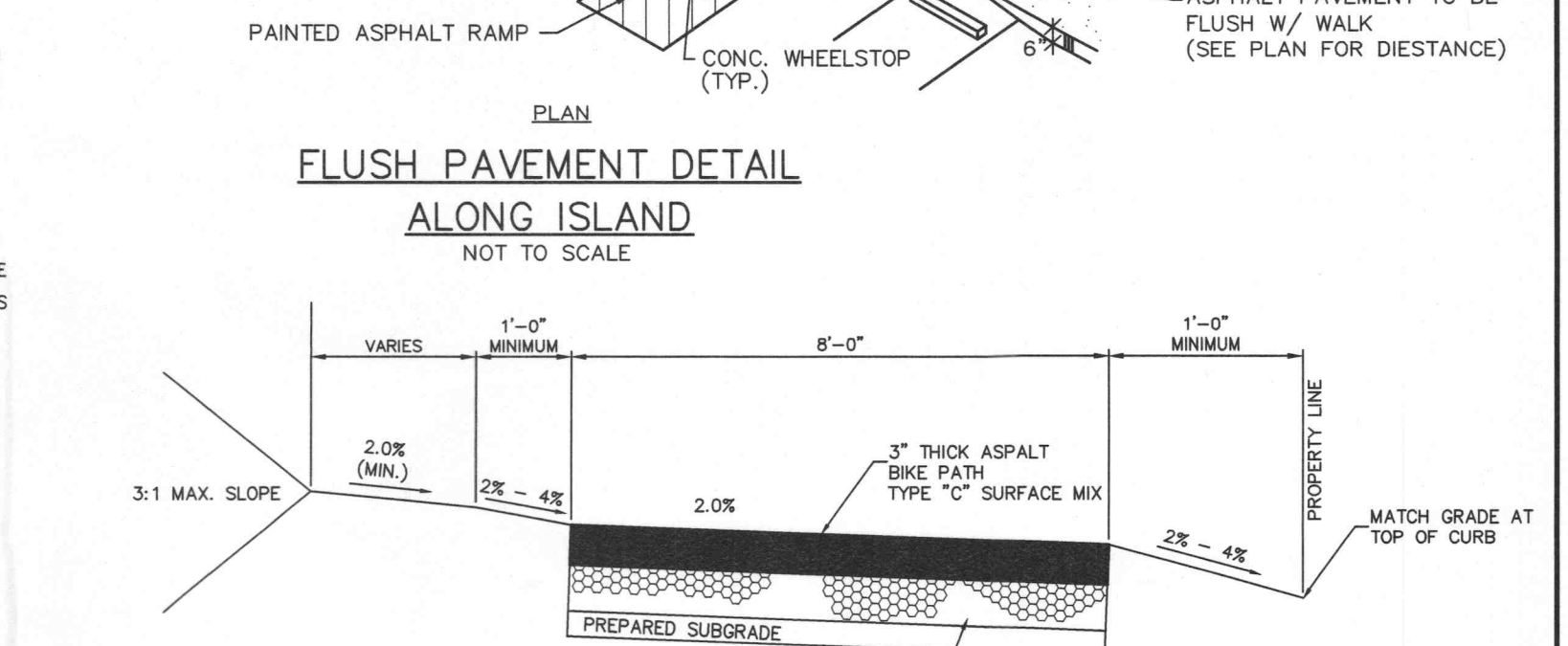
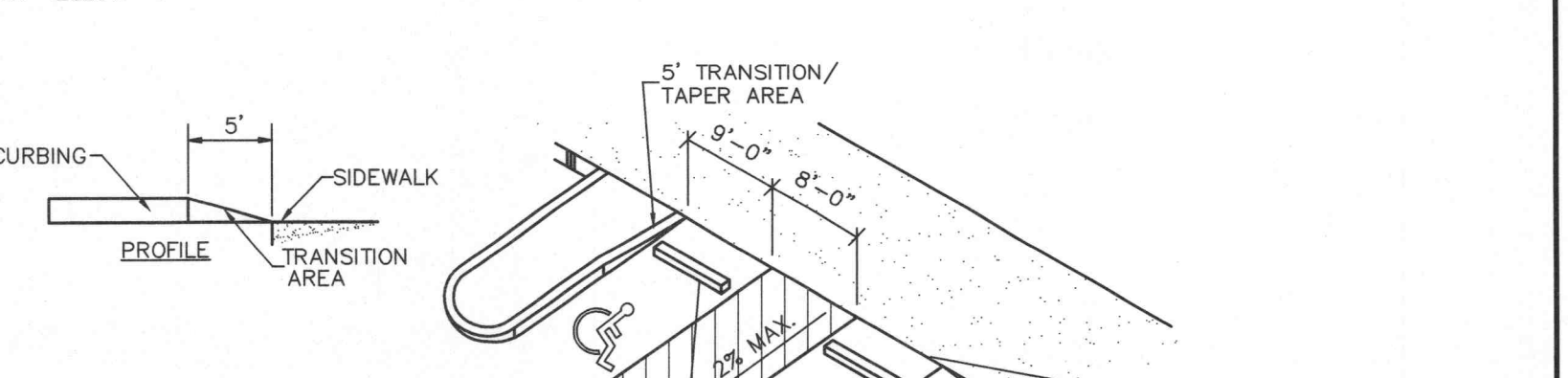
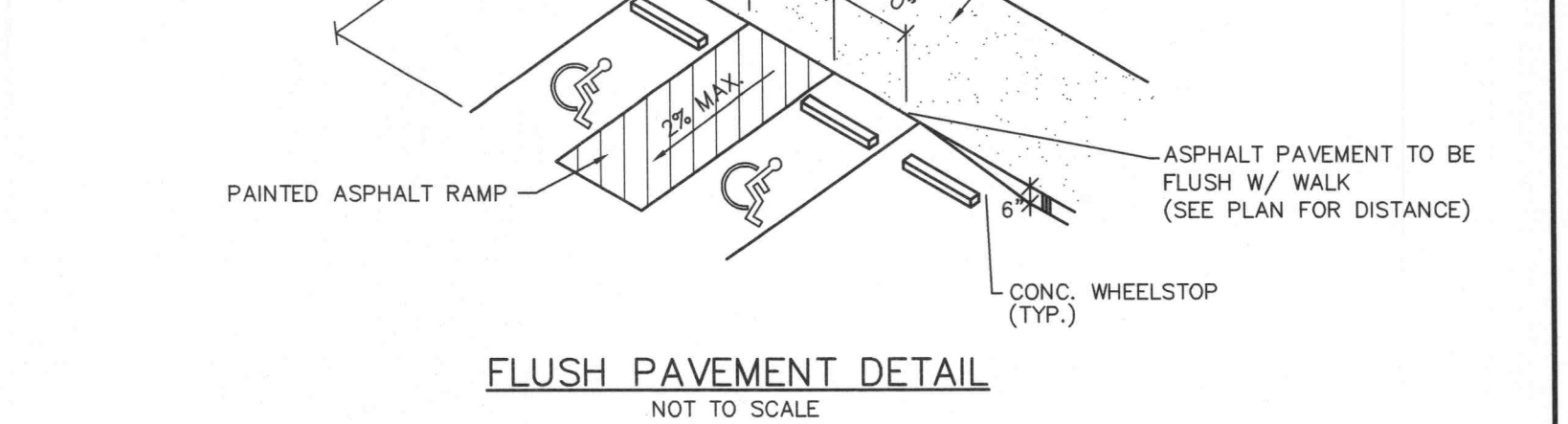
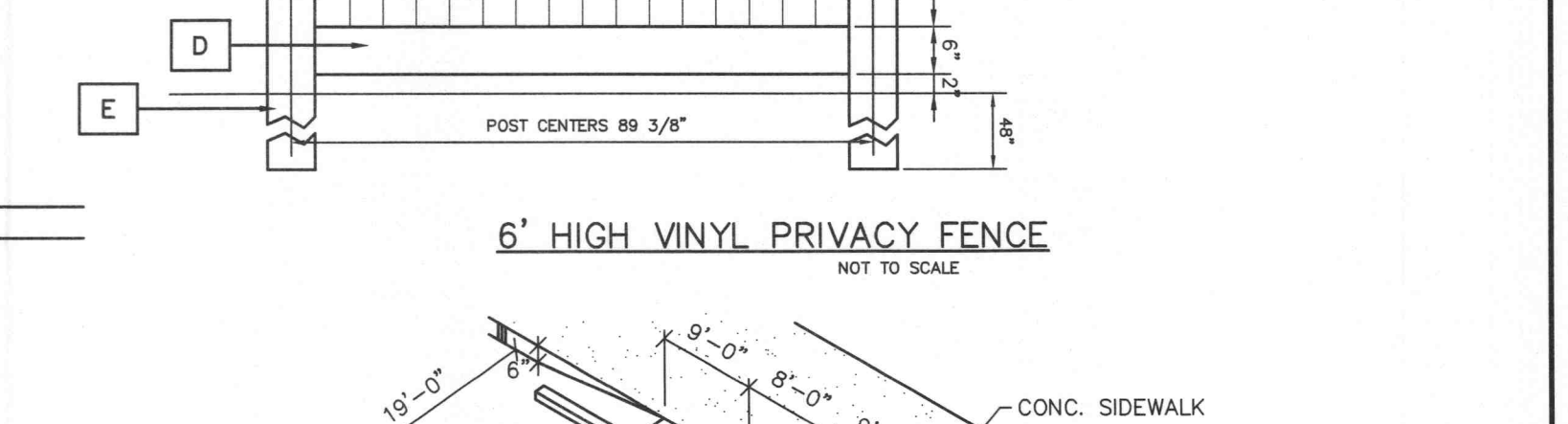

1. TRASH ENCLOSURE PLAN NOT TO SCALE  
 2. ELEVATION NOT TO SCALE  
 3. ELEVATION NOT TO SCALE

REVISIONS:  
 2-1-08 Per City Comments  
 3-11-08 MoDot Comments

A CONSTRUCTION DETAIL SHEET FOR  
**DAMES PLAZA**  
 98-10333G 11-30-07

- A TOP RAIL 2" X 6" X 88" RIBBED CHANNELLED TO ACCEPT PICKETS. INCLUDES REINFORCING CHANNEL.
- B PICKET SPACING NONE
- C PICKETS 28 PIECES OF 7/8" X 30-1/2"
- D BOTTOM RAIL 2" X 6" X 88" RIBBED CHANNELLED TO ACCEPT PICKETS. INCLUDES REINFORCING CHANNEL.
- E POST 2" X 6" X 120" FOR IN GROUND INSTALLATION. 5" X 6" X 84" FOR ABOVE GROUND INSTALLATION.

PRECAST CONCRETE WHEELSTOP N.T.S.

P & Z # 1702.03 APPROVED 11/01/07

E:\DWG\A10000PLUS\103333G-Dames Plaza\Construction\103333G.con.dwg, detail(6), 3/11/2008 3:11:38 PM, Station 28 ALL