

MISSOURI STATE HIGHWAY "P"
 SPEED LIMIT = 50 M.P.H.

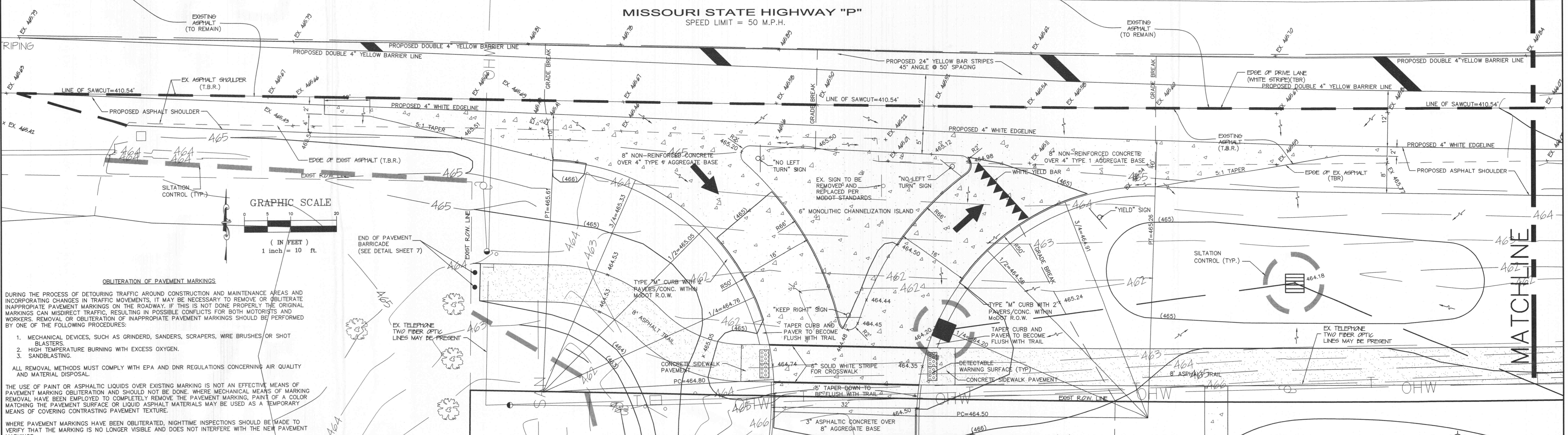

ENTRANCE/ROAD DETAIL

- * ALL SPOTS ARE TO TOP OF PAVEMENT UNLESS OTHERWISE NOTED
- * ALL LANE LINES SHALL BE EPOXY
- * ALL STOP BARS AND ARROWS SHALL BE HOT TAPE

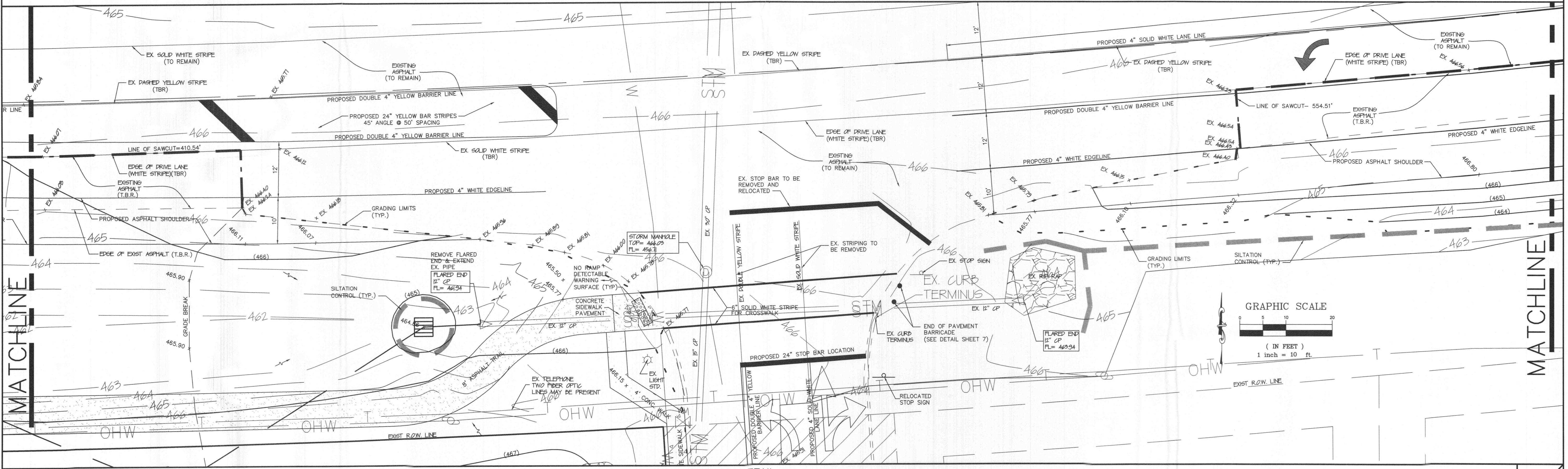

ROAD DETAIL

- * ALL SPOTS ARE TO TOP OF PAVEMENT UNLESS OTHERWISE NOTED
- * ALL LANE LINES SHALL BE EPOXY
- * ALL STOP BARS AND ARROWS SHALL BE HOT TAPE

UNDERGROUND UTILITIES HAVE BEEN PLOTTED FROM AVAILABLE INFORMATION AND THEREFORE THEIR LOCATIONS SHALL BE CONSIDERED APPROXIMATE ONLY. THE VERIFICATION OF THE LOCATION OF ALL UNDERGROUND UTILITIES, EITHER SHOWN OR NOT SHOWN ON THESE PLANS SHALL BE THE RESPONSIBILITY OF THE CONTRACTOR, AND SHALL BE LOCATED PRIOR TO ANY GRADING OR CONSTRUCTION OF THE IMPROVEMENTS.

E:\DWG\10000PLUS\10333G-Constr action\10333GCon.dwg, detail(8), 3/25/2008 1:38:51 PM, Station 28 ALJ