

C-300_Site2_2306_DardenneCreek_PLAN

5/2/24

Path: P:\2306 - ST CHARLES COUNTY - Dardenne Creek Blueway\CAD\Plans
Plotted on: 5/2/24 @ 4:07:18 PM by JENNA STOMBAUGH

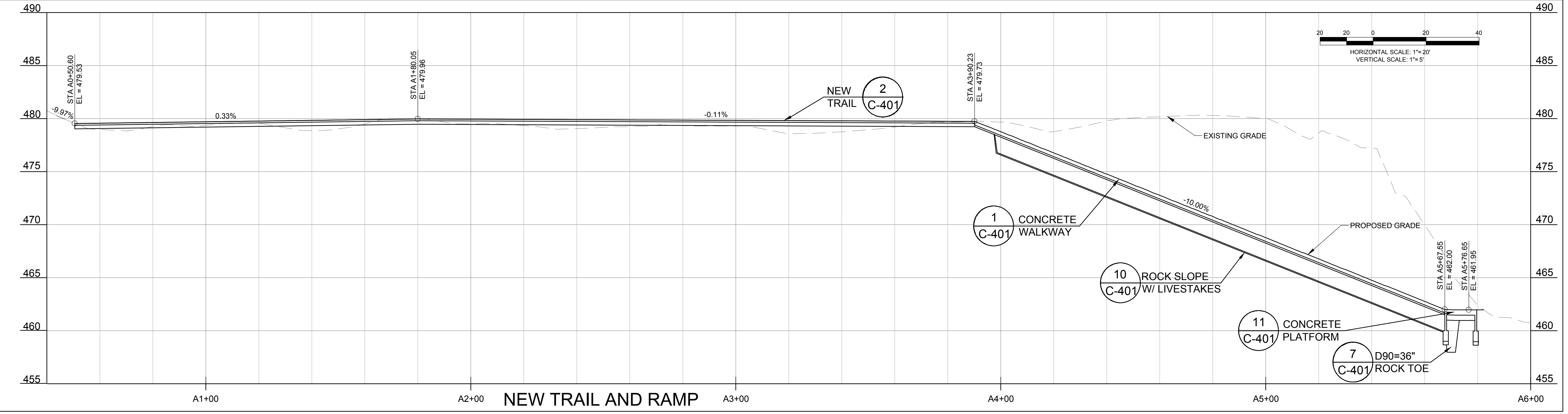
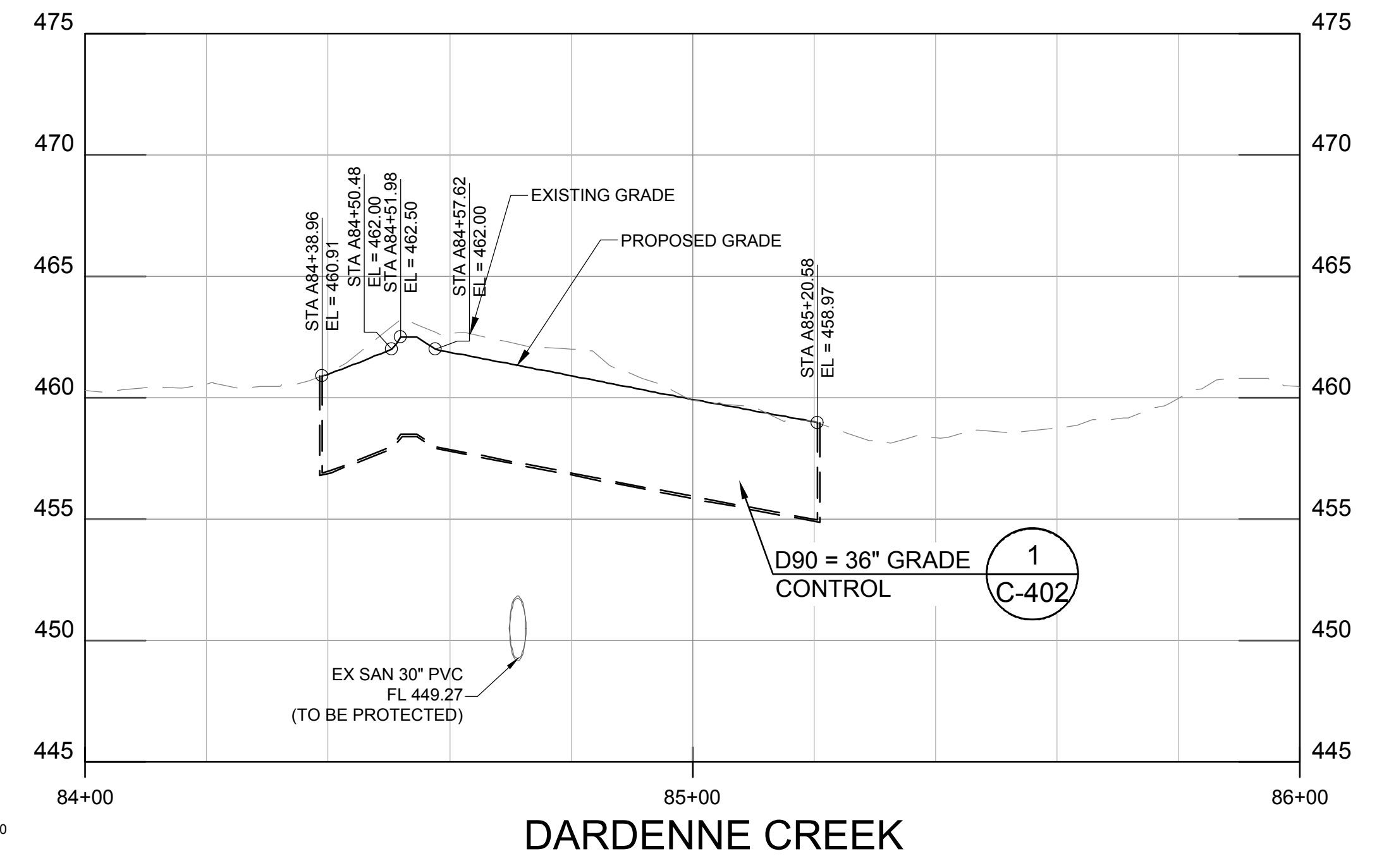
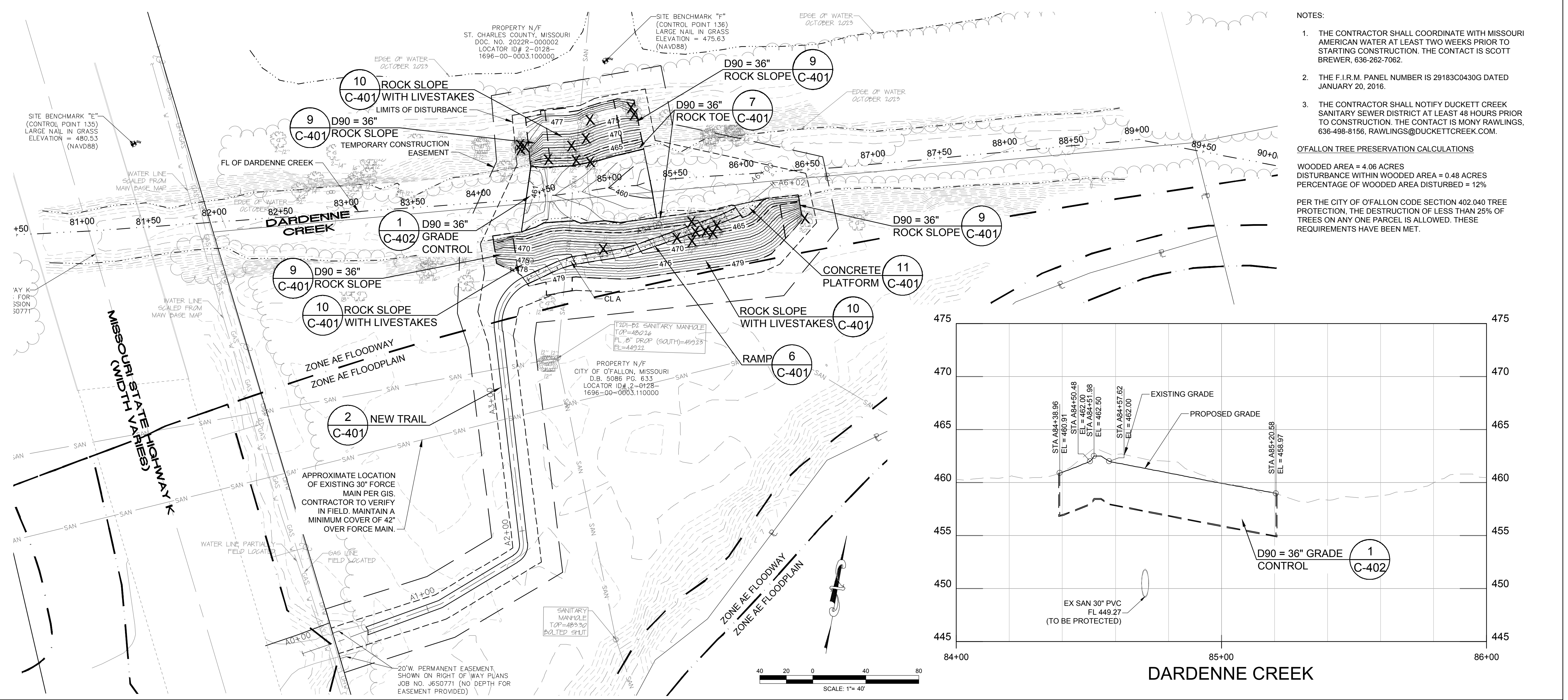

- NOTES:
1. THE CONTRACTOR SHALL COORDINATE WITH MISSOURI AMERICAN WATER AT LEAST TWO WEEKS PRIOR TO STARTING CONSTRUCTION. THE CONTACT IS SCOTT BREWER, 636-262-7062.
 2. THE F.I.R.M. PANEL NUMBER IS 29183C0430G DATED JANUARY 20, 2016.
 3. THE CONTRACTOR SHALL NOTIFY DUCKETT CREEK SANITARY SEWER DISTRICT AT LEAST 48 HOURS PRIOR TO CONSTRUCTION. THE CONTACT IS MONY RAWLINGS, 636-498-8156, RAWLINGS@DUCKETTCREEK.COM.

O'FALLON TREE PRESERVATION CALCULATIONS
 WOODED AREA = 4.06 ACRES
 DISTURBANCE WITHIN WOODED AREA = 0.48 ACRES
 PERCENTAGE OF WOODED AREA DISTURBED = 12%
 PER THE CITY OF O'FALLON CODE SECTION 402.040 TREE PROTECTION, THE DESTRUCTION OF LESS THAN 25% OF TREES ON ANY ONE PARCEL IS ALLOWED. THESE REQUIREMENTS HAVE BEEN MET.



INTUITION & LOGIC
 & LOGIC
 Intuition & Logic Engineering, Inc.
 M.O. Certificate of Authority
 16253 Swangley Ridge Rd.
 Suite 100
 Chesterfield, MO 63017
 Phone: (636) 777-3000

**DARDENNE CREEK BLUEWAY
 TRAIL AND STREAM
 STABILIZATION - SITE 2**
 Saint Charles County, Missouri

THE PROFESSIONAL WHOSE SIGNATURE AND PERSONAL SEAL APPEAR HEREON ASSUMES RESPONSIBILITY ONLY FOR WHAT APPEARS ON THIS PAGE, AND DISCLAIMS JURISDICTION TO SECTION 302.141 REGARDING ANY RESPONSIBILITY FOR ALL OTHER PLANS OR SPECIFICATIONS, PERMITS, REPORTS, OR OTHER DOCUMENTS OR INSTRUMENTS NOT SEALED BY THE UNDERSIGNED PROFESSIONAL RELATING TO OR REFERRED TO BE USED FOR ANY PART OR PARTS OF THE PROJECT TO WHICH THIS PAGE REFERS.

Professional Engineer Seal
 Timothy Patrick Dean - Engineer
 MO# E-2008019536



Expiration Date: DEC. 31, 2024

Rev	Date	Description

Date: _____
 Drawn by: JMS
 Checked by: MSA
 Approved by: TPD

PROJECT NO. 2306

SHEET TITLE:
 PLAN AND PROFILE

SHEET NUMBER:
C-301