

DEERFIELD ESTATES PLAT TWO

GENERAL NOTES

1. All sewer structures and appurtenances to conform to the current specifications of The City of O'Fallon, Missouri.
2. All sewer construction methods to conform to latest standards and specifications of The City of O'Fallon Plumbing Code.
3. After all sewers and appurtenances are completed, inspected and accepted, the contractor will be permitted to connect the sewer extension into the existing system, in the presence of Inspector.
4. Jointing material for vitrified clay sanitary sewers shall conform to ASTM Specification C-594, Type B.
5. Jointing material for poly-vinyl chloride (PVC) sanitary sewers shall conform to ASTM Specification D-3212.
6. All vitrified clay pipe shall conform to ASTM Specification C-700.
7. All poly-vinyl chloride (PVC) pipe shall conform to ASTM-D-3034, Type PSM with a SDR rating of 35, or lower.
8. Sewer manhole frame and cover to be Clay and Bailey No. 2008 or Neenah R 1736 or Deeter 1315 or approved equal.
9. Trenches under existing paving and under areas to be paved, shall be gradually backfilled with 3/4" minus granular material of adequate gradation for proper compaction.
10. In all areas where sewer and appurtenances are to be constructed in filled ground, the fill will be placed to approximate finish grade and compacted to 90% of maximum dry density, prior to the excavating and installing pipe.
11. The sewer contractor may construct the building sewer laterals in conjunction with the sanitary main, trunk or lateral sewers, within a development, so long as the building sewer lateral terminates five (5) feet, or more outside the proposed, or existing building line or foundation wall.
12. All fill areas to be compacted to the soils engineer's specifications, unless by separate written agreement to the contrary.
13. It shall be the grading contractor's responsibility to notify the soils engineer of work in progress and to comply with the specifications by the soils engineer with regards to compaction, surface preparation and placement of fill areas.
14. All stumps, limbs and other debris are to be removed from the site unless a suitable dump area is approved in advance by the soils engineer or if burning is approved.
15. All grading adjustments must be submitted in writing and approved by the site engineer and noted in the records.
16. All swales with longitudinal slopes of two percent or greater are to be sodded. Other slopes may be seeded or sodded.
17. All rough grading is to be completed within $\pm 0.2'$; all subgrade $\pm 0.1'$.
18. It is the developer's responsibility to maintain all silt-barms as provided.
19. It is the contractor's responsibility to provide the location of existing utilities and/or underground facilities by notifying utility companies prior to construction.
20. Gas, water, or other underground utilities shall not conflict with the depth or horizontal location of existing and proposed sanitary and storm sewers including house laterals.
21. Underground utilities have been plotted from available information and therefore their locations must be considered approximate only. The verification of the location of all underground utilities, either shown or not shown on these plans shall be the responsibility of the contractor and shall be located prior to grading or construction of improvements.
22. All manhole and inlet tops built without elevations furnished by the engineer will be the responsibility of the Sewer Contractor. At the time of construction stake-out of the sewer lines, all curb and grate inlets will be face staked, provided said stakes do not fall in the ditch line. If stakes fall within the ditch line the sewer company or job superintendent shall notify the engineer by phone that stakes are needed and allow 48 hours for cuts.
23. All standard street curb inlets to have face of inlet 2' (foot) behind back of curb.
24. All sanitary house connections have been designed so that the minimum vertical distance from the flow line of a sanitary sewer at the corresponding house connection is not less than the diameter of the pipe plus a vertical distance of 2 1/2 feet. All sanitary laterals to be installed at a minimum slope of 2.0 percent.
25. All filled placed, including trench backfills, under buildings, proposed storm and sanitary sewer lines and/or paved areas, shall be compacted to 90% of maximum density as determined by the "Modified AASHTO T-180 Compaction Test," (ASTM D-1557) unless otherwise required in the soils report for this project.
26. Trench backfills under paved areas shall be granular backfill.
27. No area shall be cleared without permission of the developer.
28. For Temporary Barricades see detail #66.
29. A trust indenture shall be established for maintenance of Cul-de-sac islands including the 6" vertical curb and all common ground when applicable.
30. When PVC pipe is used, appropriate rubber seal waterstop, as approved by the sewer district, shall be installed between PVC pipe and masonry (concrete and brick) structure.

All construction and materials used shall conform to current City of O'Fallon Standards.

Brick Drop manholes are not allowed.

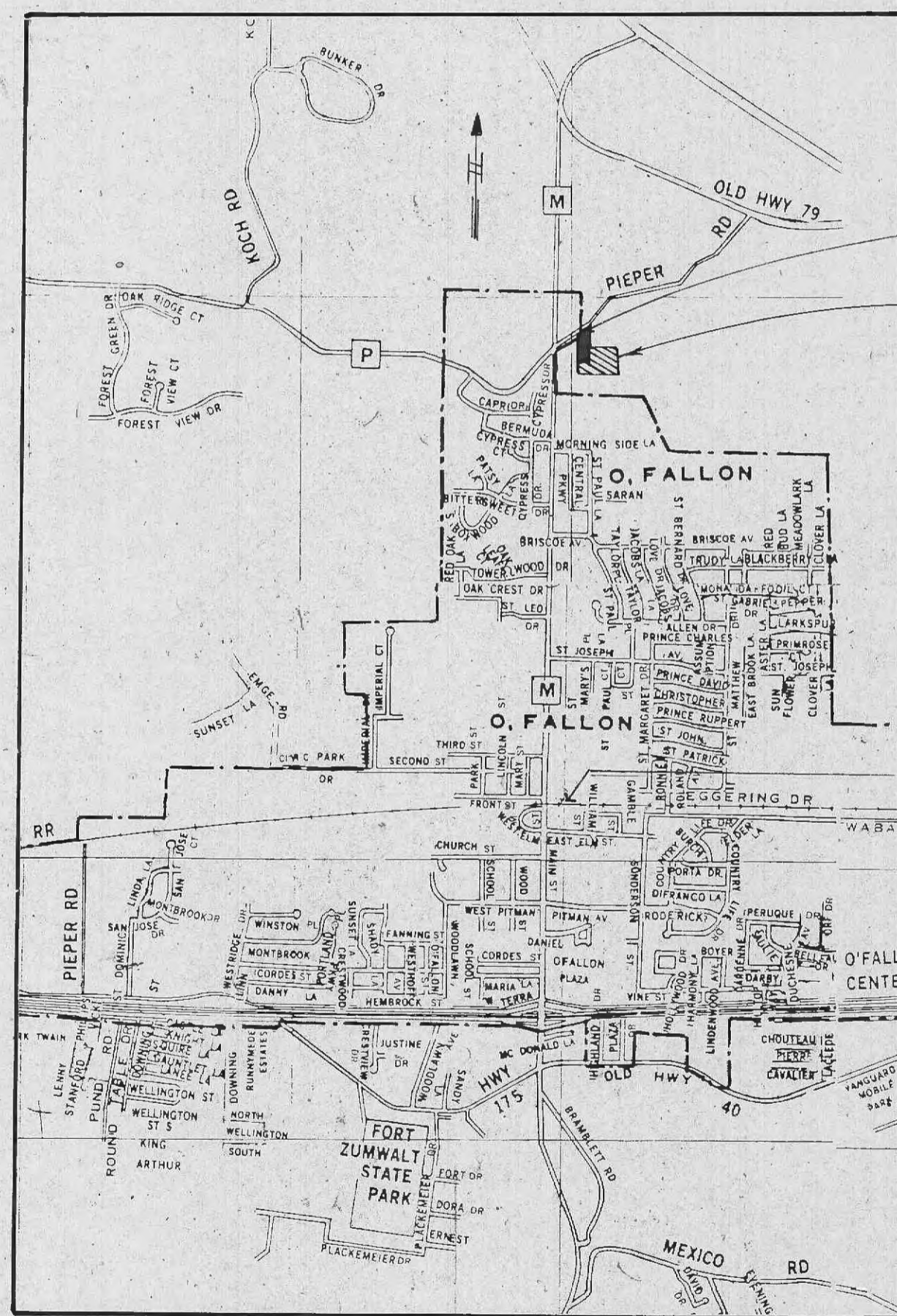

Proj. B.M. - PK nail in roof, west side of 35" maple tree. Elev. 476.807.

B.M. - USGS. F149-1985 Elev. 522.857

INDEX

SHEET 1	- SITE PLAN, WATER MAIN
SHEET 2	- STREET PROFILE
SHEET 3	- STREET PROFILE
SHEET 4	- STORM SEWER PROFILE
SHEET 5	- STORM SEWER PROFILE
SHEET 6	- SANITARY SEWER PROFILE
SHEET 7	- SANITARY SEWER PROFILE
SHEET 8	- DRAINAGE AREA MAP
SHEET 9	- GRADING PLAN
SHEET 10	- BOX CULVERT DETAIL
SHEET 11	- PLAN PROFILE HIGHWAY 'M'
SHEET 12	- CROSS SECTIONS HIGHWAY 'M'
SHEET 13	- CALC PLAT
CONSTRUCTION DETAILS - WI	- WATER MAIN DETAILS
CD1 - CD5	CONSTRUCTION DETAILS
SC1	SILATION CONTROL

Approved GBA-GRW
5-20-86

Rec'd 5-13-86 GBA

IMPROVEMENT PLANS

DEERFIELD DEVELOPMENT CO
901 BOONSLICK
ST. CHARLES, MO. 63301 (314) 441-7923

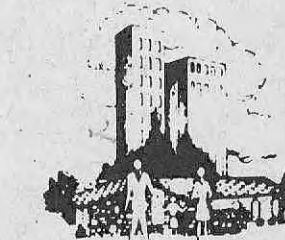

THE STERLING COMPANY
ENGINEERS SURVEYORS PLANNERS
3460 HOLLENBERG DRIVE BRIDGETON, MO 63044
314-739-0440

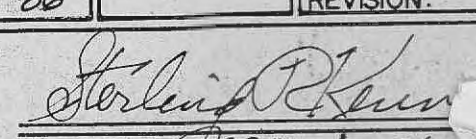
JOB NO: 86-02-407	DESIGNER / DRAFTSMAN: T. CARAG	DATE: APRIL '86	CHECKED BY:	REVISION:
 T. CARAG 5-243 LS 94				