

Materials List:

9	Red Sunset Maple	2.5-3"
3	Cleveland Select Pear	2.5-3"
7	Austrian Pine	8'
2	Dwf. Burning Bush	18-24"
27	Boxwood	5 Gal.
18	Goldflame Spirea	5 Gal.
3	Dwf. Fountain Grass	5 Gal.
3	Knockout Rose	3 Gal.
319	Daylily	1 Qt.
16	Cu. Yds. Bark Mulch	
8	Cu. Yds. Compost	

Landscape Requirements:

- One (1) tree shall be provided for every forty (40) lin. ft. of Street Frontage.
- In addition, one (1) tree shall be provided for every three thousand (3,000) sq. ft. of open are.
- Not less than 6% of Parking Area is to be landscaped.

Calculations:

- 895 Lin. Ft. Street Frontage
- Thirteen (13) Trees Required
- 8,795 Sq. Ft. Open Space
- Three (3) Additional Trees Required
- 7,290 Sq. Ft. of Parking Area
- 438 Sq. Ft. Landscaping Required

Landscape Provided:

- Sixteen (16) Trees Provided (per frontage requirement)
- Three (3) Additional Trees Provided (per open space requirement)
- Five hundred seventy-two (572) Sq. Ft. Landscaping Provided (7.8%) (per parking area requirement)

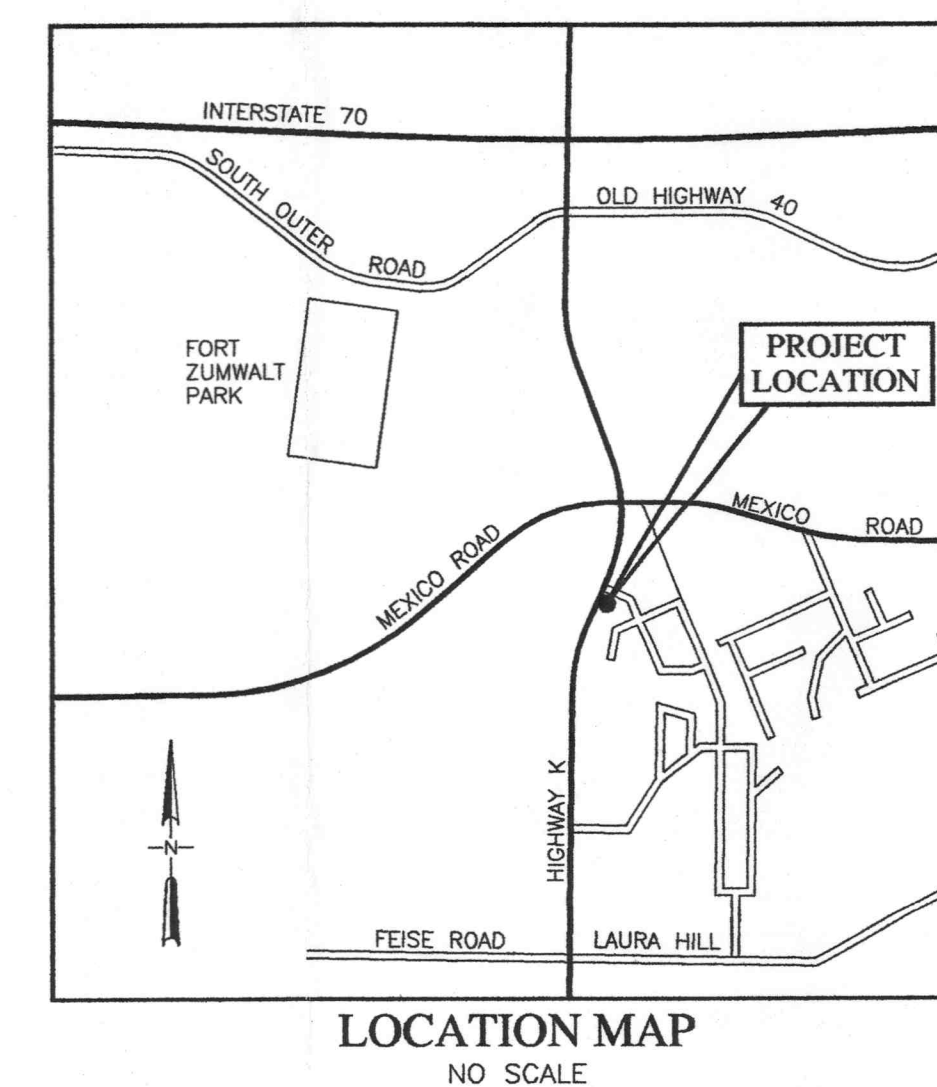

Drawn by:	CJA
Scale:	1/16" = 1'
Date:	10-14-04
Revised:	11-09-04
	11-18-04
	3-18-05

BAXTER FARMS
and NURSERIES
3411 CREVE COEUR MILL ROAD
ST. LOUIS, MISSOURI 63146
314/542-9400

Landscape Planting Plan For:
Del Taco
O'Fallon, Missouri

Drawing Number:
L-1
of one