

SEDIMENT TRAP OVERFLOW DETAIL

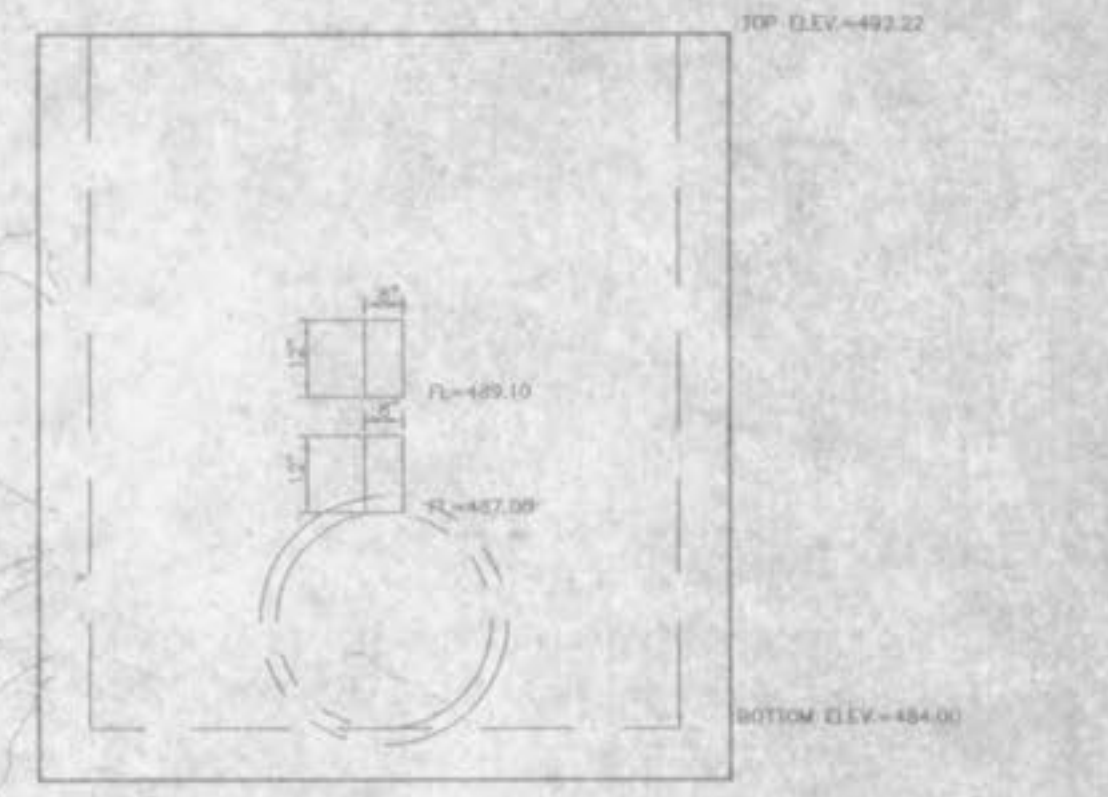
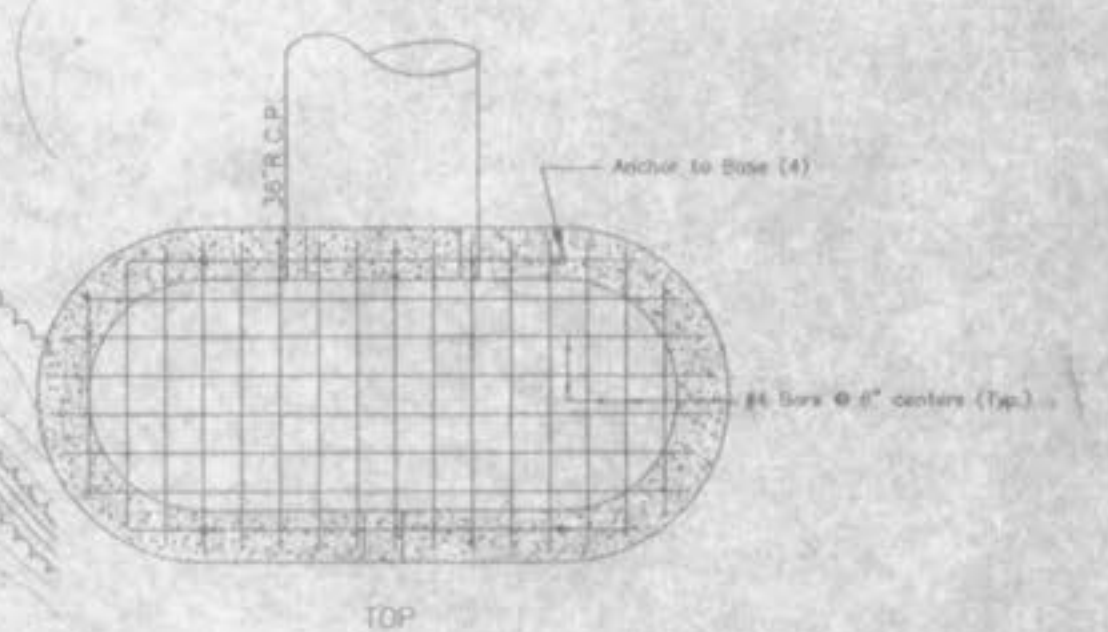

OVERFLOW STRUCTURE (PRECAST DOUBLE INLET BASE)

OVERFLOW STRUCTURE TO BE LOCATED OVER 36" R.P.P. AS CONSTRUCTED WITH COOL SPRINGS ROAD CONSTRUCTION

(GRADING SHOWN EAST OF PROPERTY (COOL SPRINGS EXTENSION) WILL BE BY OTHERS - GRADES FOR COOL SPRING EXTENSION WERE SUPPLIED BY CBA)