

TRAFFIC SIGNAL & INTERCONNECT PLAN

COMMERCIAL ENTRANCES & MISSOURI STATE HWY. K & MISSOURI STATE HWY. N O'FALLON, MISSOURI

DIERBERGS

LEGEND

- 1 COVER SHEET
- 2-6 TRAFFIC SIGNAL PLAN-
MISSOURI STATE HWY K &
COMMERCIAL ENT./ CHRISTINA MARIE
- 7 D-37A
- 8 D-37B
- 9 D-37C
- 10 D-38
- 11 TRAFFIC SIGNAL PLAN-
MISSOURI STATE HWY N &
COMMERCIAL ENTRANCE
- 12 D-37A
- 13 D-37B
- 14 D-37C
- 15 D-38

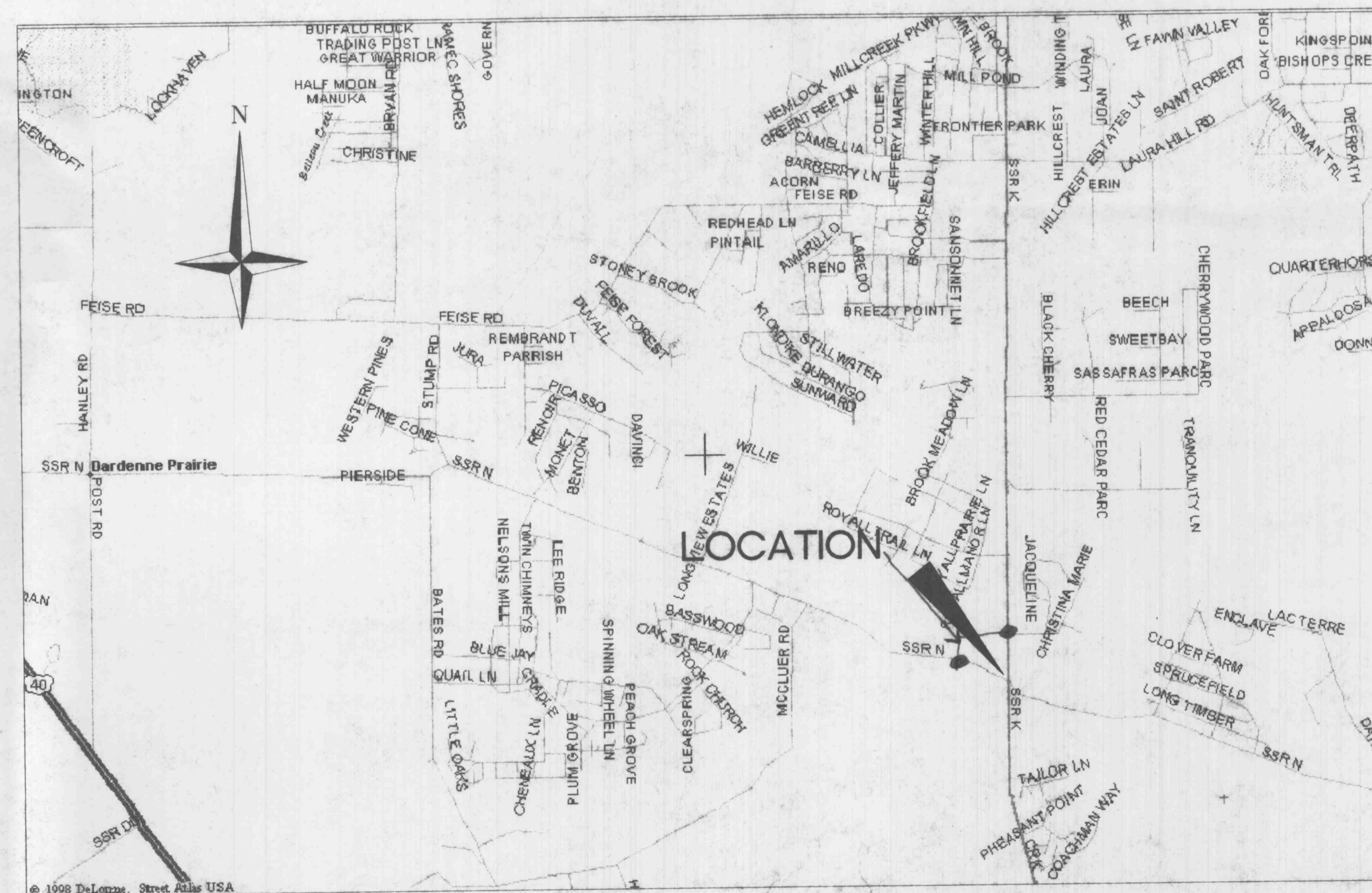

LOCATION MAP
(not to scale)

SHEET NO.	1
Job No.	142-95-1
Date:	11/16/98
Scale:	N.T.S.
Drawn by:	GMW
Design by:	PH
Approved by:	D.B.B.
File Name:	C142-95-1

REVISIONS

PRELIMINARY
DO NOT USE FOR CONSTRUCTION
DATE 1-15-98

CBB Crawford
Bunte
Brammeyer
Traffic and Transportation Engineers
St. Louis, Missouri / Glen Carbon, Illinois
314-878-6644 618-656-2612
Fax: 314-878-5876 E-Mail: cbb@t1.net

COVER SHEET
DIERBERGS
MISSOURI STATE HWY. K &
MISSOURI STATE HWY. N
O'FALLON, MISSOURI