

GENERAL NOTES:

1. THE INSTALLATION OF TRAFFIC SIGNALS SHALL BE IN ACCORDANCE WITH THE MISSOURI HIGHWAY AND TRANSPORTATION COMMISSION'S STANDARD SPECIFICATIONS, LATEST EDITION.
2. THE MISSOURI HIGHWAY AND TRANSPORTATION DEPARTMENT WILL BE RESPONSIBLE FOR SPOTTING THE LOCATION OF ALL LOOP DETECTORS. THE CONTRACTOR SHALL NOTIFY THE DISTRICT TRAFFIC ENGINEER A MINIMUM OF ONE WEEK IN ADVANCE OF THE DESIRED DATE OF LOOP INSTALLATION.
3. TRAFFIC CONTROL SHALL BE THE RESPONSIBILITY OF THE CONTRACTOR AND SHALL CONFORM TO THE MANUAL ON UNIFORM TRAFFIC CONTROL DEVICES AND THE MISSOURI HIGHWAY AND TRANSPORTATION DEPARTMENTS STANDARDS.
4. THE CONTRACTOR SHALL INSPECT THE SITE AND APPROXIMATE LOCATIONS OF ALL EQUIPMENT PRIOR TO BID PREPARATION. IT WILL BE THE CONTRACTORS RESPONSIBILITY TO CHECK FOR ROCK AND GROUND ELEVATIONS FOR ALL BASES. NO EXTRA PAYMENT WILL BE MADE FOR CONSTRUCTING BASES OR TRENCHING OF CONDUIT DUE TO ROCK.
5. DIRECTIONAL BORING MAY BE USED INSTEAD OF TRENCHING OR PUSHING; HOWEVER, NO ADDITIONAL PAYMENT WILL BE MADE.
6. ALL SAW CUTS FOR DETECTOR LOOPS THROUGH PAVEMENT MARKINGS SHALL BE REPAINTED BY THE CONTRACTOR. THIS SHALL BE INCIDENTAL AND NO EXTRA PAYMENT WILL BE MADE.
7. CONTRACTOR SHALL NOT TERMINATE POWER CABLES, OR CONDUIT UNTIL MEETING WITH THE POWER COMPANY TO DETERMINE FINAL LOCATION.

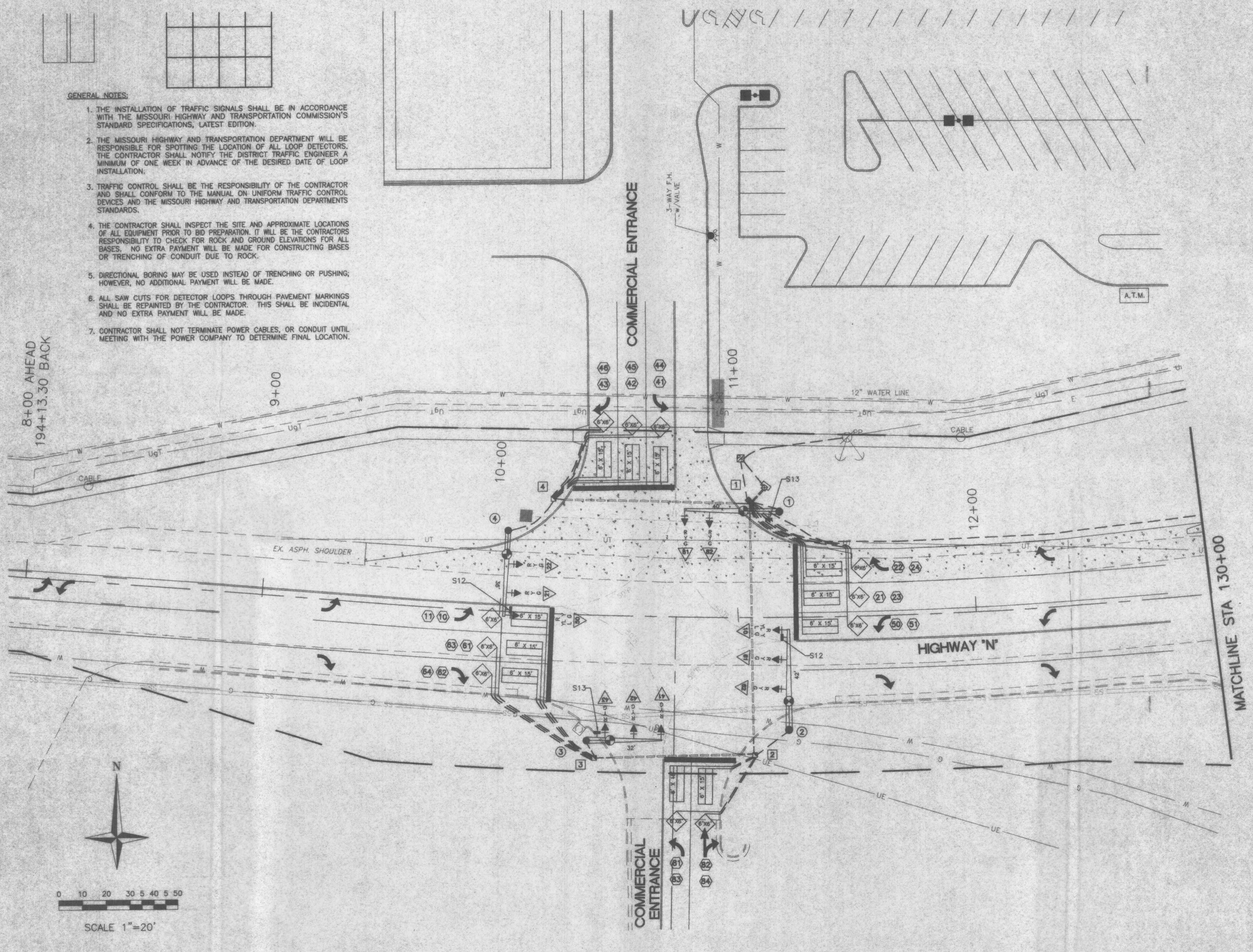

8+00 AHEAD
194+13.30 BACK

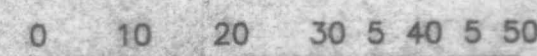
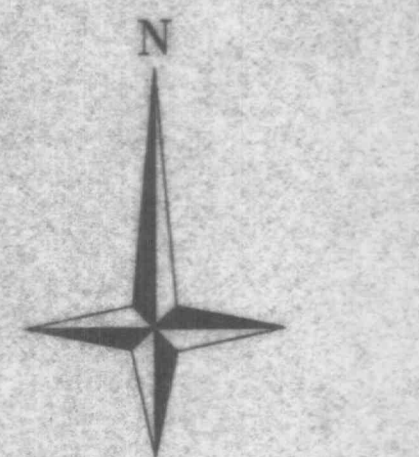

SCALE 1"=20'

SHEET NO.
11
Job No. 142-95-1
Date: 11/15/98
Scale: 1"=20'
Drawn by: C.W.S.
Design by: P.H.
Approved by: D.B.B.
File Name: S142-95-1

REVISIONS

PRELIMINARY
DO NOT USE FOR CONSTRUCTION
DATE 11/15/98

CBB Crawford Bunte Brammiller
Traffic and Transportation Engineers
St. Louis, Missouri / Glen Carbon, Illinois
314-878-6644 618-656-2612
Fax: 314-878-5876 E-Mail: cbb@t1.net

TRAFFIC SIGNAL PLAN
DIERBERG'S
MISSOURI STATE HWY. N &
COMMERCIAL ENTRANCES
O'FALLON, MISSOURI