

SCALE 1"=20'

Note: Caution should be taken in comparing the written scale to the graphic scale to ascertain if this plan has been enlarged or reduced.

--- SILT FENCE OR OTHER EROSION CONTROL BMP

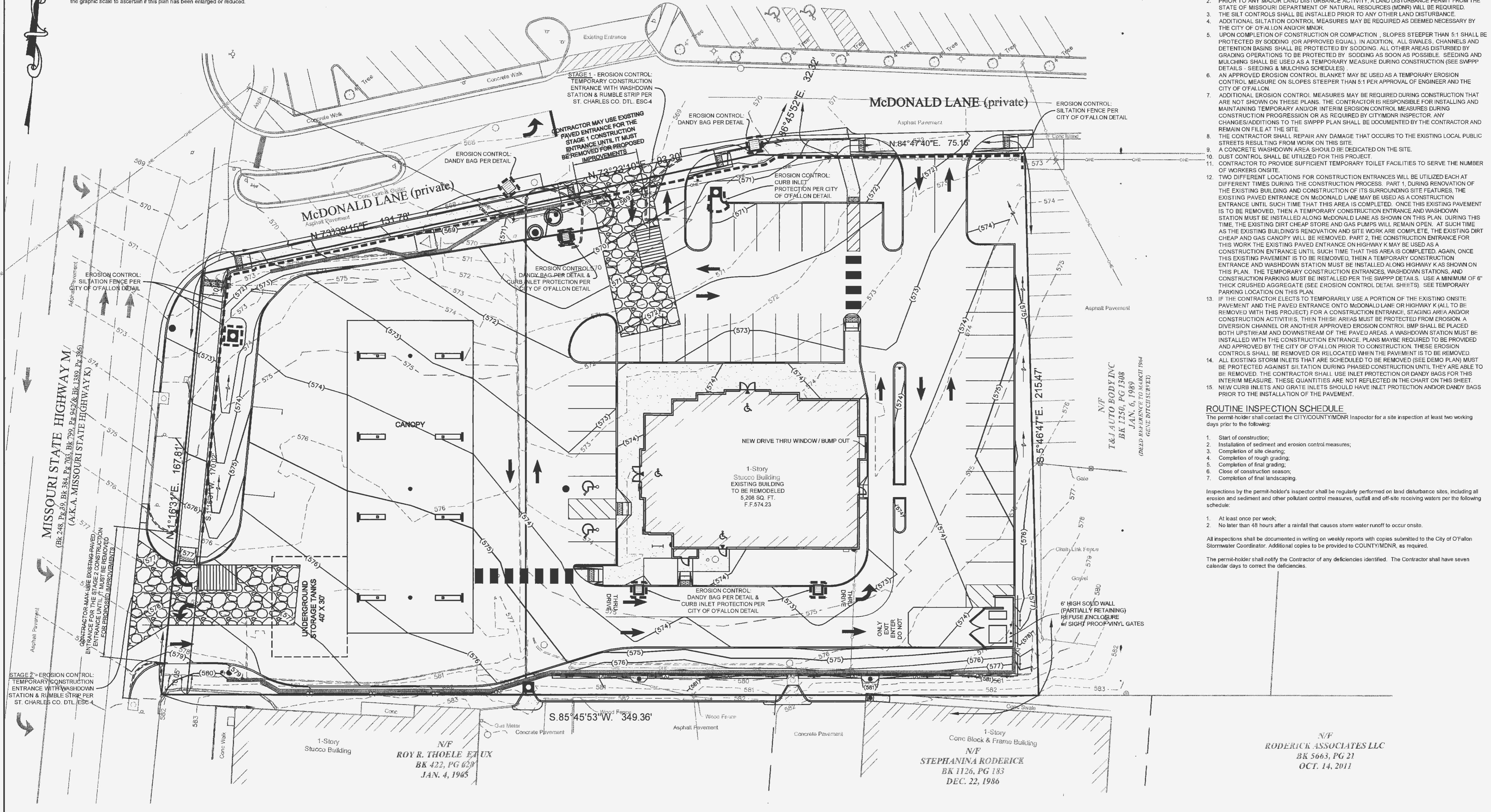

**CONSTRUCTION & EROSION CONTROL NOTES:**

- ANY LAND CLEARING, CONSTRUCTION, OR DEVELOPMENT INVOLVING THE MOVEMENT OF EARTH SHALL BE IN ACCORDANCE WITH THE STORM WATER POLLUTION PREVENTION PLAN, AND THE PERSON ISSUED A LAND DISTURBANCE PERMIT ASSUMES AND ACKNOWLEDGES RESPONSIBILITY FOR COMPLIANCE WITH THE CITY OF O'FALLON LAND DISTURBANCE CODE AND THE APPROVED STORM WATER POLLUTION PREVENTION PLAN AT THE SITE OF THE PERMITTED ACTIVITY.
- PRIOR TO ANY MAJOR LAND DISTURBANCE ACTIVITY, A LAND DISTURBANCE PERMIT FROM THE STATE OF MISSOURI DEPARTMENT OF NATURAL RESOURCES (MNR) WILL BE REQUIRED.
- THE SILT CONTROLS SHALL BE INSTALLED PRIOR TO ANY OTHER LAND DISTURBANCE.
- ADDITIONAL SILTATION CONTROL MEASURES MAY BE REQUIRED AS DEEMED NECESSARY BY THE CITY OF O'FALLON AND/OR MNR.
- UPON COMPLETION OF CONSTRUCTION OR COMPACTION, SLOPES STEEPER THAN 5:1 SHALL BE PROTECTED BY SODDING (OR APPROVED EQUAL). IN ADDITION, ALL SWALES, CHANNELS AND DETENTION BASINS SHALL BE PROTECTED BY SODDING. ALL OTHER AREAS DISTURBED BY GRADING OPERATIONS TO BE PROTECTED BY SODDING AS SOON AS POSSIBLE. SEEDING AND MULCHING SHALL BE USED AS A TEMPORARY MEASURE DURING CONSTRUCTION (SEE SWPPP DETAILS - SEEDING & MULCHING SCHEDULES).
- AN APPROVED EROSION CONTROL BLANKET MAY BE USED AS A TEMPORARY EROSION CONTROL MEASURE ON SLOPES STEEPER THAN 5:1 PER APPROVAL OF ENGINEER AND THE CITY OF O'FALLON.
- ADDITIONAL EROSION CONTROL MEASURES MAY BE REQUIRED DURING CONSTRUCTION THAT ARE NOT SHOWN ON THESE PLANS. THE CONTRACTOR IS RESPONSIBLE FOR INSTALLING AND MAINTAINING TEMPORARY AND/OR INTERIM EROSION CONTROL MEASURES DURING CONSTRUCTION PROGRESSION OR AS REQUIRED BY CITY/MNR INSPECTOR. ANY CHANGES/ADDITIONS TO THE SWPPP PLAN SHALL BE DOCUMENTED BY THE CONTRACTOR AND REMAIN ON FILE AT THE SITE.
- THE CONTRACTOR SHALL REPAIR ANY DAMAGE THAT OCCURS TO THE EXISTING LOCAL PUBLIC STREETS RESULTING FROM WORK ON THIS SITE.
- A CONCRETE WASHDOWN AREA SHOULD BE DEDICATED ON THIS SITE.
- DUST CONTROL SHALL BE UTILIZED FOR THIS PROJECT.
- CONTRACTOR TO PROVIDE SUFFICIENT TEMPORARY TOILET FACILITIES TO SERVE THE NUMBER OF WORKERS ON SITE.
- TWO DIFFERENT LOCATIONS FOR CONSTRUCTION ENTRANCES WILL BE UTILIZED EACH AT DIFFERENT TIMES DURING THE CONSTRUCTION PROCESS. PART 1, DURING RENOVATION OF THE EXISTING BUILDING AND CONSTRUCTION OF ITS SURROUNDING SITE FEATURES, THE EXISTING PAVED ENTRANCE ON McDONALD LANE MAY BE USED AS A CONSTRUCTION ENTRANCE UNTIL SUCH TIME THAT THIS AREA IS COMPLETED. ONCE THIS EXISTING PAVEMENT IS TO BE REMOVED, THEN A TEMPORARY CONSTRUCTION ENTRANCE AND WASHDOWN STATION MUST BE INSTALLED ALONG McDONALD LANE AS SHOWN ON THIS PLAN. DURING THIS TIME, THE EXISTING DIRT CHEAP STORE AND GAS PUMPS WILL REMAIN OPEN. AT SUCH TIME AS THE EXISTING BUILDING'S RENOVATION AND SITE WORK ARE COMPLETE, THE EXISTING DIRT CHEAP AND GAS CANOPY WILL BE REMOVED. PART 2, THE CONSTRUCTION ENTRANCE FOR THIS WORK THE EXISTING PAVED ENTRANCE ON HIGHWAY K MAY BE USED AS A CONSTRUCTION ENTRANCE UNTIL SUCH TIME THAT THIS AREA IS COMPLETED. AGAIN, ONCE THIS EXISTING PAVEMENT IS TO BE REMOVED, THEN A TEMPORARY CONSTRUCTION ENTRANCE AND WASHDOWN STATION MUST BE INSTALLED ALONG HIGHWAY K AS SHOWN ON THIS PLAN. THE TEMPORARY CONSTRUCTION ENTRANCES, WASHDOWN STATIONS, AND CONSTRUCTION PARKING MUST BE INSTALLED PER THE SWPPP DETAILS. USE A MINIMUM OF 6" THICK CRUSHED AGGREGATE (SEE EROSION CONTROL DETAIL SHEETS). SEE TEMPORARY PARKING LOCATION ON THIS PLAN.
- IF THE CONTRACTOR ELECTS TO TEMPORARILY USE A PORTION OF THE EXISTING ON-SITE PAVEMENT AND THE PAVED ENTRANCE ONTO McDONALD LANE OR HIGHWAY K (ALL TO BE REMOVED WITH THIS PROJECT) FOR A CONSTRUCTION ENTRANCE, STAGING AREA AND/OR CONSTRUCTION ACTIVITIES, THEN THESE AREAS MUST BE PROTECTED FROM EROSION. A DIVERSION CHANNEL OR ANOTHER APPROVED EROSION CONTROL BMP SHALL BE PLACED BOTH UPSTREAM AND DOWNSTREAM OF THE PAVED AREAS. A WASHDOWN STATION MUST BE INSTALLED WITH THE CONSTRUCTION ENTRANCE. PLANS MAYBE REQUIRED TO BE PROVIDED AND APPROVED BY THE CITY OF O'FALLON PRIOR TO CONSTRUCTION. THESE EROSION CONTROLS SHALL BE REMOVED OR RELOCATED WHEN THE PAVEMENT IS TO BE REMOVED.
- ALL EXISTING STORM INLETS THAT ARE SCHEDULED TO BE REMOVED (SEE DEMO PLAN) MUST BE PROTECTED AGAINST SILTATION DURING PHASED CONSTRUCTION UNTIL THEY ARE ABLE TO BE REMOVED. THE CONTRACTOR SHALL USE INLET PROTECTION OR DANDY BAGS FOR THIS INTERIM MEASURE. THESE QUANTITIES ARE NOT REFLECTED IN THE CHART ON THIS SHEET.
- NEW CURB INLETS AND GRATE INLETS SHOULD HAVE INLET PROTECTION AND/OR DANDY BAGS PRIOR TO THE INSTALLATION OF THE PAVEMENT.

**ROUTINE INSPECTION SCHEDULE**  
The permit holder shall contact the CITY/COUNTY/MNR Inspector for a site inspection at least two working days prior to the following:

- Start of construction;
- Installation of sediment and erosion control measures;
- Completion of site clearing;
- Completion of rough grading;
- Completion of final grading;
- Close of construction season;
- Completion of final landscaping.

Inspections by the permit-holder's inspector shall be regularly performed on land disturbance sites, including all erosion and sediment and other pollutant control measures, outfall and off-site receiving waters per the following schedule:

- At least once per week;
- No later than 48 hours after a rainfall that causes storm water runoff to occur onsite.

All inspections shall be documented in writing on weekly reports with copies submitted to the City of O'Fallon Stormwater Coordinator. Additional copies to be provided to COUNTY/MNR, as required.

The permit-holder shall notify the Contractor of any deficiencies identified. The Contractor shall have seven calendar days to correct the deficiencies.

**PROJECT TITLE:**  
SITE CONSTRUCTION PLANS  
DIRT CHEAP OF O'FALLON  
#708 MO. STATE HIGHWAY K  
O'FALLON, MISSOURI 63366

Copyright 2014  
Clayton Engineering Co.  
All Rights Reserved

the clayton engineering company, inc.  
11920 Westline Industrial Drive  
St. Louis, MO 63146  
(314) 892-2888  
claytoneng.com  
Job#: 10122

MO Cert. of Authority - Professional Engineering #000097  
& Professional Surveying #000014



Plan Date: November 8, 2013  
Revision Date: April 28, 2014  
Revision Date: May 22, 2014  
Revision Date: August 1, 2014  
Revision Date: Sept. 4, 2014

**Developer / Owner Information:**  
U-GAS PROPERTIES OF FALLON LLC  
895 Bolger Court  
Fenton, Missouri 63026  
(636) 343-9770 FAX: (636) 343-9768

**STORMWATER POLLUTION PREVENTION PLAN**

P+Z No.: (23-13.02)  
Approval Date: 10/03/13  
City No.

Page No.  
**8 of 23**

SCHEDULE OF OPERATIONS - DATE OF WORK TO BEGIN OCTOBER 1, 2014 (OR WITHIN 3 WEEKS AFTER ISSUANCE OF PERMITS)

INSTALLATION OF	OCTOBER	NOVEMBER	DECEMBER	JANUARY	FEBRUARY	MARCH
EROSION / SILT CONTROL	█					
CLEARING AND GRADING	█					
TEMP. SEEDING OF DISTURBED SLOPES			█			
FOUNDATIONS (CANOPY)				█		
UTILITIES					█	
STRUCTURES						█
PAVEMENT						█
LANDSCAPING & PERMANENT SEED/SOD						█
INTERIOR RENOVATIONS						█
REMOVAL OF EROSION / SILT CONTROL DEVICES						█

QUANTITY	ITEM	EMERGENCY REPAIR QUANTITY (15%)
447 LF	SILTATION CONTROL FENCE	67 LF
4 EA	CURB INLET PROTECTION	1 EA
5 EA	DANDY BAG	1 EA
TBD SY	SEED & MULCH (TEMP., IF NEEDED)	N/A
1,100 +/- SY	SOD (SLOPES STEEPER THAN 5:1 & IN RIGHT-OF-WAYS AT MINIMUM)	N/A
2 EA	CONSTRUCTION ENTRANCE & WASHDOWN STATION	N/A
1 EA	TEMPORARY OFF-STREET PARKING	N/A
1 EA	CONCRETE WASTE MANAGEMENT	N/A
1 EA	DUST CONTROL	N/A

(ALL QUANTITIES FOR PERMITTING PURPOSES ONLY. CONTRACTOR TO CALCULATE OWN QUANTITIES FOR BIDDING; SEED & MULCH NOT SHOWN, AS THESE WILL ONLY BE USED AS TEMPORARY EROSION CONTROL MEASURES. SOD IS TO BE USED FOR ALL PERMANENT INSTALLATIONS.)

**AMENDING THE STORM WATER POLLUTION PREVENTION PLAN**  
THE PERMIT-HOLDER SHALL AMEND THE STORM WATER POLLUTION PREVENTION PLAN WHENEVER:

- DESIGN, OPERATION OR MAINTENANCE OF BEST MANAGEMENT PRACTICES (BMP'S) IS CHANGED.
- DESIGN OF THE CONSTRUCTION PROJECT IS CHANGED THAT COULD SIGNIFICANTLY AFFECT THE QUALITY OF THE STORM WATER DISCHARGES.
- SITE OPERATOR'S INSPECTIONS INDICATE DEFICIENCIES IN THE STORM WATER POLLUTION PREVENTION PLAN (SWPPP) OR ANY BEST MANAGEMENT PRACTICES (BMP'S).
- INSPECTIONS BY A LOCAL AUTHORITY OR BY THE MISSOURI DEPARTMENT OF NATURAL RESOURCES INDICATE DEFICIENCIES IN THE STORM WATER POLLUTION PREVENTION PLAN (SWPPP) OR ANY BEST MANAGEMENT PRACTICES (BMP'S).

**DEWATERING PROCEDURES**

- ALTHOUGH NO DEWATERING ACTIVITIES ARE ANTICIPATED FOR THIS PROJECT, IF THEY BECOME NECESSARY DUE TO UNFORESEEN CIRCUMSTANCES, THE CONTRACTOR SHALL FOLLOW ALL APPLICABLE RULES AND REGULATIONS FOR DEWATERING. THESE INCLUDE BUT ARE NOT LIMITED TO THE CITY OF O'FALLON, MNR, ST. CHARLES COUNTY, AND THE EPA.
- DURING DEWATERING ACTIVITIES, STANDING "CLEAR, UNPOLLUTED WATER" CAN BE DECANTED AND DISCHARGED TO THE STORM SYSTEM. WATER THAT HAS BECOME TURBID DURING CLEANING SHOULD BE EITHER, (1) PUMPED AND HAULED TO AN ACCEPTABLE WASTEWATER DISPOSAL FACILITY OR (2) TREATED BY FILTRATION, SUCH AS PUMPED THROUGH A BAG FILTER AND DISCHARGED TO THE SANITARY SEWER SYSTEM.

- THE CONTRACTOR SHALL CONTACT THE CITY OF O'FALLON AND FOLLOW ANY RULES & REGULATIONS THEY IMPOSE PRIOR TO DISCHARGING TO THE SANITARY SYSTEM. THE FLOW RATE PUMPED INTO THE SANITARY SYSTEM SHALL NOT EXCEED 50 GPM.

**DEFINITIONS**

**CLEAR WATER:** WATER THAT HAS SETTLED ITS SOLIDS FOR 24 HOURS AND CAN BE PUMPED OUT OF THE BMP WITHOUT RE-SUSPENDING THE SOLIDS.

**UNPOLLUTED WATER:** DEFINED AS MEANING "ANY WATER THAT MAY BE DISCHARGED UNDER NPDES REGULATIONS INTO WATERS OF THE STATE WITHOUT HAVING TO BE AUTHORIZED BY A NPDES PERMIT AND WHICH WILL NOT CAUSE ANY VIOLATIONS OF STATE OR FEDERAL WATER QUALITY STANDARDS."

**CONTAINMENT FAILURE PLAN**  
IN THE EVENT OF ANY LOSS OF CONTAINED SEDIMENT:

- REPAIR ANY DAMAGED SILTATION FENCES.
- CLEAN UP ANY NECESSARY SILTED AREAS.
- RESTORE ANY NECESSARY SILTED AREAS.
- PROVIDE DOCUMENTATION OF ACTIONS & MANDATORY REPORTING TO CITY OF O'FALLON DEPARTMENT OF PUBLIC WORKS.

**Call Before you DIG**  
Dial 811 or TOLL FREE  
1-800-344-7483  
mo1call.com  
MISSOURI ONE-CALL SYSTEM INC.

Underground facilities, structures & utilities have been plotted from available surveys, records & information, and therefore, do not necessarily reflect the actual existence, nonexistence, size, type, number of, or location of these facilities, structures, & utilities.

The Contractor shall be responsible for verifying the actual location of all underground facilities, structures, & utilities, either shown or not shown on these plans. The underground facilities, structures, & utilities shall be located in the field prior to any grading, excavation or construction of improvements. These provisions shall in no way absolve any party from complying with the Underground Facility Safety and Damage Prevention Act, Chapter 319, RSMO.

The signed and sealed original of this drawing is on file at the offices of The Clayton Engineering Company, Inc. The signed and sealed original is the official document and shall take precedence over any digital version.

SILTATION CONTROLS CAN ONLY BE REMOVED WHEN THE SITE IS VEGETATED AND STABILIZED (SEE SWPPP NOTES)