

200 200

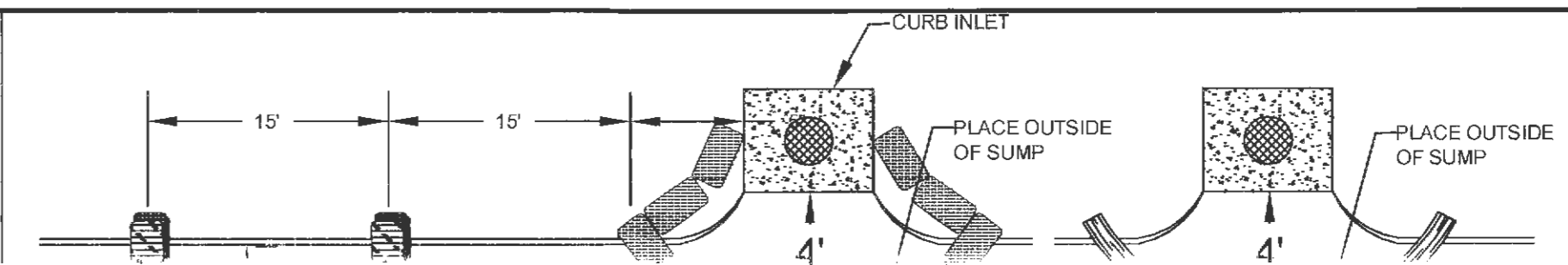
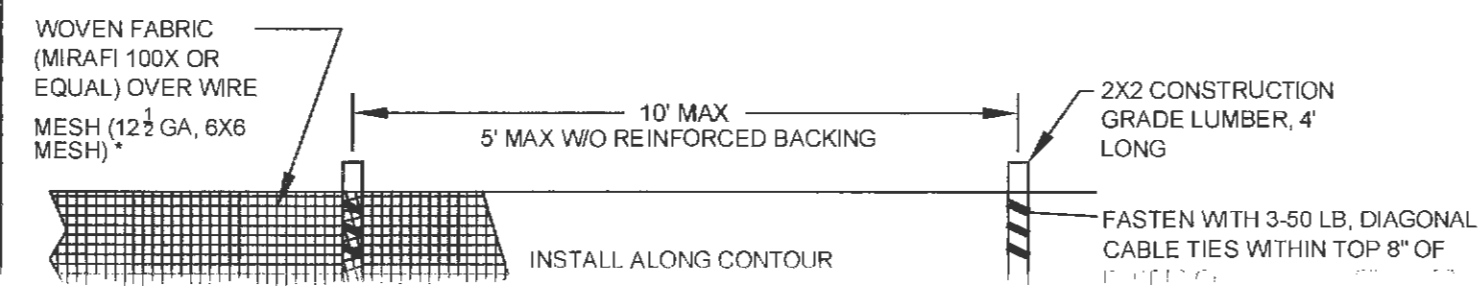

ON PLANS
FALLON
HIGHWAY K
JRI 63366

Ground Slope

CITY OF FALLON
ENGINEERING DEPARTMENT
FALLON, MISSOURI

**SPACING CHART
FOR ESC DEVICES**

SECTION

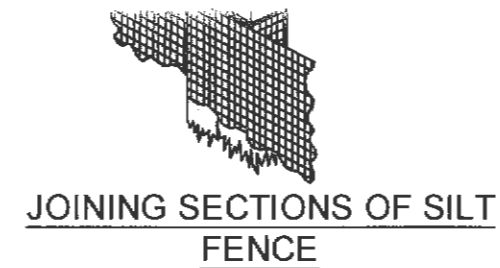

CITY OF FALLON
ENGINEERING DEPARTMENT
FALLON, MISSOURI

**SILT FENCE INSTALLATION
(SHEET FLOW ONLY)**

**TRAP PLACEMENT AT
INTERMEDIATE INLET**

1. MAXIMUM DRAINAGE AREA - 1 ACRE.
2. PEAK RUNOFF SHALL BE ≤ 2 CFS BASED ON THE 6-MONTH STORM.
3. STACK GRAVEL BAGS DOUBLE HIGH. PROVIDE GAP FOR DRAINAGE.

CITY OF FALLON
ENGINEERING DEPARTMENT
FALLON, MISSOURI

**CURB INLET
PROTECTION**

the clayton
engineering
company, inc.
11920 Westline Industri
St. Louis, MO 63146
(314) 692-8888
claytoneng@pro
fallo.com
Job#: 10122

MO Cert. of Authority - Professional Engi
& Professional Surveying #01

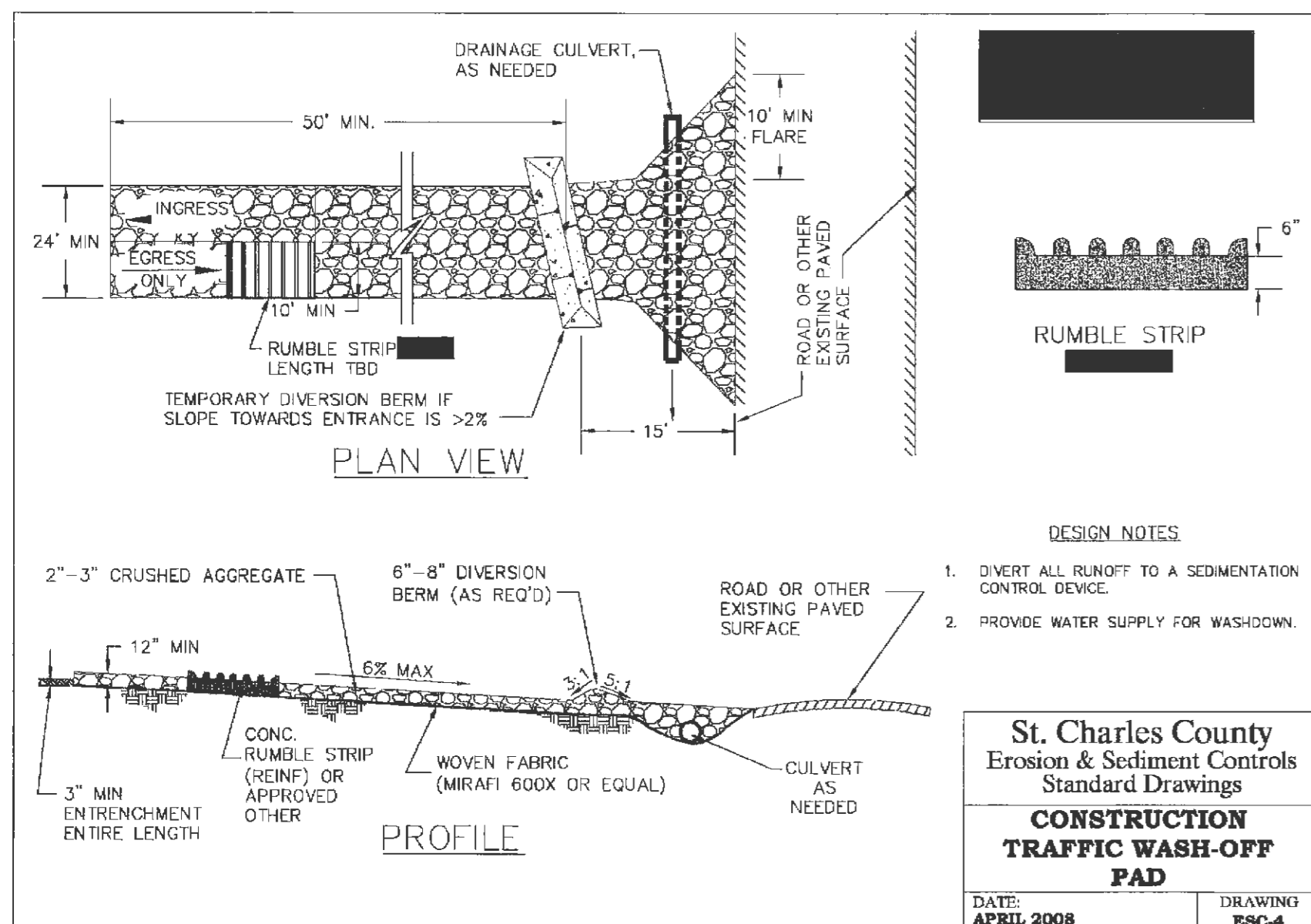

- DESIGN NOTES**
1. DIVERT ALL RUNOFF TO A SEDIMENTATION CONTROL DEVICE.
 2. PROVIDE WATER SUPPLY FOR WASHDOWN.

St. Charles County
Erosion & Sediment Controls
Standard Drawings

**CONSTRUCTION
TRAFFIC WASH-OFF
PAD**

DATE: APRIL 2008 DRAWING: ESC-4

Additional erosion control measures may be required during construction that are not shown on these plans. Contractor is responsible for installing and maintaining temporary and/or interim erosion control measures during construction progression or as required by the City of Fallon, St. Charles County and/or MDNR Inspector. Any changes/additions to the Storm Water Pollution Prevention Plan (SWPPP) shall be documented by the contractor and remain on file at the site.

Dandy Bag® Plan Insert

The patented Dandy Bag® is designed for use with flat grates (including round) and mountable curbs to detain sediment-laden storm water. The suspended solids are allowed to settle out of the slowed flow prior to entering the Dandy Bag®.

Installation

1. Stand the grate on end
2. Place the Dandy Bag® over the grate
3. Roll the grate over so that the open end is up
4. Pull up the stack
5. Tuck the flap in
6. Press the velcro strips together
7. Be sure that the end of the grate is completely covered by the flap or the Dandy Bag® will not work properly
8. Holding the handles, carefully place the Dandy Bag® with the grate inserted into the catch basin frame

Maintenance

To insure proper operation remove silt, sediment, and debris from the surface and the vicinity of the unit with a square point shovel or stiff bristle broom away from environmentally sensitive areas and waterways in manner satisfactory to the engineer/inspector. Remove fine material from inside Dandy Bag® as needed. Dispose of Dandy Bag® no longer in use at an appropriate recycling or solid waste facility.

Inlet Inspection

To inspect inlet, remove Dandy Bag® with grate inside, inspect catch basin and replace Dandy Bag® back into grate frame.

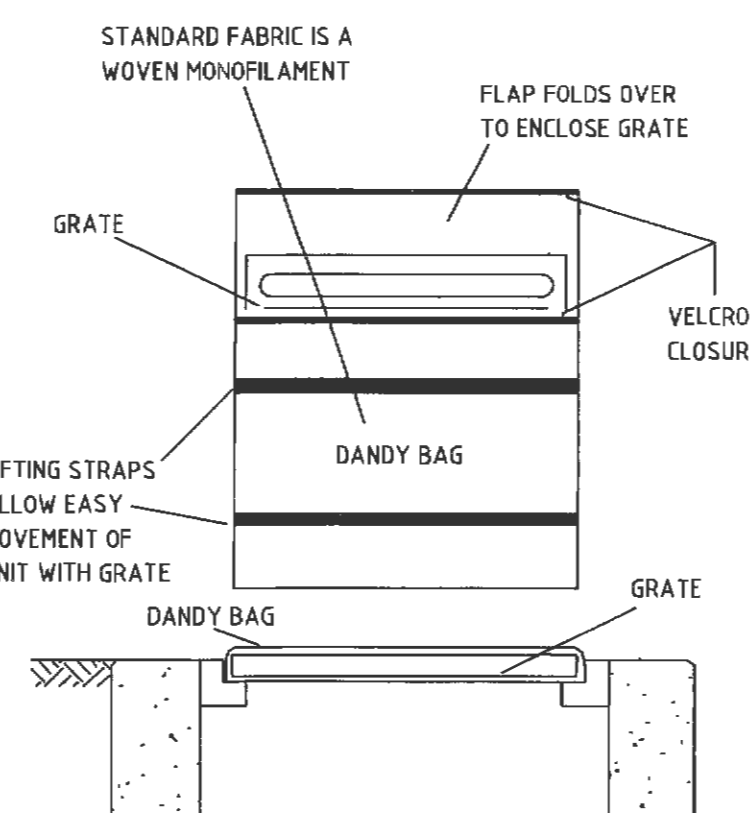

Ponding is likely if sediment is not removed regularly. The Dandy Bag® must never be used where overflow may endanger an exposed slope. The Dandy Bag® is not intended for any other use and should not be used for any other purpose.



DANDY PRODUCTS, INC.
2011 Harrisburg Pike, Suite R
Grove City, Ohio 43123

1-800-591-2284
(local) 614-875-2284
FAX: 614-875-6305
E-MAIL: dandy@dandyproducts.com
www.dandyproducts.com

The signed and sealed original of this drawing is on file at the offices of The Clayton Engineering Company, Inc. The signed and sealed original is the official document and shall take precedence over any digital version.

Call Before you DIG
Dial 811 or TOLL FREE
1-800-344-7483
mocal.com
MISSOURI ONE-CALL SYSTEM INC.

Underground facilities, structures & utilities have been plotted from available surveys, records & information, and therefore, do not necessarily reflect the actual existence, nonexistence, size, type, number of, or location of these facilities, structures, & utilities.

The Contractor shall be responsible for verifying the actual location of all underground facilities, structures, & utilities, either shown or not shown on these plans. The underground facilities, structures, & utilities shall be located in the field prior to any grading, excavation or construction of improvements. These provisions shall in no way absolve any party from complying with the Underground Facility Safety and Damage Prevention Act, Chapter 319, RSMO.

Plan Date: November 8, 2013
Revision Date: April 28, 2014
Revision Date: May 22, 2014
Revision Date: August 1, 2014
Revision Date: Sept. 4, 2014

Developer / Owner Information:
U-GAS PROPERTIES OF FALLON LLC
895 Bolger Court
Fenton, Missouri 63026
(636) 343-9770 FAX: (636) 343-9768

EROSION CONTROL DETAILS

P+Z No.: (23-13.02)
Approval Date: 10/03/13
City No.

Page No.

10 of 23