

ONSITE CONCRETE INCLUDING NEW CONCRETE DRIVE ENTRANCES
(NOT FOR USE ON McDONALD LANE OR HIGHWAY K ROAD WORK)
CONCRETE PAVEMENT DETAIL
NOT TO SCALE

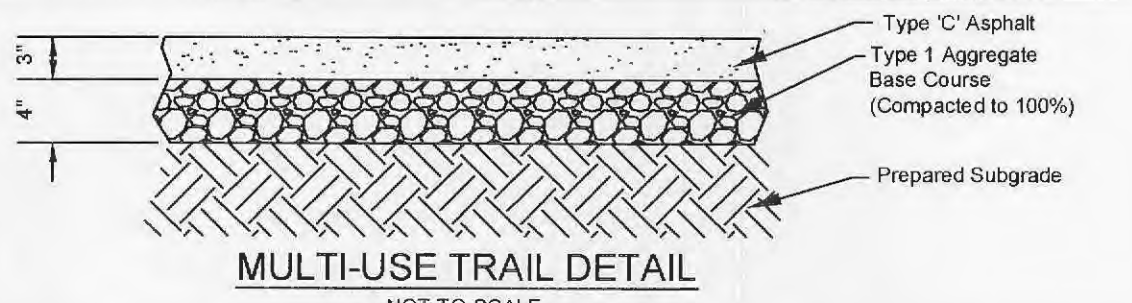

MULTI-USE TRAIL DETAIL
NOT TO SCALE

NOTE: TRAIL CROSS SLOPE SHALL BE LESS THAN 2% PER CURRENT ADA GUIDELINES (TOWARDS THE STREET).

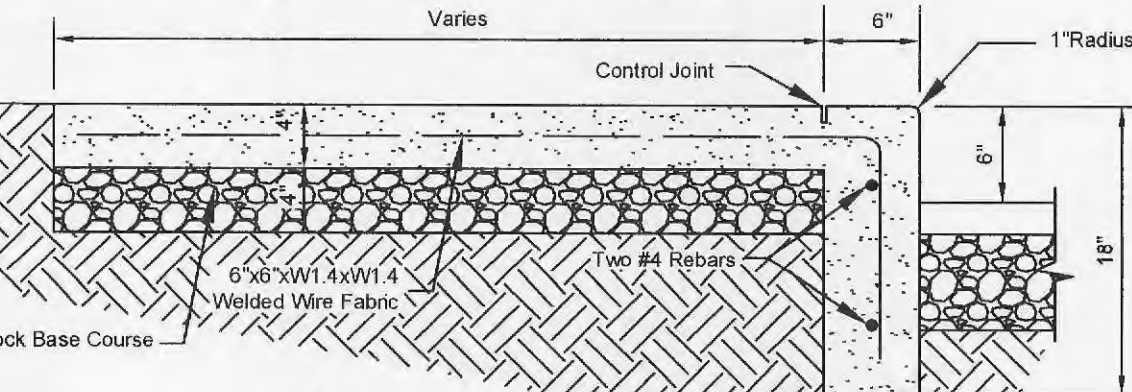

INTEGRAL SIDEWALK/CURB
NOT TO SCALE

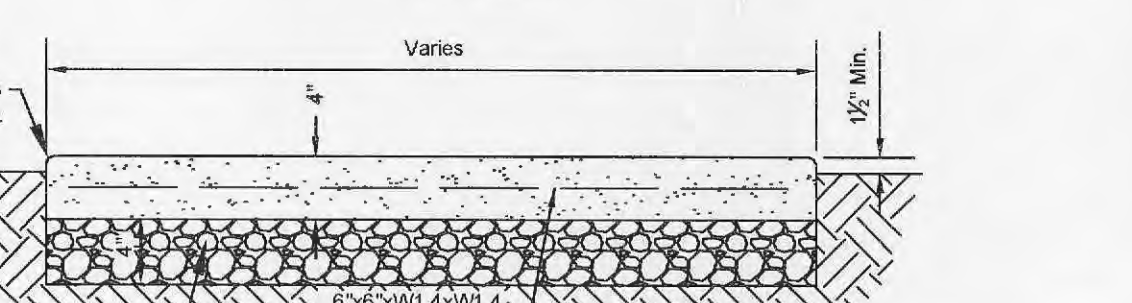

CONCRETE SIDEWALK
NOT TO SCALE

NOTE: SIDEWALK CROSS SLOPE SHALL BE LESS THAN 2% PER CURRENT ADA GUIDELINES.

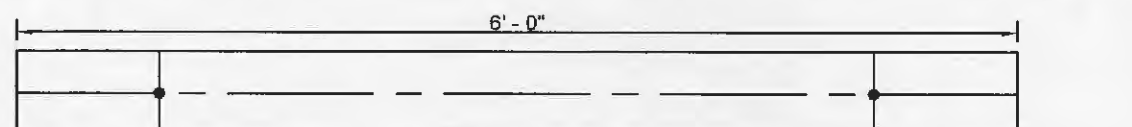

PLAN VIEW

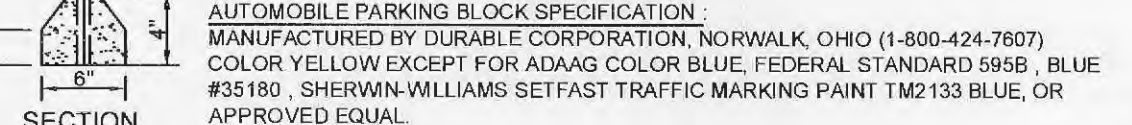

SECTION

- MANUFACTURER'S INSTALLATION NOTES FOR ASPHALT OR CONCRETE:**
- POSITION PARKING BLOCK IN ITS INSTALLATION POSITION & USING ITS PRE-DRILLED HOLES AS TEMPLATES, MARK THE LOCATION OF EACH HOLE ON THE PARKING SURFACE.
 - REMOVE PARKING BLOCK USING A HIGH-SPEED HAMMER DRILL WITH A 3/8" MASONRY BIT, DRILL A HOLE AT EACH MARKED LOCATION TO A DEPTH OF 3" BELOW PARKING SURFACE.
 - INSERT LAG ANCHOR INTO EACH HOLE (I.E. ANCHOR OPENING ON TOP). TAP THE ANCHOR INTO THE HOLE WITH A HAMMER SO THAT THE ANCHORS ARE SET FLUSH WITH THE SURFACE. PLACE A WASHER OVER EACH ANCHOR HOLE.
 - REPOSITION THE PARKING BLOCK IN ITS INSTALLATION POSITION. SLIP A WASHER ONTO THE LAG BOLT, INSERT BOLT THROUGH PRE-DRILLED HOLE IN THE PARKING BLOCK AND TIGHTEN THE BOLT ABOUT THREE QUARTERS OF THE WAY WITH THE 3/8" SOCKET. REPEAT FOR EACH HOLE IN THE PARKING BLOCK. FINISH TIGHTENING EACH BOLT UNTIL JUST SNUG. DO NOT OVER TIGHTEN! EXCESSIVE TIGHTENING MAY DAMAGE THE BLOCK AND VOID THE PRODUCT WARRANTY.

PARKING BLOCK DETAIL
NOT TO SCALE

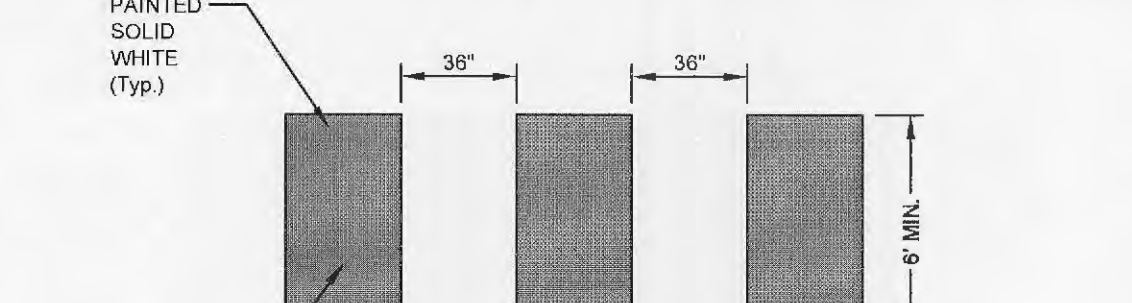

ZEBRA STYLE CROSSING
For Use Onsite
Not to Scale

SEE PLANS FOR LOCATIONS

Call Before you DIG
Dial 811 or TOLL FREE
1-800-344-7483
notcall.com
MISSOURI ONE-CALL SYSTEM INC.

Underground facilities, structures & utilities have been plotted from available surveys, records & information, and therefore, do not necessarily reflect the actual existence, nonexistence, size, type, number of, or location of these facilities, structures, & utilities.

The Contractor shall be responsible for verifying the actual location of all underground facilities, structures, & utilities, either shown or not shown on these plans. The underground facilities, structures, & utilities shall be located in the field prior to any grading, excavation or construction of improvements. These provisions shall in no way absolve any party from complying with the Underground Facility Safety and Damage Prevention Act, Chapter 319, RSMo.

The signed and sealed original of this drawing is on file at the offices of The Clayton Engineering Company, Inc. The signed and sealed original is the official document and shall take precedence over any digital version.

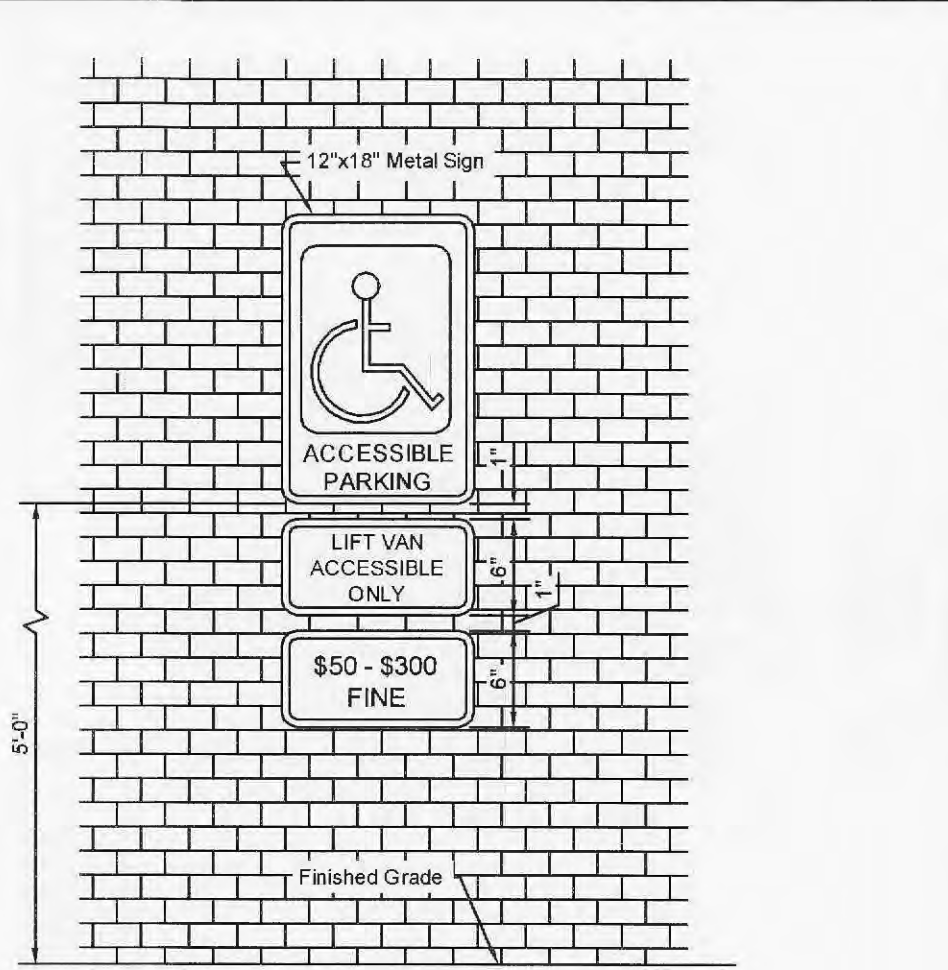

ADA PARKING SIGN (Wall Mounted)
Not to Scale

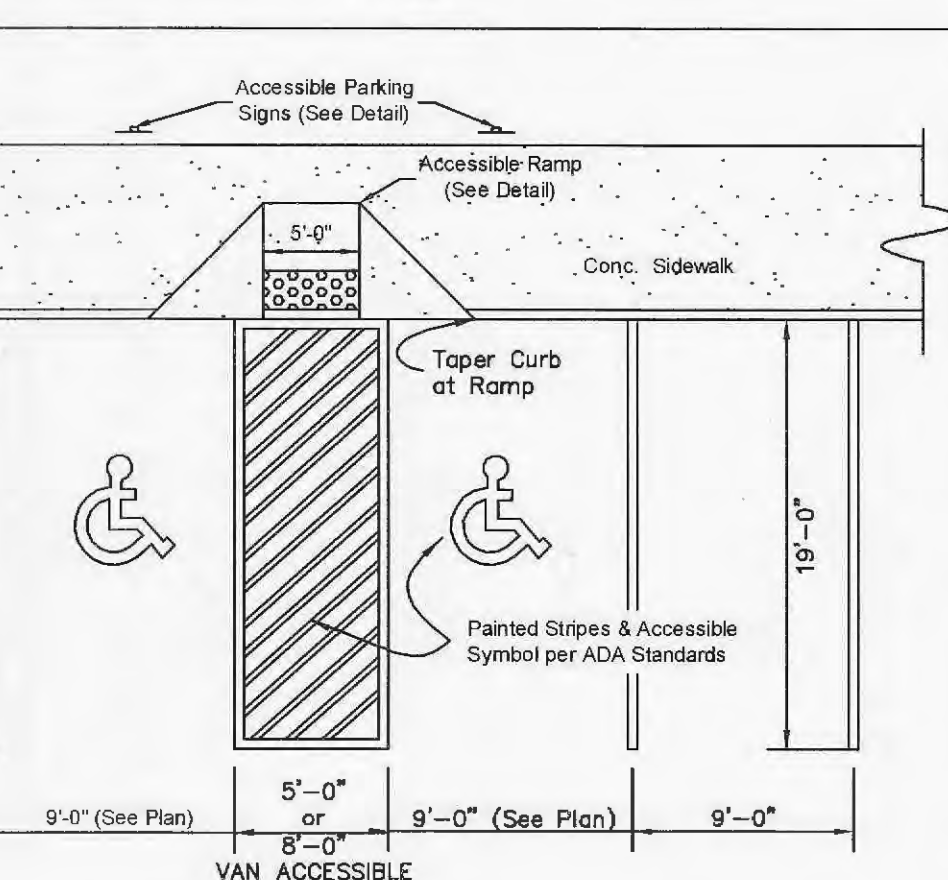

ACCESSIBLE PARKING DETAIL
NOT TO SCALE

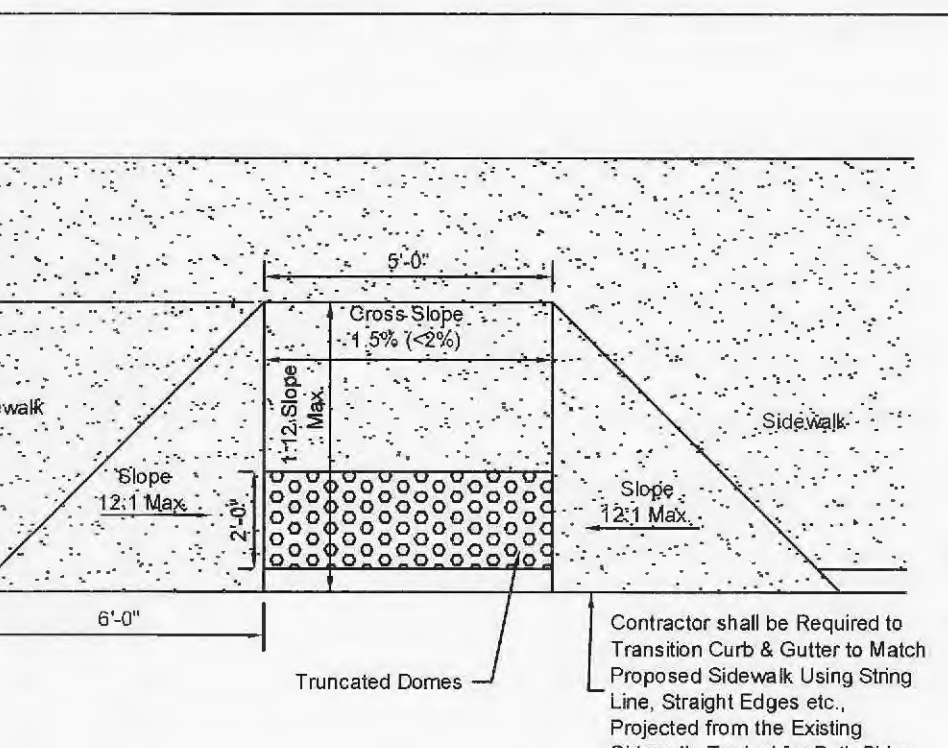

ADA RAMP - TYPE 'A'
Not to Scale

CONTAINED IN SIDEWALK w/ 12:1 Flared Sides

NOT FOR USE IN CITY OR MODOT RIGHT-OF-WAY

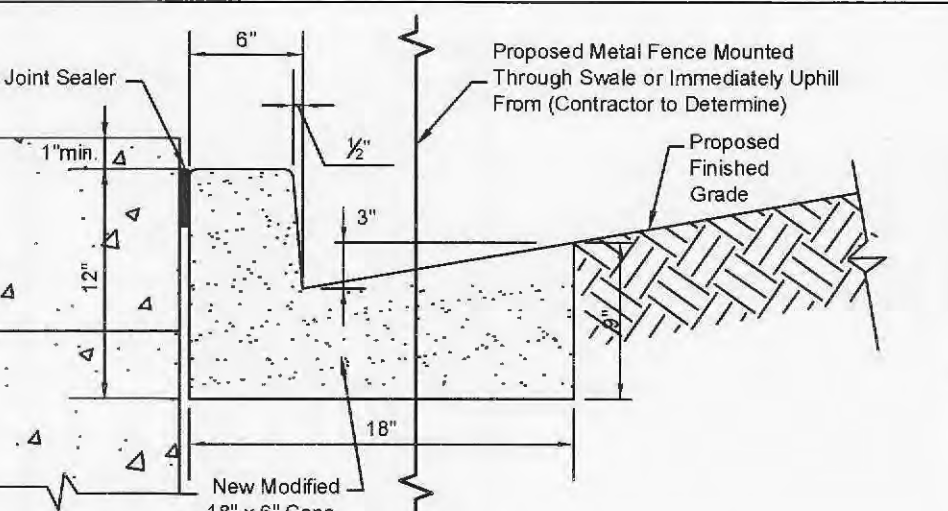

BACK OF WALL CONCRETE DIVERSION SWALE
NOT TO SCALE

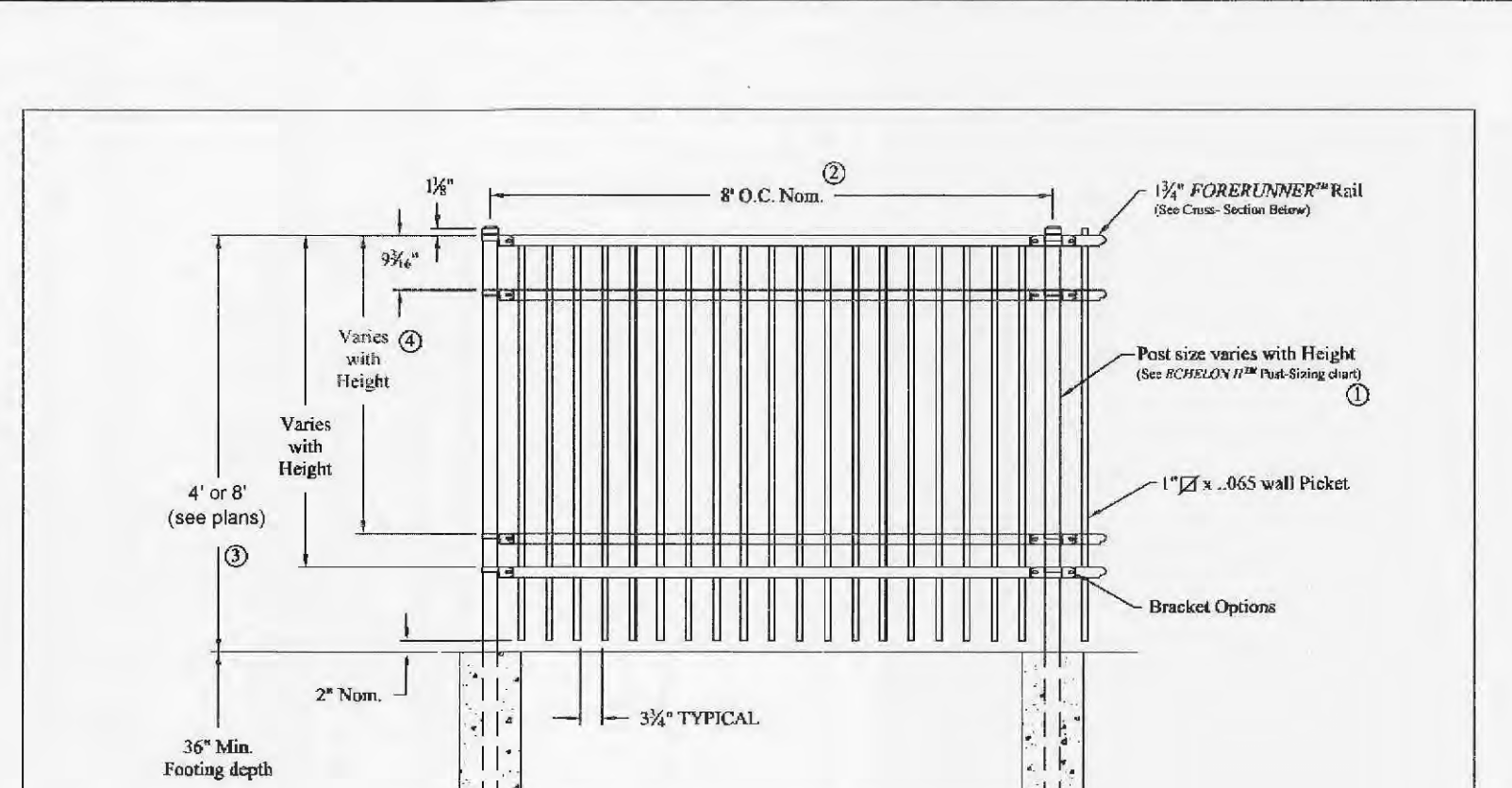

METAL ORNAMENTAL FENCE DETAIL
N.T.S.

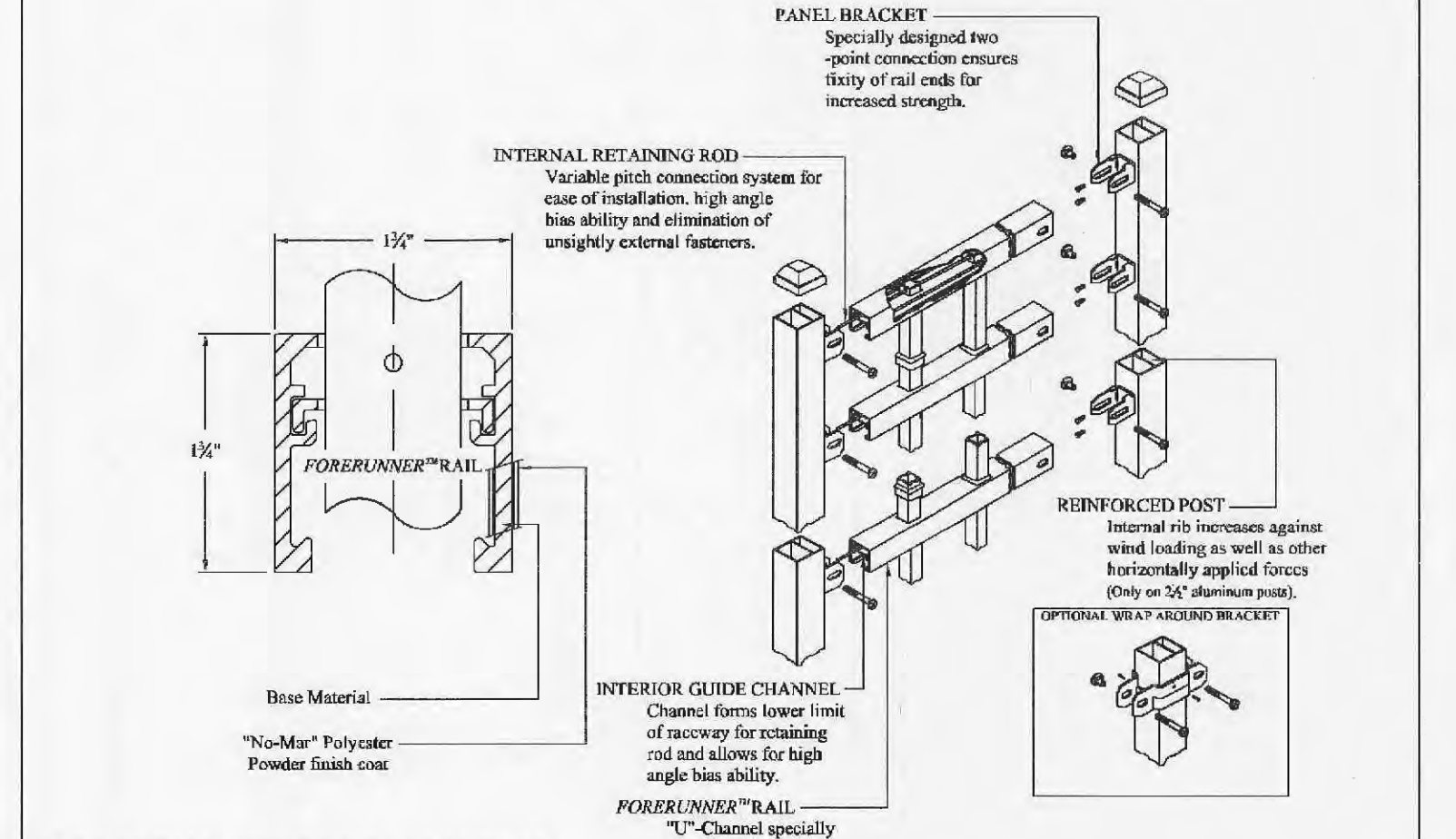

INDUSTRIAL STRENGTH ALUMINUM
ECHOLON II MAJESTIC 2 3/4-RAIL
DR: RTM SH: 1011 SCALE: DO NOT SCALE
CK: MM Date: 6/5/06 REV: b

1555 N. Mingo
Tulsa, OK 74116
1-888-333-3422
www.ameristarfence.com

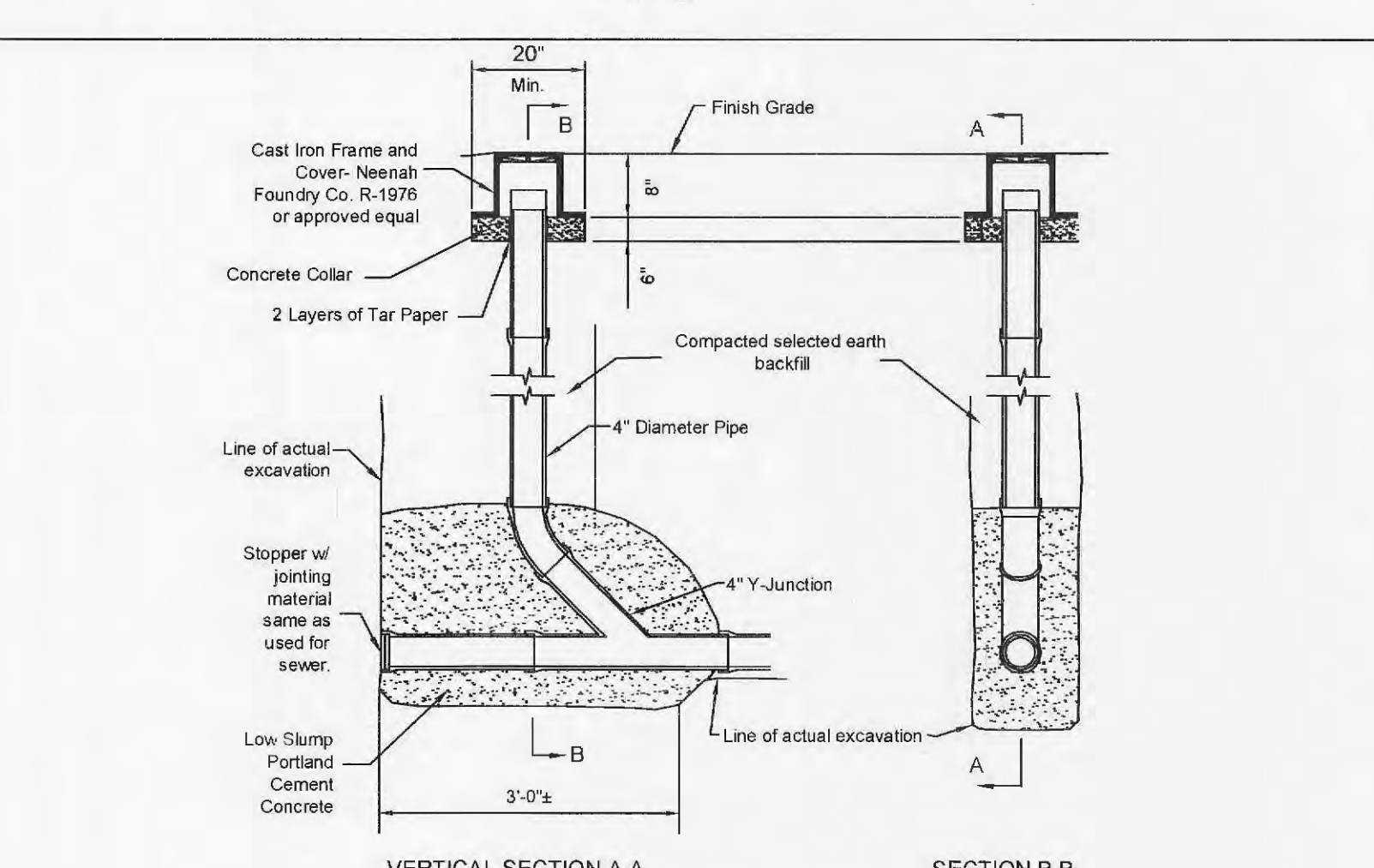

SEWER CLEANOUT
NOT TO SCALE

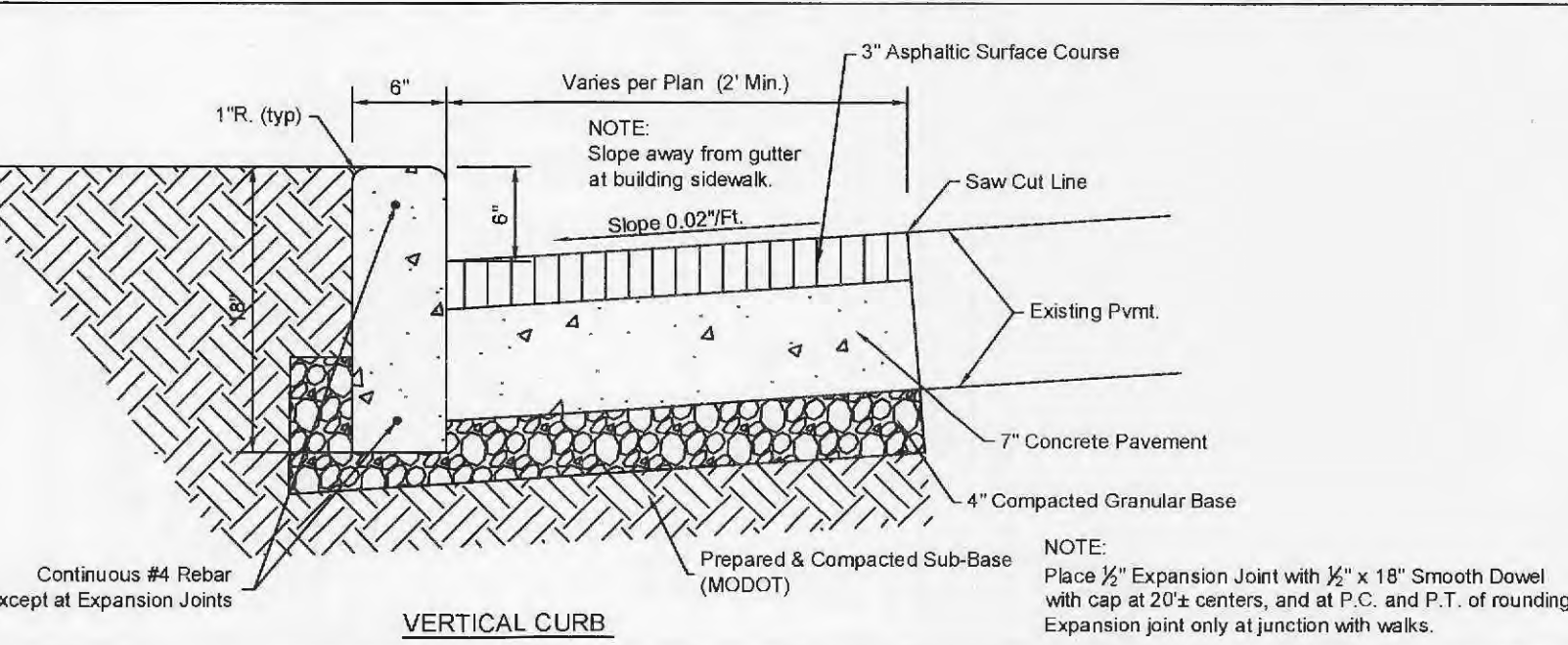

VERTICAL CURB

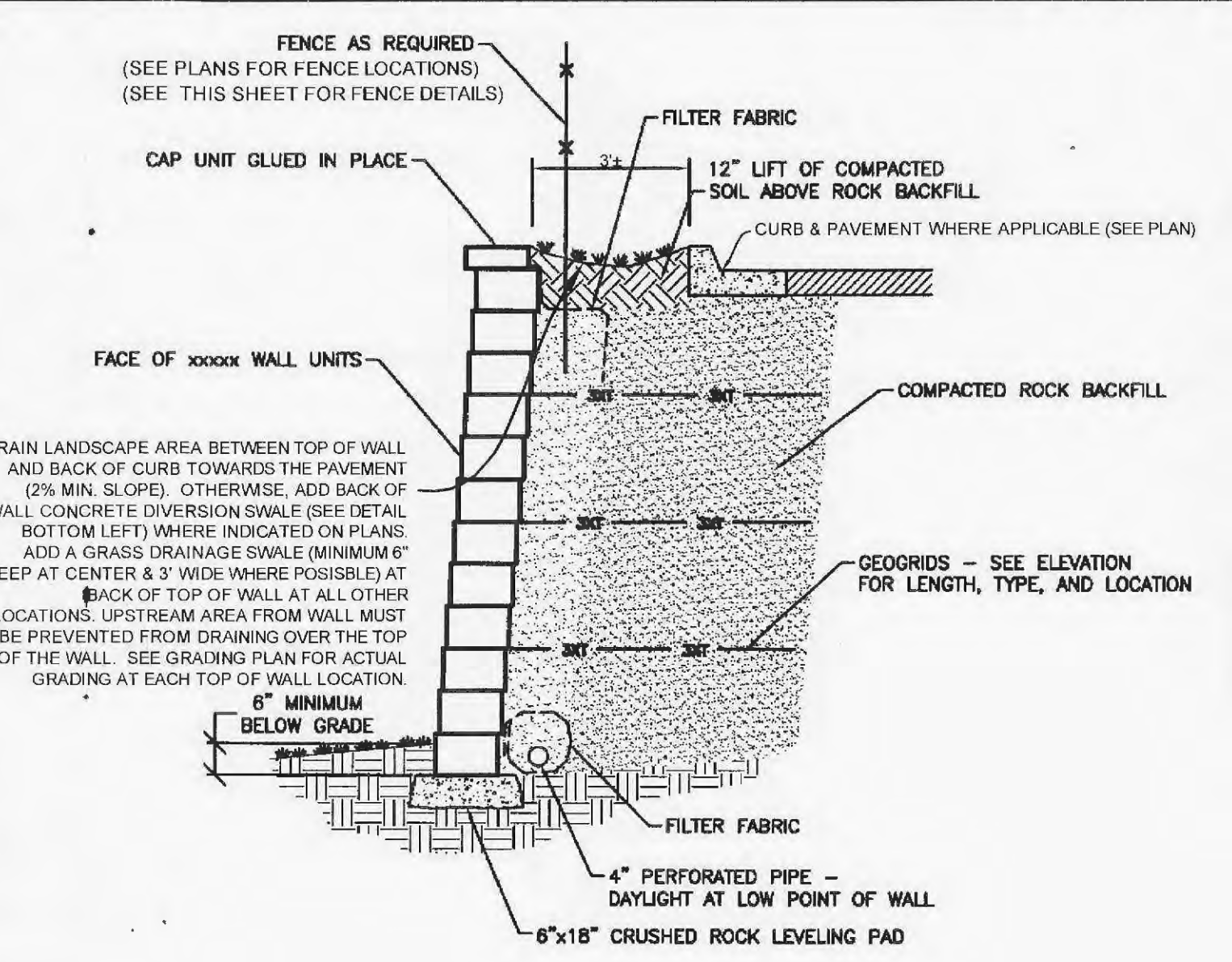

TYPICAL SECTION
NOT TO SCALE

- NOTES:**
- SHOP DRAWINGS ARE TO BE PREPARED BY A PROFESSIONAL ENGINEER. THE WALL DESIGNS SHALL BE SUBMITTED TO THE PROJECT CIVIL ENGINEER FOR REVIEW PRIOR TO WALL CONSTRUCTION.
 - THE WALL DESIGN SHALL MEET THE PROJECT REQUIREMENTS AND THE LOCAL REVIEW AGENCY REQUIREMENTS TO OBTAIN A CONSTRUCTION PERMIT.
 - THE PROJECT GEOTECHNICAL ENGINEER IS TO DETERMINE THE FOUNDATION BEARING CAPACITY AND WILL PROVIDE A GLOBAL STABILITY ANALYSIS IF NECESSARY.
 - THE OWNER'S REPRESENTATIVE WILL PROVIDE FOOTING INSPECTIONS PRIOR TO CONSTRUCTION AND BACKFILL COMPACTION TESTING AS REQUIRED.
 - ACCEPTABLE WALL UNITS ARE KEYSTONE AND VERSA-LOK WALL SYSTEMS.

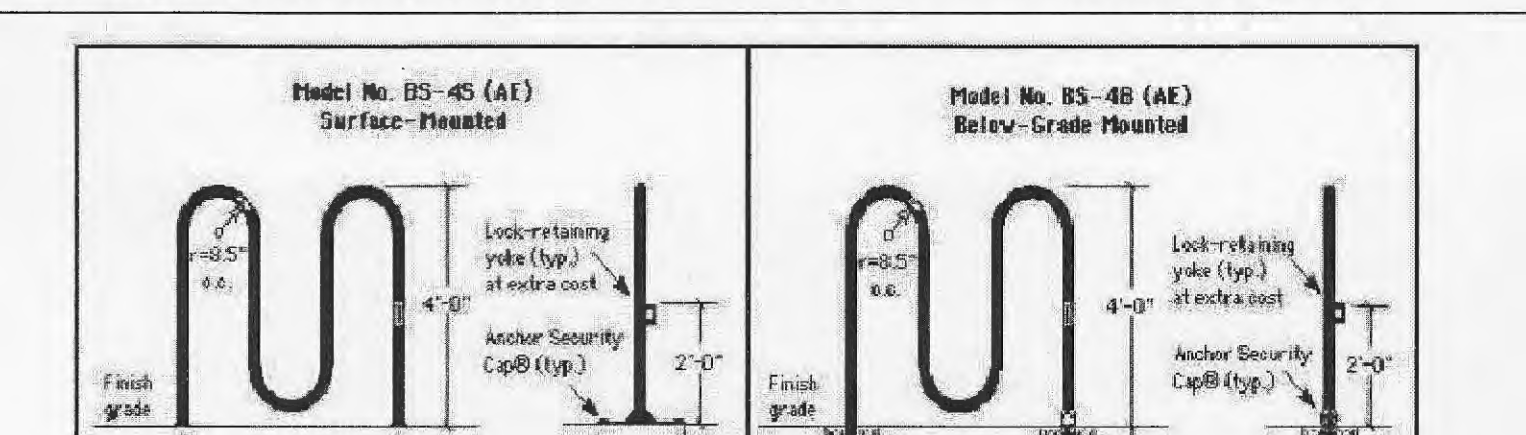

BIKE RACK DETAIL
Not to Scale

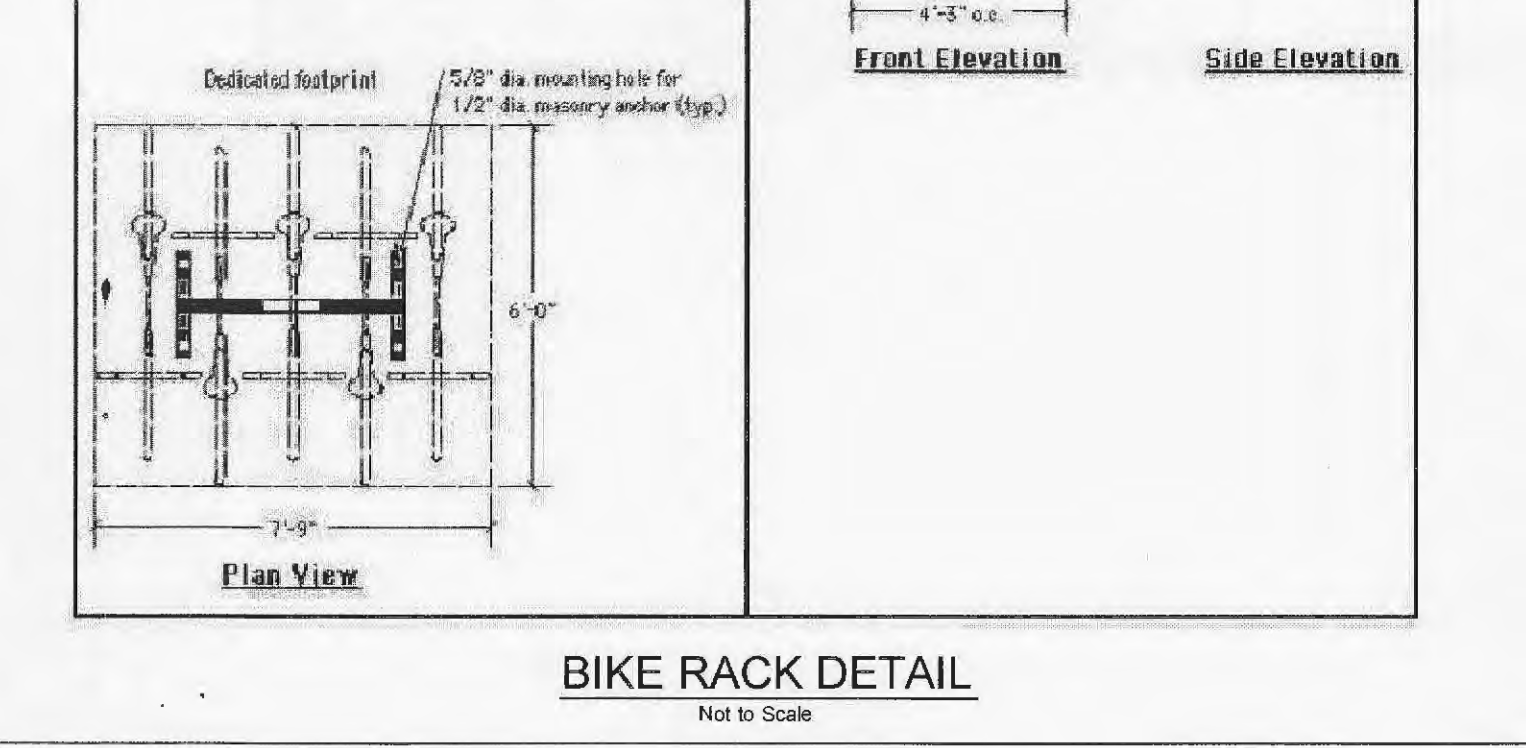

PIPE BOLLARD DETAIL
NOT TO SCALE

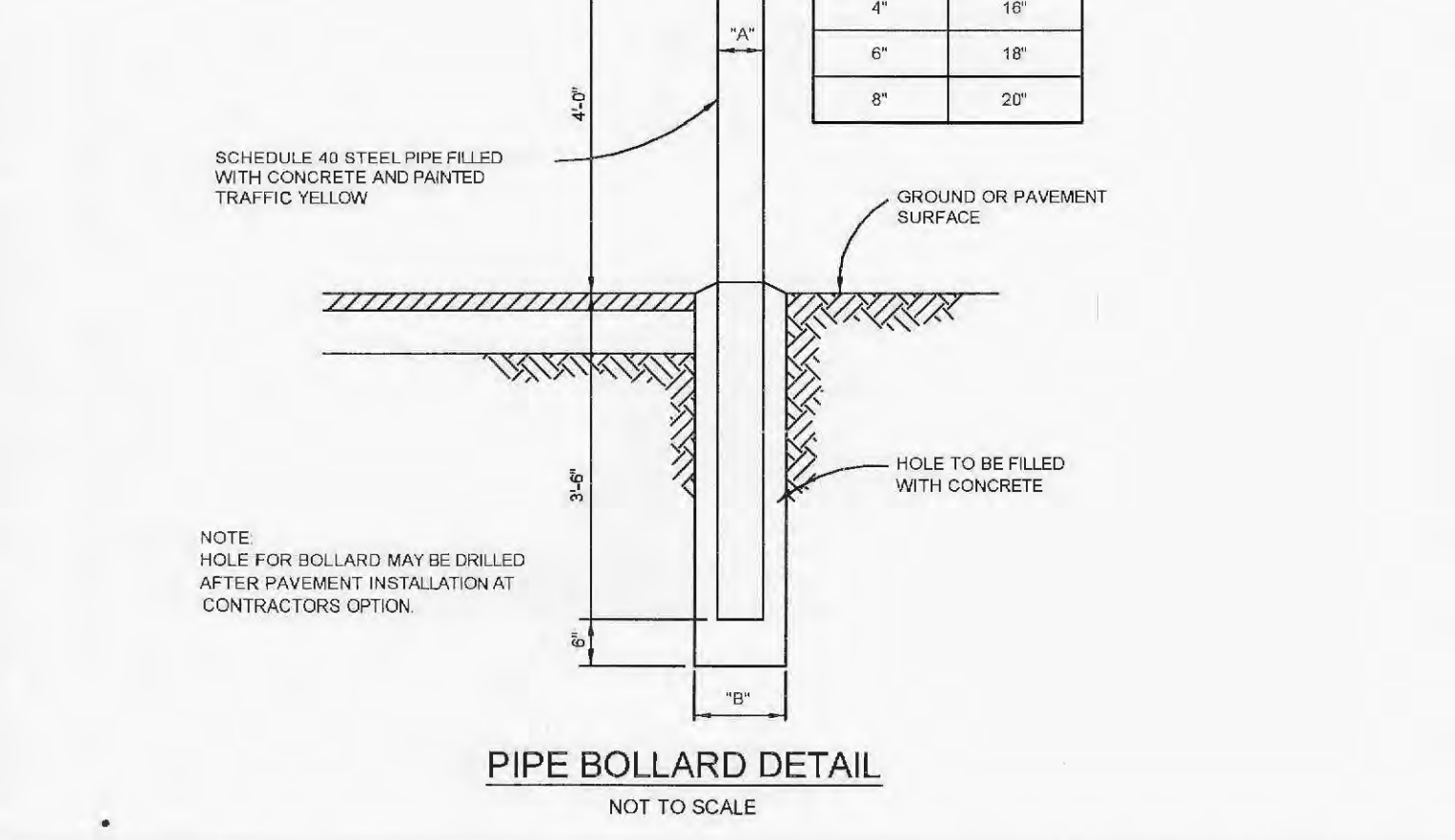

VERTICAL CURB

PROJECT TITLE:
SITE CONSTRUCTION PLANS
DIRT CHEAP OF FALLON
#708 MO. STATE HIGHWAY K
O'FALLON, MISSOURI 63366

Copyright 2014
Clayton Engineering Co.
All Rights Reserved

the clayton engineering company, inc.
11920 Westline Industrial Drive
St. Louis, MO 63146
(314) 692-9888
Fax: (314) 692-9888
Job#: 1012

MO Cert. of Authority - Professional Engineering #000067
& Professional Surveying #000014

Erik J. Staley - Professional Engineer
(PE-200500132)

STATE OF MISSOURI
ERIK J. STALEY
NUMBER
PE-200500132
PROFESSIONAL ENGINEER
9-4-14

Plan Date: November 8, 2013
Revision Date: April 28, 2014
Revision Date: May 22, 2014
Revision Date: August 1, 2014
Revision Date: Sept. 4, 2014

Developer / Owner Information:
U-GAS PROPERTIES OF FALLON LLC
895 Bolger Court
Fenton, Missouri 63026
(636) 343-9770 FAX: (636) 343-9768

P+Z No: (23-13.02)
Approval Date: 10/03/13
City No.

Page No.

12 of 23

CONSTRUCTION DETAILS