

REVISIONS	BY
2/24/2024	RVM
3/12/2024	RVM

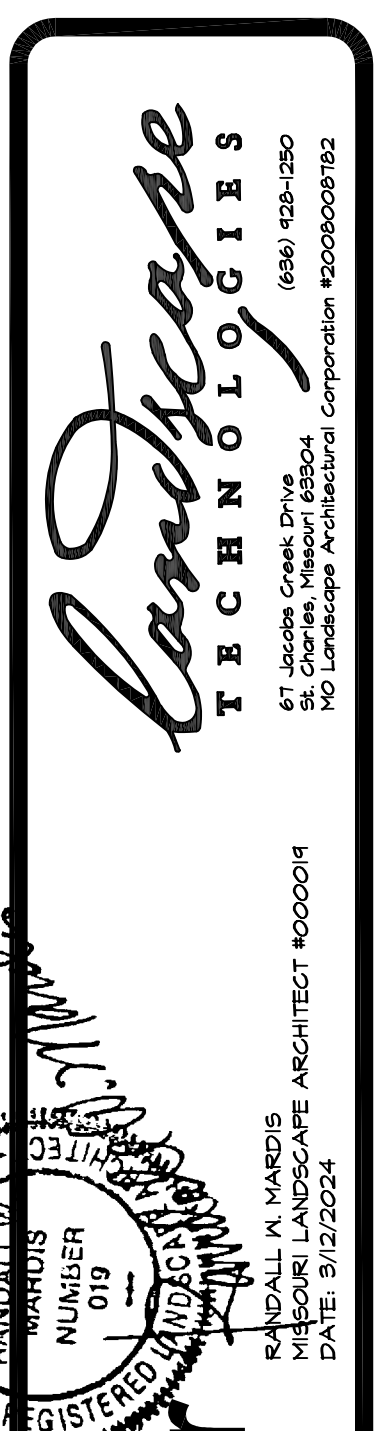

PLANTING PLAN FOR THE PROPOSED  
**Dobbs Tire & Auto Center**  
 OF FALLON, MISSOURI

DRAWN	R. MARDIS
CHECKED	RAMWEL
DATE	11/1/2023
SCALE	N.A.
JOB No.	2023-175
SHEET	L-2
OF TWO SHEETS	

## LANDSCAPE GUIDELINE SPECS:

### GENERAL:

- 1.) Base map information is accurate as of the date of drawing printed in this package.
- 2.) It shall be the landscape contractor's responsibility to:
  - A.) Verify all existing and proposed features shown on the drawings prior to commencement of work.
  - B.) Report all discrepancies found with regard to existing conditions or proposed design to the landscape architect immediately for a decision.
  - C.) Stake the locations of all proposed plant material and obtain the approval of the owner's representative or landscape architect ten (10) days prior to installation.
- 3.) The contractor shall be in compliance with all codes applicable to this work.
- 4.) Clean all planting beds of debris, rock, building material, etc. prior to adding / spreading topsoil or mulch.
- 5.) All annual and/or perennial beds are to be roto-tilled at a depth of 12" and amended with peat moss or organic material prior to planting. All grass and/or weeds shall be killed / removed from new planting beds of any kind.
- 6.) Remove all debris and rock in parking lot islands shall be removed / disposed and new topsoil provided to a depth of 3" with a berm 4" higher than the adjacent curbing.
- 7.) All natural vegetation shall be maintained where it does not interfere with construction or the permanent plan of operation. Every effort possible shall be made to protect existing structures or vegetation from damage due to equipment usage. Contractor shall at all times protect all materials and work against injury to public. The landscape contractor shall be responsible for any coordination and sequencing with other site related work being performed by other contractors. Any damage to the existing improvements shall be the responsibility of the contractor. It shall be the responsibility of the contractor to restore all areas of the site where disturbed by said contractor. Refer to additional drawings for further coordination of work to be done.
- 8.) Underground facilities, structures and utilities must be considered approximate only. There may be others not presently known or shown. It shall be the landscape contractor's responsibility to determine or verify the existence of and exact location of the above (Call utility location services in municipality).
- 9.) Plant material are to be planted in the same relationship to grade as was grown in nursery conditions. All planting beds shall be cultivated to 6" depth minimum and graded smooth immediately before planting of plants. Plant groundcover to within 12" of trunk of trees or shrubs planted within the area.
- 10.) Plant material shall be typical in shape and form for species specified. Plants planted in groupings and masses shall also be matched. Container grown plant material shall not be root-bound and balled-and-burlapped material shall have root balls as dictated by American Standard for Nursery Stock.
- 11.) list. It shall be the landscape contractor's responsibility to verify all quantities and conditions prior to implementation of this plan. No substitutions of types or size of plant materials will be accepted without written approval from the landscape architect.
- 12.) Provide single-stem trees unless otherwise noted in plant schedule.
- 13.) All plant material shall comply with the recommendations and requirements of ANSI Z60.1 "American Standards for Nursery Stock".
- 14.) It shall be the contractor's responsibility to provide for inspection of the plant material by the Landscape Architect (or Owners' Representative) prior to acceptance. Inspections may take place before, during or after installation. Plants not conforming exactly to the plant list will not be accepted and shall be replaced at the landscape contractor's expense.
- 15.) All bids are to have unit prices listed. The Owner has the option to delete any portion of the contract prior to signing the contract or beginning work. This will be a unit price contract; quotes shall be valid for 12 months.
- 16.) Should auger equipment be utilized in excavating any plant pits, vertical sides of plant pits shall be thoroughly scarified to avoid creation of "polished side walls" prior to plant material installation.
- 17.) All excess topsoil, rocks, debris and/or tainted soils shall be removed by the general contractor prior to point project is turned over to the landscape contractor to commence landscape installation.
- 18.) Keep all plant material (except turf) a minimum of 36" clear of fire hydrants.
- 19.) All tags, nursery stakes, labels, etc. shall be removed by the landscape contractor at completion of all landscape installation.
- 20.) Landscape contractor shall be in compliance with all federal, state and local laws / regulations relating to insect infestation and/or plant diseases.
- 21.) All substitutions of plant material shall be submitted to landscape architect for approval.
- 22.) Tree protection fencing is to be installed prior to any grading operations and inspected daily / maintained in place until completion of the project.
- 23.) No parking, storage of materials or any other construction activities are to occur within tree protection areas.

### PRUNING:

- 1.) Lightly prune trees at time of planting. Prune only the crossover limbs, intermingled leaders and/or any broken branches. Some interior twigs and lateral branches may be pruned. However, do not remove the terminal buds of branches that extend to the edge of the crown.
- 2.) All pruning shall comply with ANSI A300 standards.

### INSURANCE:

- 1.) The landscape contractor shall submit certificates of insurance for workman's compensation and general liability.

### MULCH:

- 1.) All mulch to be shredded oak bark mulch at 3" depth (after compaction) unless otherwise noted. Mulch shall be clean and free of all foreign materials, including weeds, mold, deleterious materials, etc.
- 2.) No plastic sheeting or filter fabric shall be placed beneath shredded bark mulch beds. Mirafi fabric shall be used beneath all gravel mulch beds. Lap fabric 6" over adjacent coverages.
- 3.) Edge all beds with spade-cut edge unless otherwise noted.

### MAINTENANCE:

- 1.) Landscape Contractor shall provide a separate proposal to maintain all plants, shrubs, groundcover, perennials and annuals for a period of 12 months after acceptance.
- 2.) Contractor shall ensure that only competent and trained personnel shall provide such services and that such services be provided in a timely manner.
- 3.) Watering of seeded or sodded lawns shall begin immediately and shall continue to be provided continuously for the following 72 hours. Regardless, the landscape contractor shall be responsible for all landscape maintenance until project turnover.

### SIGHT TRIANGLES:

- 1.) No landscape material or other obstructions shall be placed or be maintained within the sight distance area so as to impede the vision between a height of thirty inches (30") and ten feet (10') above the adjacent street or paving surfaces.
- 2.) Sight triangles at the intersection of a public street and a private access way (except for single family residences) shall also be formed by measuring from the point of intersection of the street frontage curbs and the entrance curb lines a distance of 35' and connecting the points so established to form the sight triangle area.

### TOPSOIL:

- 1.) Topsoil mix for all proposed landscape plant material (excluding turf areas) shall be five (5) parts well-drained screened organic topsoil to one (1) part Canadian sphagnum peat moss as per planting details. Roto-till topsoil mix to a depth of 6" minimum and grade smooth.
- 2.) Provide a soil analysis, as requested, made by an independent soil-testing agency outlining the % of organic matter, inorganic matter, deleterious material, pH and mineral content.
- 3.) Any foreign topsoil used shall be free of roots, stumps, weeds, brush, stones (larger than 1"), litter or any other extraneous or toxic material. Landscape contractor shall be fully responsible for correcting all negative soil issues prior to plant installation. Killing and removal of all weeds shall be the responsibility of the landscape contractor as part of this task.
- 4.) Landscape contractor to apply pre-emergent herbicide to all planting beds upon completion of planting operations and before application of shredded bark mulch.
- 5.) Install siltation controls prior to commencement of any grading operations. Inspect and maintain all siltation fences on a weekly basis until vegetation is established.

### MISC. MATERIAL:

- 1.) Provide stakes and deadmen of sound, new hardwood, free of knotholes and defects per planting details. Remove stakes and guying from all trees one year after planting.
- 2.) Tree wrap tape shall be 4" minimum, designed to prevent borer damage and winter freezing. Additionally, only 3-ply tying material shall be used.

### EROSION CONTROL BLANKET (Where applicable):

- 1.) All seeded areas on slopes greater than 4:1 shall receive an erosion control blanket which shall consist of loose straw mat and anchor pins as manufactured by: Northern American Green, D5 75 or approved equal. Install per manufacturer's recommendations.

### PLUG PLANTING NOTES:

- 1.) All plugs to be 4-1/2" deep X 2" diameter minimum.
- 2.) Plugs are to be planted in a hole dug with a trowel, spade or planting bar such that the hole is of a minimum diameter and depth to accommodate the plug and its roots, without damage.
- 3.) Plugs shall be spaced in a triangulated layout approximately 24" on center. Plugs shall be planted through erosion control blanket where appropriate.
- 4.) Obtain plugs from a reputable nursery.
- 5.) Water plugs upon completion of planting so that soil is moist but not saturated.
- 6.) If planting is delayed more than six hours after delivery, store plugs in the shade, protect from weather and mechanical damage and keep them moist and cool. All plugs shall be planted within 24 hours after delivery.

### WARRANTY:

- 1.) All plant material (excluding ground cover, perennials and annuals) are to be warranted for a period of 12 months after complete installation of all landscape material at 100% of the installed price. All plant material deemed unhealthy, unsightly or having undue amounts of dead branches by the landscape architect shall be replaced under this warranty.
- 2.) Any plant material found to be defective shall be removed and replaced within 30 days of notification or in growth season determined to be best for that plant.
- 3.) Only one replacement per tree or shrub shall be required at the end of the warranty period, unless loss is due to failure to comply with the warranty.
- 4.) Landscape contractor shall not be liable due to acts of God or vandalism.
- 5.) Lawn establishment period will be in effect once the lawn has been mowed three times. Plant establishment period shall commence on the date of acceptance and 100% completion.
- 6.) A written guarantee shall be provided to the owner per conditions outlined in #1 above.

### TURF:

- 1.) All disturbed lawn areas to be seeded with a mixture of Turf-Type Fescue (50% per acre) and bluegrass (10% per acre). Lawn areas shall be unconditionally warranted for a period of 90 days from date of final acceptance. Bare areas more than one square foot per any 50 square feet shall be replaced.
- 2.) Seed and fertilization operations shall occur between May 1 and June 15th or between September 1 and October 15th unless directed by others in writing AND irrigation system is operating.
- 3.) Granular or pelleted fertilizer consisting of 50% water-insoluble slow release nitrogen, phosphorous and potassium in a 12-12-12 composition.
- 4.) The turf contractor shall be responsible for protection of finished grade; restore and repair any erosion or water damage and obtain owners' approval prior to seeding or sod installation.
- 5.) Landscape contractor shall offer an alternate price for sod in lieu of seed. Sod shall be cut at a uniform thickness of 3/4". No broken pieces, irregular pieces or torn pieces will be accepted.
- 6.) Any points carrying concentrated water loads and all slopes of 15% or greater shall be sodded.
- 7.) All sod shall be placed a maximum of 24 hours after harvesting.
- 8.) Recondition existing lawn areas damaged by Contractor's operations including equipment/material storage and movement of vehicles.
- 9.) Sod Contractor to ensure sod is placed below sidewalk and all paved area elevations to allow for proper drainage.

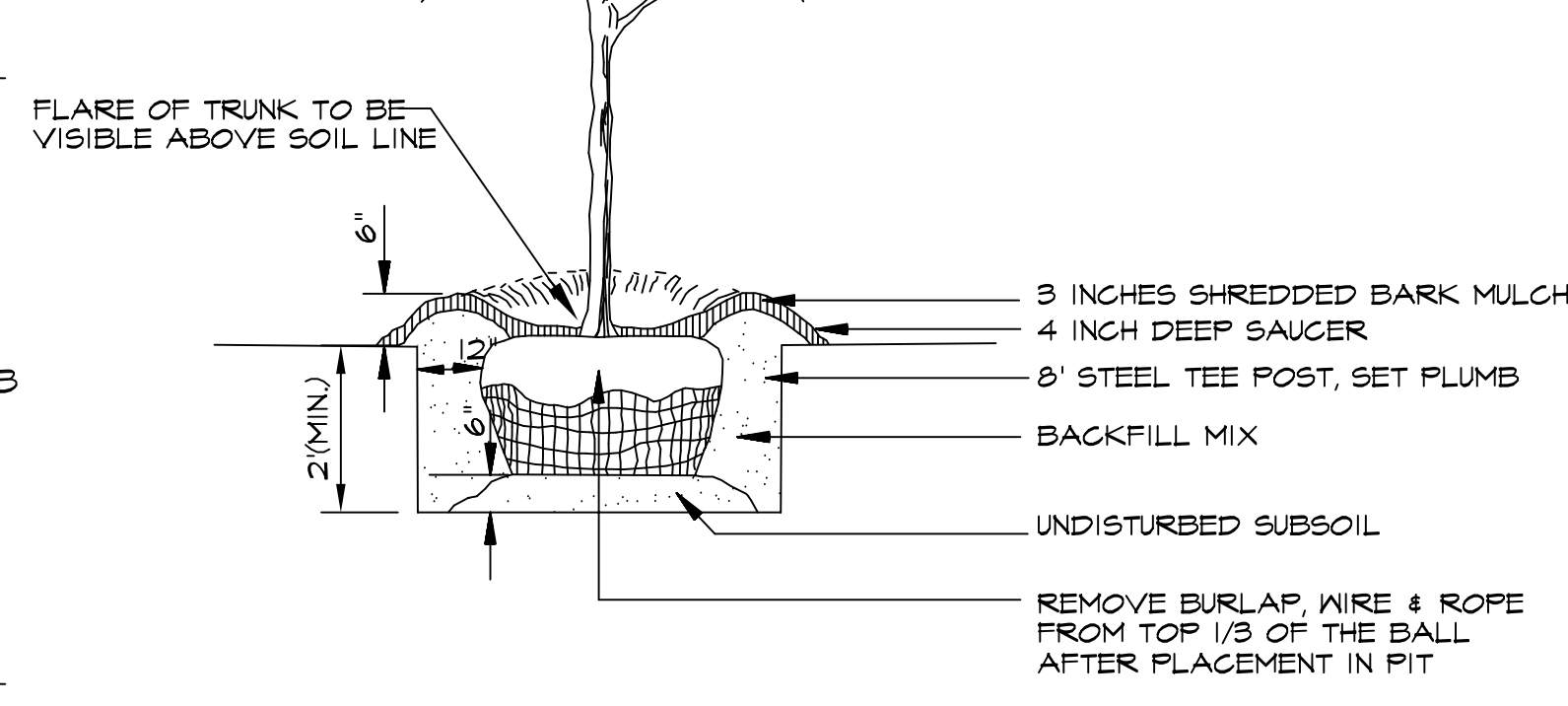
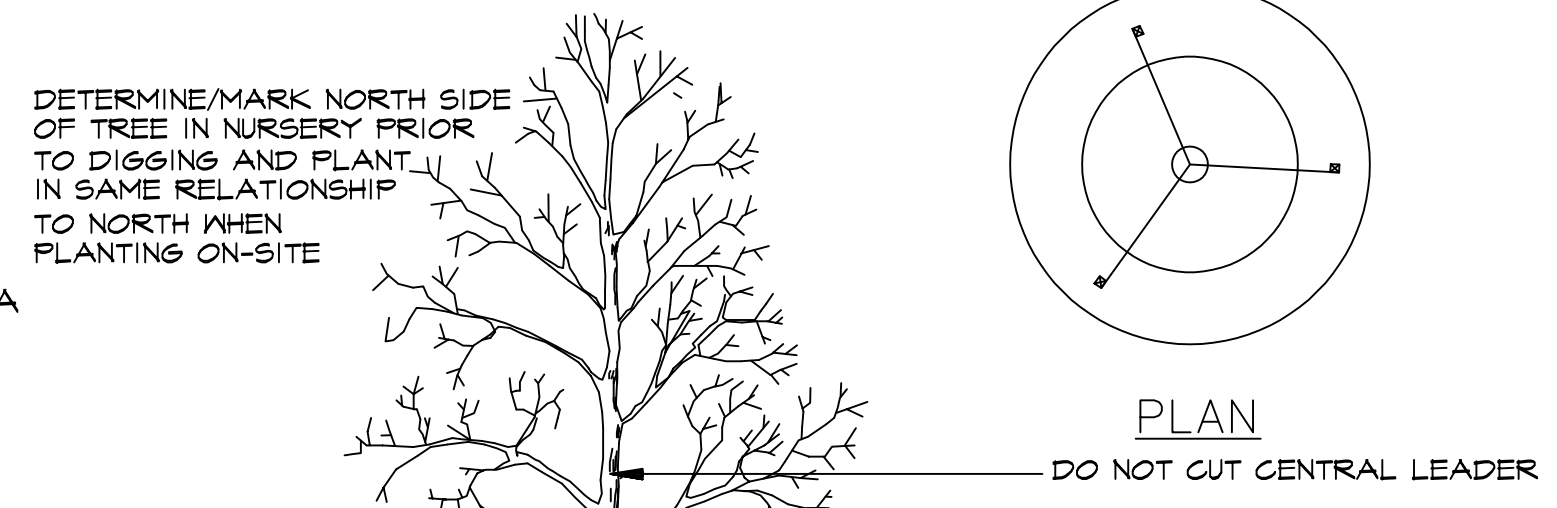

## DECIDUOUS TREE PLANTING

N.T.S.

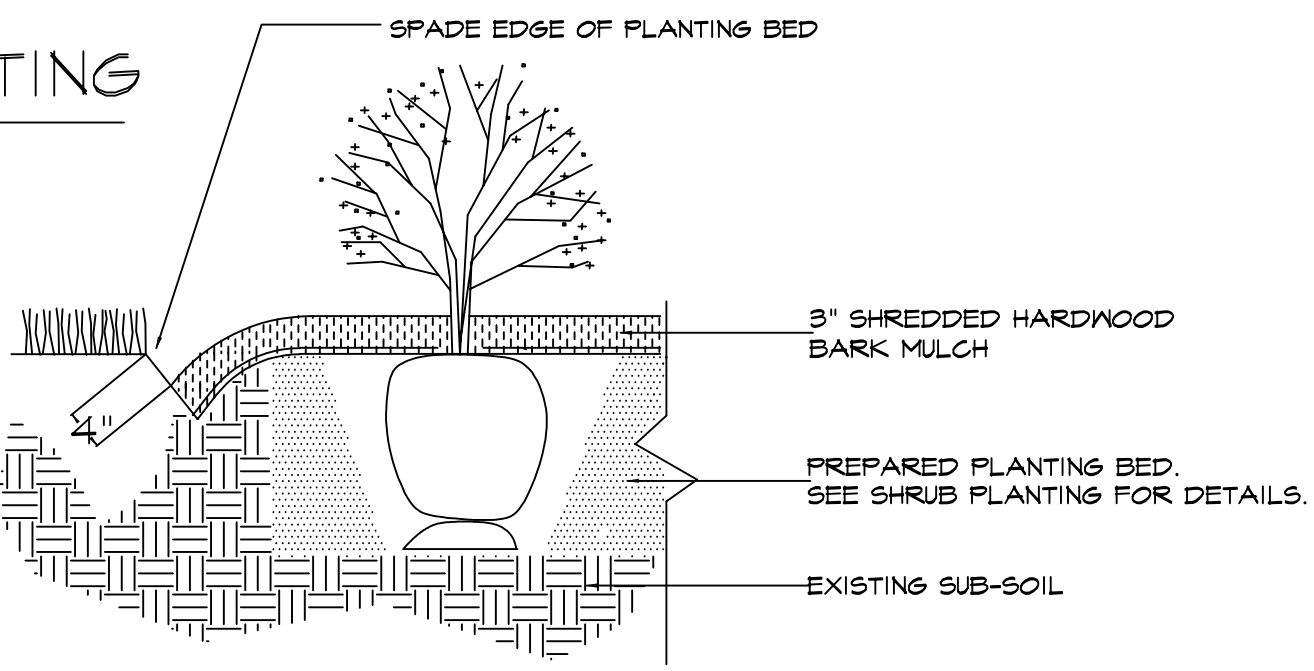
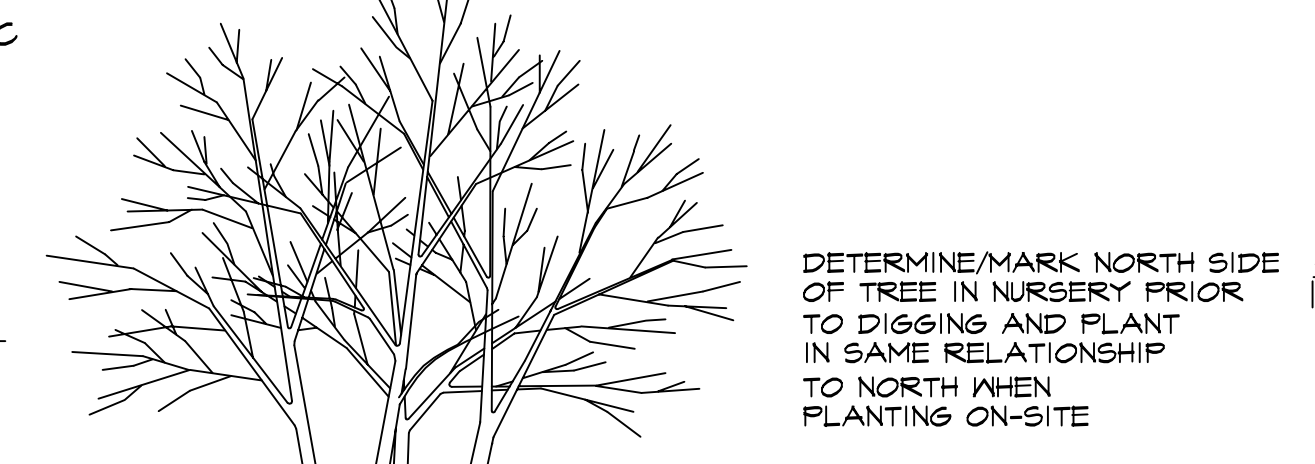

## SPADE-CUT EDGE DETAIL

N.T.S.

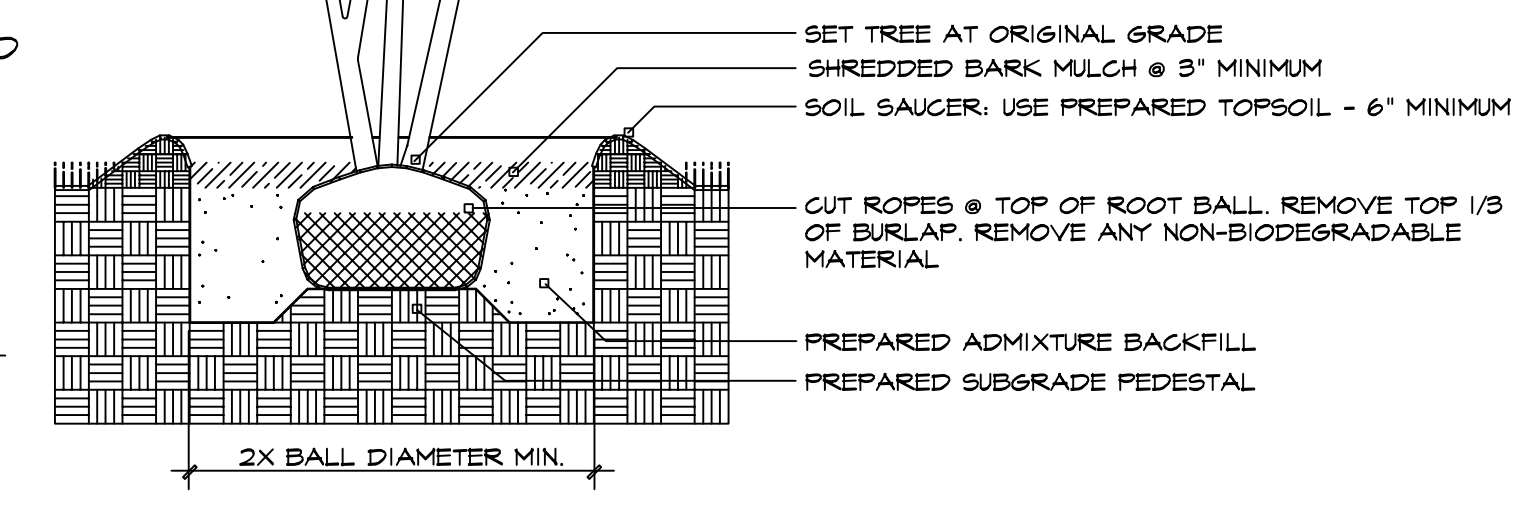

## MULTI-STEM TREE PLANTING

N.T.S.

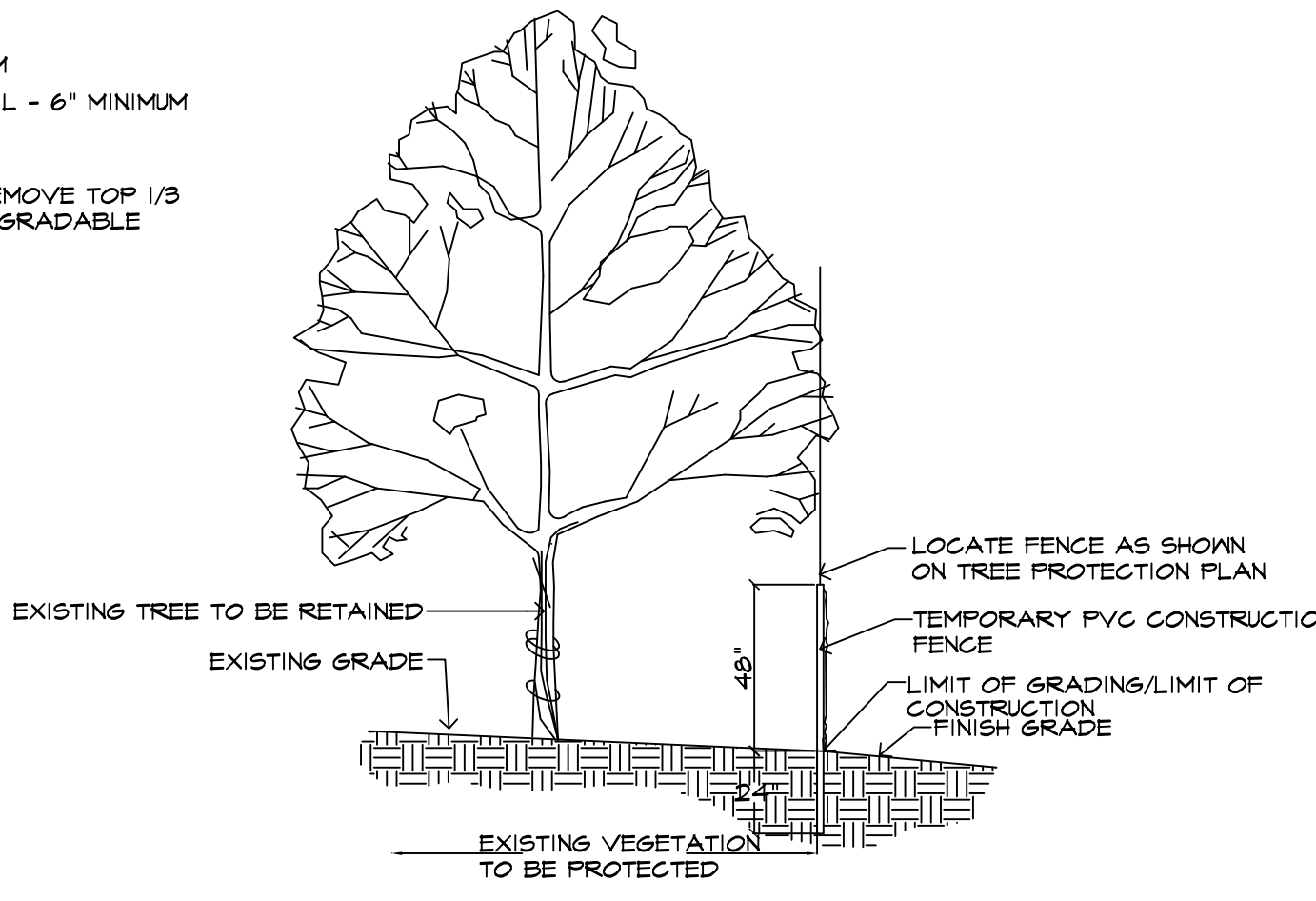
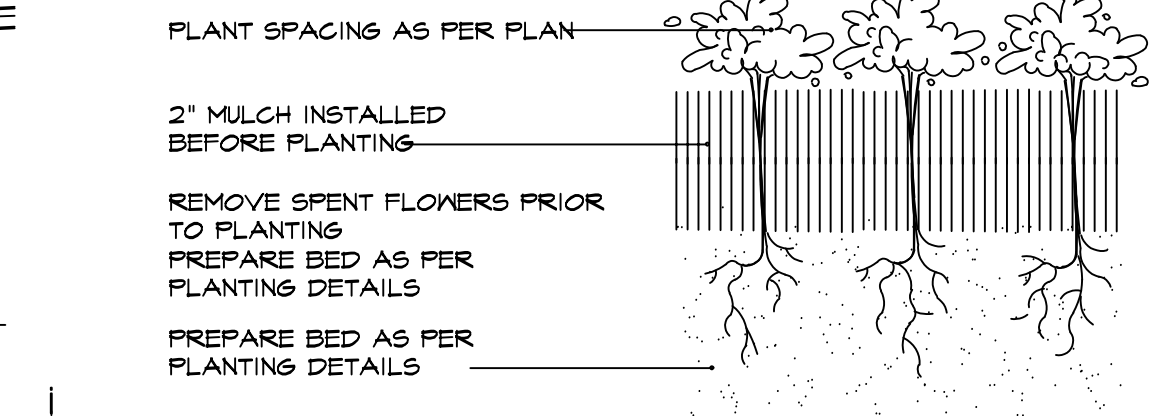

## TREE PROTECTION DETAIL

N.T.S.



## PERENNIAL / ANNUAL PLANTING

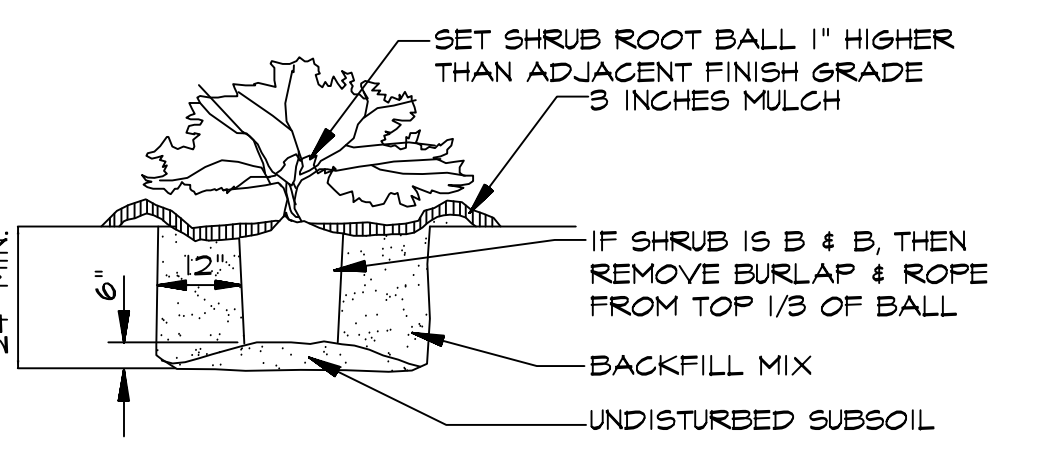

PRUNE ANY BROKEN BRANCHES AFTER PLANTING. DAMAGED SHRUBS OR BROKEN / CRUMBLING ROOT BALLS WILL BE REJECTED.

## SHRUB PLANTING

N.T.S.