

1 TYPICAL CONCRETE HEADWALL
D2 NTS

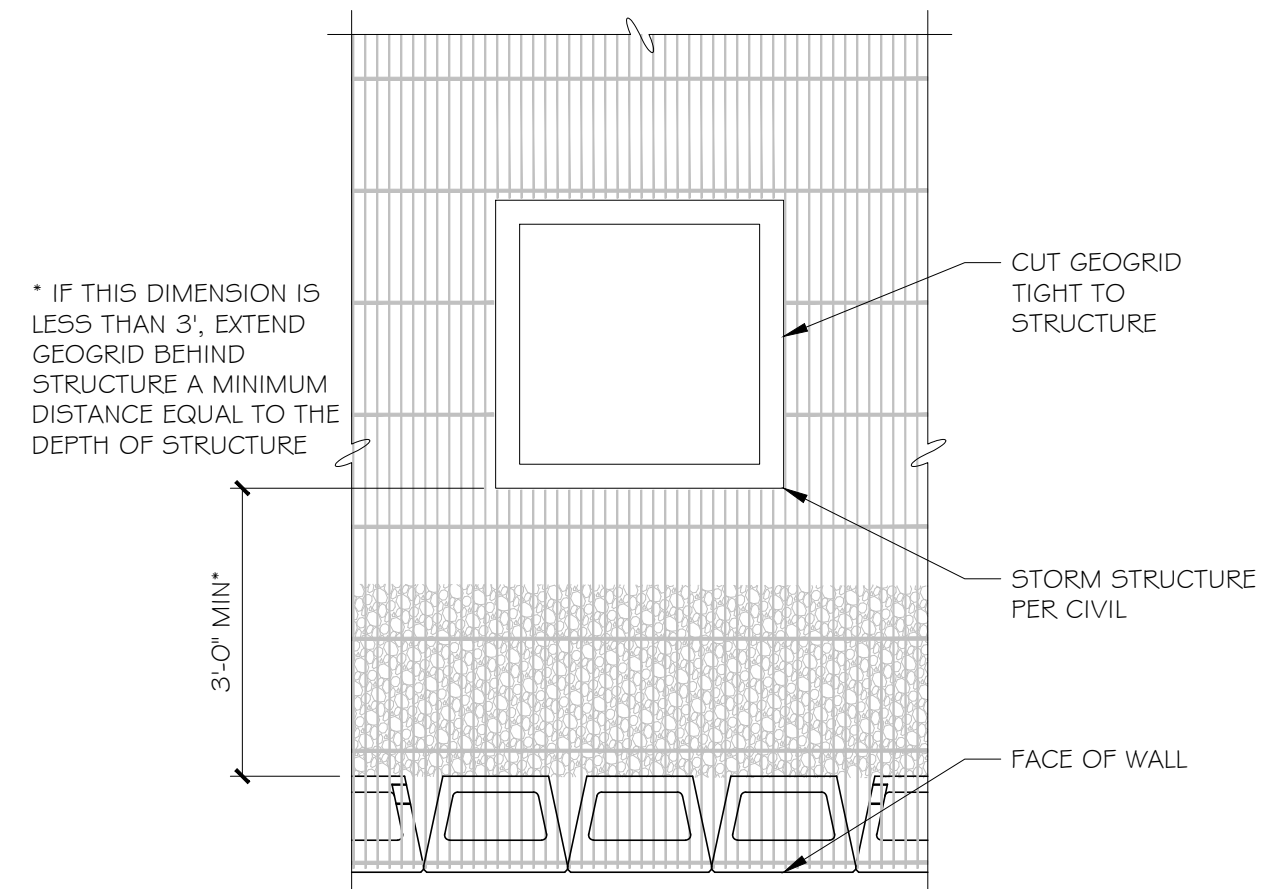

2 TYPICAL SECTION - AT STRUCTURE
D2 NTS

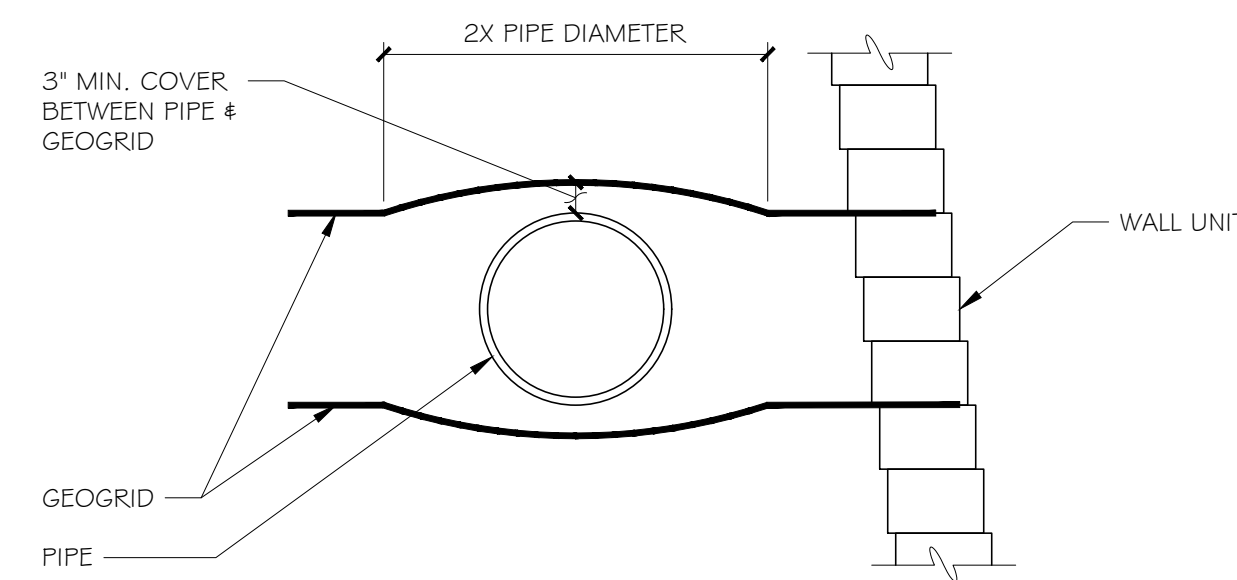

3 TYPICAL SECTION - AT PIPE
D2 NTS

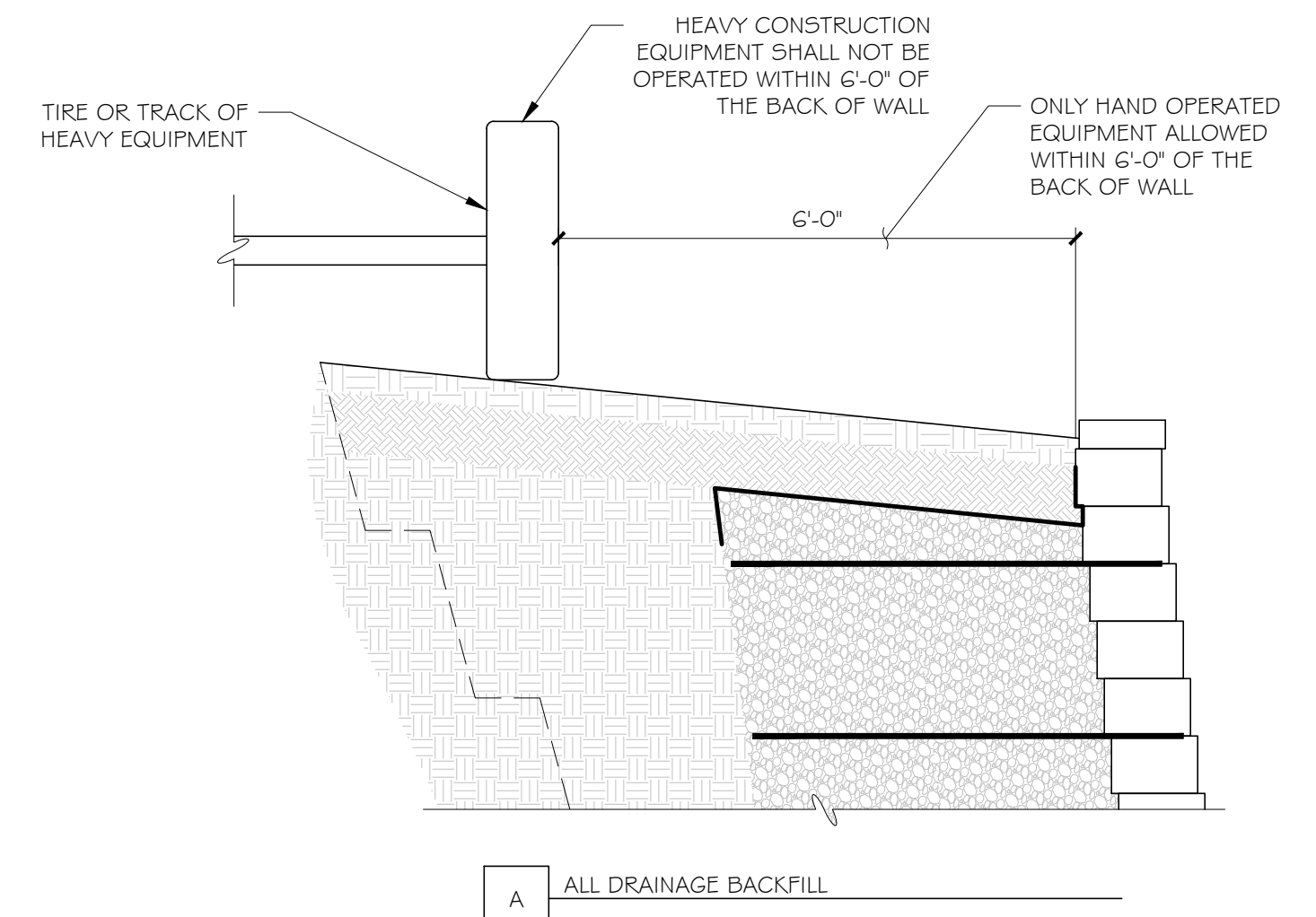

4 HEAVY EQUIPMENT AT TOP OF WALL
D2 NTS
SEE DETAIL I/D1 FOR ADDITIONAL INFORMATION NOT SHOWN

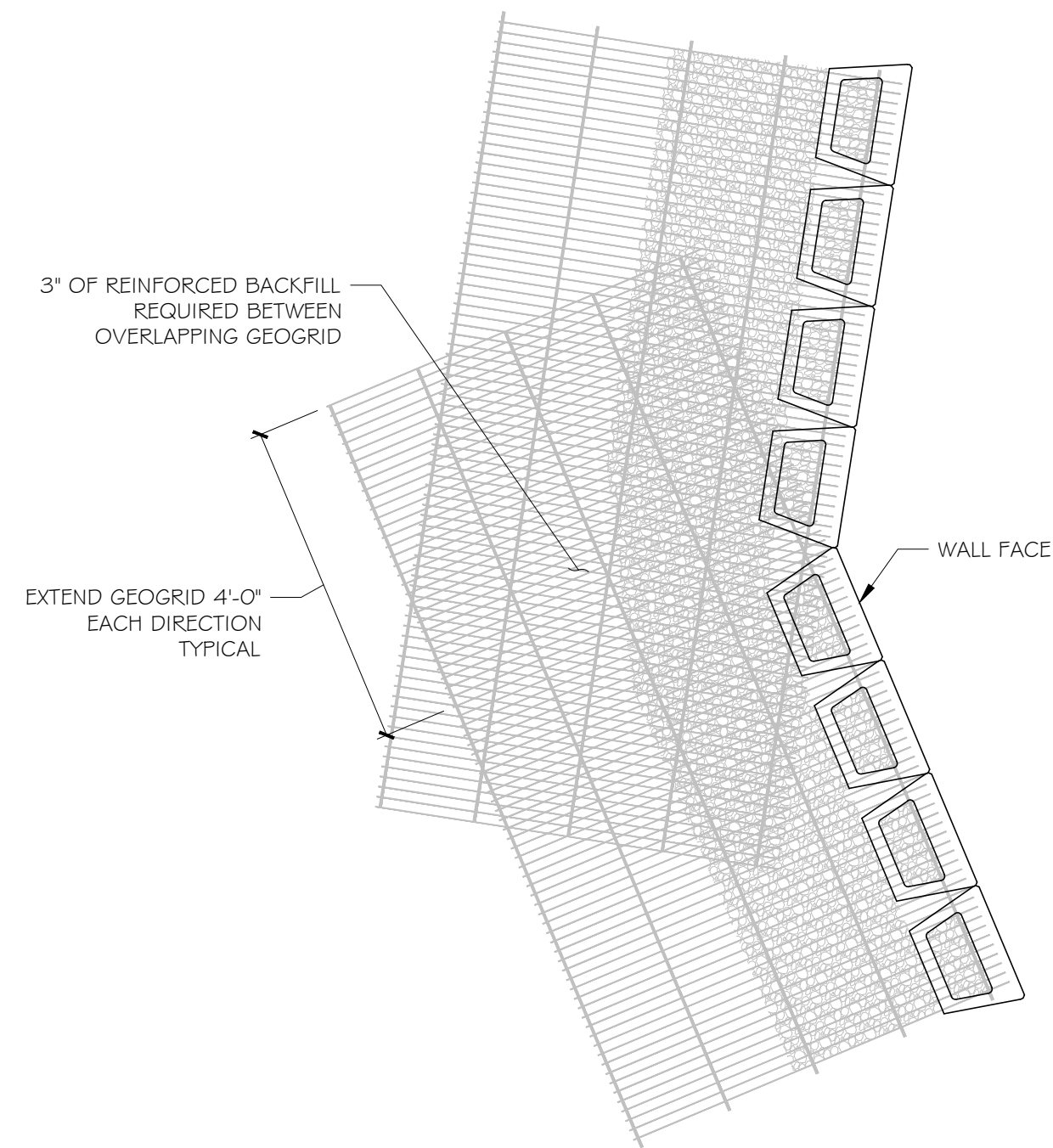

5 ANGLE POINT DETAIL
D2 NTS

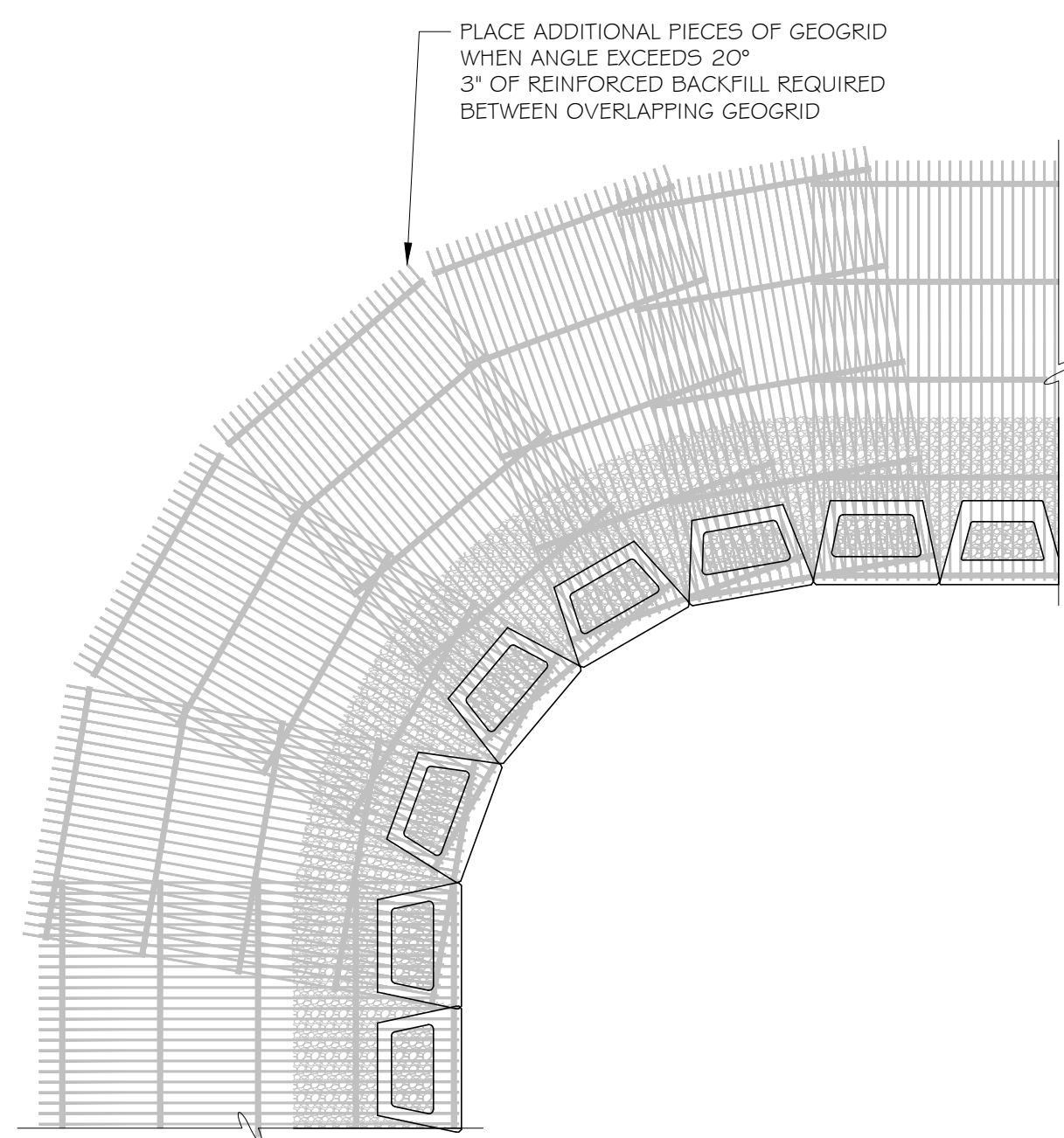

6 TYPICAL CONCAVE CORNER DETAIL
D2 NTS

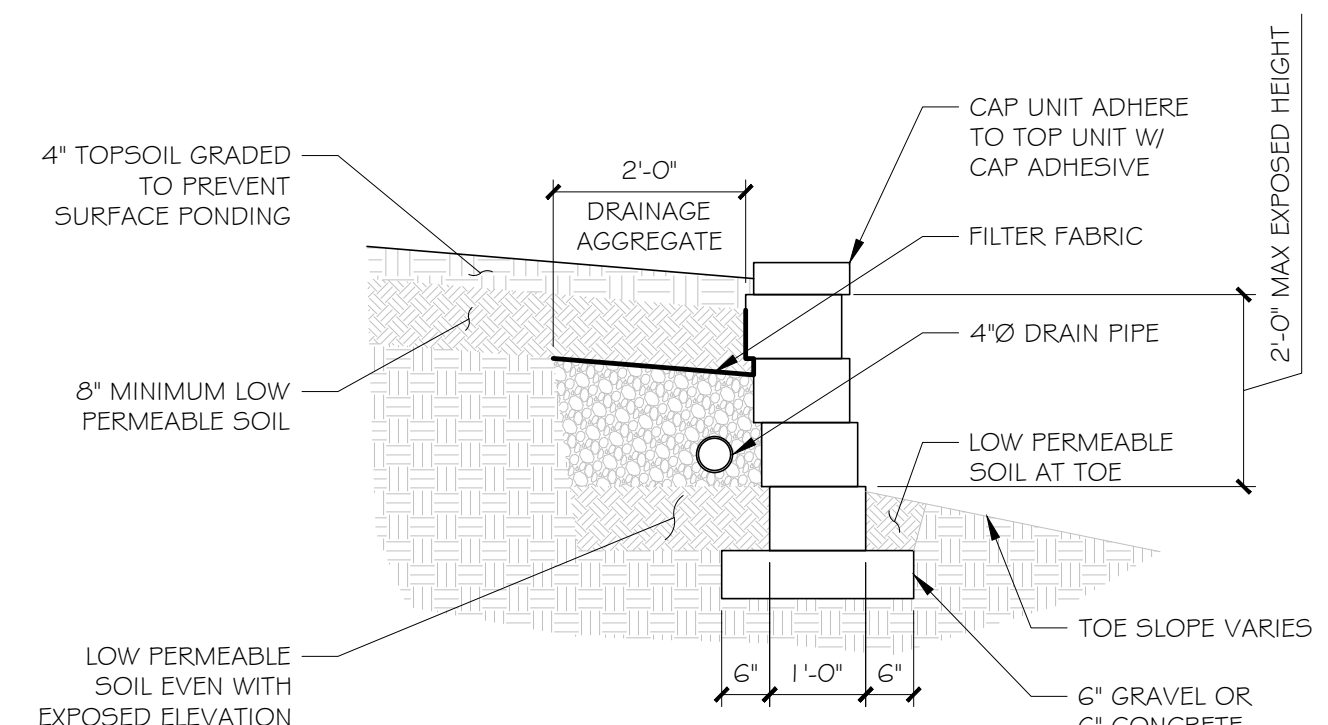

7 TYPICAL SECTION - UNREINFORCED WALL
D2 NTS

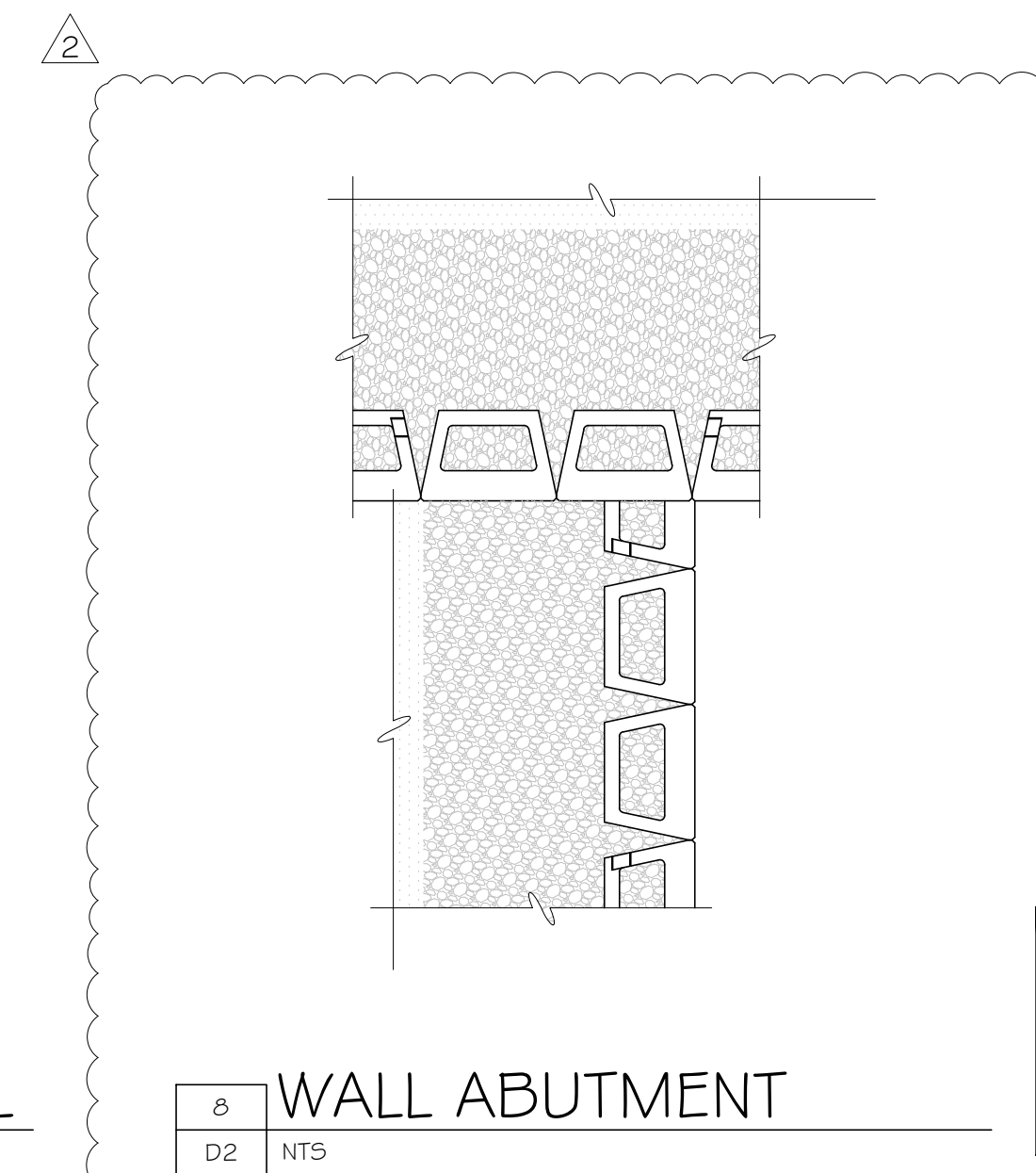

8 WALL ABUTMENT
D2 NTS

STRUCTURAL DESIGN HEREIN REPRESENTS A FINISHED STRUCTURE. THE GENERAL CONTRACTOR/OWNER SHALL PROVIDE ALL INTERIM BRACING, SHORING, INTERIM DRAINAGE PROVISIONS, DRAINAGE DIVERSION AND EROSION PROTECTION REQUIRED UNTIL FINAL CAPPING, PAVING, CURBING AND COMPLETION OF FINAL STORM DRAIN SYSTEM IS COMPLETE.

REV	DATE	DESCRIPTION
3	7-13-23	NO CHANGES THIS SHEET
2	6-28-23	DESIGN REVISION - SUBMITTAL COMS
1	5-9-23	NO CHANGES THIS SHEET

ROSCH ENGINEERING
18390 WINGS CORPORATE DRIVE
CHESTERFIELD, MO 63005
PHONE: 636-519-7770
FAX: 636-532-7773

MO CERTIFICATE OF AUTHORITY #E-2012039663

DOLLAR GENERAL
O'FALLON, MO
RETAINING WALL
DETAILS

DESIGNED:	BCS
DRAWN:	JTM
DESIGN ENGINEER:	ECS
REVIEWED:	BCS
DATE:	3-27-23
JOB NO.:	22-1048
SHEET:	D2



THESE PLANS ARE FOR THE EXCLUSIVE USE OF ROSCH CONSTRUCTION. USE OF THESE PLANS BY ANY OTHER ENTITY TO CONSTRUCT THE SUBJECT STRUCTURES WILL RENDER THE ENGINEERING SEAL SHOWN NULL AND VOID.

3-27-23