

SECTION A-A
4" type 1 or type 5 Aggregate base
7" Bituminous Concrete Base

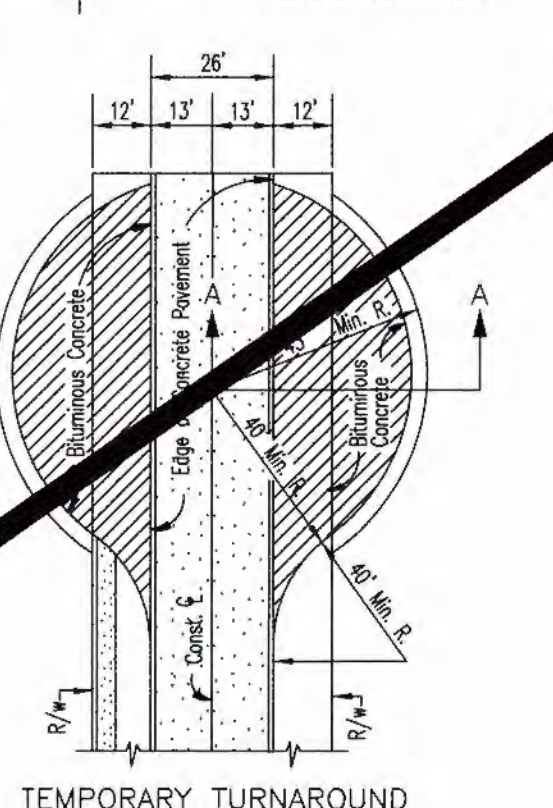

- Permits will not be issued for building construction on lots abutting a temporary turnaround unless and until the turnaround is actually constructed.
- The removal of the temporary turnaround surface, the restoration of the disturbed ground, and the extension of city sidewalk shall be the responsibility of the party(ies) that will be extending the street.
- Other temporary turn around types can be considered depending on type and dimensions.
- Stub streets over two hundred fifty (250) feet shall have a minimum temporary turnaround pavement radius of forty (40) feet, covered by a temporary turnaround easement to remain until the road is extended and platted. In lieu of turnarounds, the Planning and Zoning Commission may approve a "T" or "Y" shaped paved space on streets which are less than two hundred fifty (250) feet in length and are planned to be extended in the future.

CITY OF O'FALLON
ENGINEERING DEPARTMENT
O'FALLON, MISSOURI

PAVEMENT CONSTRUCTION DETAILS
RESIDENTIAL
TEMPORARY TURNAROUND

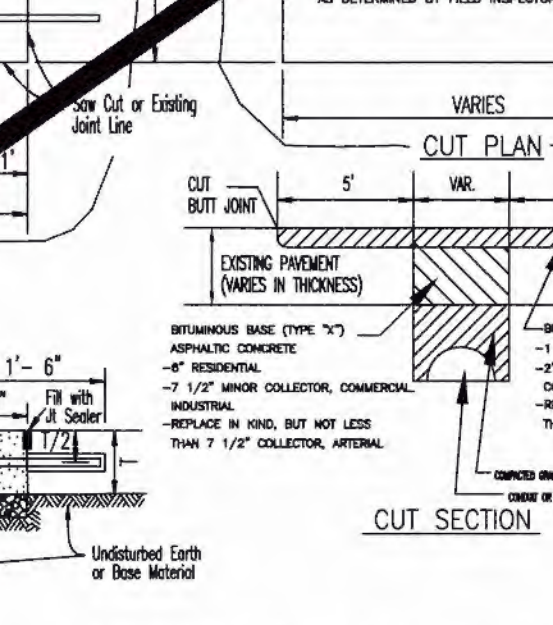
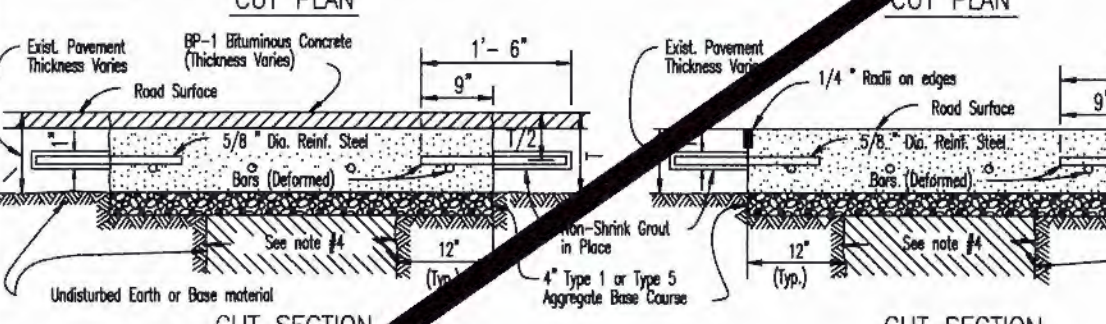
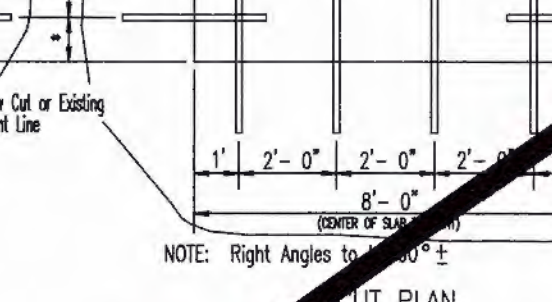
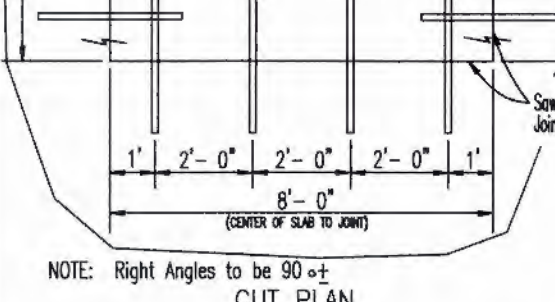

- GENERAL NOTES
- If a permit is issued to reconstruct existing concrete sidewalks, the depth of the concrete pavement to be reconstructed shall be determined by the City Engineer. The depth of the concrete pavement to be reconstructed shall be determined by the City Engineer.
 - Minimum thickness for pavement to be reconstructed shall be 4 inches for residential streets, 6 inches for collector streets, and 8 inches for arterial streets.
 - If the excavations are made in the improved portion of the ROW, the excavations shall be filled with concrete to the existing grade. The concrete shall be placed in a minimum of 4 inch lifts, each lift shall be 4 inches thick. The concrete shall be finished with a broom finish. The concrete shall be cured for a minimum of 7 days before the roadway is opened to traffic.

CITY OF O'FALLON
ENGINEERING DEPARTMENT
O'FALLON, MISSOURI

DETAILS OF TEMPORARY OPENINGS IN ROADWAY PAVEMENT

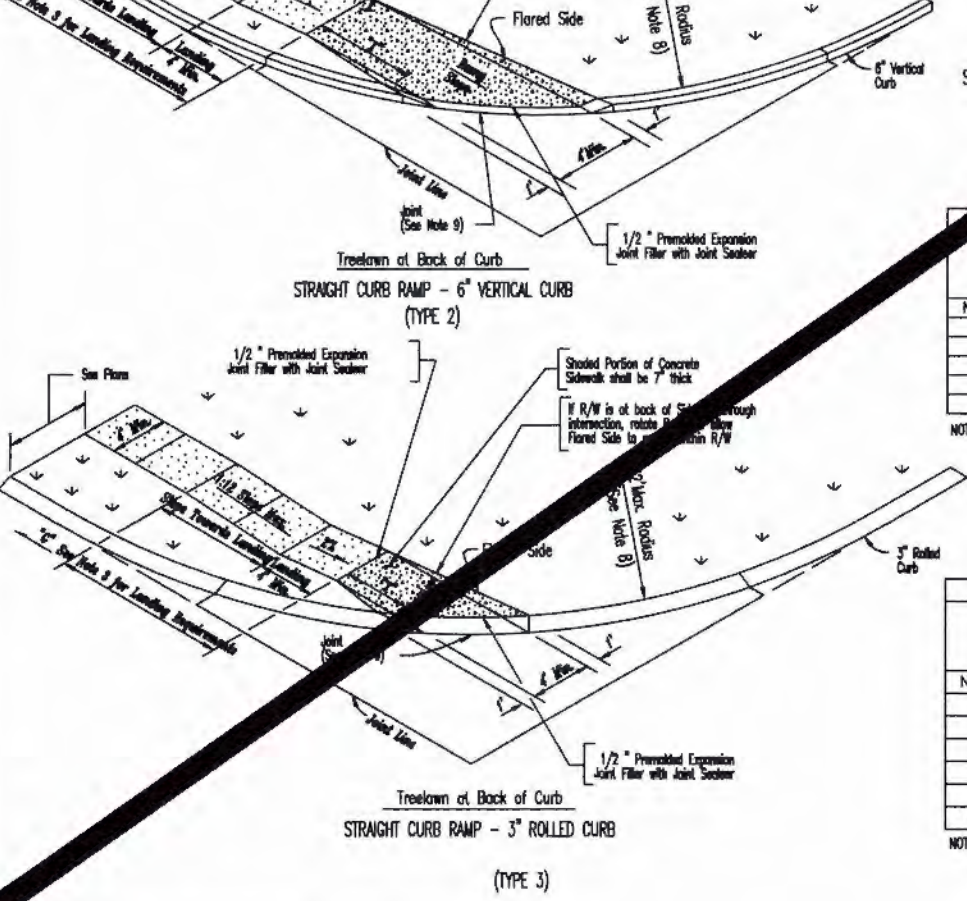

TYPE 1 AND TYPE 2 CURB RAMPS

ALLOY (C) VALUES	MIN. LENGTH OF RAMP (L.F.)
0.10 to 0.12	4
0.13 to 0.15	5
0.16 to 0.18	6
0.19 to 0.21	7
0.22 to 0.24	8
0.25 to 0.27	9
0.28 to 0.30	10
0.31 to 0.33	11
GREATER THAN 0.34	12

NOTE: (1) - Provision may be made for a greater length of ramp.

- GENERAL NOTES
- Do not scale drawing. Follow dimensions.
 - Sidewalks and sidewalk curb ramps shall be constructed in accordance with these details and the current approved American Disabilities Act Accessibility Guidelines (ADAAG).
 - Sidewalk cross slope shall be 0.02'/ft. Minimum sidewalk width shall be 5 feet. Minimum sidewalk width shall be 3 feet for ramps.
 - Where curb ramps meet pavement, bullnose will not be permitted.
 - If integral concrete curb is constructed, strike a dummy joint across bottom of ramp at curb line. If concrete curb is cast-in-place, back out pavement to provide full depth curb across ramp from outer point of curb taper to outer point of curb taper.
 - For sidewalk locations on Cul-De-Sacs, refer to "Pavement Construction Details".
 - For roadway cross slopes, pavement types, and thicknesses, refer to "Standard Typical Sections".
 - The intersection of two sidewalks or the intersection of a sidewalk and a driveway may serve as a wheelchair passing space on sidewalks less than 5 feet wide.
 - All curb ramps shall have a detectable warning complying with Americans with Disabilities Act Accessibility Guidelines (ADAAG).

CITY OF O'FALLON
ENGINEERING DEPARTMENT
O'FALLON, MISSOURI

CONCRETE SIDEWALK WITHIN CUL-DE-SACS

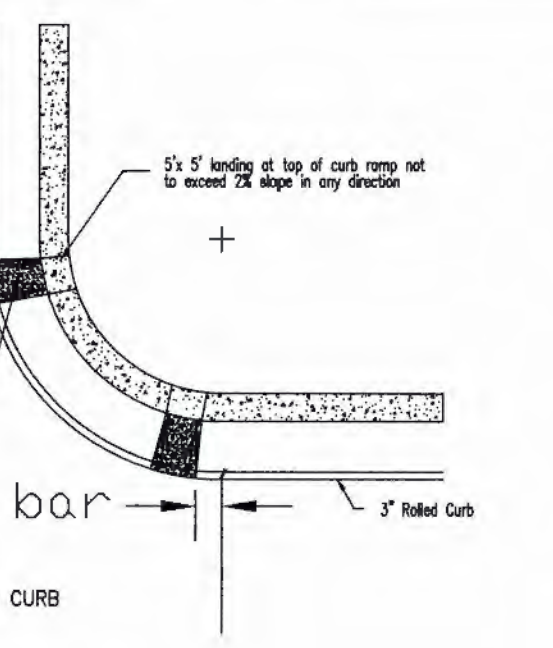
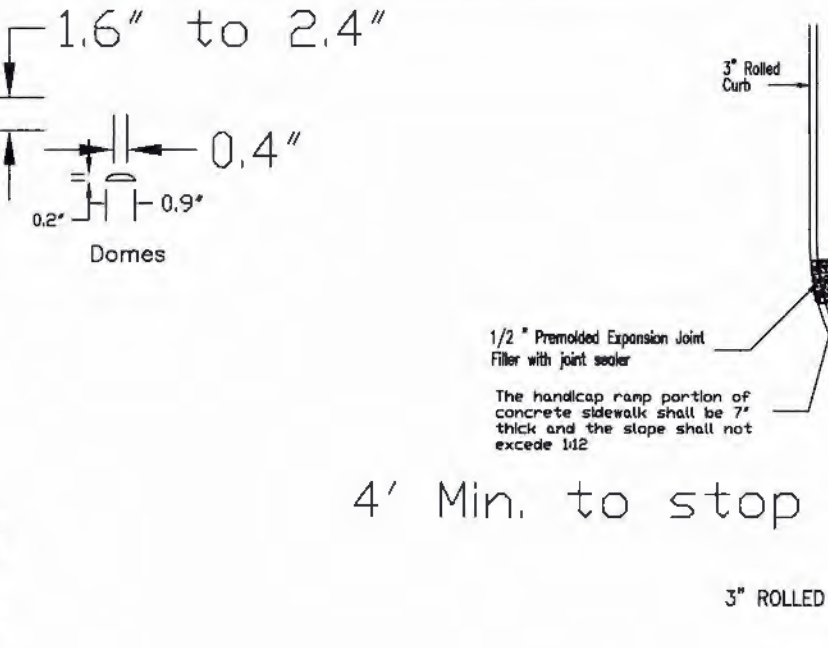
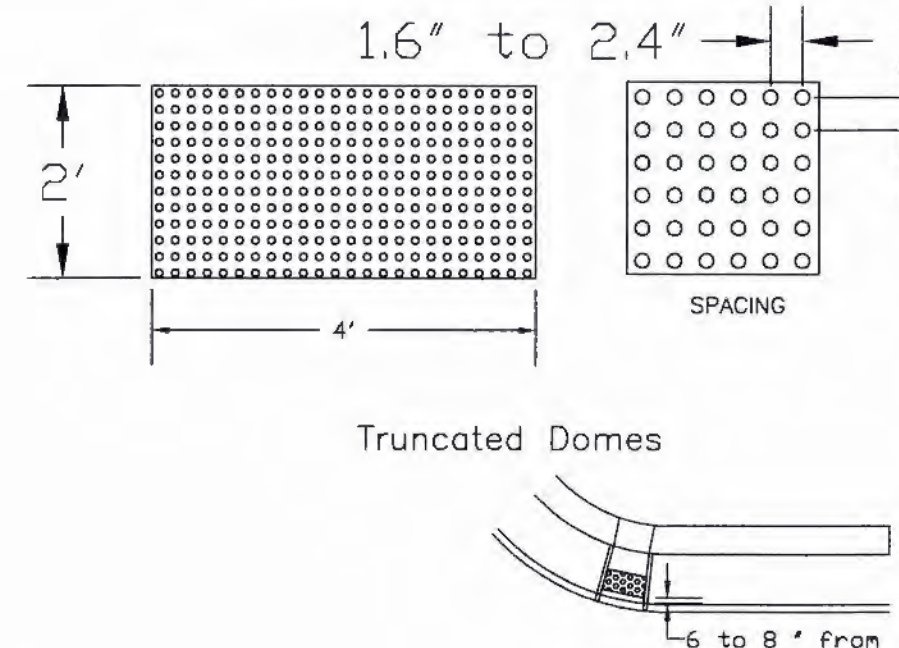
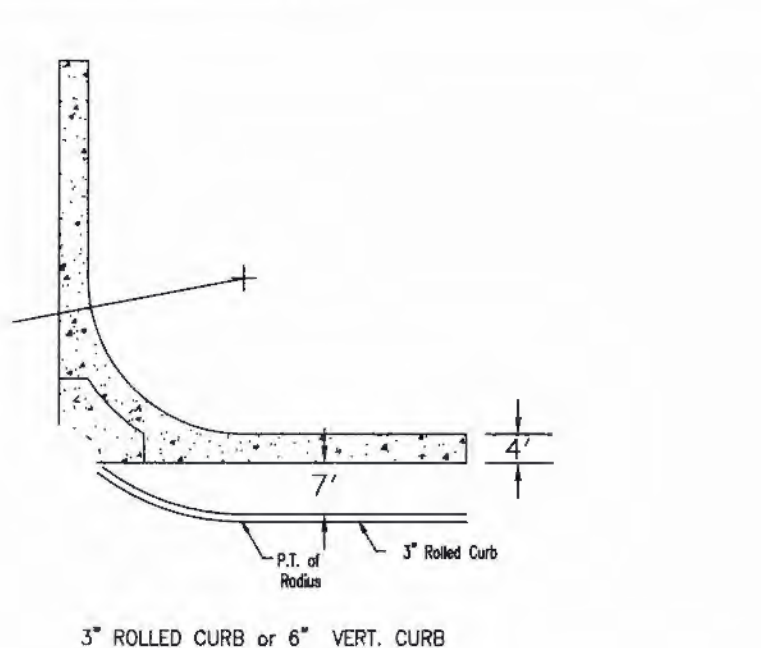

- GENERAL NOTES
- Do not scale drawing. Follow dimensions.
 - Sidewalks and sidewalk curb ramps shall be constructed in accordance with these details and the current approved American Disabilities Act Accessibility Guidelines (ADAAG).
 - Minimum sidewalk width shall be 5 feet. Minimum sidewalk width shall be 3 feet for ramps.
 - All sidewalk widths shall be 4 feet, except where indicated as 7 feet by shaded portions shown on details.
 - Where curb ramps meet pavement, bullnose will not be permitted.
 - If integral concrete curb is constructed, strike a dummy joint across bottom of ramp at curb line. If concrete curb is cast-in-place, back out pavement to provide full depth curb across ramp from outer point of curb taper to outer point of curb taper.
 - For pavement longitudinal and transverse joints and dowel and tie bar requirements and dimensions, refer to the "Pavement Construction Details for Arterials and Collectors".
 - For roadway cross slopes, pavement types, and thicknesses, refer to "Standard Typical Sections".
 - The intersection of two sidewalks or the intersection of a sidewalk and a driveway may serve as a wheelchair passing space on sidewalks less than 5 feet wide.
 - All curb ramps shall have a detectable warning complying with Americans with Disabilities Act Accessibility Guidelines (ADAAG).
 - All ramps must line up with the corresponding existing curb on the other side of the street.
 - All truncated domes shall run parallel to the road that it's crossing.
 - Truncated warning domes shall not be stamped and will be an ADA approved product.

CITY OF O'FALLON
ENGINEERING DEPARTMENT
O'FALLON, MISSOURI

PAVEMENT CONSTRUCTION DETAILS
CONCRETE SIDEWALK AND CURB RAMPS

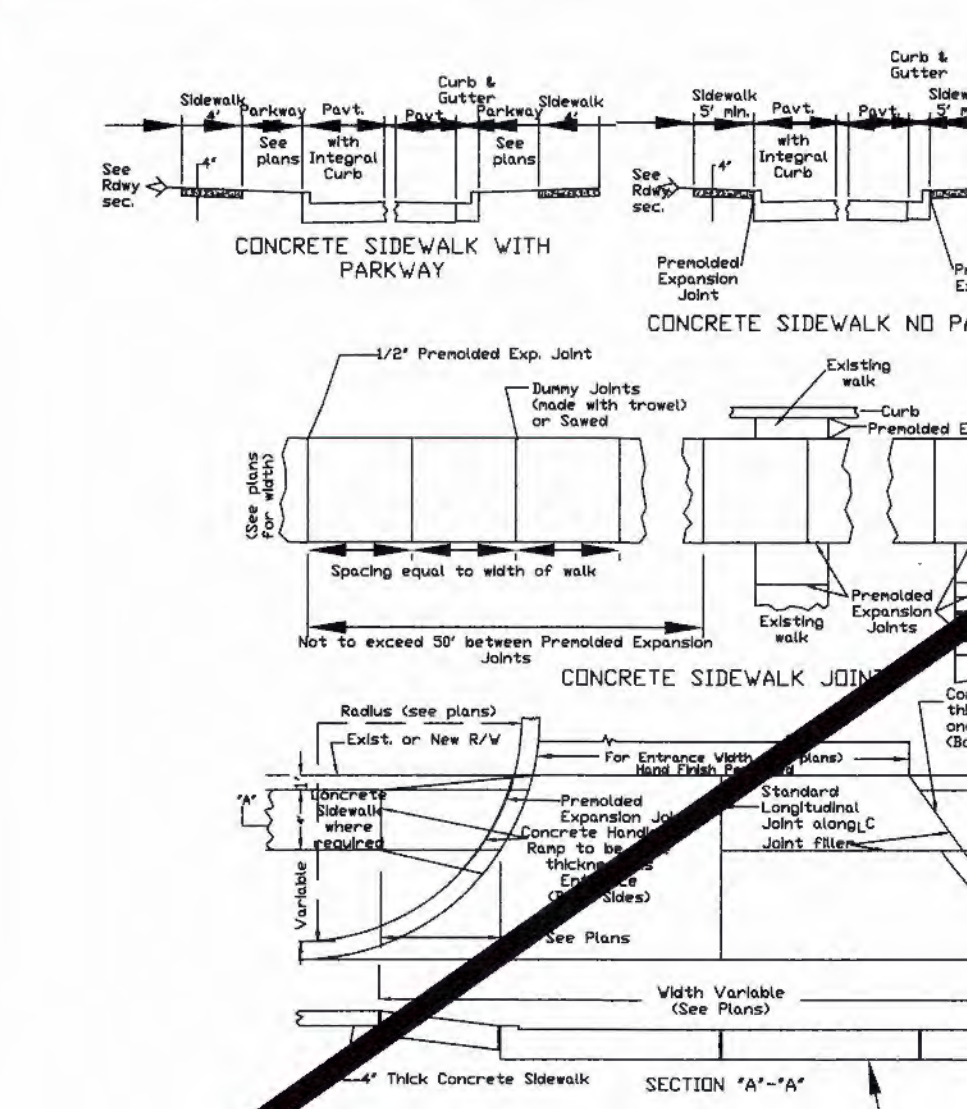

TYPE 3 CURB RAMP

ALLOY (C) VALUES	MIN. LENGTH OF RAMP (L.F.)
0.10 to 0.12	4
0.13 to 0.15	5
0.16 to 0.18	6
0.19 to 0.21	7
0.22 to 0.24	8
0.25 to 0.27	9
0.28 to 0.30	10
0.31 to 0.33	11
GREATER THAN 0.34	12

NOTE: (1) - Provision may be made for a greater length of ramp.

- GENERAL NOTES
- Do not scale drawing. Follow dimensions.
 - Sidewalk cross slope shall be 0.02'/ft.
 - Sidewalk thickness shall increase to 6 inches on each side of concrete Driveways and 7 inches on each side of commercial Driveways for one direction of travel. Sidewalk thickness shall increase to 8 inches on each side of the sidewalk. See "Entrance Construction Details".
 - For sidewalk locations on Cul-De-Sacs see "Pavement Construction Details".
 - For longitudinal and transverse joints, dowel, and tie bar requirements and dimensions refer to the "Integral Curb Pavement Typical Sections and Details".
 - For roadway cross slopes, pavement types, and thickness, refer to "Standard Typical Section".

CITY OF O'FALLON
ENGINEERING DEPARTMENT
O'FALLON, MISSOURI

CONCRETE SIDEWALK THROUGH COMMERCIAL ENTRANCES

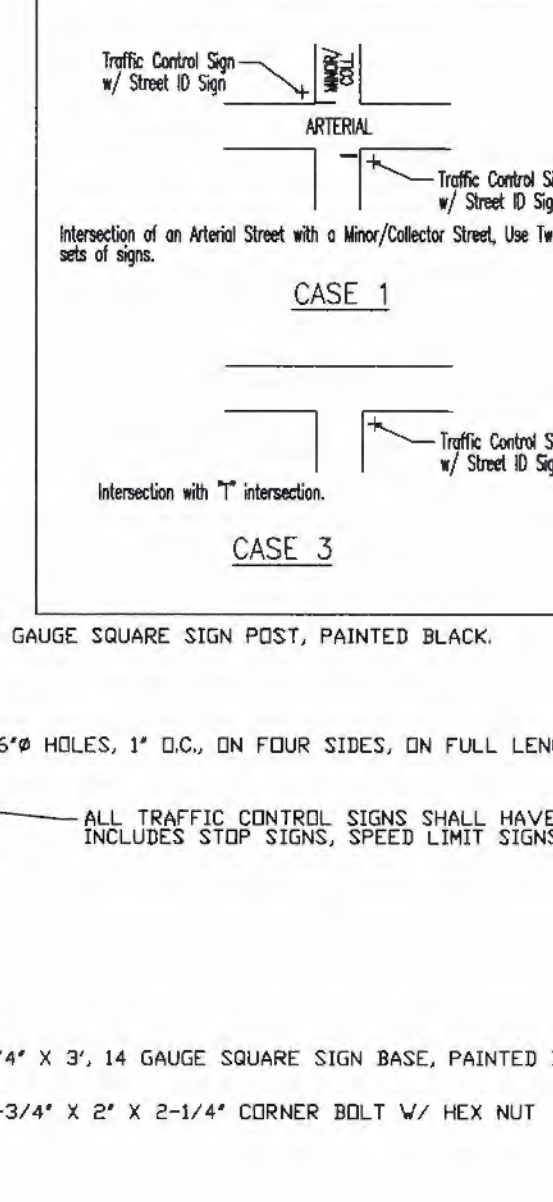
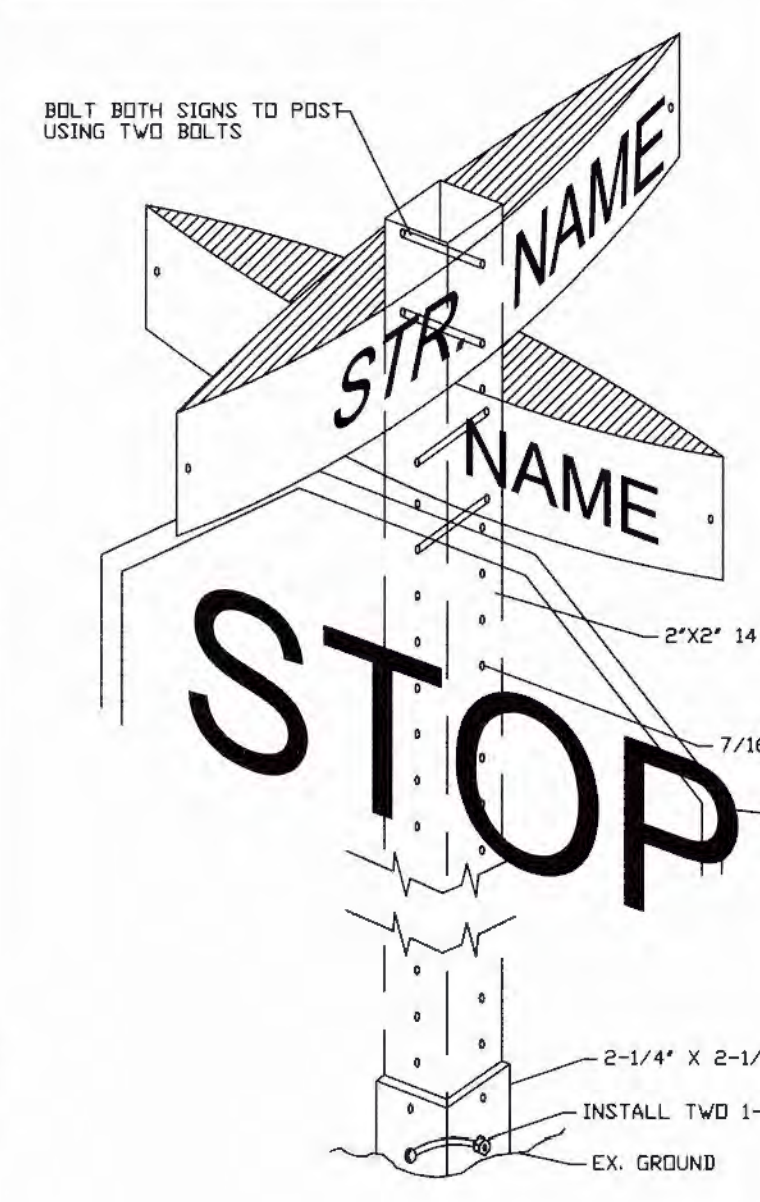
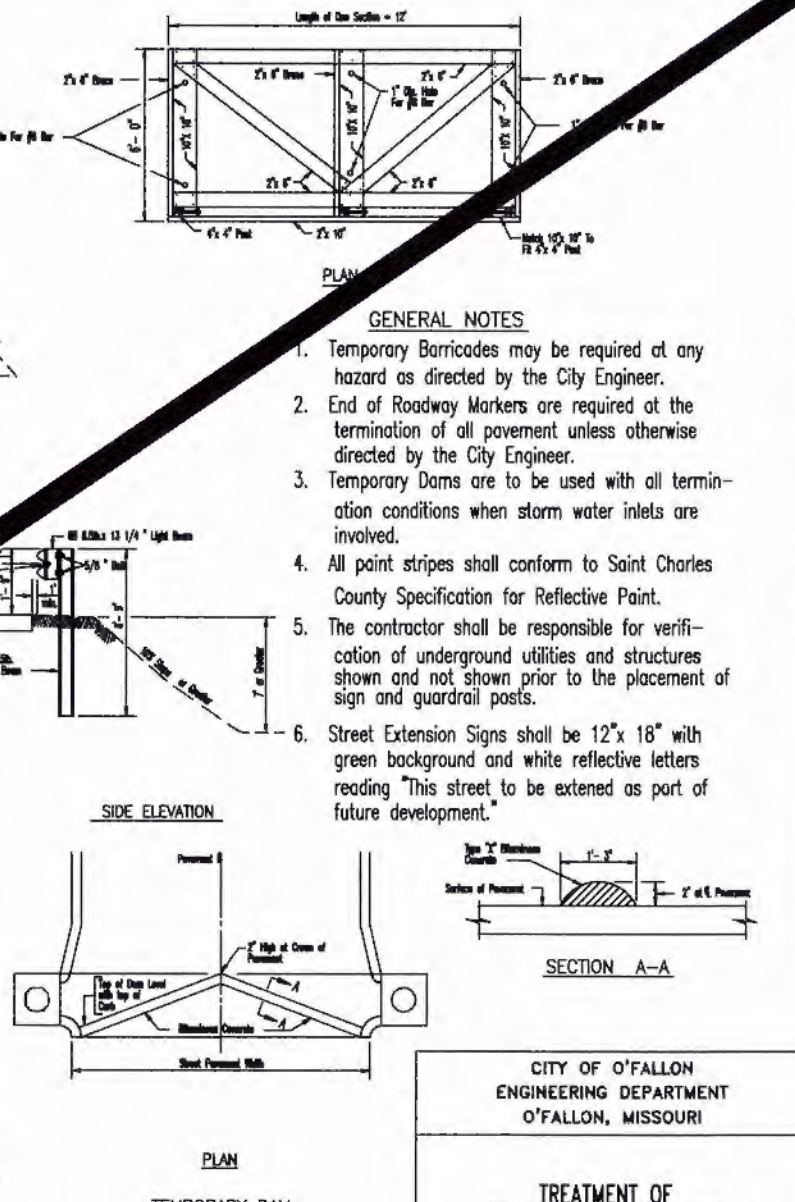
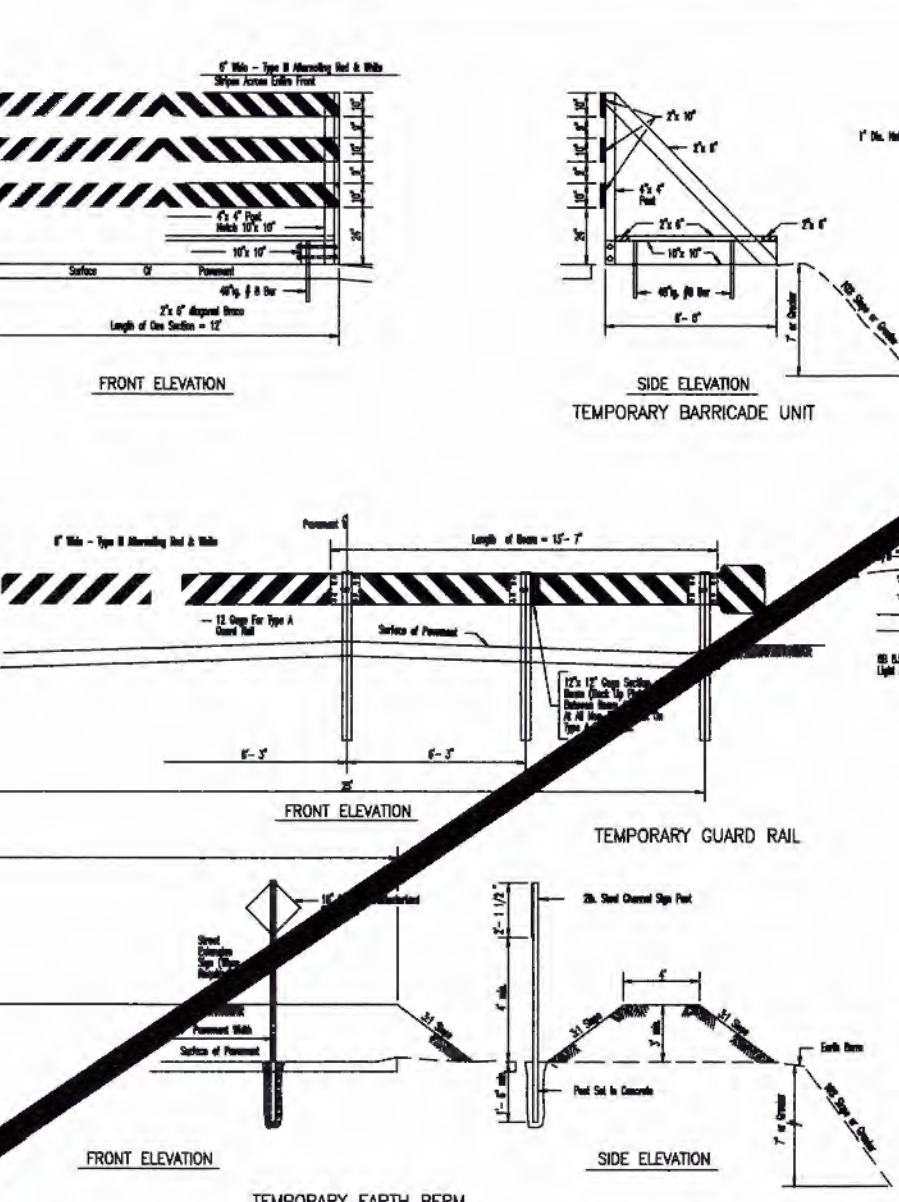

- GENERAL NOTES
- Temporary barricades may be required at any hazard as directed by the City Engineer.
 - End of roadway markers are required at the termination of all pavement unless otherwise directed by the City Engineer.
 - Temporary dams are to be used with all termination conditions when storm water inlets are involved.
 - All point stripes shall conform to Saint Charles County Specification for Reflective Paint.
 - The contractor shall be responsible for verification of underground utilities and structures shown on and not shown prior to the placement of sign and guardrail posts.
 - Street Extension Signs shall be 12" x 18" with green background and white reflective letters reading "This street to be entered as part of future development."

CITY OF O'FALLON
ENGINEERING DEPARTMENT
O'FALLON, MISSOURI

TREATMENT OF TEMPORARY TERMINATIONS OF ROADWAY PAVEMENT

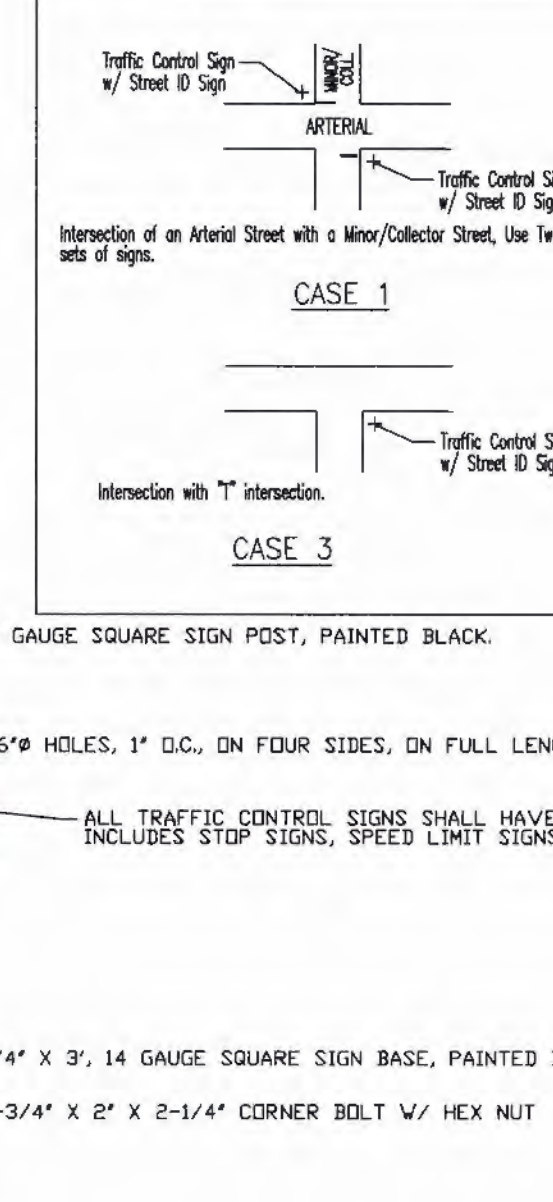
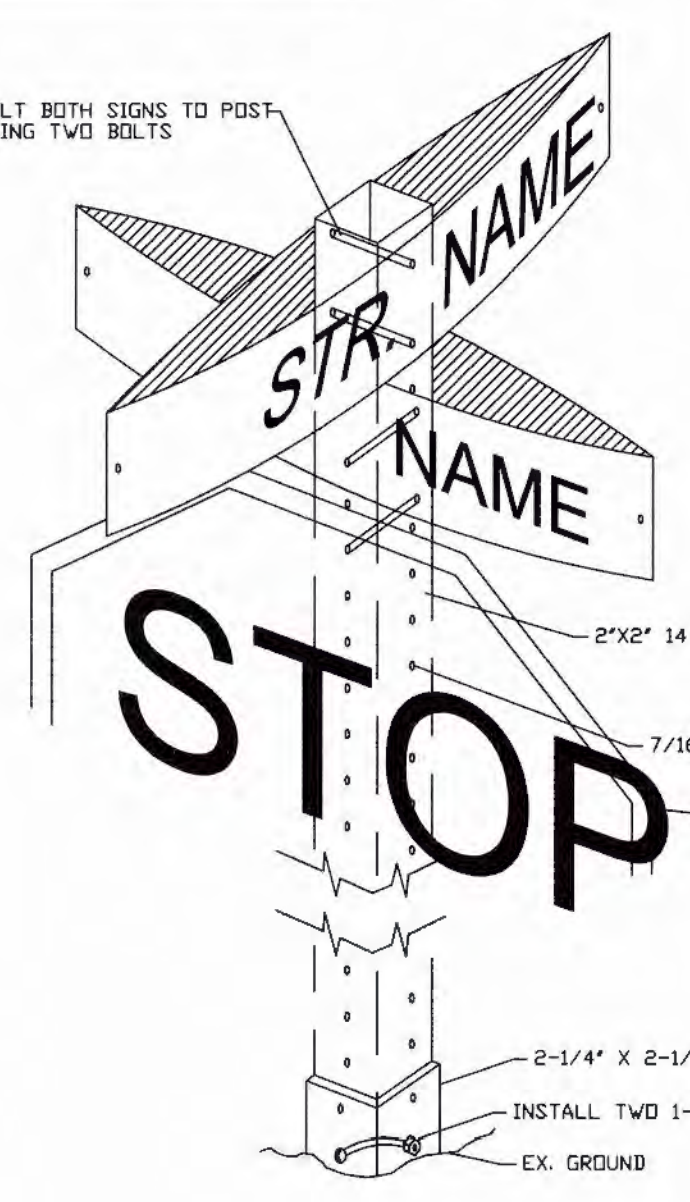

- GENERAL NOTES
- TRAFFIC CONTROL SIGNS SHALL HAVE THE BACK SIDES PAINTED BLACK. INCLUDES STOP SIGNS, SPEED LIMIT SIGNS, YIELD SIGNS, NO PARKING SIGNS, ETC.
 - TRAFFIC CONTROL SIGNS SHALL BE 7 INCH SIGN ENGINEER GRADE SHEETING OR APPROVED EQUAL WHITE REFLECTIVE WITH THE CITY OF O'FALLON LOGO WITH A 1/4\"/>

CITY OF O'FALLON
ENGINEERING DEPARTMENT
O'FALLON, MISSOURI

ARTERIAL SIGNS

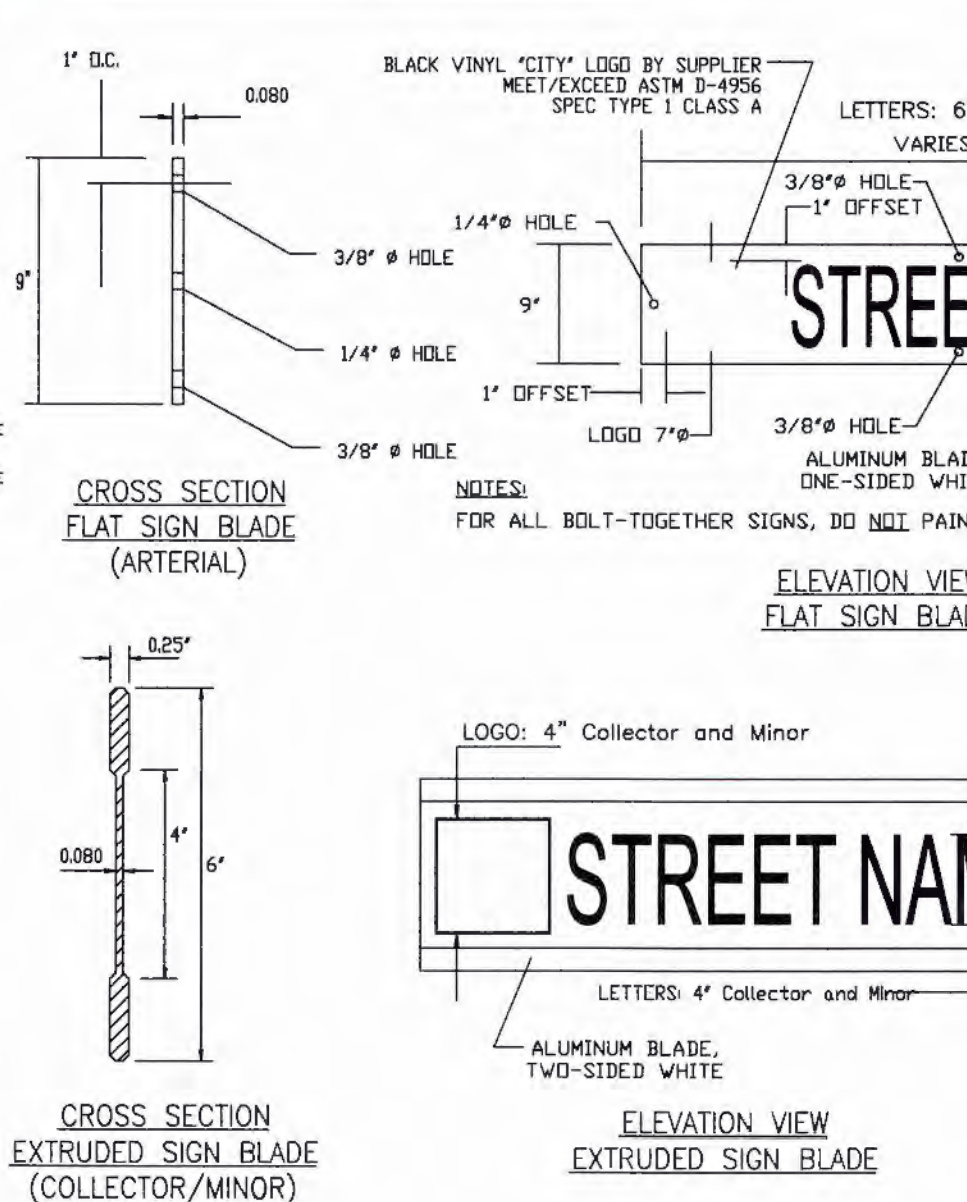

- GENERAL NOTES
- ALL SIGN POST AND BACK OF SIGNS THAT ARE TO BE PAINTED BLACK SHALL USE A PAINT SYSTEM THAT PROVIDES A MINIMUM 7 YEAR LIFE EXPECTANCY. MAY USE: (1) CARBONE BLACK PIGMENT BASE AT 1-3 MILS THICK, CARBONE 800 500 MID-LAYER AT 3-5 MILS THICK, CARBONE 120 800 TOP COAT OR APPROVED EQUAL OR (2) ELECTROSTATIC APPLIED, BLACK POWDER COATED AND BAKED ON PAINT SYSTEM AT 0-3 MILS THICKNESS OR APPROVED EQUAL.
 - ALL SIGN LOCATIONS AND SIZES MUST BE APPROVED BY THE ENGINEERING DIVISION PRIOR TO INSTALLATION.
 - STREET NAME SIGN PLATES SHALL BE 1/2\"/>

CITY OF O'FALLON
ENGINEERING DEPARTMENT
O'FALLON, MISSOURI

SIGNS, DETAILS AND LOCATIONS

PROJECT TITLE:
EL TO PEPE MEXICAN RESTAURANT

315 WEST TERRA LANE
O'FALLON, ST. CHARLES,
MISSOURI 63366

Box Project # 97-955A Issue Date: Oct/12/2017

ENGINEERING
PLANNING
SURVEYING

222 Point View Blvd
St. Charles, MO 63301
636-928-5552
FAX 636-928-1718

DISCLAIMER OF RESPONSIBILITY
I hereby specify that the documents intended to be authenticated by my seal are limited to this sheet, and I hereby disclaim any responsibility for all other drawings, specifications, estimates, reports or other documents or instruments relating to or intended to be used for any part or parts of the architectural or engineering project or survey.

REFERENCE
DRAWING

REVISIONS

DATE	CITY COMMENTS
09/19/17	CITY COMMENTS
10/04/17	CITY COMMENTS

Developer / Owner:
WR HOLMAN, LLC
2 HICKORY HILL DRIVE
O'FALLON, MISSOURI 63366
(636) 734-1815

P+Z No. 33-14.01
CUP No. 33-14.01.01
Page No. 13 of 18

ROADWAY, SIDEWALK AND SIGN DETAILS