



**Product Details:**  
 Dimensions Length 18.38" / Depth 2.375" / Height 36" (46" In Ground) / Mounting Plates 6"  
 Weight Surface Mount: 32-lbs In-ground: 36-lbs  
 Styling Contemporary  
 Capacity Holds 3 Bikes  
 Finish Durable baked-on powder coat, high-grade galvanized steel, or electrostatically oven cured SealGuard™  
 Construction Heavy-Duty 2 3/8" O.D. Steel

**Mounting Types:**

**Surface:**  
 Bolts through bottom plate into pre-drilled concrete into ground anchors. Use appropriate length and size bolt for local requirements.

**IG = In-Ground:**  
 Embedded in hole filled with concrete. Depth of the hole varies depending on local code.

Depth varies depending on local code

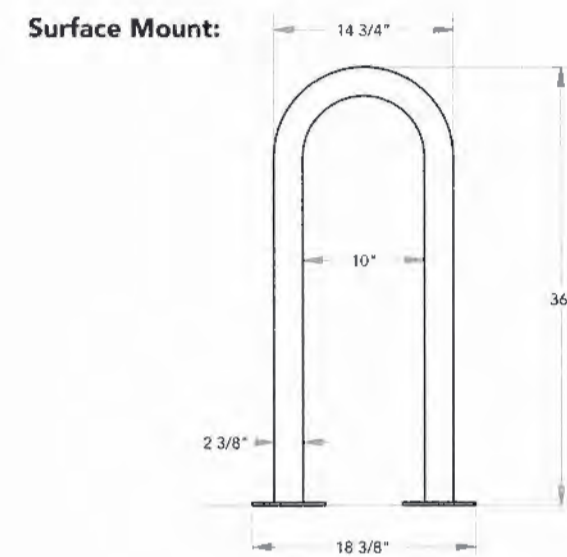
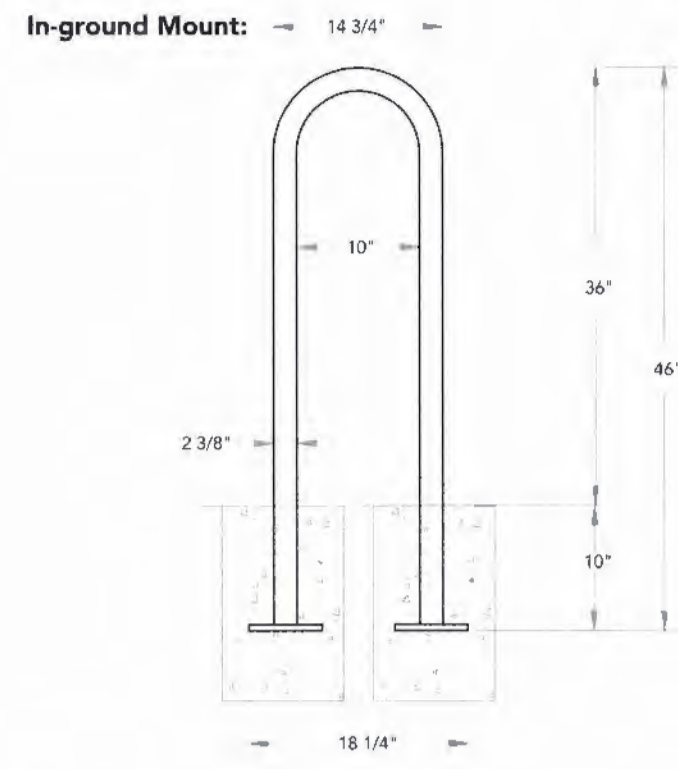
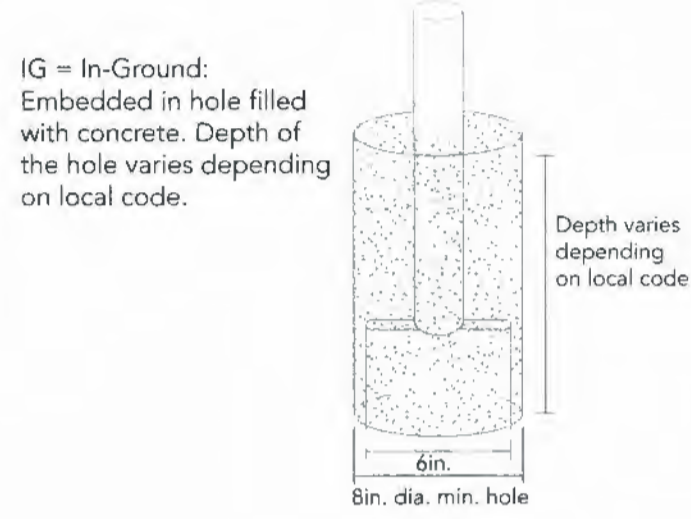
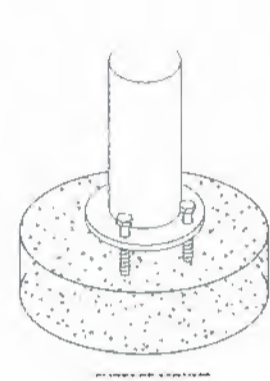

BIKE RACK DETAIL  
USE OR SIMILAR

REFERENCE DRAWINGS ONLY  
 ENGINEERS SEAL DOES NOT APPLY  
 TO DETAILS ABOVE.

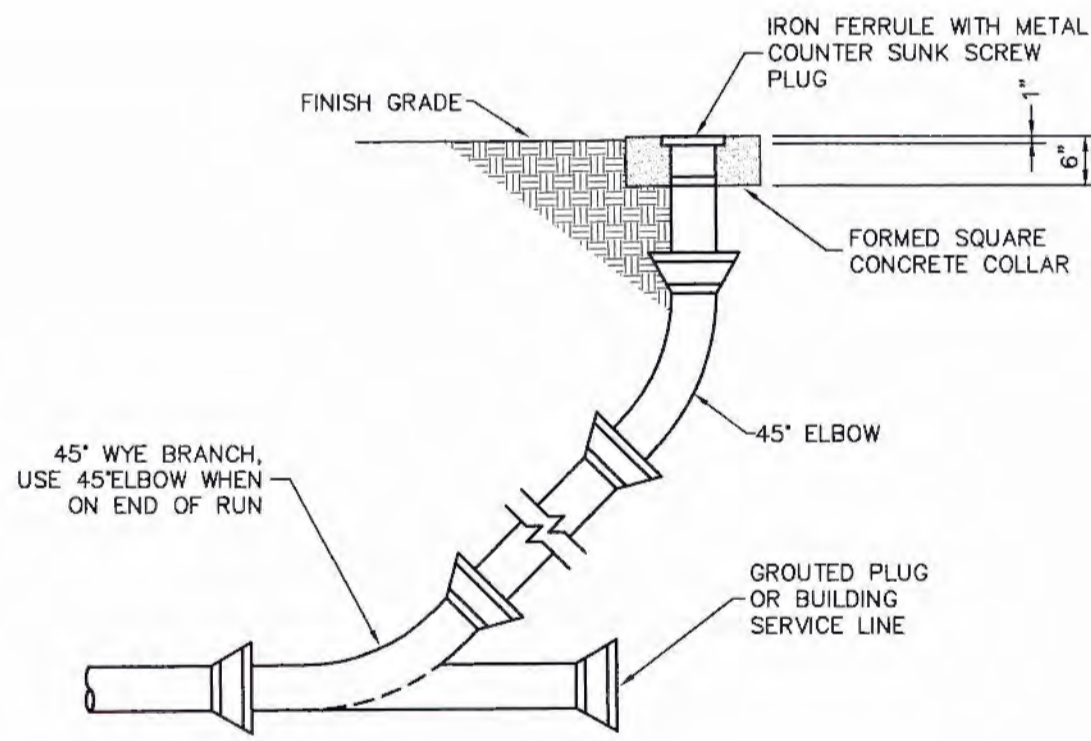

SEWER CLEANOUT  
NOT TO SCALE

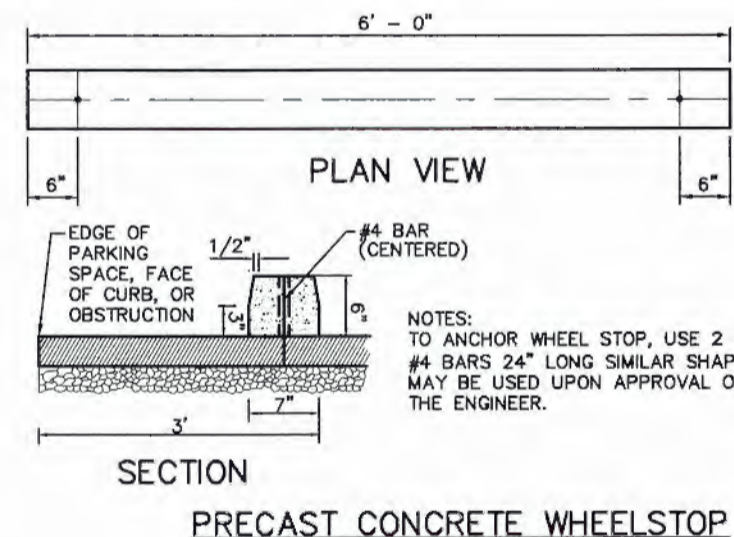

PRECAST CONCRETE WHEELSTOP

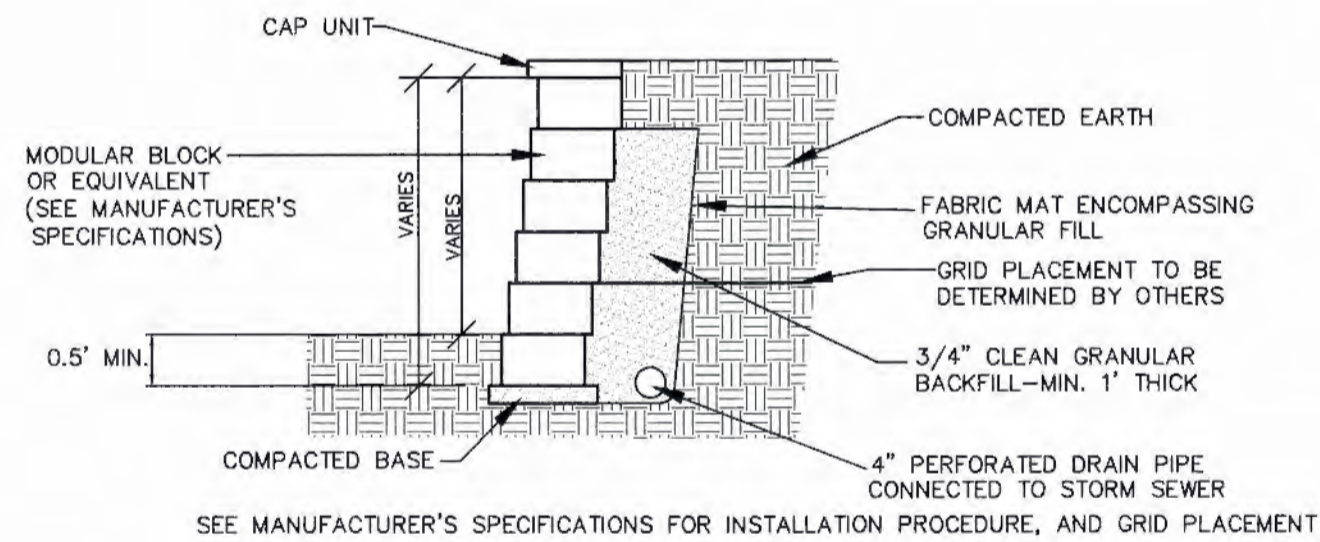

MODULAR BLOCK CONCRETE RETAINING WALL  
(RETAINING WALL DESIGN BY OTHERS)  
NOT TO SCALE

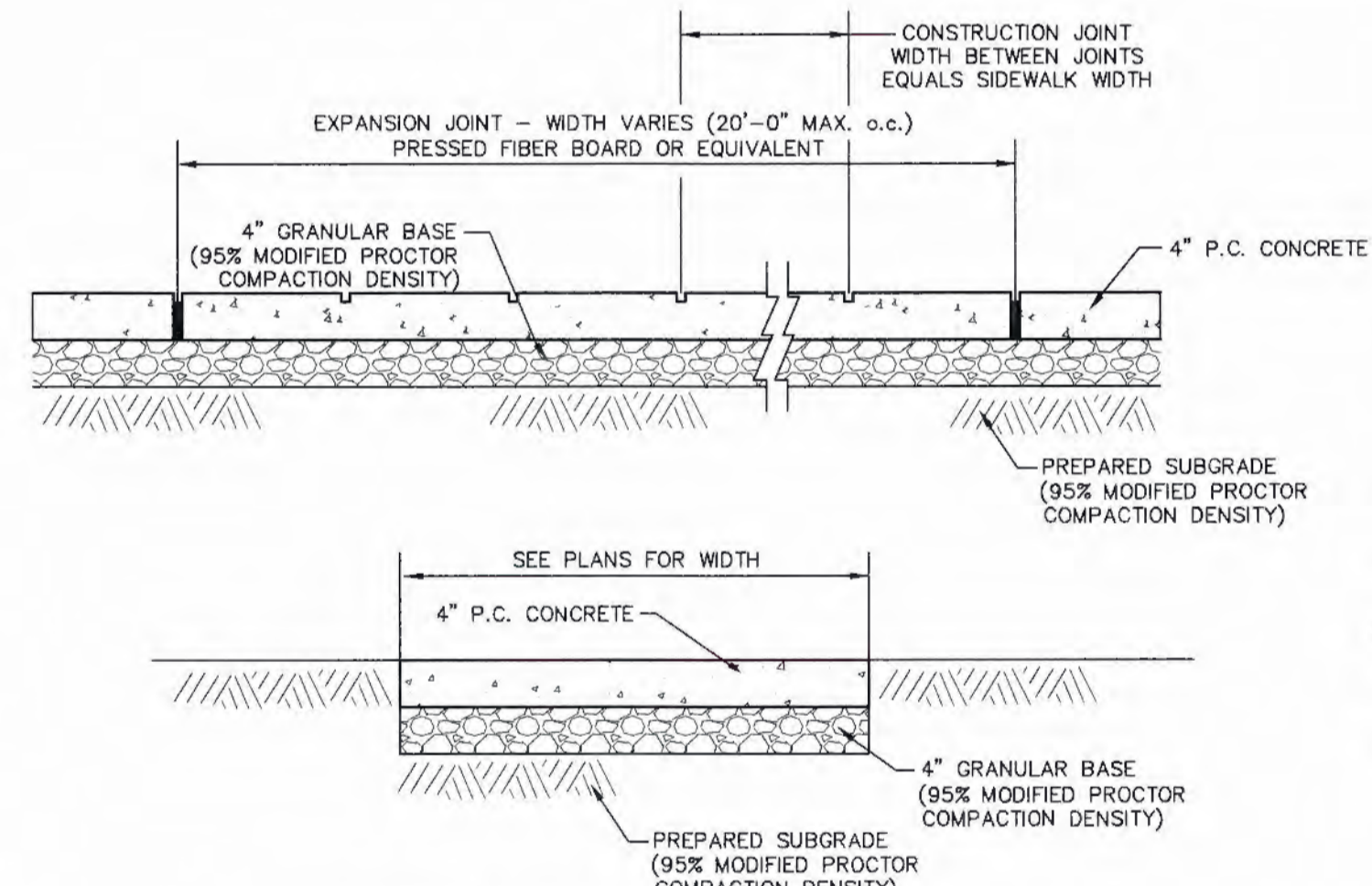

CONCRETE SIDEWALK WITH BASE DETAIL  
NOT TO SCALE

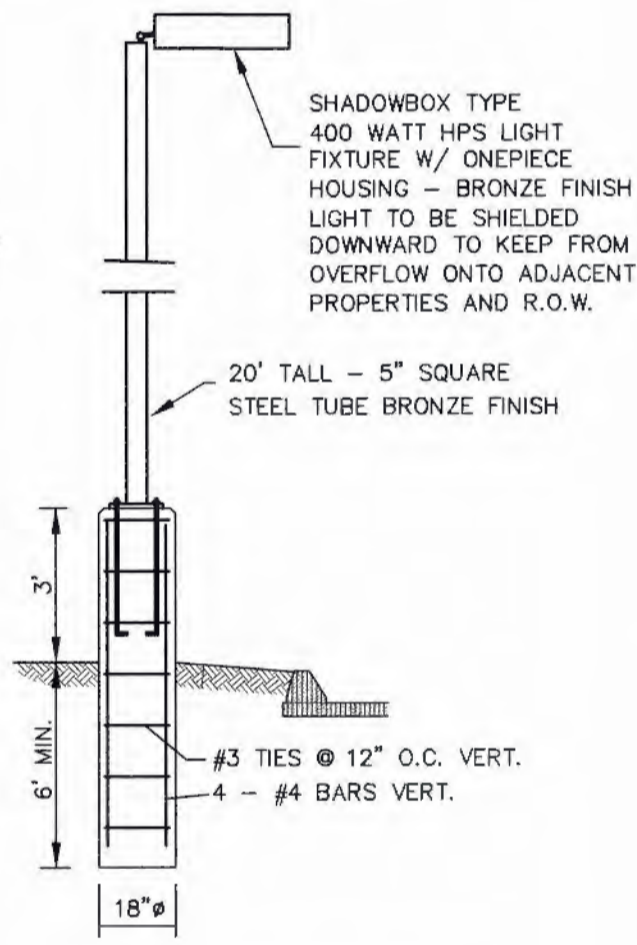

LIGHT POLE & BASE  
NOT TO SCALE

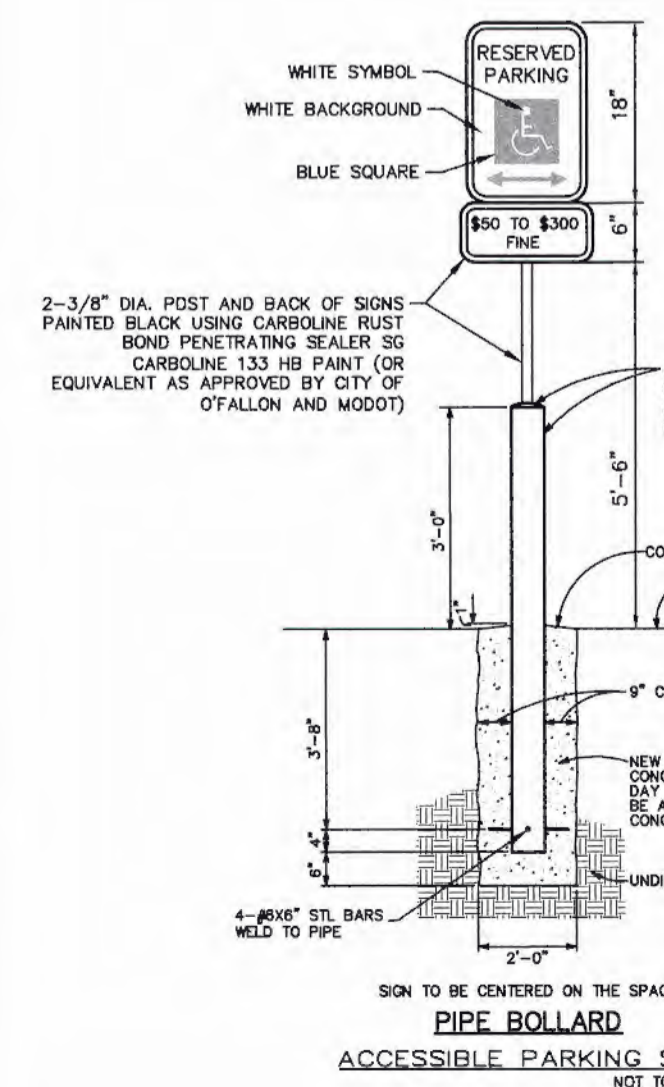

PIPE BOLLARD  
ACCESSIBLE PARKING SIGN  
NOT TO SCALE

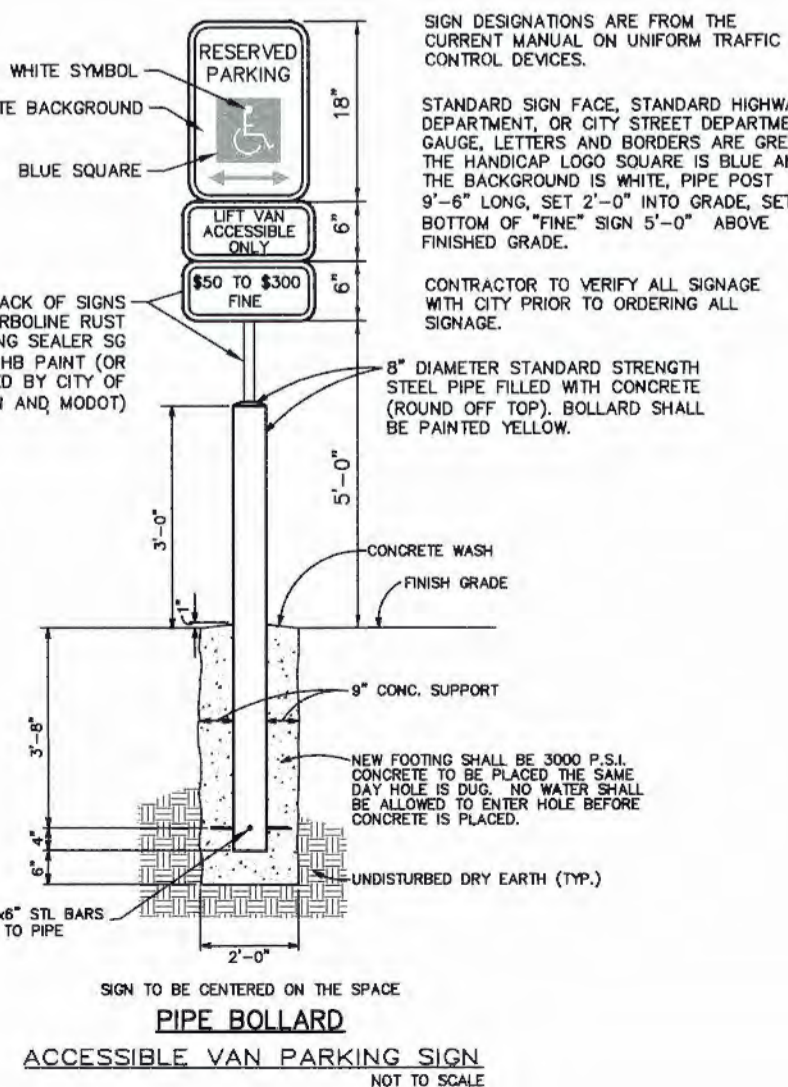
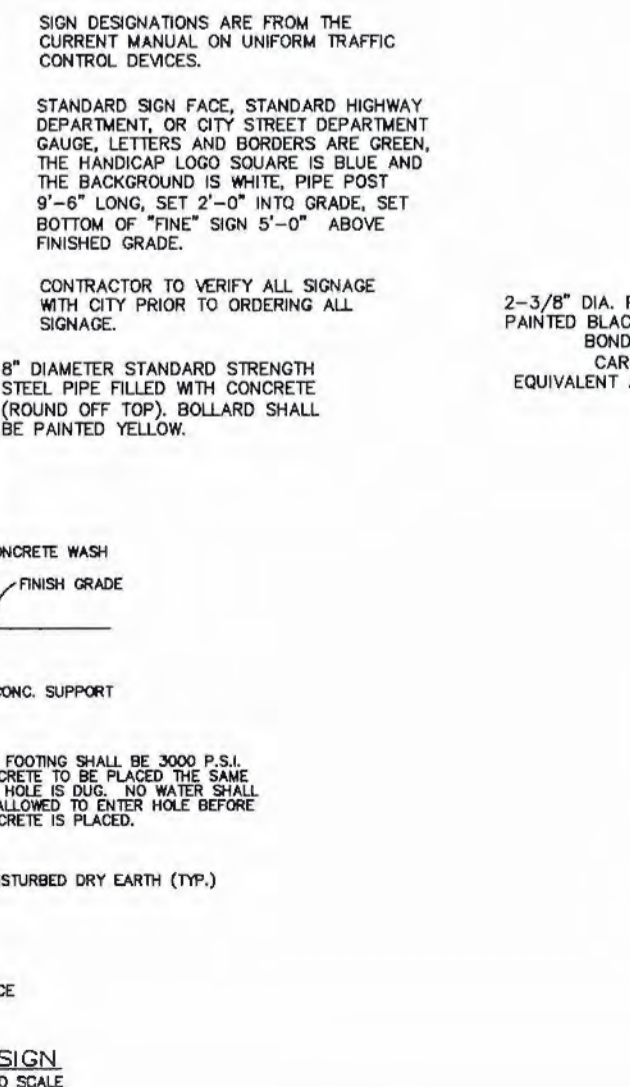

ACCESSIBLE VAN PARKING SIGN  
NOT TO SCALE

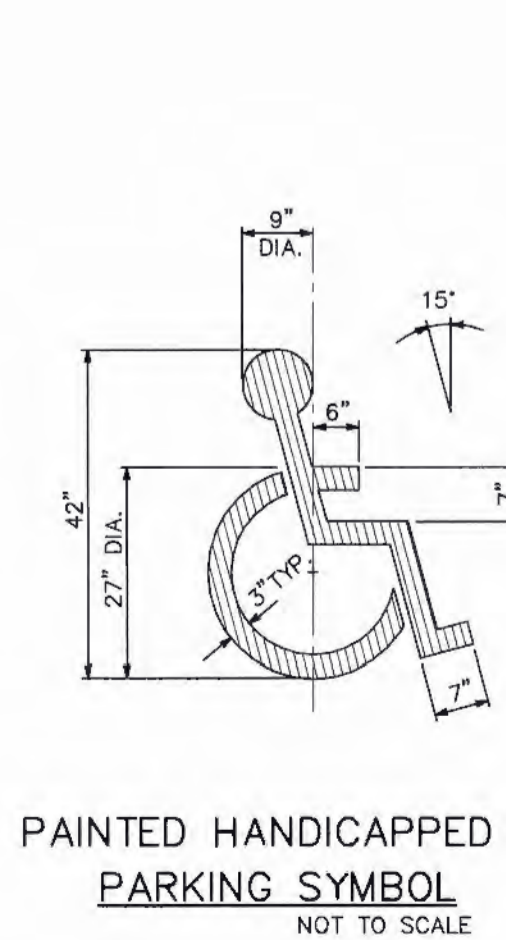

PAINTED HANDICAPPED  
PARKING SYMBOL  
NOT TO SCALE

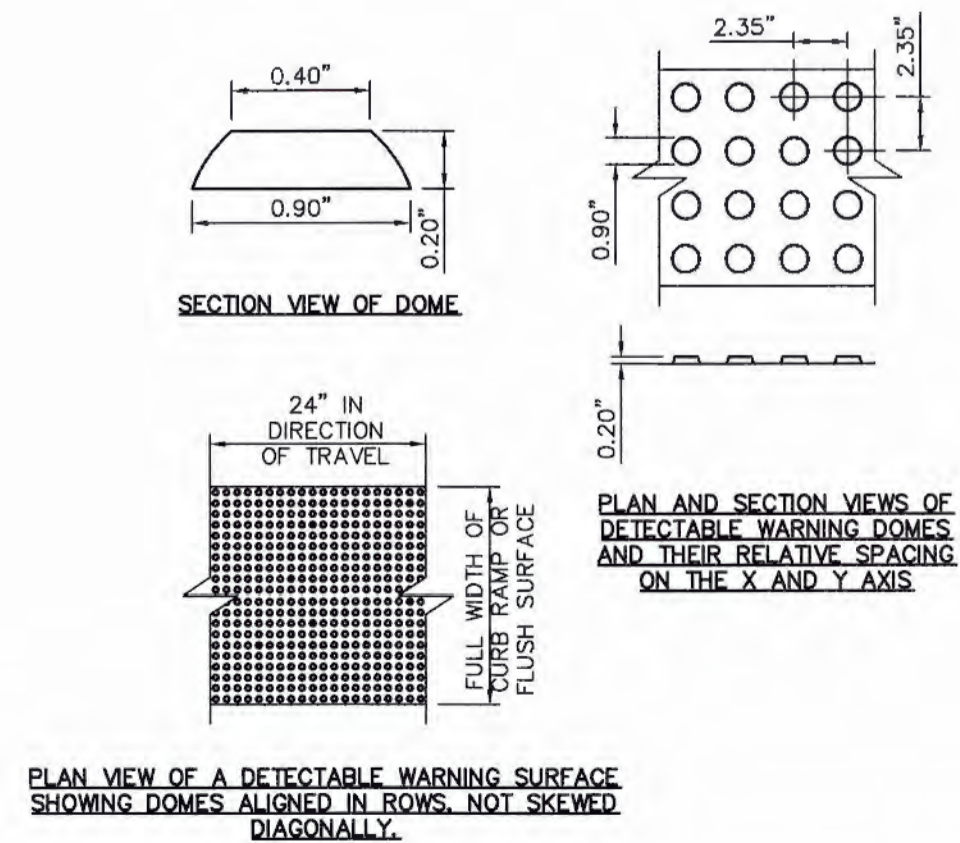

TYPICAL DETAIL OF DETECTABLE WARNING SURFACE  
NOT TO SCALE

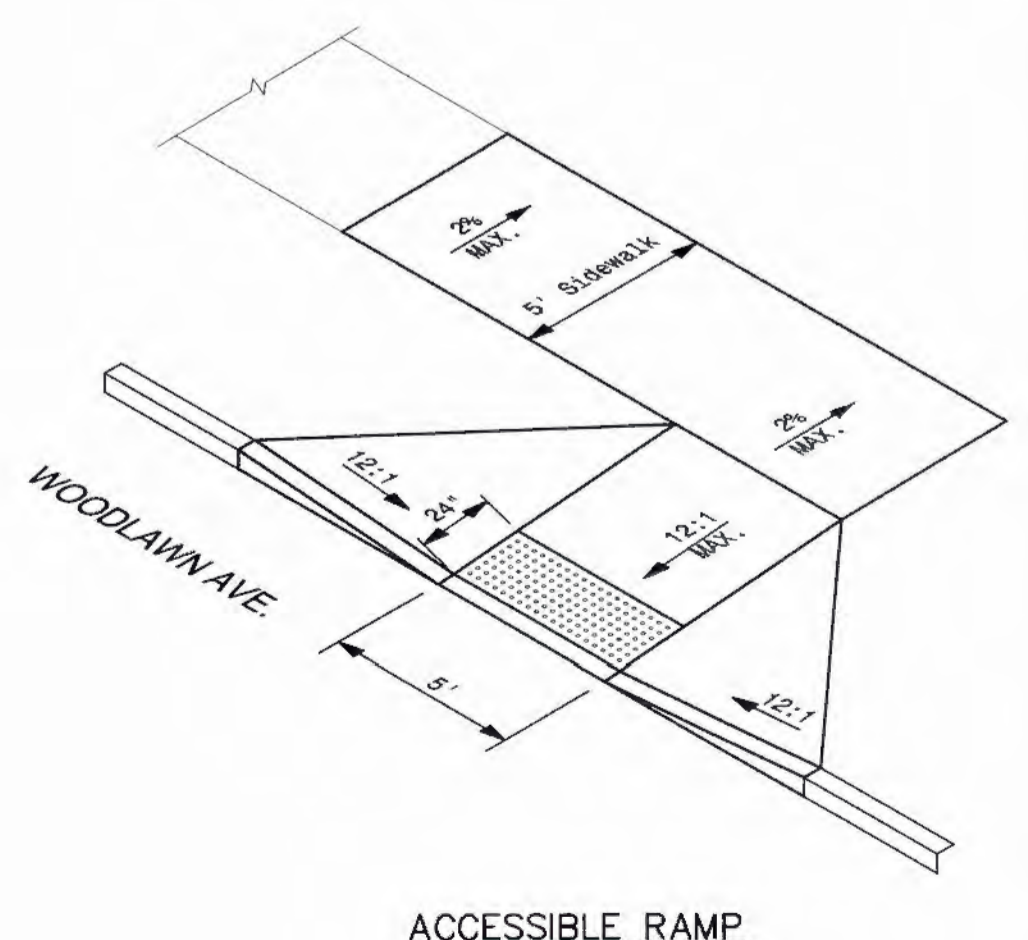

ACCESSIBLE RAMP  
NOT TO SCALE

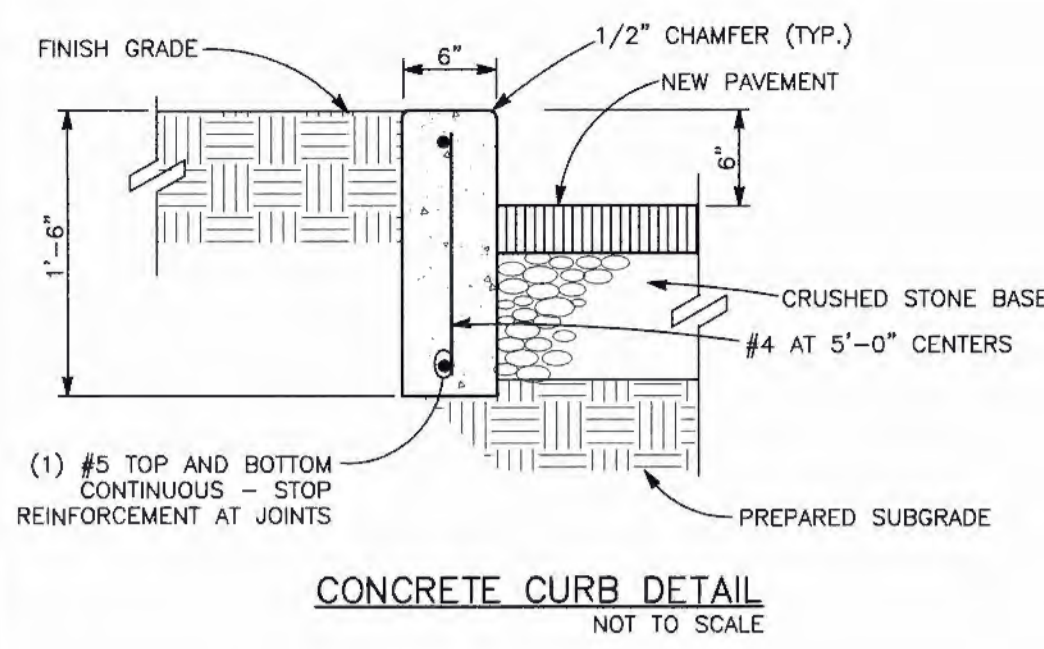

CONCRETE CURB DETAIL  
NOT TO SCALE

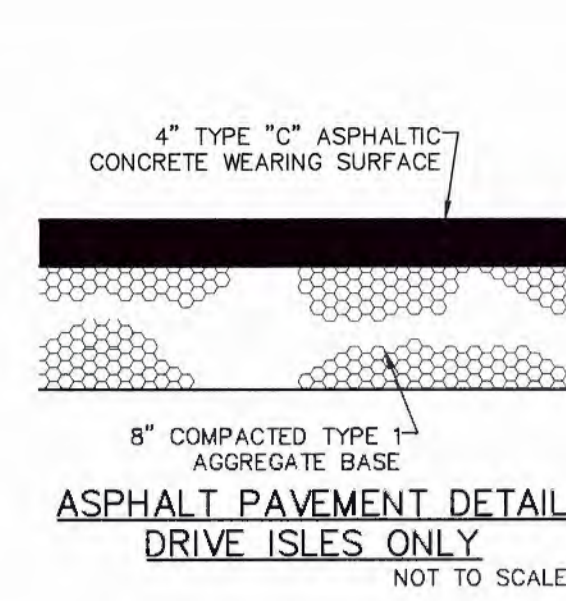

ASPHALT PAVEMENT DETAIL  
DRIVE ISLES ONLY  
NOT TO SCALE

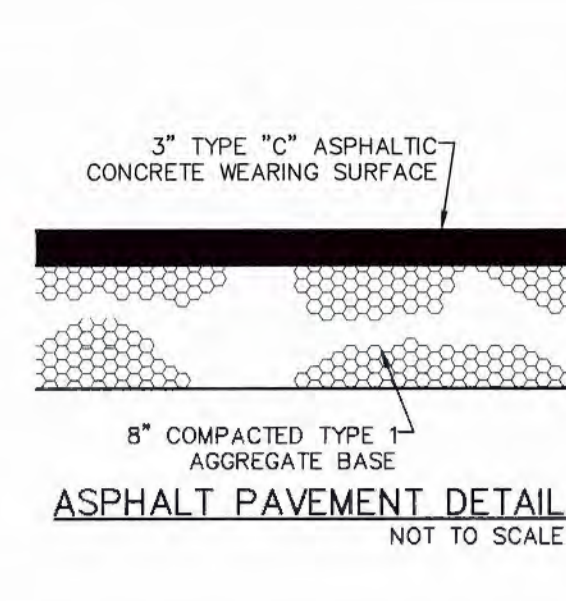

ASPHALT PAVEMENT DETAIL  
NOT TO SCALE

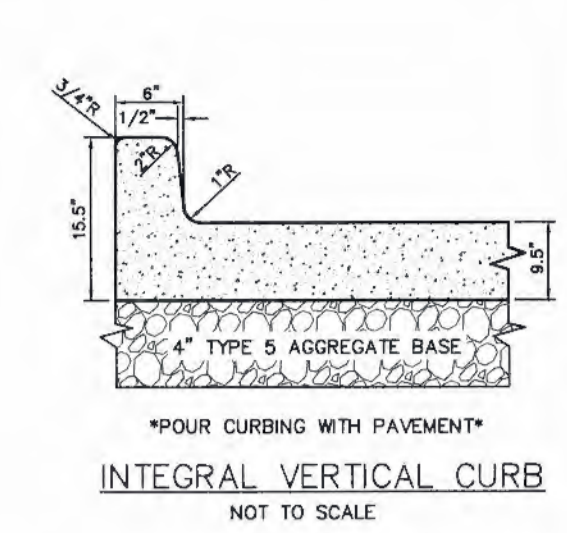

INTEGRAL VERTICAL CURB  
NOT TO SCALE

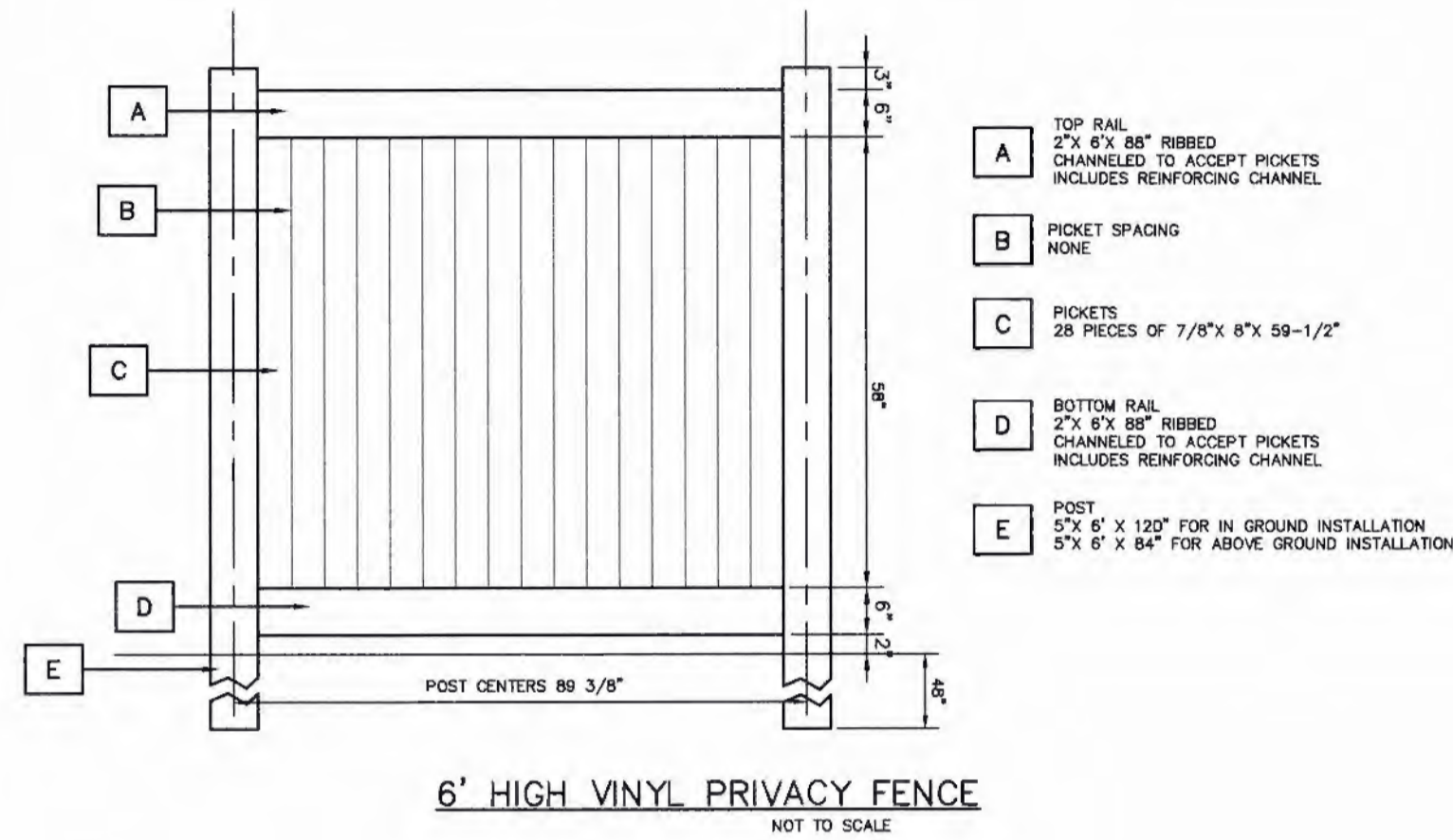

6' HIGH VINYL PRIVACY FENCE  
NOT TO SCALE

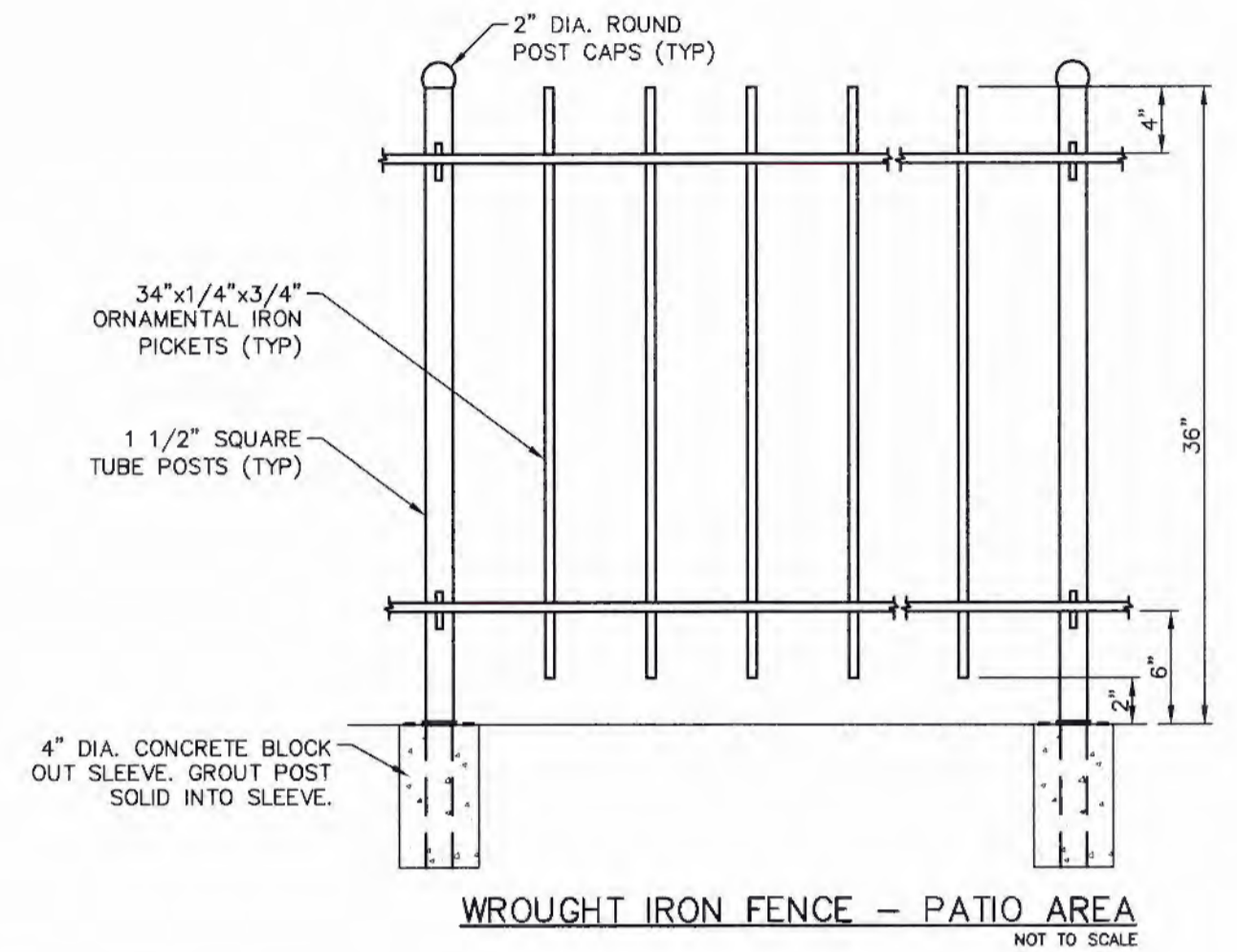

WROUGHT IRON FENCE - PATIO AREA  
NOT TO SCALE

**PROJECT TITLE:**  
 EL TIO PEPE MEXICAN RESTAURANT  
 315 WEST TERRA LANE  
 O'FALLON, ST. CHARLES, MISSOURI 63366

ENGINEERING PLANNING SURVEYING  
 221 Point View Blvd.  
 St. Charles, MO 63301  
 636-928-5552  
 FAX 928-1718



DISCLAIMER OF RESPONSIBILITY  
 I hereby specify that the documents intended to be authorized by my seal are limited to this sheet, and I hereby disclaim any responsibility for all other drawings, specifications, estimates, reports or other documents or instruments relating to or intended to be used for any part or parts of the architectural or engineering project of name.



Copyright 2017  
 Box Engineering Company, Inc.  
 Engineering Authority No. 000655  
 Surveying Authority No. 000144  
 All Rights Reserved

**REVISIONS**

DATE	CITY COMMENTS
09/19/17	CITY COMMENTS
10/04/17	CITY COMMENTS

**Developer / Owner:**  
 WR HOLMAN, LLC  
 2 HICKORY HILL DRIVE  
 O'FALLON, MISSOURI 63366  
 (636) 734-1815

**P+Z No.**  
33-14.01

**CUP No.**  
33-14.01.01

**Page No.**  
14 of 18

**CONSTRUCTION DETAILS**

LAST SAVE: 10/27/2017 8:17:05 AM  
 FILE LOCATION: \\LOCALSERVER\c\p\PROJECTS\33-14.01 WEST TERRA CONSTRUCTION\WP-33-14-01-01.dwg