

30' WIDE PRIVATE ROADWAY SHOWN ON OLD SURVEY RECORDS FROM 1992 AND 1999 IN THE ARCHIVES OF BAX ENGINEERING COMPANY FOR ACCESS TO PROPERTY NORTH OF THE RAILROAD. SAID 30' STRIP IS BELIEVED TO BE AN EASEMENT ACROSS THE PROPERTY OF JUSTIN RIGALL, ARCHBISHOP OF ST. LOUIS SHOWN HEREON. THE ROAD IS STILL IN EXISTENCE ALONG THE NORTH LINE OF THE SUBJECT PROPERTY BUT NO RAILROAD CROSSING TO THE PROPERTY NORTH OF THE RAILROAD IS EVIDENT.

UNDERGROUND UTILITIES HAVE BEEN PLOTTED FROM AVAILABLE INFORMATION AND THEREFORE THEIR LOCATIONS MUST BE CONSIDERED APPROXIMATE ONLY. THE VERIFICATION OF THE LOCATION OF ALL UNDERGROUND UTILITIES, EITHER SHOWN OR NOT SHOWN ON THIS PLAN, SHALL BE THE RESPONSIBILITY OF THE CONSTRUCTION CONTRACTOR AND SHALL BE LOCATED PRIOR TO EXCAVATION, GRADING, OR CONSTRUCTION.

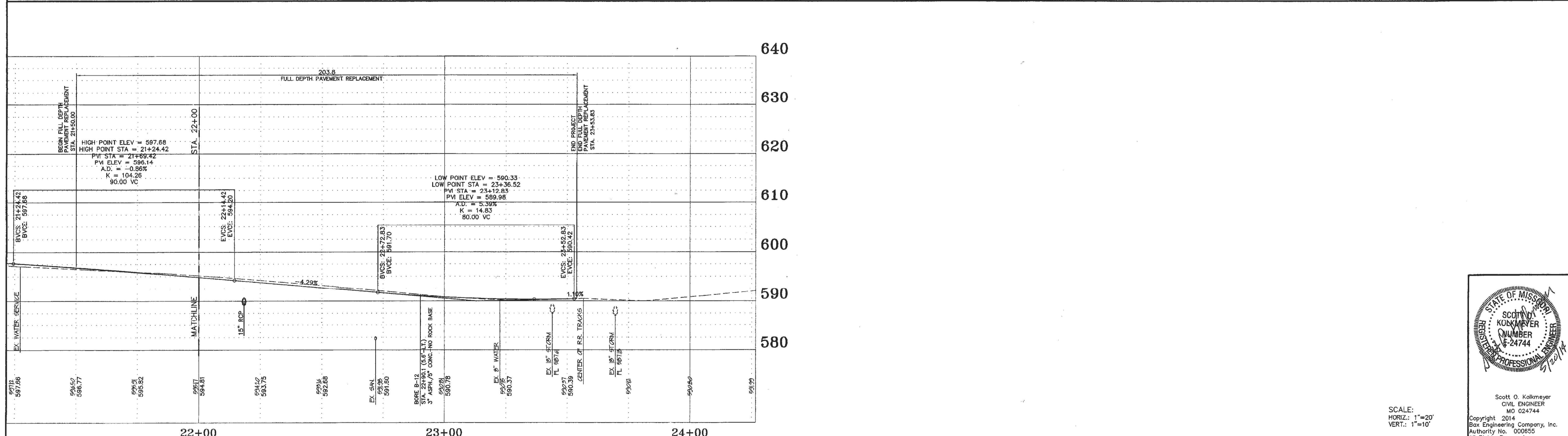
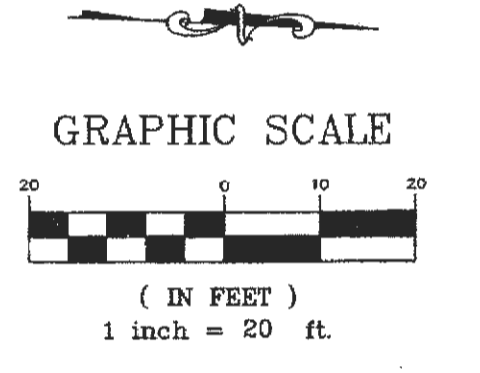

DATE	BY	DESCRIPTION	DATE	BY	DESCRIPTION
6-27-13	ERB	REVISED PER CITY COMMENTS	3-13-14	ERB	REVISED PER MODOT & CITY COMMENTS
7-17-13	ERB	REVISED PER CITY COMMENTS	5-20-14	ERB	REVISED PER RAILROAD COMMENTS
9-24-13	ERB	REVISED PER MODOT & CITY COMMENTS			

BAX ENGINEERING CO., INC.
 221 Point West Blvd.
 St. Charles, MO 63301
 Phone: 636-928-5552
 Fax: 636-928-1718

PROJECT NAME: **CITY OF O'FALLON ELAINE DRIVE IMPROVEMENTS**
 PROJECT NO.: 10-15142 DATE: 5/20/2014

PLAN & PROFILE
 DISCLAIMER OF RESPONSIBILITY: I hereby disclaim any responsibility for all other drawings, specifications, estimates, reports or other documents or instruments relating to or intended to be used for any part or parts of the architectural or engineering project or survey other than these authenticated by my seal.
 7/65

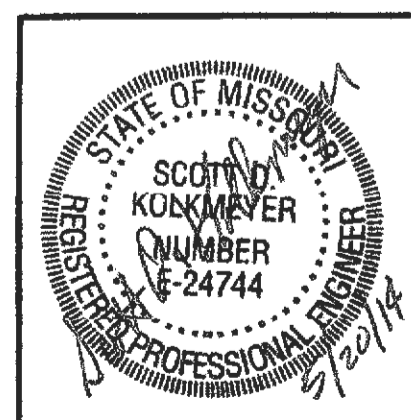

Scott O. Kolkmeier
 CIVIL ENGINEER
 MO 024744
 Copyright 2014
 Bax Engineering Company, Inc.
 Authority No. 000655
 All Rights Reserved