

SECTION 18
OF
SECTION 18

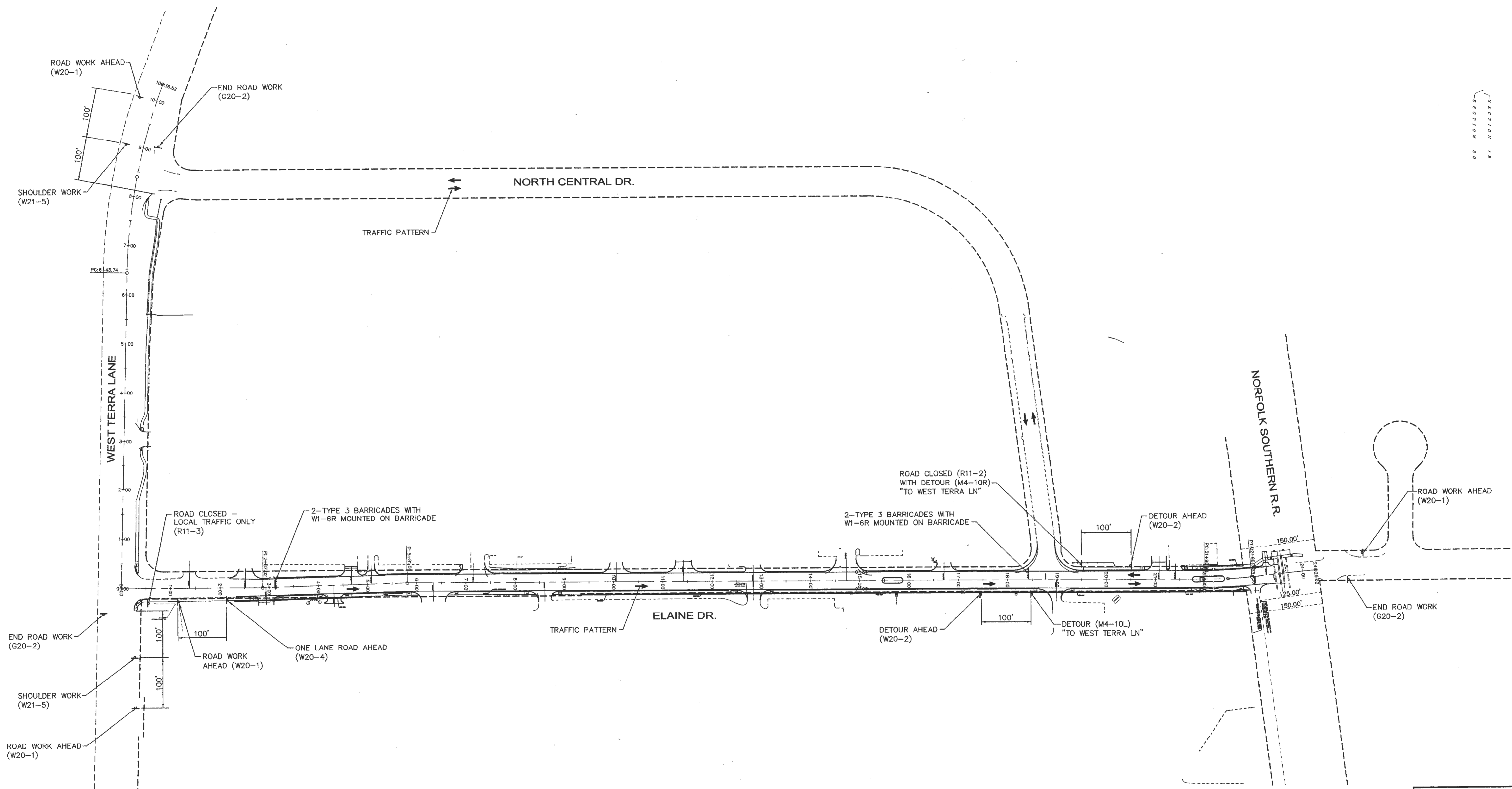

DETOUR PLAN

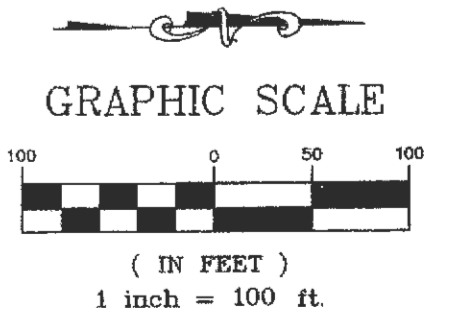

STATE OF MISSOURI
REGISTERED PROFESSIONAL ENGINEER
SCOTT O. KOLMEYER
NUMBER 24744

Scott O. Kolmeyer
CIVIL ENGINEER
MO 024744
Copyright 2014
Bax Engineering Company, Inc.
Authority No. 000855
All Rights Reserved

		REVISIONS									
DATE	BY	DESCRIPTION	DATE	BY	DESCRIPTION	BAX ENGINEERING CO., INC. 221 Point West Blvd. St. Charles, MO 63301 Phone: 636-928-6562 Fax: 636-928-1718		PREPARED FOR: CITY OF O'FALLON		PROJECT NAME: ELAINE DRIVE IMPROVEMENTS	
6-27-13	ERB	REVISED PER CITY COMMENTS	3-13-14	ERB	REVISED PER MODOT & CITY COMMENTS	PROJECT NO.: 10-15142 DATE: 5/20/2014		TRAFFIC CONTROL PLANS		DISCLAIMER OF RESPONSIBILITY I hereby disclaim any responsibility for all other drawings, specifications, estimates, reports or other documents or instruments relating to or intended to be used for any part or parts of the architectural or engineering project or survey other than these authenticated by my seal.	
7-17-13	ERB	REVISED PER CITY COMMENTS	5-20-14	ERB	REVISED PER RAILROAD COMMENTS						
9-24-13	ERB	REVISED PER MODOT & CITY COMMENTS									