

UPP STR	LOW STR	L	DIA	UPPER FL LN	LOWER FL LN	PS	UPPER ST EL	DEPTH HY GR	UPPER HY EL	LOWER HY EL	HYDR GRADE	FR HEAD	VEL	VEL HEAD	JUNC LOSS	TURN LOSS	TQ	PIPE CAP	REMARKS
MH 108	MH 107	127	36	506.28	505.97	0.24	512.00	2.90	509.10	508.97	.00050	0.06	2.12	0.07	0.07	0.00	15.00	32.94	1
MH 107	CI 106	138	36	505.87	505.61	0.19	511.15	2.47	508.68	508.61	.00040	0.05	1.84	0.05	0.00	0.02	13.00	28.95	2 HW=508.61

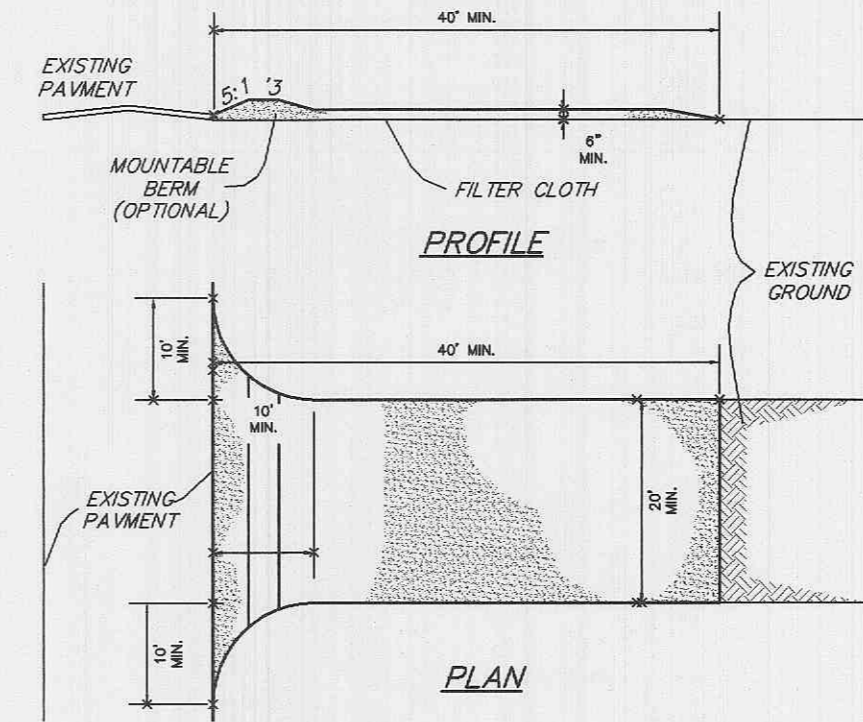

- CONSTRUCTION SPECIFICATIONS**
- Stone Size - Use 2" stone, or reclaimed or recycled concrete equivalent.
 - Length - As required, but not less than 40 feet (except on a single residence lot where a 30 foot minimum length would apply).
 - Thickness - Not less than six (6) inches.
 - Width - Twenty (20) foot minimum, but not less than the full width at points where ingress or egress occurs.
 - Filter Cloth - Will be placed over the entire area prior to placing of stone. Filter will not be required on a single family residence lot.
 - Surface Water - All surface water flowing or diverted toward construction entrances shall be piped across the entrance. If piping is impractical, a mountable berm with 5:1 slopes will be permitted.
 - Maintenance - The entrance shall be maintained in a condition which will prevent tracking or flowing of sediment onto public rights-of-way. This may require periodic top dressing with additional stone as conditions demand and repair and/or cleanout of any measures used to trap sediment. All sediment spilled, dropped, washed or tracked onto public rights-of-way must be removed immediately.
 - Washing - Wheels shall be cleaned to remove sediment prior to entrance onto public rights-of-way. When washing is required, it shall be done on an area stabilized with stone and which drains into an approved sediment trapping device.
 - Periodic inspection and needed maintenance shall be provided after each rain.

STABILIZED CONSTRUCTION ENTRANCE/WASHDOWN AREA
 NOT TO SCALE

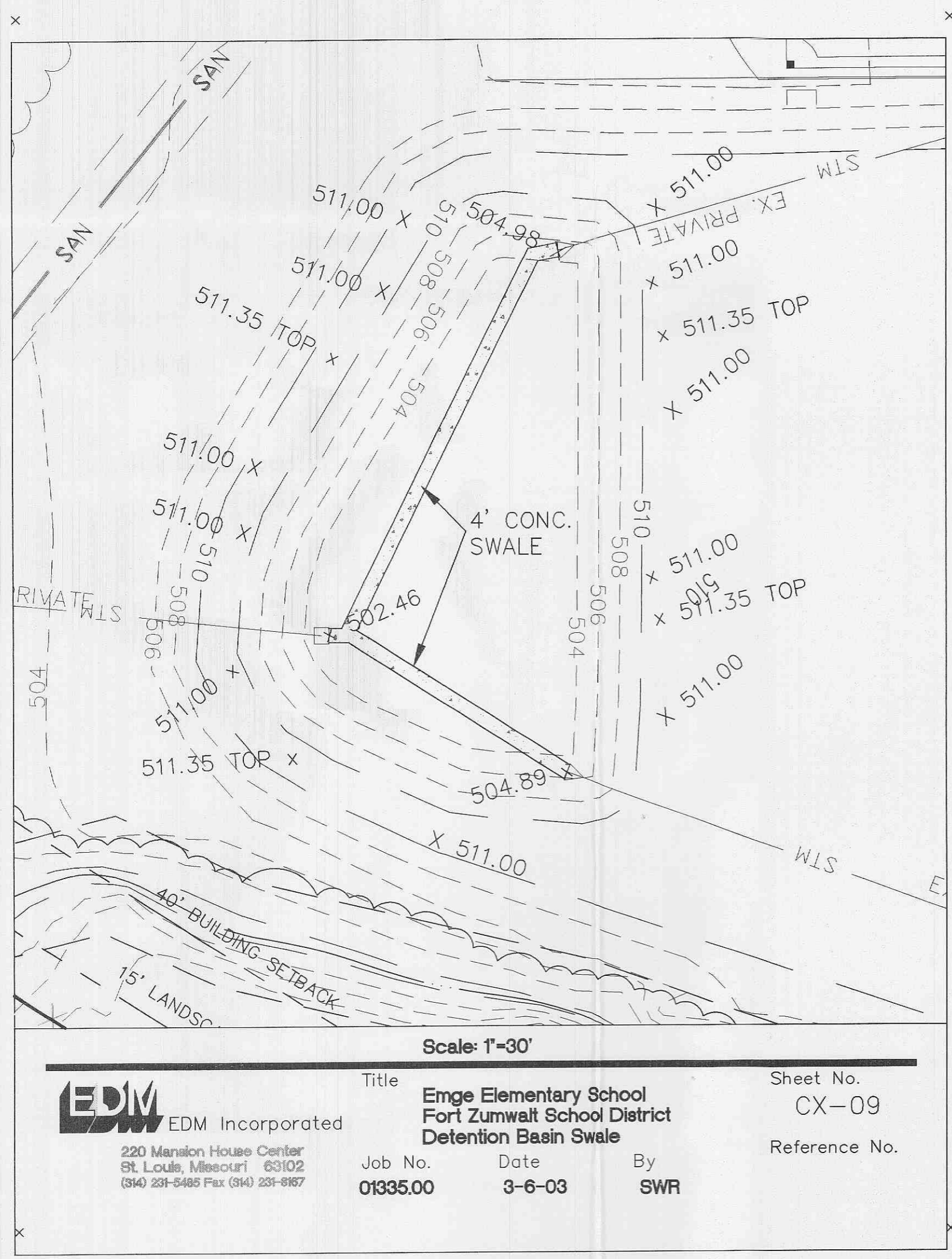

EDM EDM Incorporated 220 Madison House Center St. Louis, Missouri 63102 (314) 291-5485 Fax: (314) 291-8977	Title Emge Elementary School Fort Zumwalt School District Detention Basin Swale	Job No. 01335.00	Date 3-6-03	By SWR	Sheet No. CX-09	Reference No.
--	---	----------------------------	-----------------------	------------------	---------------------------	---------------

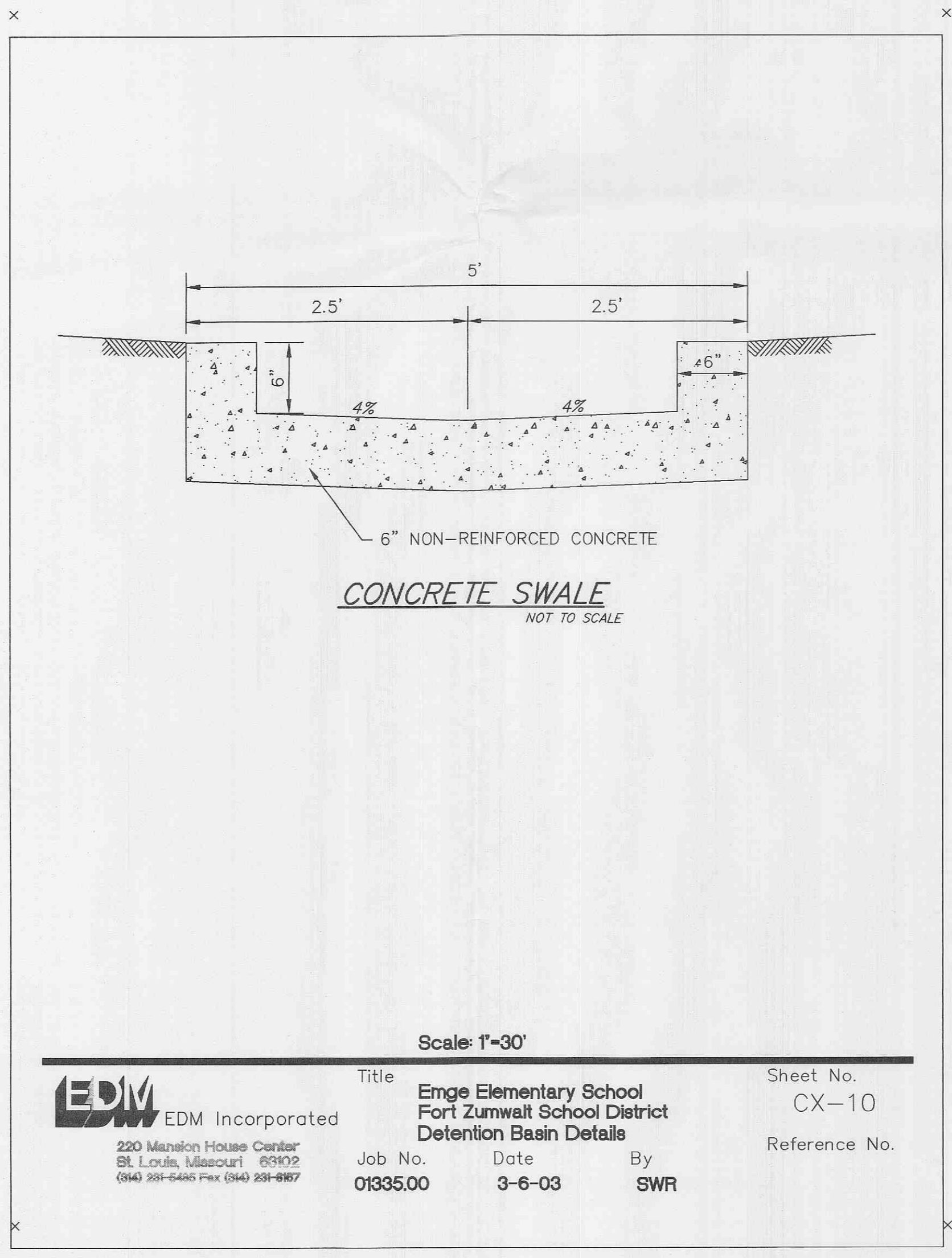

EDM EDM Incorporated 220 Madison House Center St. Louis, Missouri 63102 (314) 291-5485 Fax: (314) 291-8977	Title Emge Elementary School Fort Zumwalt School District Detention Basin Details	Job No. 01335.00	Date 3-6-03	By SWR	Sheet No. CX-10	Reference No.
--	---	----------------------------	-----------------------	------------------	---------------------------	---------------

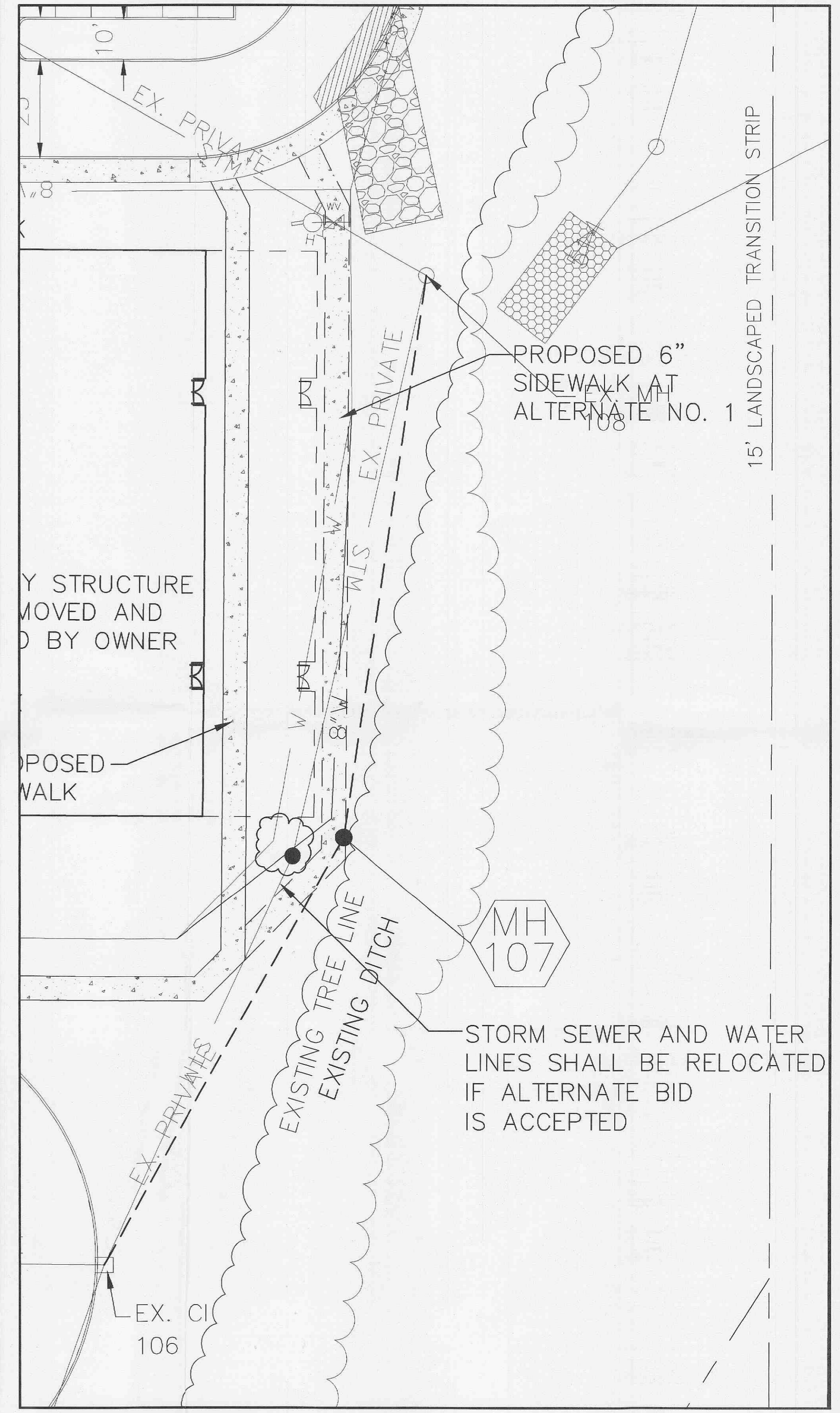

**WATER AND SEWER
 REALIGNMENT**
 SCALE: 1"= 20'

UNDERGROUND UTILITIES HAVE BEEN PLOTTED FROM AVAILABLE INFORMATION AND THEREFORE THEIR LOCATIONS SHALL BE CONSIDERED APPROXIMATE ONLY. THE VERIFICATION OF THE LOCATION OF ALL UNDERGROUND UTILITIES, EITHER SHOWN OR NOT SHOWN ON THESE PLANS SHALL BE THE RESPONSIBILITY OF THE CONTRACTOR, AND SHALL BE LOCATED PRIOR TO ANY GRADING OR CONSTRUCTION OF THE IMPROVEMENTS.