

# GRADING PLAN

SCALE: 1" = 20'

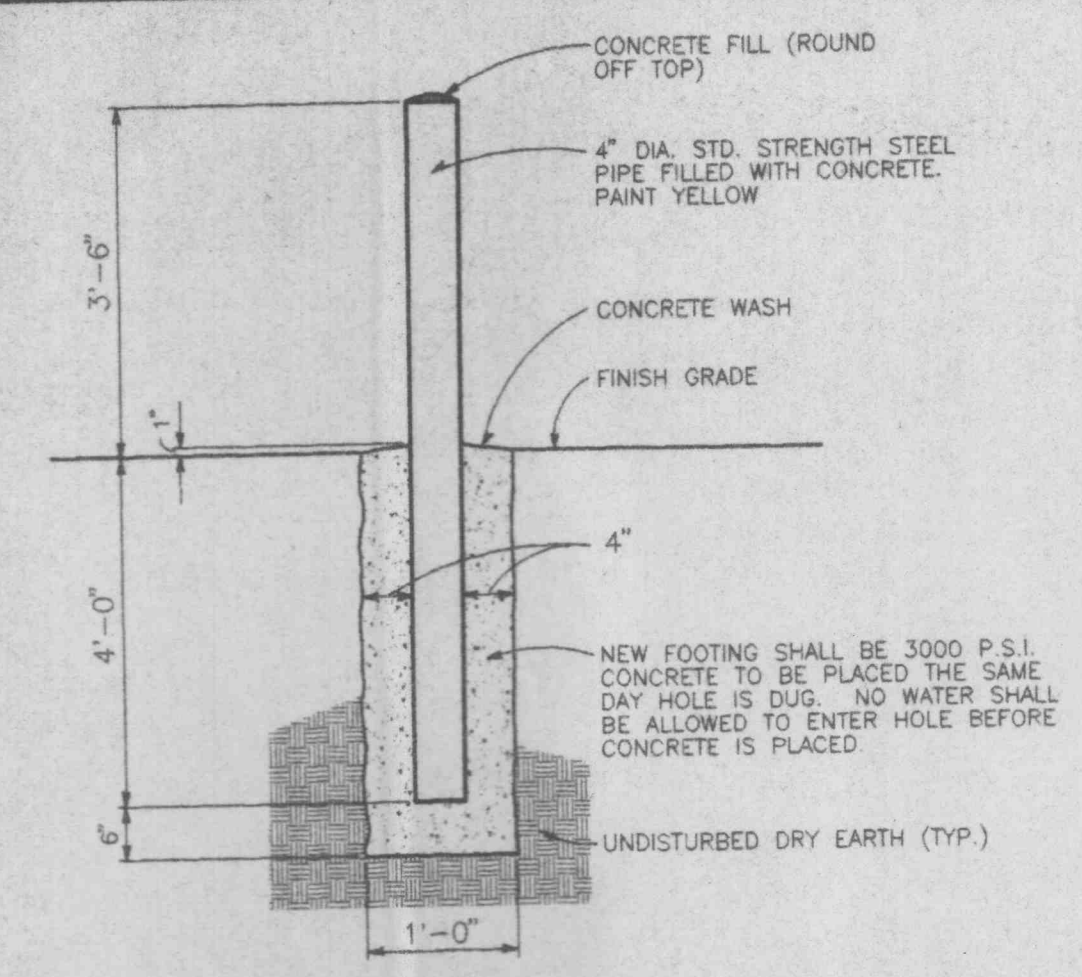

**PROTECTIVE STEEL POST**  
NO SCALE

### CONSTRUCTION NOTES

THE CONTRACTOR SHALL ASSUME COMPLETE RESPONSIBILITY FOR CONTROLLING ALL SILTATION AND EROSION OF THE PROJECT AREA. THE CONTRACTOR SHALL USE WHATEVER MEANS NECESSARY TO CONTROL EROSION AND SILTATION INCLUDING BUT NOT LIMITED TO STAKED STRAW BALES AND/OR SILTATION FABRIC FENCES (ONE POSSIBLE METHOD OF CONTROL IS DETAILED ON THIS SHEET). CONTROL SHALL COMMENCE WITH GRADING AND BE MAINTAINED THROUGHOUT THE PROJECT UNTIL ACCEPTANCE OF THE WORK BY THE OWNER AND/OR CITY OF O'FALLON AND/OR M.H.T.D. THE CONTRACTOR'S RESPONSIBILITIES INCLUDE ALL DESIGN AND IMPLEMENTATION AS REQUIRED TO PREVENT EROSION AND THE DEPOSITING OF SILT. THE OWNER AND/OR THE CITY OF O'FALLON AND/OR M.H.T.D. MAY AT THEIR OPTION DIRECT THE CONTRACTOR IN HIS METHODS AS DEEMED FIT TO PROTECT PROPERTY AND IMPROVEMENTS. ANY DEPOSITING OF SILT OR MUD ON NEW OR EXISTING PAVEMENT OR IN NEW OR EXISTING STORM SEWERS OR SWALES SHALL BE REMOVED AFTER EACH RAIN AND AFFECTED AREAS CLEANED TO THE SATISFACTION OF THE OWNER AND/OR CITY OF O'FALLON AND/OR M.H.T.D. ALL AT THE EXPENSE OF THE CONTRACTOR.

REFER TO SHEET C-1 FOR DIMENSIONS AND IDENTIFICATION OF PROPOSED IMPROVEMENTS.

PROPOSED ELEVATIONS ARE SHOWN TO FINISH PAVEMENT OR GRADE.

REFER TO SHEETS C-5 AND C-6 FOR RETAINING WALL ELEVATION, SECTIONS & DETAILS.

REFER TO EXPLORATION OF SUBSURFACE CONDITIONS AND FOUNDATION RECOMMENDATIONS DATED MAY 4, 1995, PREPARED BY SOIL CONSULTANTS, INC. FOR SOIL BORING DATA.

ALL GRADING, EXCAVATION, REMOVAL AND RECOMPACTION OF INPLACE MATERIAL, COMPACTION OF FILL, ETC. SHALL BE IN ACCORDANCE WITH EXPLORATION OF SUBSURFACE CONDITIONS AND FOUNDATION RECOMMENDATIONS DATED MAY 4, 1995, PREPARED BY SOIL CONSULTANTS, INC.

### BENCHMARK

"□" ON SIDEWALK S.E. SIDE OF BUILDING 136 FEET RIGHT OF STATION 11+90 - ROUTE K - AS NOTED ON M.H.T.D. PLANS FOR JOB NO. 6-U-K-562, PROJECT NO. RS-437 (5), SHEET 4. ELEVATION = 571.42

### LEGEND

EXISTING 1' CONTOUR		574
EXISTING 5' CONTOUR		575
FINISH CONTOUR		575
FINISH SPOT ELEVATION		554.0
SILTATION BARRIER		
EXISTING SPOT ELEVATION		574.99
SWALE LINE IN PAVEMENT		
FUTURE CONTOUR (BY OTHERS)		
MATCH EXISTING		M.E.
TO REMAIN		T.R.
TO BE REMOVED		T.B.R.
FINISHED FLOOR		F.F.
ELEVATION		ELEV.

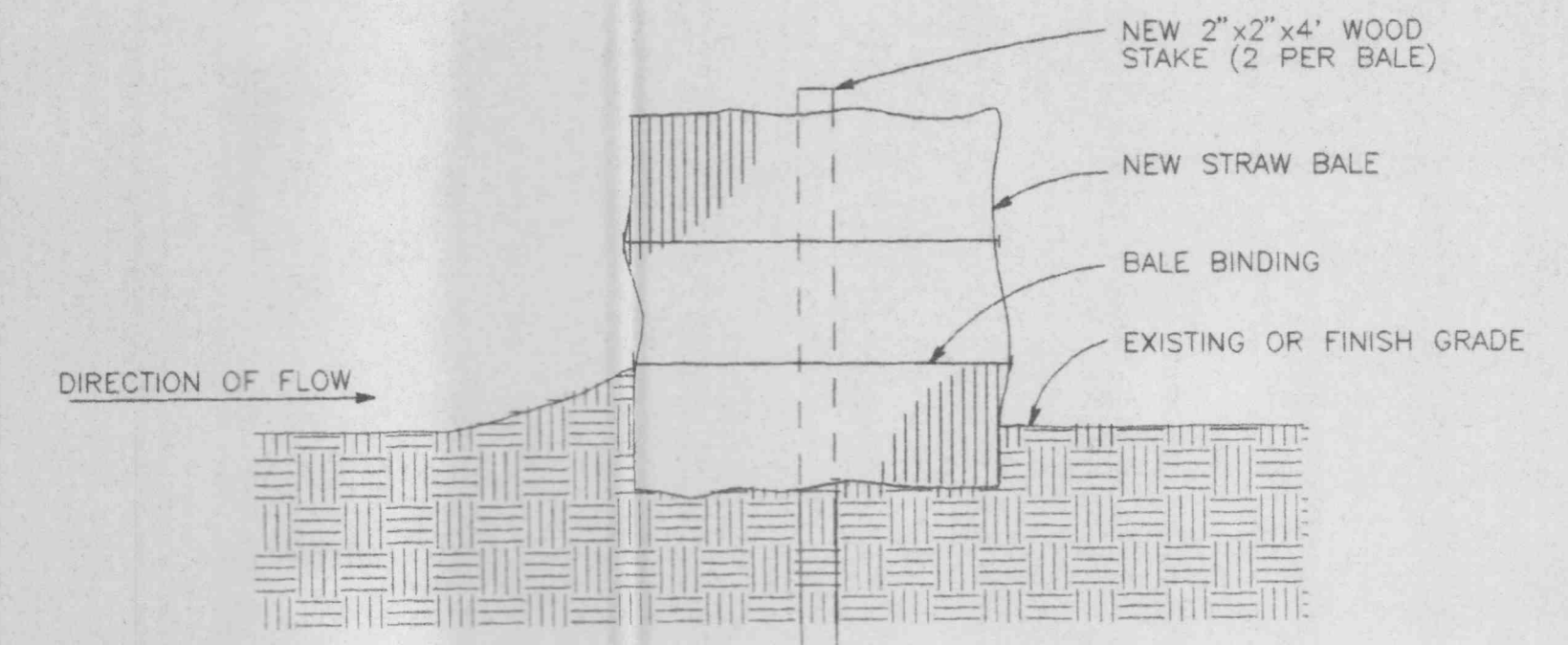
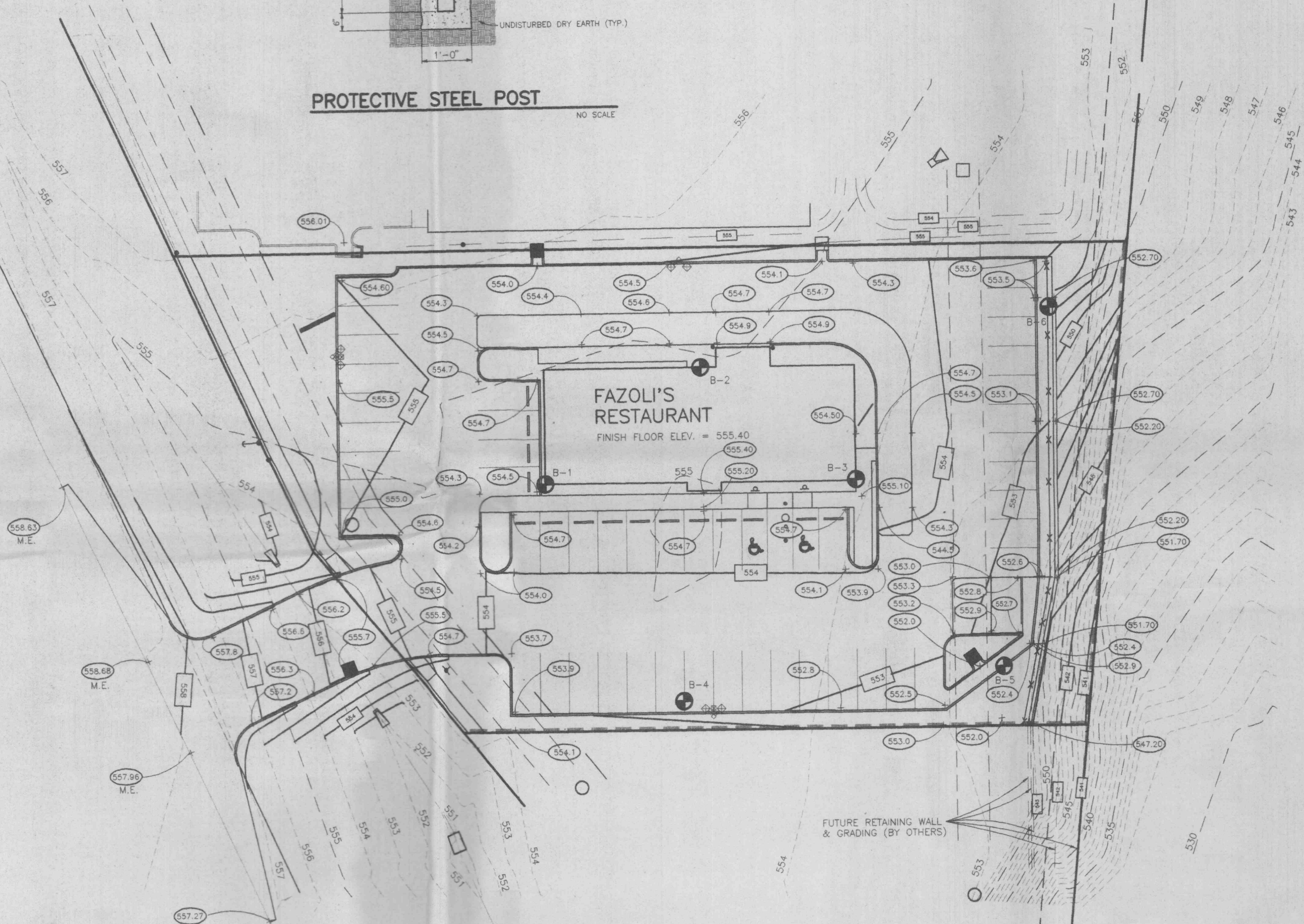

### NOTES:

1. STRAW BALES, NOT HAY BALES, SHALL BE USED.
2. BUTT ENDS OF BALES TIGHTLY TOGETHER
3. INSTALL BALES WITH BINDING AROUND SIDES, NOT TOP AND BOTTOM.
4. FILL ANY GAP BETWEEN BALES BY WEDGING LOOSE STRAW BETWEEN THEM.

**SEDIMENT BARRIER**  
NO SCALE

REVISIONS	
NO	DATE DESCRIPTIONS
01	5/12/95 CITY REVIEW COMMENTS & RETAINING WALL

**FAZOLI'S RESTAURANT**  
 MO. STATE HWY. "K"  
 O'FALLON, MISSOURI

**Farnsworth Polk, Inc.**  
 engineers & surveyors  
 144 W. Lockwood Ave.  
 St. Louis, MO 63119  
 Phone (314)982-7900  
 Fax (314)982-1253

TITLE:	GRADING PLAN
DATE:	3-31-95
PROJECT NO.:	94189

SHEET:  
**C-2**