

STORM SEWER PROFILE

SCALE: 1" = 20' HORIZ., 1" = 5' VERT.

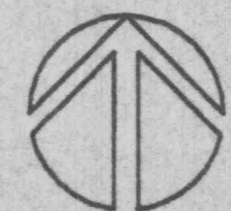
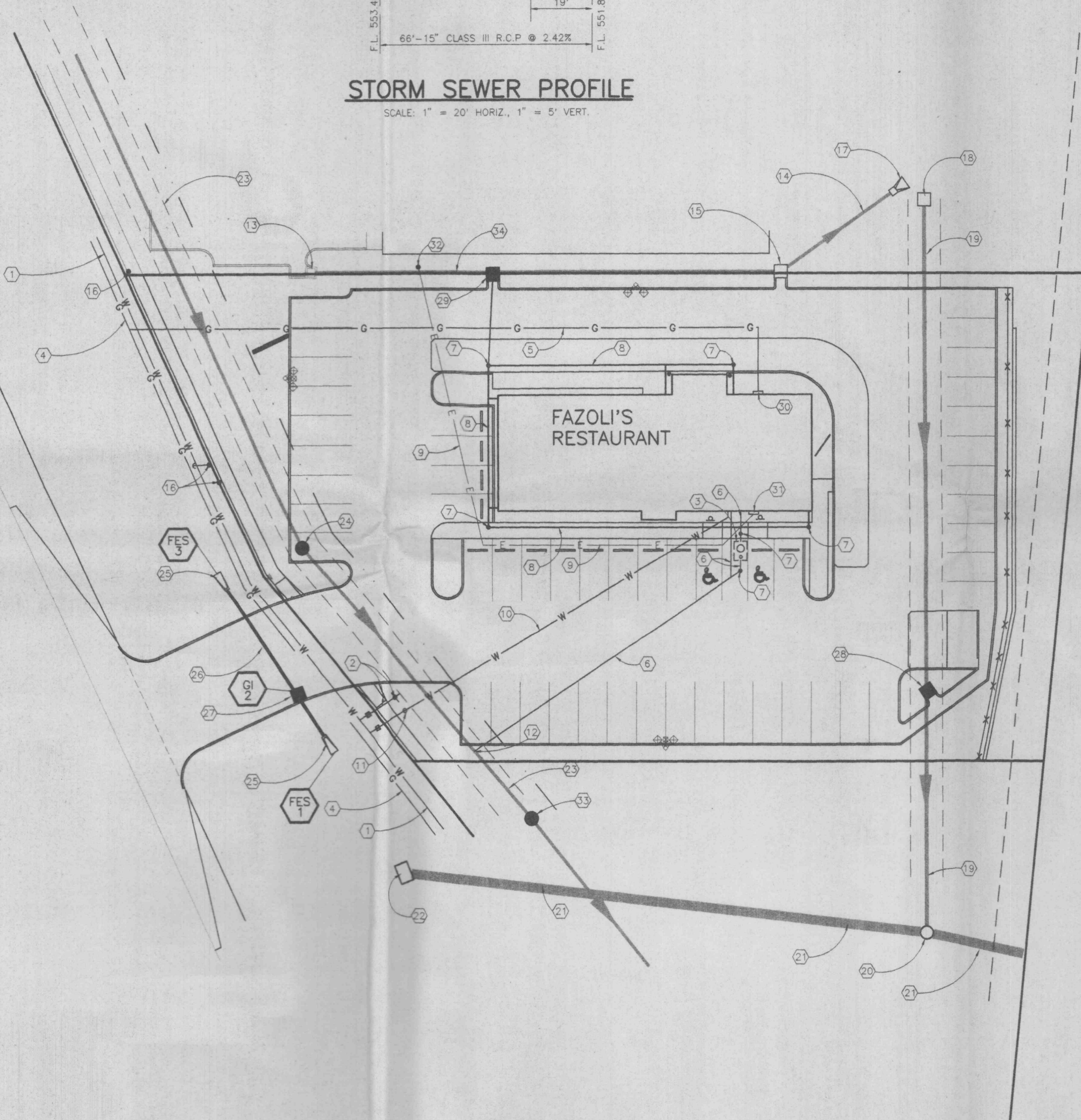

SCALE: 1" = 20'

SEWER AND UTILITY PLAN

EXISTING UTILITIES SHOWN HEREON ARE FROM INFORMATION PROVIDED BY UTILITIES AND MUST BE CONSIDERED AS APPROXIMATE. CONTRACTOR SHALL BE RESPONSIBLE FOR DETERMINING EXACT LOCATIONS PRIOR TO COMMENCING WORK.

ALL ON SITE SEWER OR UTILITY TRENCHES TO BE BACKFILLED PER TRENCH DETAIL ON SHEET C-4.

ALL WORKMANSHIP AND MATERIALS ASSOCIATED WITH WORK TO BE PERFORMED IN THE MISSOURI STATE HIGHWAY "K" RIGHT OF WAY SHALL CONFORM TO THE LATEST STANDARDS AND SPECIFICATIONS OF THE M.H.T.D.

ALL WORKMANSHIP AND MATERIALS ASSOCIATED WITH THE INSTALLATION OF NEW STORM SEWERS SHALL CONFORM TO THE LATEST STANDARDS AND SPECIFICATIONS OF THE CITY OF O'FALLON.

ALL WORKMANSHIP AND MATERIALS ASSOCIATED WITH THE INSTALLATION OF NEW SANITARY SEWERS SHALL CONFORM TO THE LATEST STANDARDS AND SPECIFICATIONS OF THE DUCKETT CREEK SANITARY DISTRICT.

KEYED NOTES

1. APPROXIMATE LOCATION OF NEW 8" WATER MAIN EXTENSION 'BY OTHERS'.
2. NEW FIRE HYDRANT AND 6" BRANCH LINE BY FAZOLI'S CONTRACTOR. TURN STEAM FITTING TOWARD ENTRANCE.
3. NEW GREASE INTERCEPTOR. REFER TO ARCHITECTURAL DRAWINGS FOR DETAILS.
4. APPROXIMATE LOCATION OF NEW 4" GAS MAIN EXTENSION 'BY OTHERS'.
5. NEW 2-1/2" P.V.C. GAS SERVICE. MATERIAL & INSTALLATION PROVIDED BY UTILITY COMPANY.
6. NEW 6" P.V.C. SANITARY LATERAL AT 2.00% MINIMUM SLOPE AND 3' MINIMUM COVER.
7. NEW SEWER CLEAN OUT WITH CAST IRON FRAME AND SOLID TOP.
8. NEW 6" P.V.C. DOWNSPOUT DRAIN PIPE @ 2.00% MINIMUM SLOPE & 3' MINIMUM COVER.
9. NEW 600 AMP / 208 V / 3 PHASE UNDERGROUND ELECTRIC SERVICE. VERIFY POWER REQUIREMENTS ON ARCHITECTURAL DRAWINGS. COORDINATE WITH UTILITY COMPANY. CONTRACTOR TO FURNISH AND INSTALL CONDUITS AS REQUIRED.
10. NEW 1 - 1/2" TYPE "K" COPPER WATER SERVICE. CONNECT TO NEW MAIN EXTENSION.
11. NEW 1 - 1/2" WATER METER PER ST. CHARLES COUNTY WATER COMPANY AND CITY OF O'FALLON STDS.
12. NEW SANITARY WYE CONNECTION PER DUCKETT CREEK SANITARY DISTRICT AND CITY OF O'FALLON STDS.
13. EXISTING GRATE INLET (T.R.) TOP 556.01 F.L. 553.04
14. EXISTING 12" R.C.P. STORM SEWER (T.R.)
15. EXISTING CURB INLET (T.R.) TOP 555.88 F.L. 550.03 CONTRACTOR TO ADJUST TOP TO 554.60
16. EXISTING POWER POLE (T.R.)
17. EXISTING FLARED END SECTION (T.R.) F.L. 548.92
18. EXISTING AREA INLET (T.R.) TOP 552.39 F.L. 546.69
19. EXISTING 226' - 15" R.C.P. @ 2.46% (T.R.)
20. EXISTING STORM MANHOLE (T.R.) TOP 551.28 F.L. IN 541.13(N), F.L. IN 530.73(W), F.L. OUT 530.73(E)
21. EXISTING 36" STORM SEWER (T.R.) F.L. OUT 529.65
22. EXISTING 4'x6' M.H.T.D. CONCRETE STRUCTURE (T.R.) JOINT @ GROUND SURFACE ELEV. = 550.64 EXISTING TOP 555.51 F.L. 535.66
23. EXISTING 8" P.V.C. SANITARY SEWER (T.R.)
24. EXISTING SANITARY MANHOLE (T.R.) TOP 555.57 F.L. 545.23 CONTRACTOR TO ADJUST TOP TO 555.00.
25. NEW 15" FLARED END SECTION.
26. NEW 15" CLASS III R.C.P.
27. NEW TYPE G M.H.T.D. TYPE GRATE INLET WITH SIDE INTAKE.
28. NEW SINGLE CURB INLET (BUILD OVER EXIST. 15" R.C.P.) TOP 552.50 F.L. 542.95 PER CITY OF O'FALLON STDS.
29. NEW SINGLE CURB INLET (BUILD OVER EXIST. 12" R.C.P.) TOP 554.50 F.L. 551.86 PER CITY OF O'FALLON STDS.
30. NEW GAS METER. MATERIAL AND INSTALLATION PROVIDED BY UTILITY COMPANY.
31. ELECTRIC METER / SERVICE ENTRANCE
32. NEW POWER POLE AND POLE MOUNT TRANSFORMER BY UTILITY COMPANY.
33. EXISTING SANITARY MANHOLE (T.R.) TOP 555.65 F.L. 544.05
34. EXISTING 146' - 12" R.C.P. @ 2.06% (T.R.)

LEGEND

- T.R. TO REMAIN
- STDS. STANDARDS
- E ELECTRIC AND TELEPHONE
- S SANITARY SEWER
- SS STORM SEWER
- W WATER
- G GAS
- E ELECTRIC
- F.L. FLOW LINE
- (1) KEYED NOTE DESIGNATOR
- (FES 1) SEWER STRUCTURE DESIGNATOR

UTILITY CONTACTS

- T.C.I. CABLE COMPANY
4160 OLD MILL PARKWAY
ST. PETERS, MISSOURI 63376
PHONE (314) 441-7737
- G.T.E. TELEPHONE COMPANY
1000 G.T.E. DRIVE
BUILDING "E"
WENTZVILLE, MISSOURI 63385
PHONE (314) 639-3928
- UNION ELECTRIC COMPANY
200 CALLAHAN ROAD
WENTZVILLE, MISSOURI 63385
PHONE (314) 327-6203
- ST. CHARLES COUNTY WATER COMPANY
DISTRICT NO. 2
100 WATER DRIVE
O'FALLON, MISSOURI 63366
PHONE (314) 625-3737
- ST. CHARLES GAS CORP.
NO. 1 WESTBURY SQUARE
BUILDING "D"
ST. CHARLES, MO. 63301
PHONE (314) 946-8937
- DUCKETT CREEK SANITARY DISTRICT
2950 GREENS BOTTOM ROAD
ST. CHARLES, MISSOURI 63303
PHONE (314) 272-3493
- O'FALLON FIRE PROTECTION
119 EAST ELM STREET
O'FALLON, MISSOURI 63366
PHONE (314) 272-3493
- CITY OF O'FALLON (STORM WATER)
138 SOUTH MAIN
O'FALLON, MISSOURI 63366
PHONE (314) 240-2000

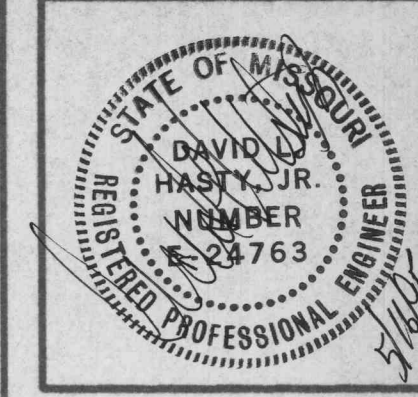

REVISIONS	
NO	DATE
01	5/12/95

FAZOLI'S RESTAURANT
 MO. STATE HWY. "K"
 O'FALLON, MISSOURI

Farnsworth Polk, Inc.

engineers & surveyors

144 W. Lockwood Ave.
St. Louis, MO 63119
Phone (314)962-7900
Fax (314)962-1253

TITLE:
SEWER AND
UTILITY PLAN

DATE: 3-31-95
PROJECT NO.: 94189

SHEET:
C-3