

PAVEMENT WARPING DETAIL ALONG HIGHWAY K
1"=10'

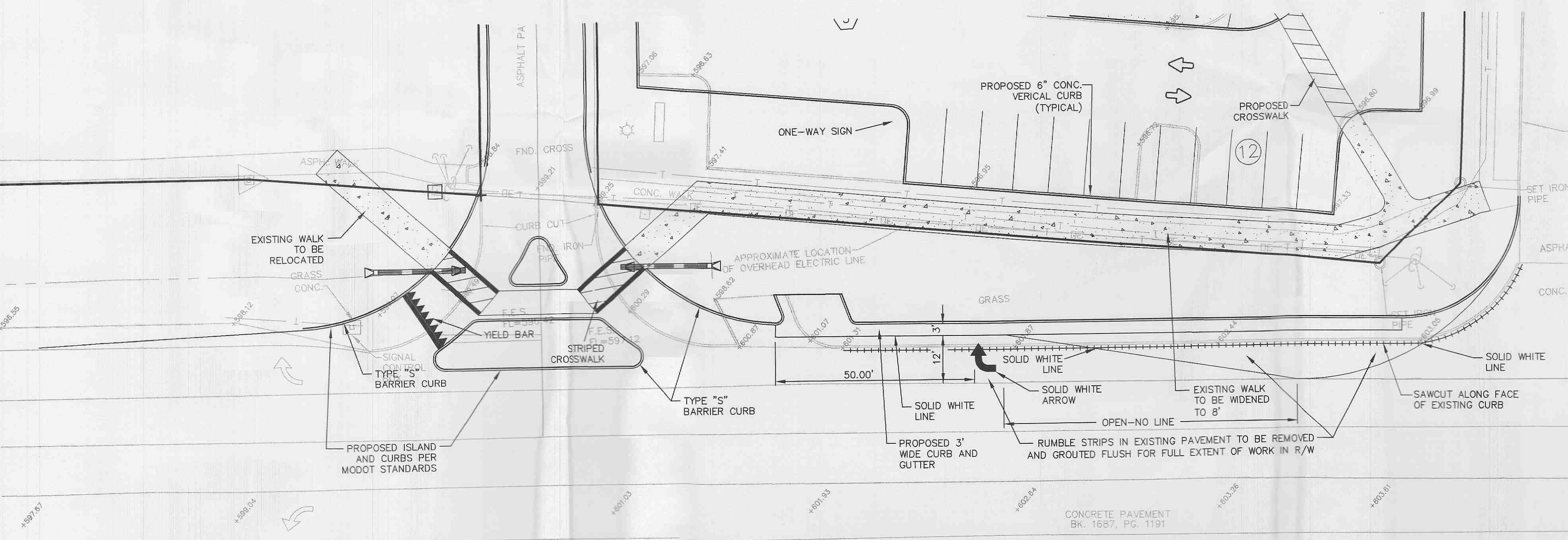

STRIPING DETAIL ALONG HIGHWAY K
1"=20'

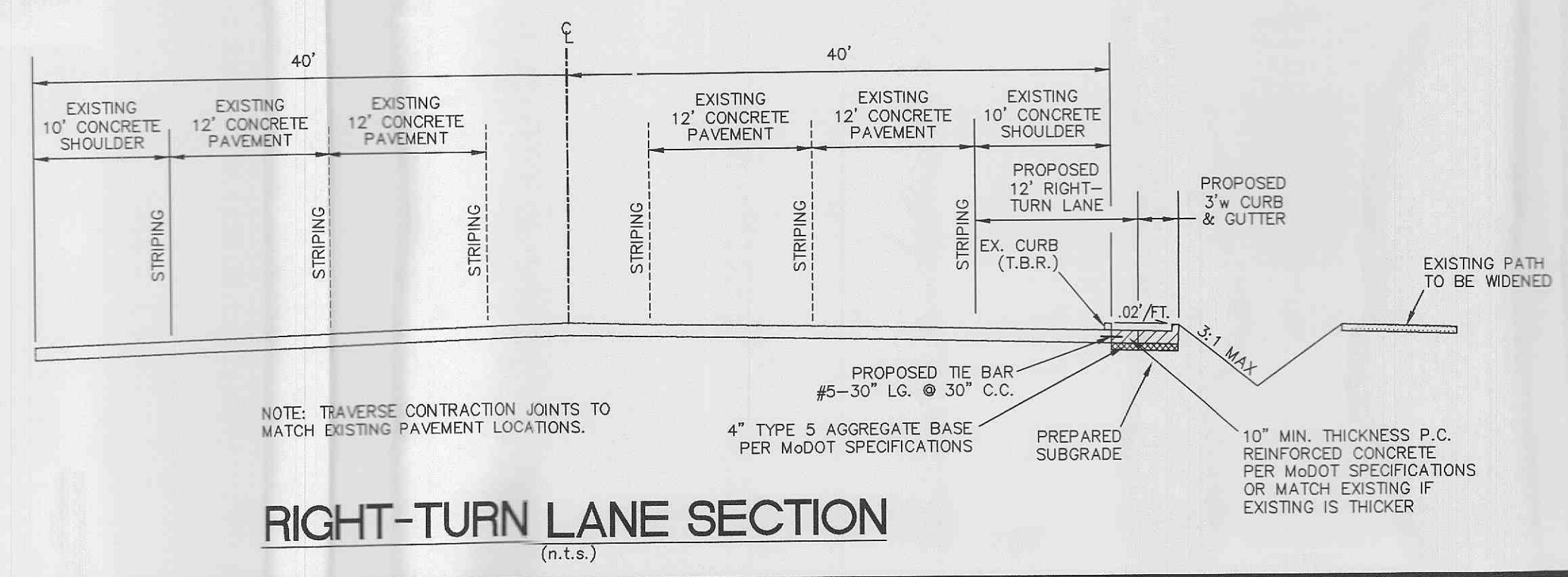

RIGHT-TURN LANE SECTION
(n.t.s.)

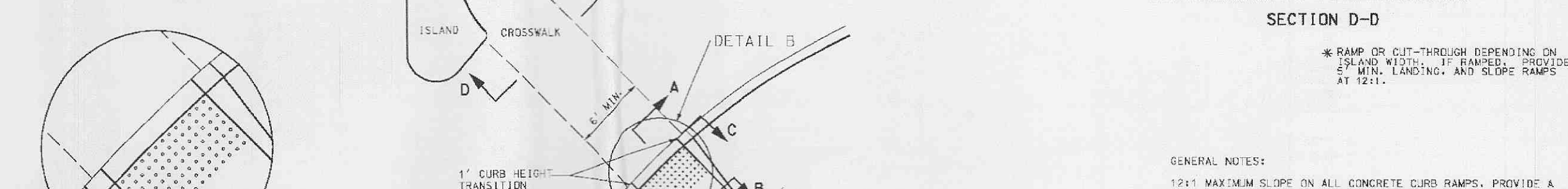
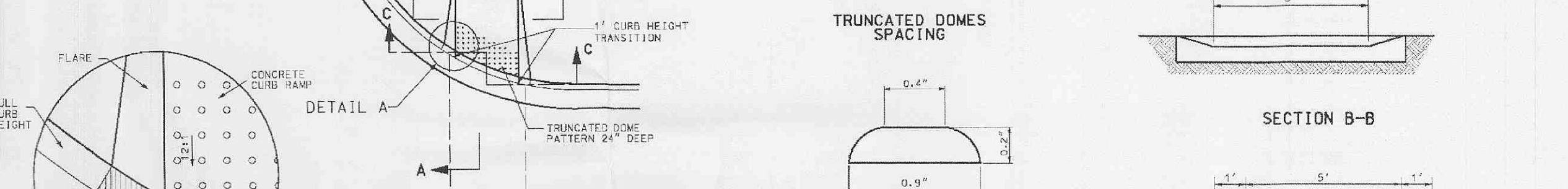
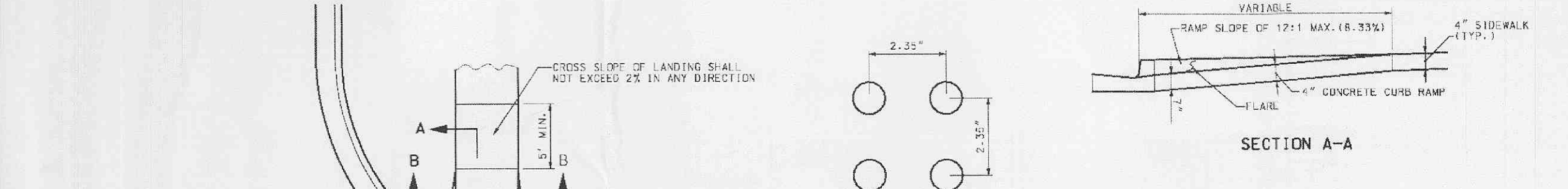
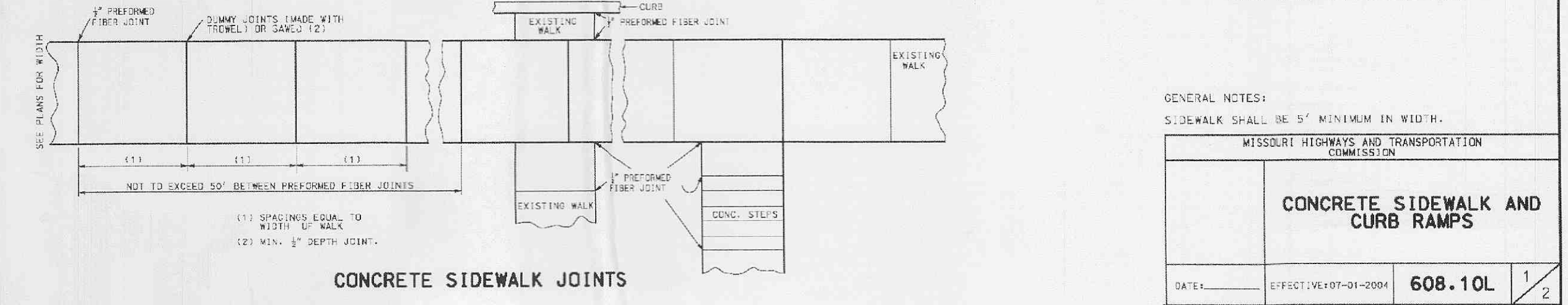
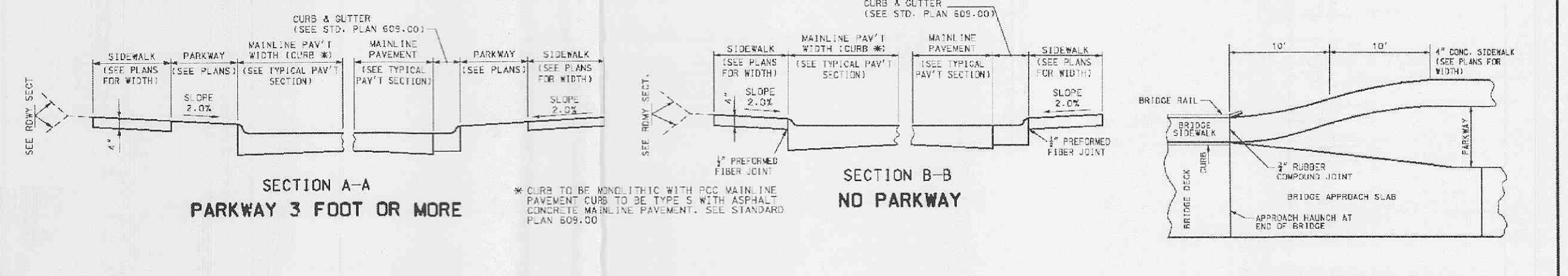
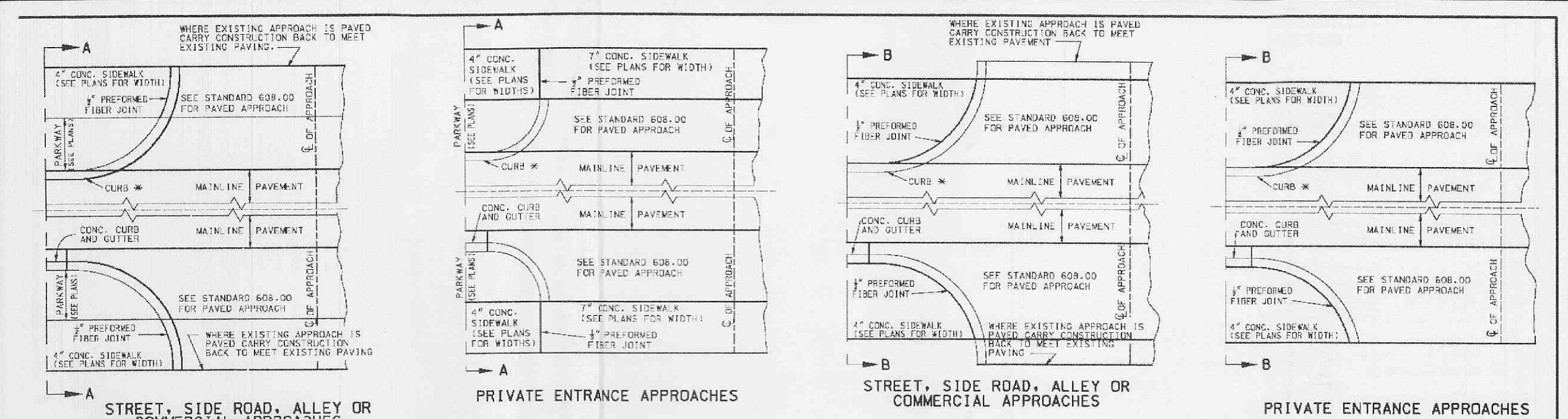

GENERAL NOTES:	
SIDEWALK SHALL BE 5' MINIMUM IN WIDTH.	
MISSOURI HIGHWAYS AND TRANSPORTATION COMMISSION	
CONCRETE SIDEWALK AND CURB RAMPS	
DATE:	EFFECTIVE: 07-01-2004
608.10L / 2	

P&Z NOS: 0106
APPROVED ON 05/04/2006

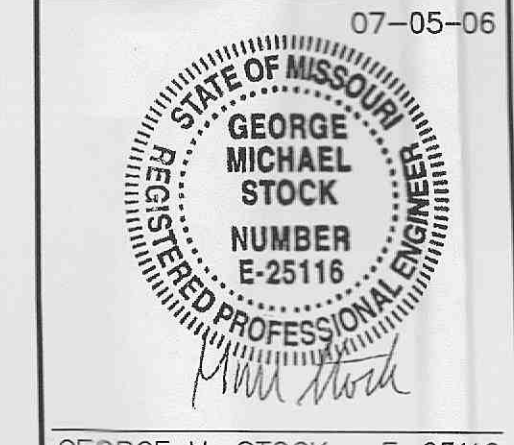

GEORGE M. STOCK E-25116

△ 07-03-06 REVISED CROSSWALK AT DRIVEWAY ENTRANCE OFF HWY K.
△ 06-16-06 REVISED PER CITY COMMENTS

MODOT DETAILS

FIFTH THIRD BANK - HIGHWAY K

STOCK & ASSOCIATES

Consulting Engineers, Inc.

257 Chesterfield Business Parkway
St. Louis, MO 63005
PH: (636) 530-9100
FAX: (636) 530-9130
e-mail: general@stockassoc.com
Web: www.stockassoc.com

DRAWN BY:	DATE:	CHECKED BY:	DATE:	JOB NUMBER:	SHEET:
J.P.P.	05/08/06	C.M.S.	05/08/06	205-3665.1	C13 of 14