

REVISIONS	BY

landscape TECHNOLOGIES
 67 Jacobs Creek Drive
 St. Charles, Missouri 63304
 (636) 928-1250
 Fax: (636) 928-4653

O'FALLON, MISSOURI
 STATE ROUTE K @ WOOD CREST BLVD.

PLANTING PLAN FOR THE PROPOSED
Fifth Third Bank
 STATE ROUTE K @ WOOD CREST BLVD.

DRAWN: R. MARRIS
 CHECKED: RWM/GJB
 DATE: MARCH 10, 2006
 SCALE: 1"=20'-0"
 JOB No. 2006-130
 SHEET
L-1
 OF ONE SHEET

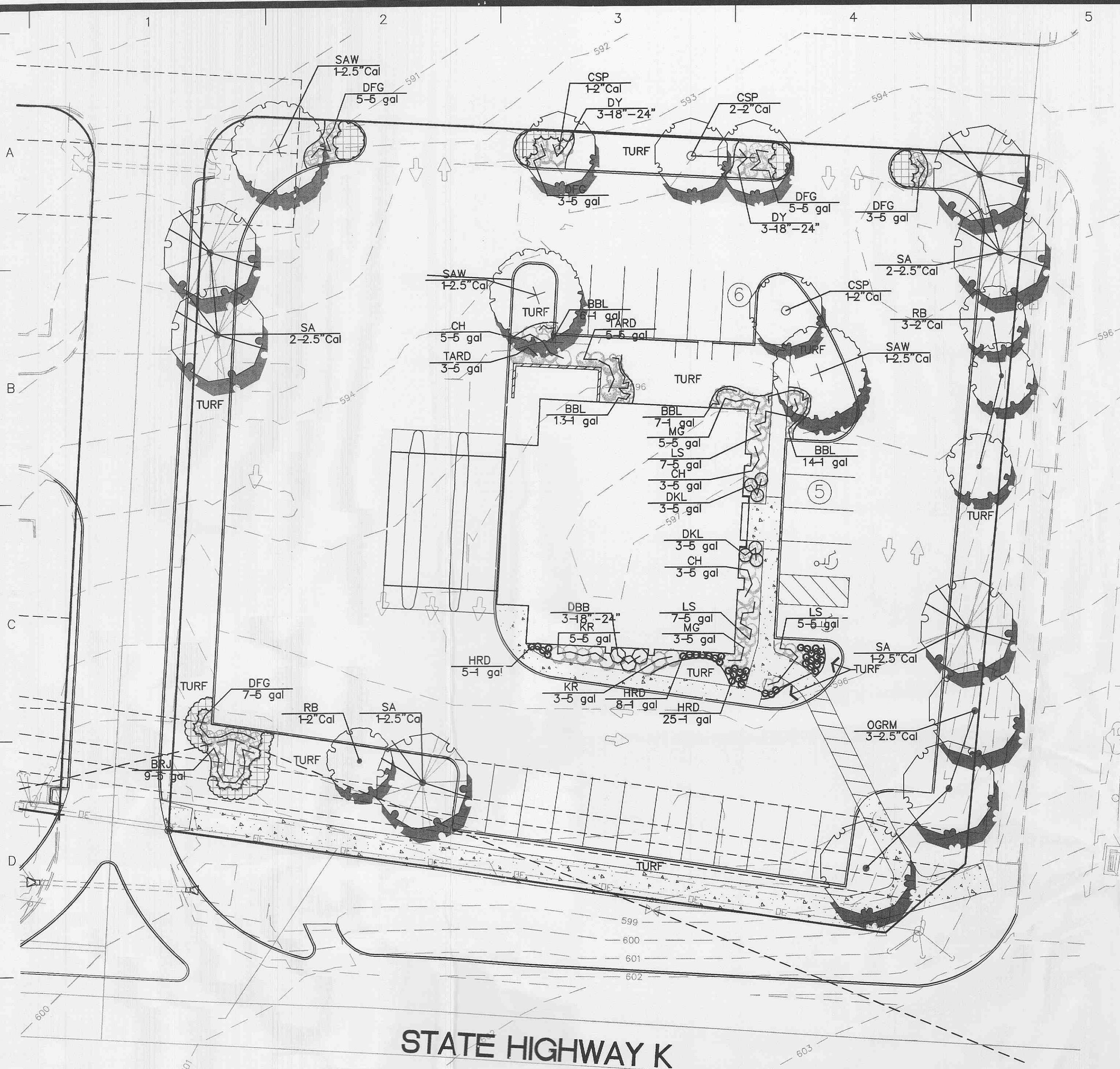

PLANT SCHEDULE

TREES	QTY	COMMON/BOTANICAL	SIZE
OGRM	3	'October Glory' Maple / <i>Acer rubrum</i> 'October Glory'	2.5" Cal
RB	4	Redbud / <i>Cercis canadensis</i>	2" Cal
SA	6	Summit Ash / <i>Fraxinus pennsylvanica</i> 'Summit'	2.5" Cal
CSP	4	Cleveland Select Pear / <i>Pyrus calleryana</i> 'Cleveland Select'	2" Cal
SAW	3	Sawtooth Oak / <i>Quercus acutissima</i>	2.5" Cal
SHRUBS	QTY	COMMON/BOTANICAL	SIZE
DBB	3	Compact Burning Bush / <i>Euonymus alatus</i> 'Compactus'	18"-24"
HRD	38	Happy Returns Daylily / <i>Hemerocallis</i> hybrid 'Happy Returns'	1 gal
TARD	8	Tardiva Hydrangea / <i>Hydrangea paniculata</i> 'Tardiva'	5 gal
CH	11	China Boy/Girl Holly / <i>Ilex meserveae</i> 'China Boy/Girl' TM	5 gal
BRJ	9	Broadmoor Juniper / <i>Juniperus sabin</i> 'Broadmoor'	5 gal
BBL	40	Big Blue Liriope / <i>Liriope muscari</i> 'Big Blue'	1 gal
MG	8	Maiden Grass / <i>Miscanthus sinensis</i> 'Gracillimus'	5 gal
DFG	23	Hamln Dwarf Fountain Grass / <i>Pennisetum alopecuroides</i> 'Hameln'	5 gal
KR	8	Knockout Rose / <i>Rosa Knockout</i>	5 gal
LS	19	Limemound Spirea / <i>Spiraea bumalda</i> 'Limemound' TM	5 gal
DKL	6	Dwarf Korean Lilac / <i>Syringa meyeri</i> 'Palibin'	5 gal
DY	6	Dense Yew / <i>Taxus media</i> 'Densiformis'	18"-24"
GROUND COVERS	QTY	COMMON/BOTANICAL	SIZE
	840	Mixed Annuals / Min. of Five Varieties	1 Qt @ 8" oc

LANDSCAPE GUIDELINE SPECS:

GENERAL:

- All natural vegetation shall be maintained where it does not interfere with construction or the permanent plan of operation. Every effort possible shall be made to protect existing structures or vegetation from damage due to equipment usage. Contractor shall at all times protect all materials and work against injury to public.
- The landscape contractor shall be responsible for any coordination with other site related work being performed by other contractors. Refer to architectural drawings for further coordination of work to be done.
- Underground facilities, structures and utilities must be considered approximate only. There may be others not presently known or shown. It shall be the landscape contractor's responsibility to determine or verify the existence of and exact location of the above.
- Plant material are to be planted in the same relationship to grade as was grown in nursery conditions. All planting beds shall be cultivated to 6" depth minimum and graded smooth immediately before planting of plants. Plant groundcover to within 12" of trunk of trees or shrubs planted within the area.
- It shall be the landscape contractor's responsibility to:
 - Verify all existing and proposed features shown on the drawings prior to commencement of work.
 - Report all discrepancies found with regard to existing conditions or proposed design to the landscape architect immediately for a decision.
 - Stake the locations of all proposed plant material and obtain the approval of the owner's representative or landscape architect prior to installation.
- Items shown on this drawing take precedence over the material list. It shall be the landscape contractor's responsibility to verify all quantities and conditions prior to implementation of this plan. No substitutions of types or size of plant materials will be accepted without written approval from the landscape architect.
- Provide single-stem trees unless otherwise noted in plant schedule.
- All plant material shall comply with the recommendations and requirements of ANSI Z60.1 "American Standards for Nursery Stock".

MULCH:

- All mulch to be shredded oak bark mulch at 3" depth (after compaction) unless otherwise noted. Mulch shall be clean and free of all foreign materials, including weeds, mold, deleterious materials, etc.
- No plastic sheeting or filter fabric shall be placed beneath shredded bark mulch beds. Myrfi fabric shall be used beneath all gravel mulch beds.
- Edge all beds with spade-cut edge unless otherwise noted.

MAINTENANCE:

- Landscape Contractor shall provide a separate proposal to maintain all plants, shrubs, groundcover, perennials and annuals for a period of 12 months after acceptance.
- Contractor shall ensure that only competent and trained personnel shall provide such services and that such services be provided in a timely manner.

TOPSOIL:

- Topsoil mix for all proposed landscape plantings shall be five (5) parts well-drained screened organic topsoil to one (1) part Canadian sphagnum peat moss as per planting details. Roto-till topsoil mix to a depth of 6" minimum and grade smooth.
- Provide a soil analysis, if requested, made by an independent soil-testing agency outlining the % of organic matter, inorganic matter, deleterious material, pH and mineral content.
- Any foreign topsoil used shall be free of roots, stumps, weeds, brush, stones (larger than 1"), litter or any other extraneous or toxic material.
- Landscape contractor to apply pre-emergent herbicide to all planting beds upon completion of planting operations and before application of shredded bark mulch.

MISC. MATERIAL:

- Provide stakes and deadmen of sound, new hardwood, free of knotholes and defects.
- Tree wrap tape shall be 4" minimum, designed to prevent borer damage and winter freezing. Additionally, only 3-ply tying material shall be used.

TURF:

- All disturbed lawn areas to be seeded with a mixture of Turf-Type fescue (300# per acre) and bluegrass (18# per acre). Lawn areas shall be unconditionally warranted for a period of 90 days from date of final acceptance. Bare areas more than one square foot per any 50 square feet shall be replaced.
- Landscape contractor shall offer an alternate price for sod in lieu of seed. Sod shall be cut at a uniform thickness of 3/4". No broken pieces, irregular pieces or torn pieces will be accepted.
- Any points carrying concentrated water loads and all slopes of 15% or greater shall be sodded.
- All sod shall be placed a maximum of 24 hours after harvesting.
- Recondition existing lawn areas damaged by Contractor's operations including equipment/material storage and movement of vehicles.

WARRANTY:

- All plant material (excluding ground cover, perennials and annuals) are to be warranted for a period of 12 months after installation at 100% of the installed price.
- Any plant material found to be defective shall be removed and replaced within 30 days of notification or in growth season determined to be best for that plant.
- Only one replacement per tree or shrub shall be required at the end of the warranty period, unless loss is due to failure to comply with warranty.
- Lawn establishment period will be in effect once the lawn has been mowed three times. Plant establishment period shall commence on the date of acceptance and 100% completion.

