

Drawing name: K:\D\0306147 Fox Haven\IMPROVEMENTS\6147IMP.dwg Plotted on: Aug 23, 2005 - 11:24am Plotted by: gester

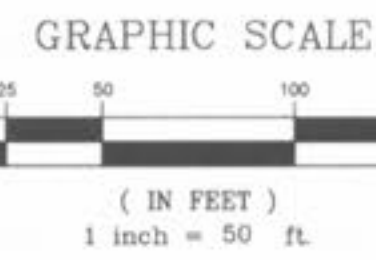
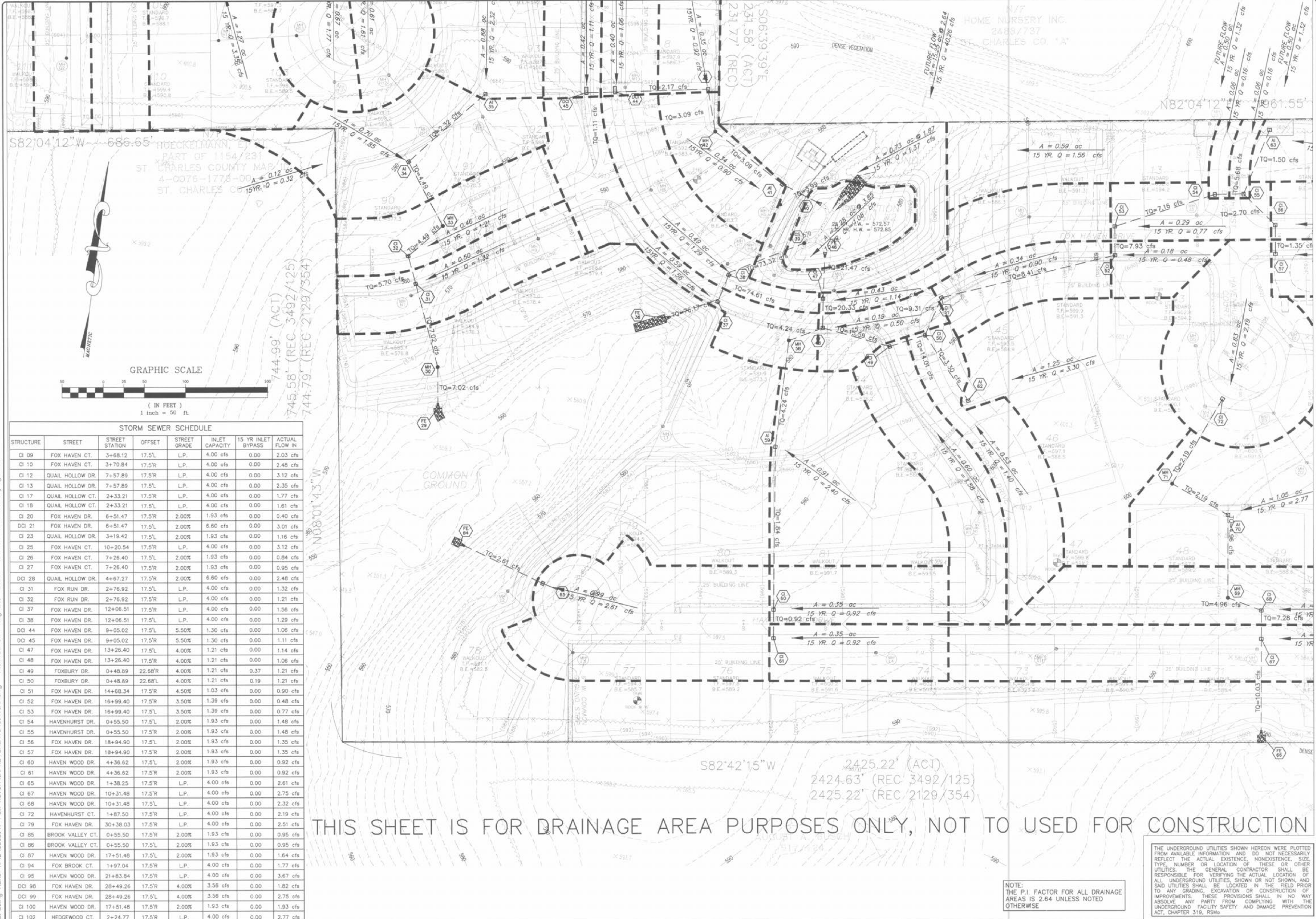

STORM SEWER SCHEDULE

STRUCTURE	STREET	STREET STATION	OFFSET	STREET GRADE	INLET CAPACITY	15 YR INLET BYPASS	ACTUAL FLOW IN
CI 09	FOX HAVEN CT.	3+68.12	17.5'L	L.P.	4.00 cfs	0.00	2.03 cfs
CI 10	FOX HAVEN CT.	3+70.84	17.5'R	L.P.	4.00 cfs	0.00	2.48 cfs
CI 12	QUAIL HOLLOW DR.	7+57.89	17.5'R	L.P.	4.00 cfs	0.00	3.12 cfs
CI 13	QUAIL HOLLOW DR.	7+57.89	17.5'L	L.P.	4.00 cfs	0.00	2.35 cfs
CI 17	QUAIL HOLLOW CT.	2+33.21	17.5'R	L.P.	4.00 cfs	0.00	1.77 cfs
CI 18	QUAIL HOLLOW CT.	2+33.21	17.5'L	L.P.	4.00 cfs	0.00	1.61 cfs
CI 20	FOX HAVEN DR.	6+51.47	17.5'R	2.00%	1.93 cfs	0.00	0.40 cfs
DCI 21	FOX HAVEN DR.	6+51.47	17.5'L	2.00%	6.60 cfs	0.00	3.01 cfs
CI 23	QUAIL HOLLOW DR.	3+19.42	17.5'L	2.00%	1.93 cfs	0.00	1.16 cfs
CI 25	FOX HAVEN CT.	10+20.54	17.5'R	L.P.	4.00 cfs	0.00	3.12 cfs
CI 26	FOX HAVEN CT.	7+26.40	17.5'L	2.00%	1.93 cfs	0.00	0.84 cfs
CI 27	FOX HAVEN CT.	7+26.40	17.5'R	2.00%	1.93 cfs	0.00	0.95 cfs
DCI 28	QUAIL HOLLOW DR.	4+67.27	17.5'R	2.00%	6.60 cfs	0.00	2.48 cfs
CI 31	FOX RUN DR.	2+76.92	17.5'L	L.P.	4.00 cfs	0.00	1.32 cfs
CI 32	FOX RUN DR.	2+76.92	17.5'R	L.P.	4.00 cfs	0.00	1.21 cfs
CI 37	FOX HAVEN DR.	12+06.51	17.5'R	L.P.	4.00 cfs	0.00	1.56 cfs
CI 38	FOX HAVEN DR.	12+06.51	17.5'L	L.P.	4.00 cfs	0.00	1.29 cfs
DCI 44	FOX HAVEN DR.	9+05.02	17.5'L	5.50%	1.30 cfs	0.00	1.06 cfs
DCI 45	FOX HAVEN DR.	9+05.02	17.5'R	5.50%	1.30 cfs	0.00	1.11 cfs
CI 47	FOX HAVEN DR.	13+26.40	17.5'L	4.00%	1.21 cfs	0.00	1.14 cfs
CI 48	FOX HAVEN DR.	13+26.40	17.5'R	4.00%	1.21 cfs	0.00	1.06 cfs
CI 49	FOX BURRY DR.	0+48.89	22.68'R	4.00%	1.21 cfs	0.37	1.21 cfs
CI 50	FOX BURRY DR.	0+48.89	22.68'L	4.00%	1.21 cfs	0.19	1.21 cfs
CI 51	FOX HAVEN DR.	14+68.34	17.5'R	4.50%	1.03 cfs	0.00	0.90 cfs
CI 52	FOX HAVEN DR.	16+99.40	17.5'R	3.50%	1.39 cfs	0.00	0.48 cfs
CI 53	FOX HAVEN DR.	16+99.40	17.5'L	3.50%	1.39 cfs	0.00	0.77 cfs
CI 54	HAVENHURST DR.	0+55.50	17.5'L	2.00%	1.93 cfs	0.00	1.48 cfs
CI 55	HAVENHURST DR.	0+55.50	17.5'R	2.00%	1.93 cfs	0.00	1.48 cfs
CI 56	FOX HAVEN DR.	18+94.90	17.5'L	2.00%	1.93 cfs	0.00	1.35 cfs
CI 57	FOX HAVEN DR.	18+94.90	17.5'R	2.00%	1.93 cfs	0.00	1.35 cfs
CI 60	HAVEN WOOD DR.	4+36.62	17.5'L	2.00%	1.93 cfs	0.00	0.92 cfs
CI 61	HAVEN WOOD DR.	4+36.62	17.5'R	2.00%	1.93 cfs	0.00	0.92 cfs
CI 65	HAVEN WOOD DR.	1+38.25	17.5'R	L.P.	4.00 cfs	0.00	2.61 cfs
CI 67	HAVEN WOOD DR.	10+31.48	17.5'R	L.P.	4.00 cfs	0.00	2.75 cfs
CI 68	HAVEN WOOD DR.	10+31.48	17.5'L	L.P.	4.00 cfs	0.00	2.32 cfs
CI 72	HAVENHURST CT.	1+87.50	17.5'R	L.P.	4.00 cfs	0.00	2.19 cfs
CI 79	FOX HAVEN DR.	30+38.03	17.5'R	L.P.	4.00 cfs	0.00	2.51 cfs
CI 85	BROOK VALLEY CT.	0+55.50	17.5'R	2.00%	1.93 cfs	0.00	0.95 cfs
CI 86	BROOK VALLEY CT.	0+55.50	17.5'L	2.00%	1.93 cfs	0.00	0.95 cfs
CI 87	HAVEN WOOD DR.	17+51.48	17.5'L	2.00%	1.93 cfs	0.00	1.64 cfs
CI 94	FOX BROOK CT.	1+97.04	17.5'R	L.P.	4.00 cfs	0.00	1.77 cfs
CI 95	HAVEN WOOD DR.	21+83.84	17.5'R	L.P.	4.00 cfs	0.00	3.67 cfs
DCI 98	FOX HAVEN DR.	28+49.26	17.5'R	4.00%	3.56 cfs	0.00	1.82 cfs
DCI 99	FOX HAVEN DR.	28+49.26	17.5'L	4.00%	3.56 cfs	0.00	2.75 cfs
CI 100	HAVEN WOOD DR.	17+51.48	17.5'R	2.00%	1.93 cfs	0.00	1.93 cfs
CI 102	HEDGEWOOD CT.	2+24.77	17.5'R	L.P.	4.00 cfs	0.00	2.77 cfs

THIS SHEET IS FOR DRAINAGE AREA PURPOSES ONLY, NOT TO BE USED FOR CONSTRUCTION

NOTE: THE P.I. FACTOR FOR ALL DRAINAGE AREAS IS 2.64 UNLESS NOTED OTHERWISE

THE UNDERGROUND UTILITIES SHOWN HEREON WERE PLOTTED FROM AVAILABLE INFORMATION AND DO NOT NECESSARILY REFLECT THE ACTUAL EXISTENCE, NONEXISTENCE, SIZE, TYPE, NUMBER OR LOCATION OF THESE OR OTHER UTILITIES. THE GENERAL CONTRACTOR SHALL BE RESPONSIBLE FOR VERIFYING THE ACTUAL LOCATION OF ALL UNDERGROUND UTILITIES, SHOWN OR NOT SHOWN, AND SAID UTILITIES SHALL BE LOCATED IN THE FIELD PRIOR TO ANY GRADING, EXCAVATION OR CONSTRUCTION OF IMPROVEMENTS. THESE PROVISIONS SHALL IN NO WAY ABSOLVE ANY PARTY FROM COMPLYING WITH THE UNDERGROUND FACILITY SAFETY AND DAMAGE PREVENTION ACT, CHAPTER 319, RSMo

ISSUE	REMARKS/DATE
1	03-01-04 FIRST SUBMITTAL
2	06-15-04 REVISED PER CITY COMMENTS
3	07-20-04 REVISED PER CITY COMMENTS
4	08-04-04 REVISED PER CITY COMMENTS
5	08-12-04 REVISED PER PWSOP COMMENTS
6	10-18-04 REVISED PER DEVELOPER COMMENTS
7	04-21-05 REVISED OUTFALL STRUCTURE 02
8	06-14-05 GRADING COMMENTS PER DEVELOPER

PREPARED FOR:
McBride & Son Homes
 Land Development, Inc.
 #1 McBride & Son Center Drive
 Chesterfield, Missouri 63005
 (636) 537-2000



THE **STERLING CO.**
 ENGINEERS & SURVEYORS
 5055 NEW BALMGARTNER ROAD
 ST. LOUIS, MISSOURI 63129
 (314) 487-0440 FAX 487-8844
 E-Mail: Sterling@sterling-eng-survey.com

PROJECT:	NO 03 06 147
DRAWN:	M.S.D. SHEET 24
DESIGNED:	P# 48
CHECKED:	OF
SHEET TITLE:	DRAINAGE AREA MAP

BASE MAP