

TYPICAL PAVEMENT SECTION

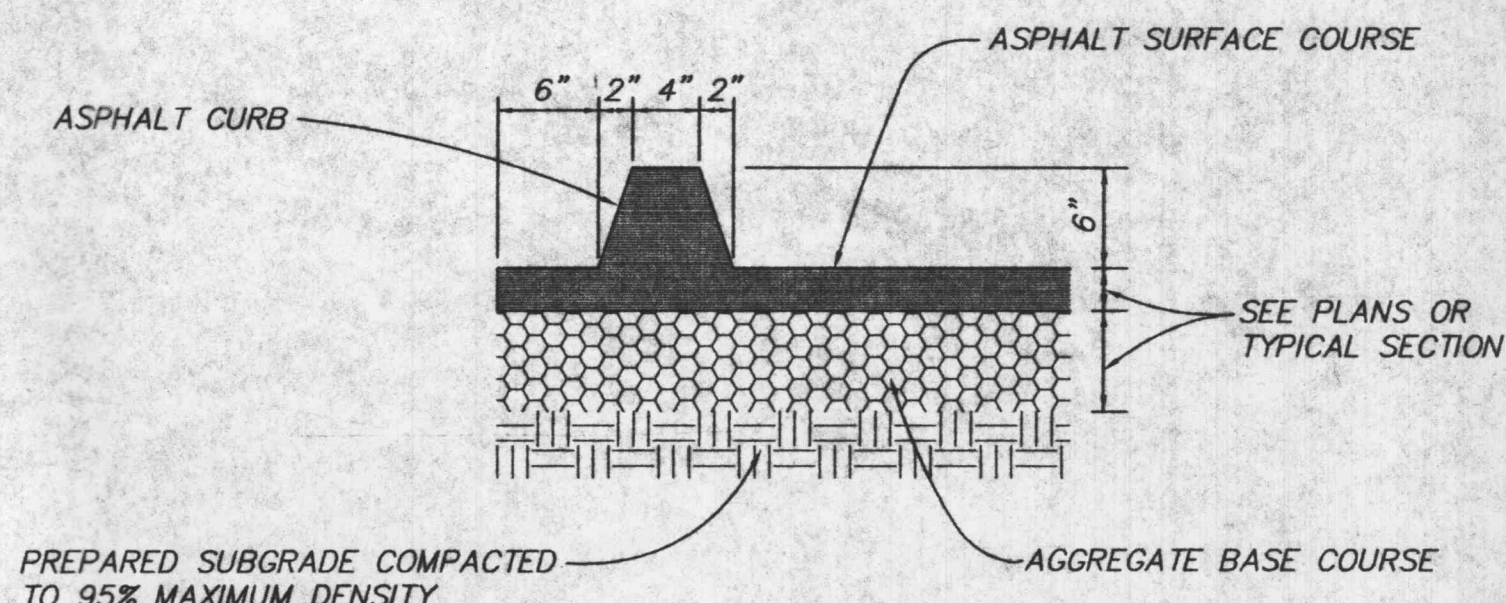

6" ASPHALT CURB
N.T.S.

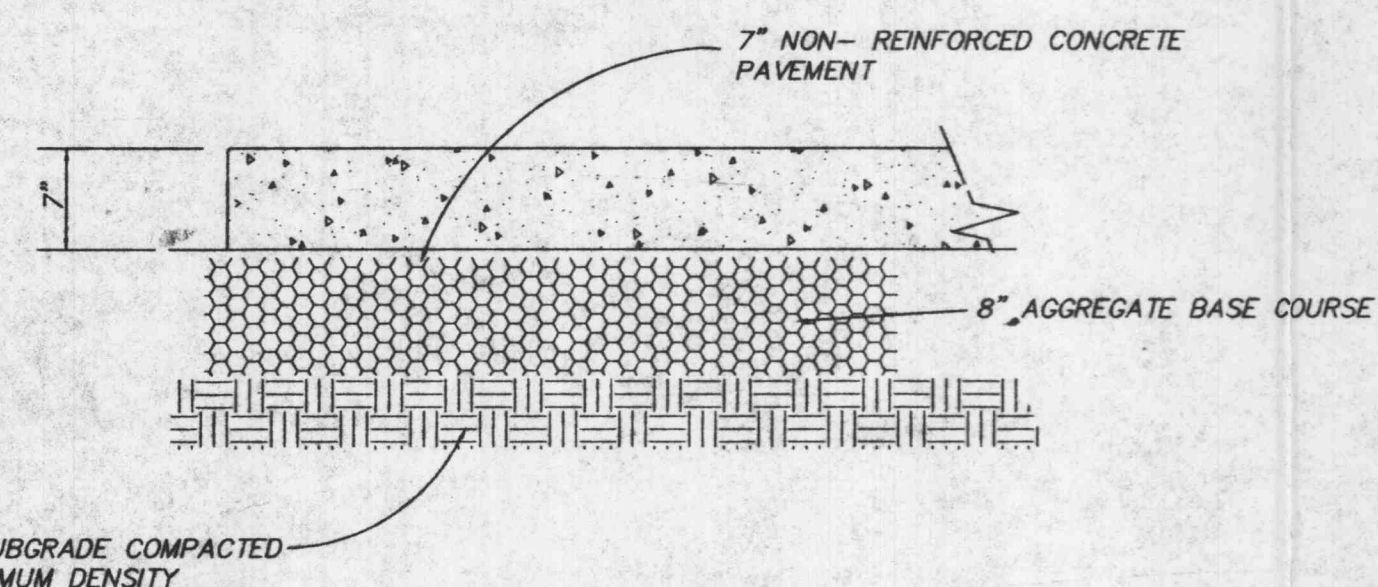

CONCRETE PAVEMENT DETAIL
N.T.S.

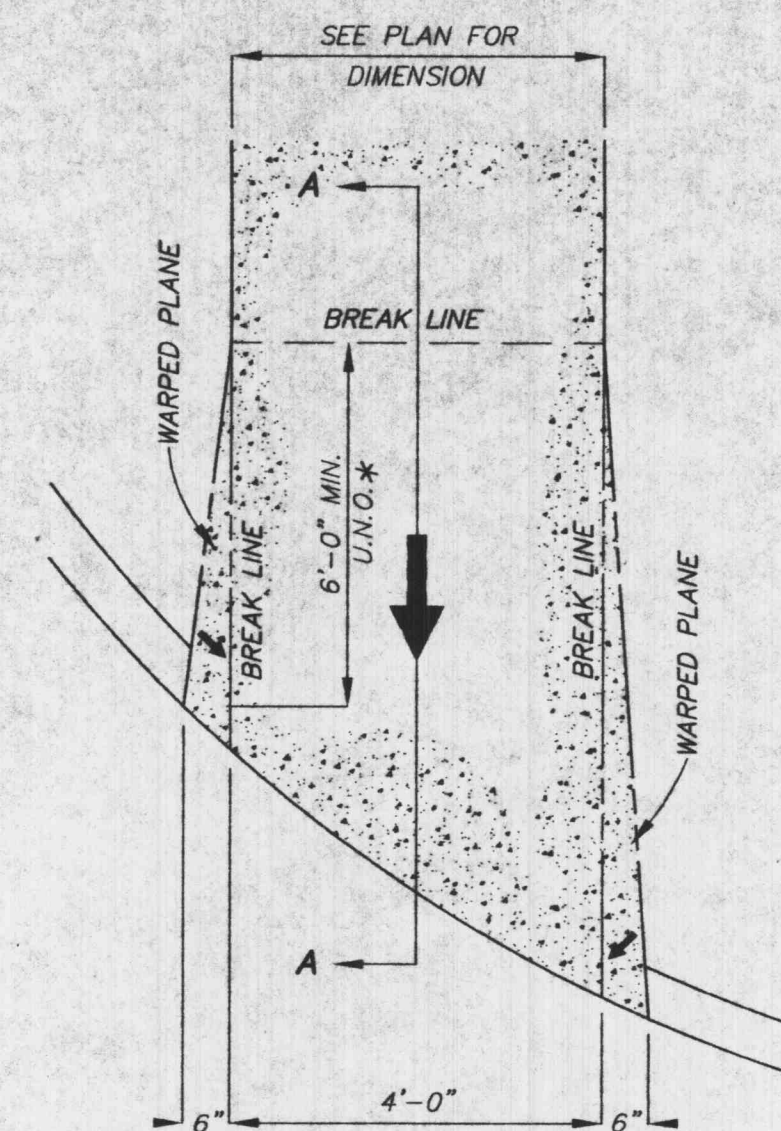

*U.N.O. = UNLESS NOTED OTHERWISE ON SITE PLAN

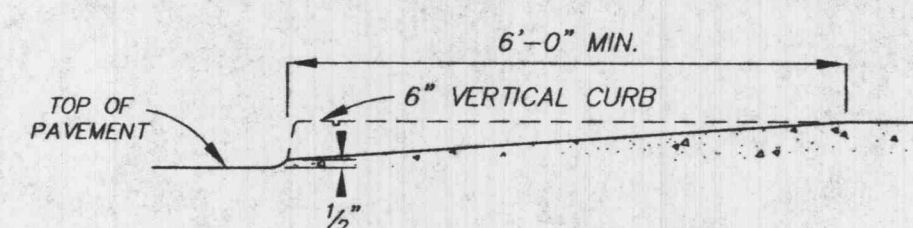

CURVED CURB
HANDICAPPED RAMP DETAIL
N.T.S.

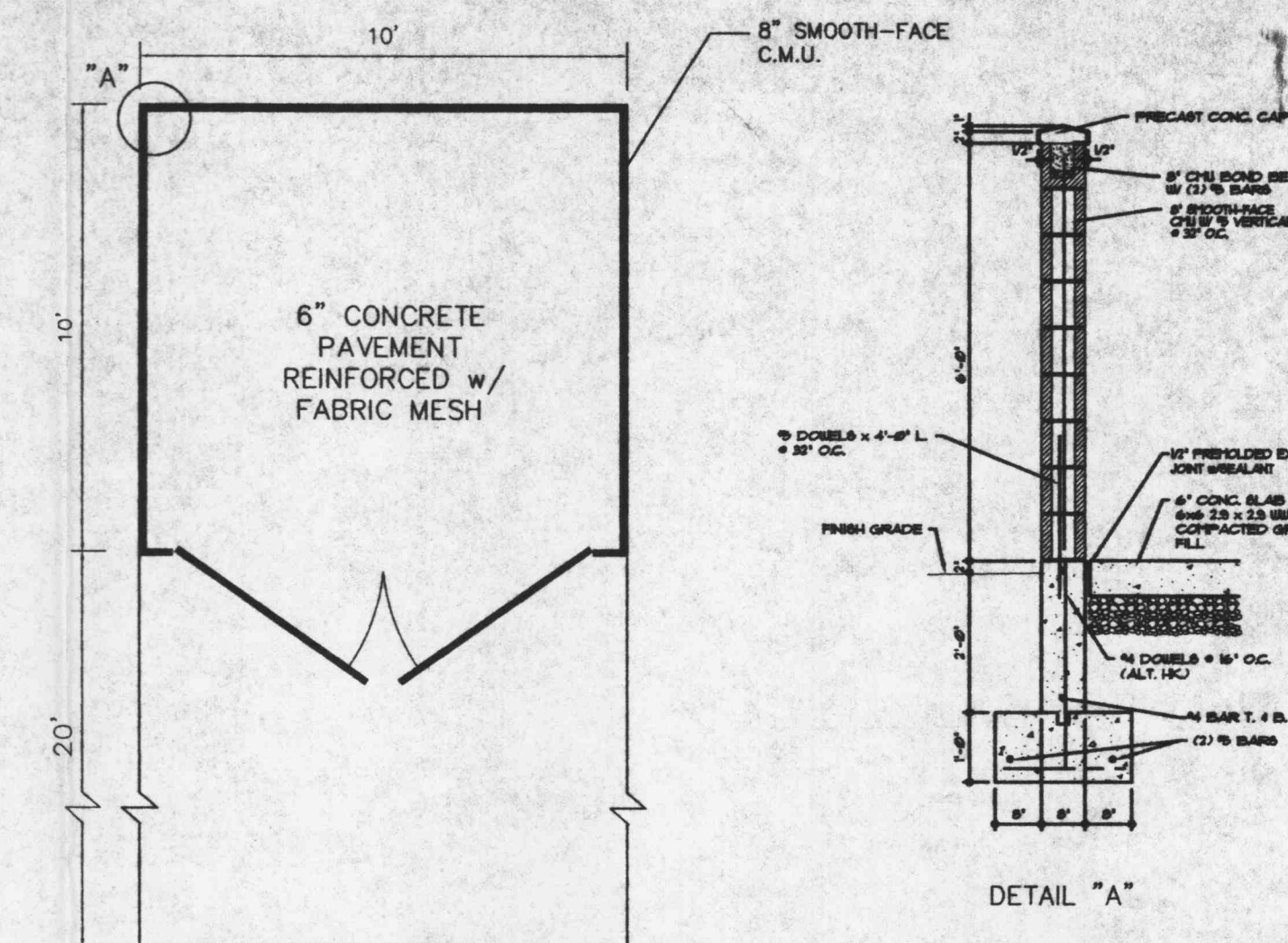

TRASH ENCLOSURE DETAIL

Siltation Control

Siltation control shall consist of temporary berms and swales to divert storm water run-off to a natural discharge point. (See Grading Plan for locations.) At which point there shall be a double row of straw bales with four feet of separation between bales and straw bales shall be staggered. In areas where a berm and swales are not feasible, a single row of straw bales shall be placed end to end to protect adjacent property and right-of-ways (this shall be the responsibility of the grading contractor or developer if so agreed). Upon completion of storm sewers, straw bales shall be placed on all sides of appropriate structures to keep silt out of storm sewer (this shall be the responsibility of the sewer contractor or the developer if so agreed). All straw bales shall be securely anchored and properly maintained until all disturbed areas are paved or vegetation established.

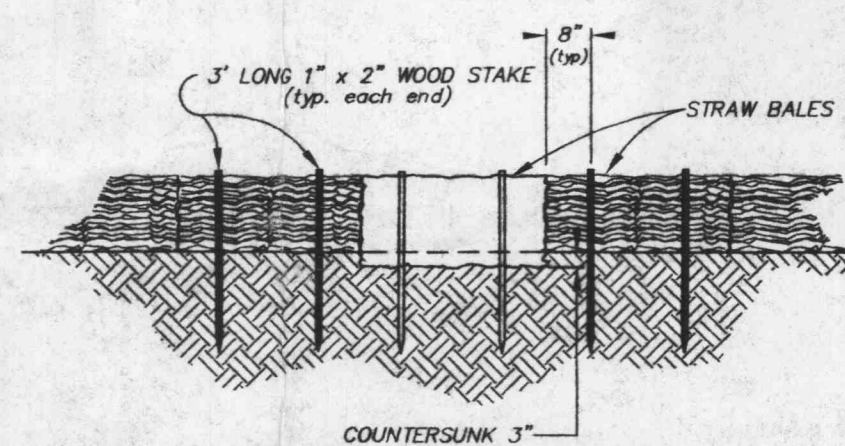

STAKED BALE DETAIL

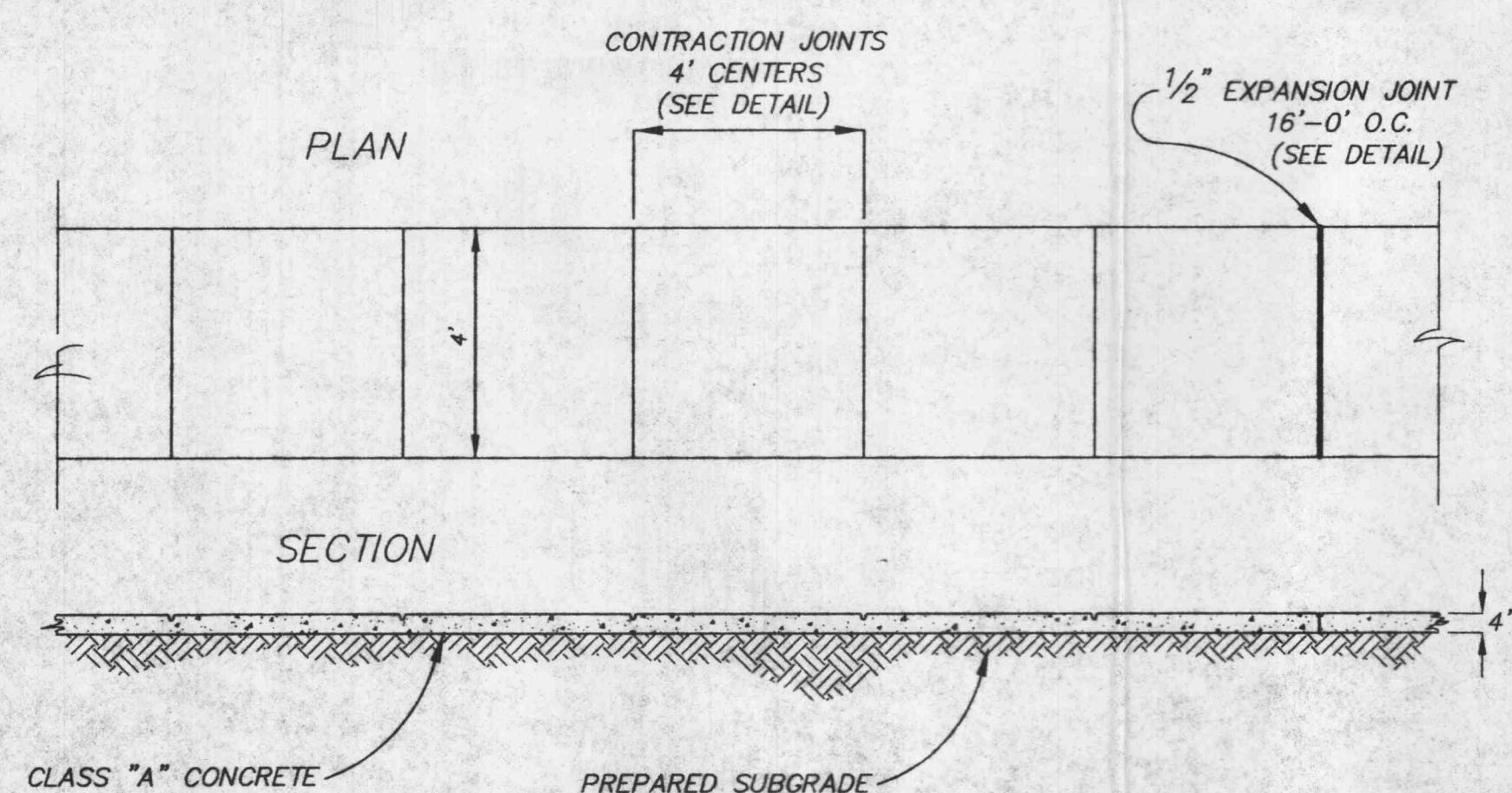

CONCRETE SIDEWALK DETAIL
N.T.S.

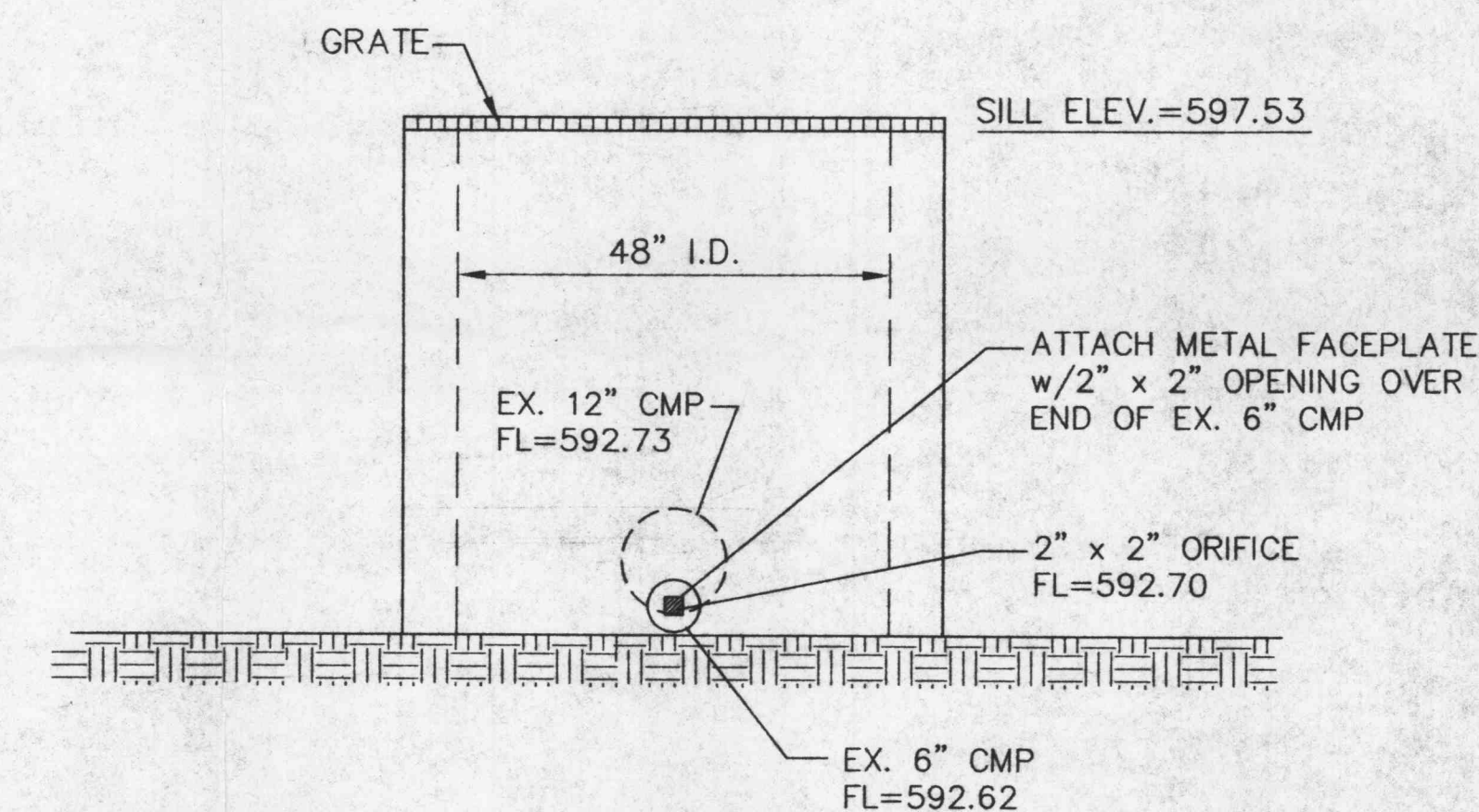

EXISTING OUTFALL STRUCTURE
48" INSIDE DIAMETER STANDPIPE
WITH GRATE ON SILL

H:\99203\dwg\99203.dwg, Tue, Jun 20, 14: 00: 02, 2007
 HP Desig\jnet 755DM Hewlett-Packard HP-BL/2 devices, ADI 4.3 - 10r Autodesk by HP
 99203