

ES COUNTY

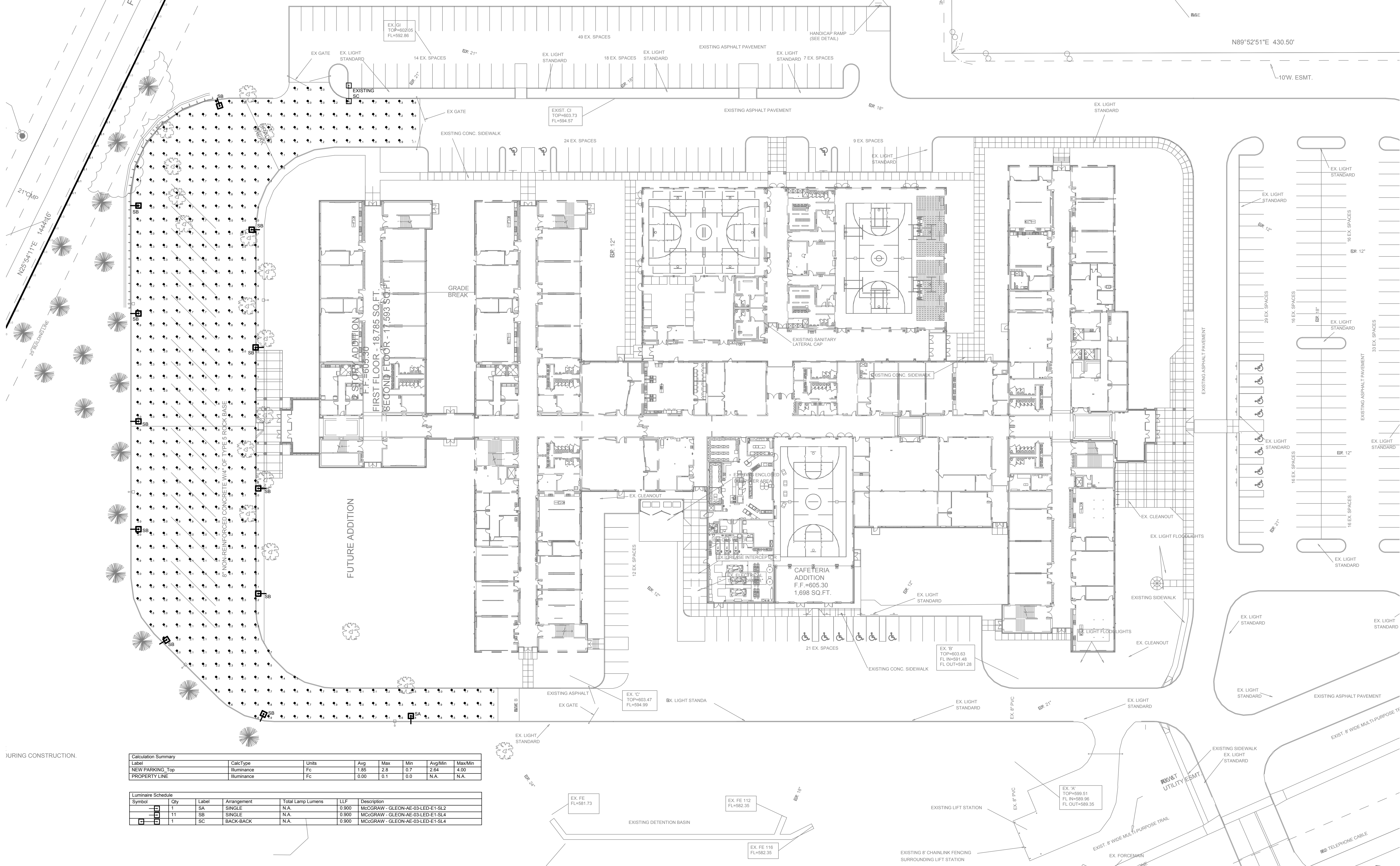
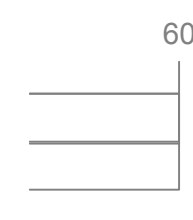

Calculation Summary						
Label	CalcType	Units	Avg	Max	Min	Avg/Min
NEW PARKING_Top	Illuminance	Fc	1.85	2.8	0.7	2.64
PROPERTY LINE	Illuminance	Fc	0.00	0.1	0.0	N.A.

Luminaire Schedule						
Symbol	Qty	Label	Arrangement	Total Lamp Lumens	LLF	Description
1	1	SA	SINGLE	N.A.	0.900	MCCRAW - GLEON-AE-03-LED-E1-SL2
11	1	SB	SINGLE	N.A.	0.900	MCCRAW - GLEON-AE-03-LED-E1-SL4
1	1	SC	BACK-BACK	N.A.	0.900	MCCRAW - GLEON-AE-03-LED-E1-SL4

N  
**PARTIAL SITE PHOTOMETRIC PLAN**  
 SCALE: 1" = 30' - 0"



CHUCK DALE-DERKS  
 LICENSE #24547  
 ENGINEERING CORP.  
 NO. 00067

GEOTECHNICAL  
 PSI, INC.

STRUCTURAL  
 MECH/ELEC/PLUMB  
 CIVIL/SURVEY

**FRONTIER MIDDLE SCHOOL**  
 HOENER ASSOCIATES, INC. - ARCHITECTS  
 CONSULTING ENGINEERS:  
 ASDG, LLC  
 MCCLURE ENGINEERING  
 BAX ENGINEERING

WHERITZVILLE R-F SCHOOL DISTRICT  
**HOENER ASSOCIATES, INC. - ARCHITECTS**  
 6707 PLAINVIEW AVENUE  
 ST. LOUIS, MISSOURI 63109  
 Ph. (314) 781-9855 - Fax (314) 781-0163



ALL DIMENSIONS MUST BE VERIFIED AT BUILDING BEFORE WORK IS EXECUTED. THIS DRAWING IS THE PROPERTY OF THE ARCHITECTS AND SHALL NOT BE COPIED OR DUPLICATED WITHOUT THEIR CONSENT.

proj. no. 19-06C  
 date issued  
 ISSUE DATE  
 date revised

drawn by TWF  
 checked by SWD  
 sheet no.

**E1.00**

SITE PHOTOMETRIC

S:\112708.005 WSD Frontier MS Addition Ph 4\03 Electrical\E1.00.dwg 01/15/20 14:42 T\Fisher