

ST. CHARLES COUNTY

1768/585  
UNZONED O'FALLON

END PIPE  
21" CMP  
FL = 5712.0

END PIPE  
21" CMP  
FL = 5711.7

25' BUILDING LINE

FOX WOOD ( 50'W PRIVATE ) DRIVE

10

ZONED A  
ST. CHARLES COUNTY

FOX WOOD ESTATES  
PLAT TWO  
P.B.19 PG.187

ST. CHARLES COUNTY

FOX WOOD DRIVE  
( 50'W PRIVATE )

GRADING LIMITS

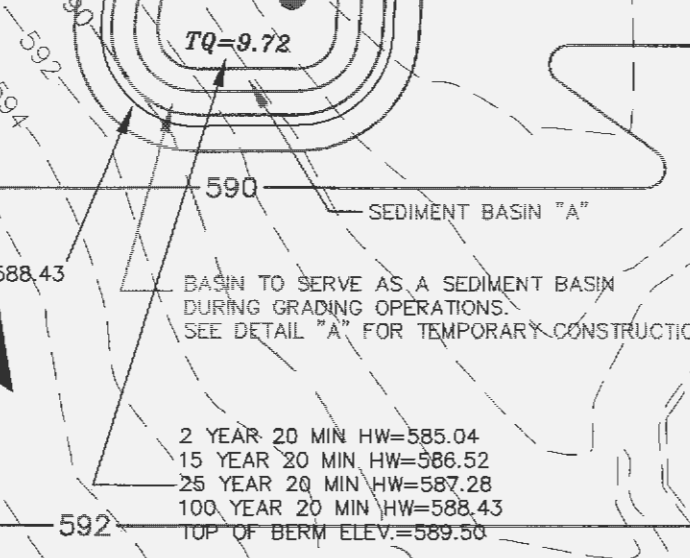

GRADING LIMITS

6' BUILDING LINE

GRADING LIMITS

6' BUILDING LINE

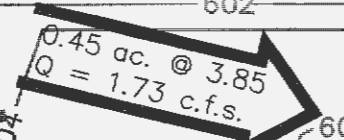
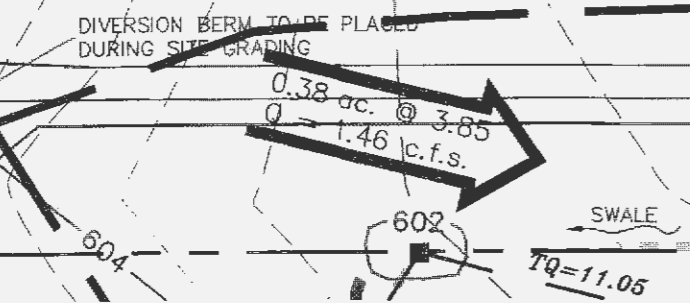

VEGETATION CONTROL SEE SHEET C4.10

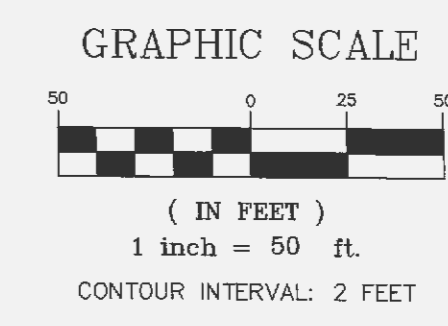

A St. Charles County Highway Department Special Use Permit must be obtained before any work is allowed to commence on the Right-Of-Way of public road under St. Charles County's control or maintenance.

CITY FILE #6403.02

WENTZVILLE, MISSOURI

NEW MIDDLE SCHOOL  
WENTZVILLE R-IV SCHOOL DISTRICT

1002 South Clermont Drive  
St. Peters, MO. 65759-6445  
636-928-8882  
636-928-8882  
FAX 636-928-1718



CONSULTING ENGINEERS:  
ABS CONSULTING, INC.  
MECH/ELEC/PLUMB  
BAX ENGINEERING  
DENNIS G. GLORE, INC.

HOENER ASSOCIATES, INC.  
ARCHITECTS  
ST. LOUIS, MISSOURI

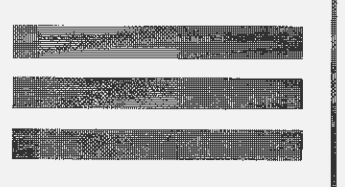

ALL DIMENSIONS MUST BE VERIFIED AT BUILDING BEFORE WORK IS EXECUTED. THIS DRAWING IS THE PROPERTY OF THE ARCHITECTS AND SHALL NOT BE COPIED OR DUPLICATED WITHOUT THEIR CONSENT.

job no. 02-06Q  
date issued  
6-24-04  
date revised  
7-12-04 CITY COMMENTS

drawn by SWR  
checked by SWR  
sheet no.

C4.00

DRAINAGE MAP

E:\DWG\A12000\PLUS\12495 WENTZVILLE SCHOOL - FOXWOOD\CONSTRUCTION\12495GRADING.dwg, DAM-4.0, 7/12/2004 2:38:36 PM, Sta. 36 SWR