

GE AVE. EXTENSION

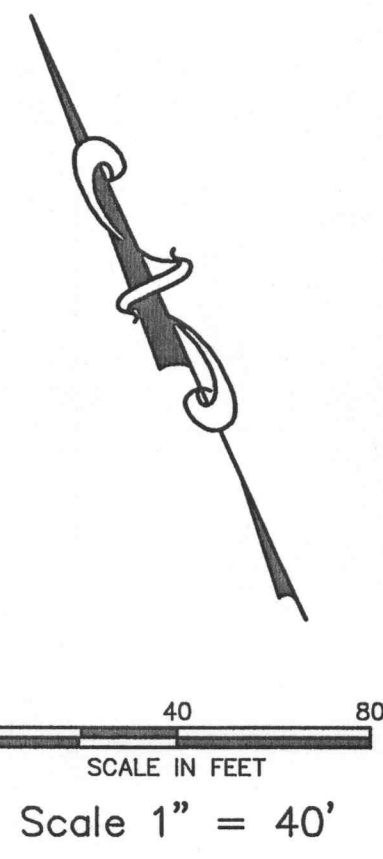

UTILITY NOTES:
 1. Existing sanitary sewer service shall not be interrupted.
 2. Connection to DCSD Sanitary Sewer requires DCSD Inspection. Contact Mr. Steve Overby, Chief Inspector, at (636) 441-1244 to schedule inspection. 24-Hour advance notice required.

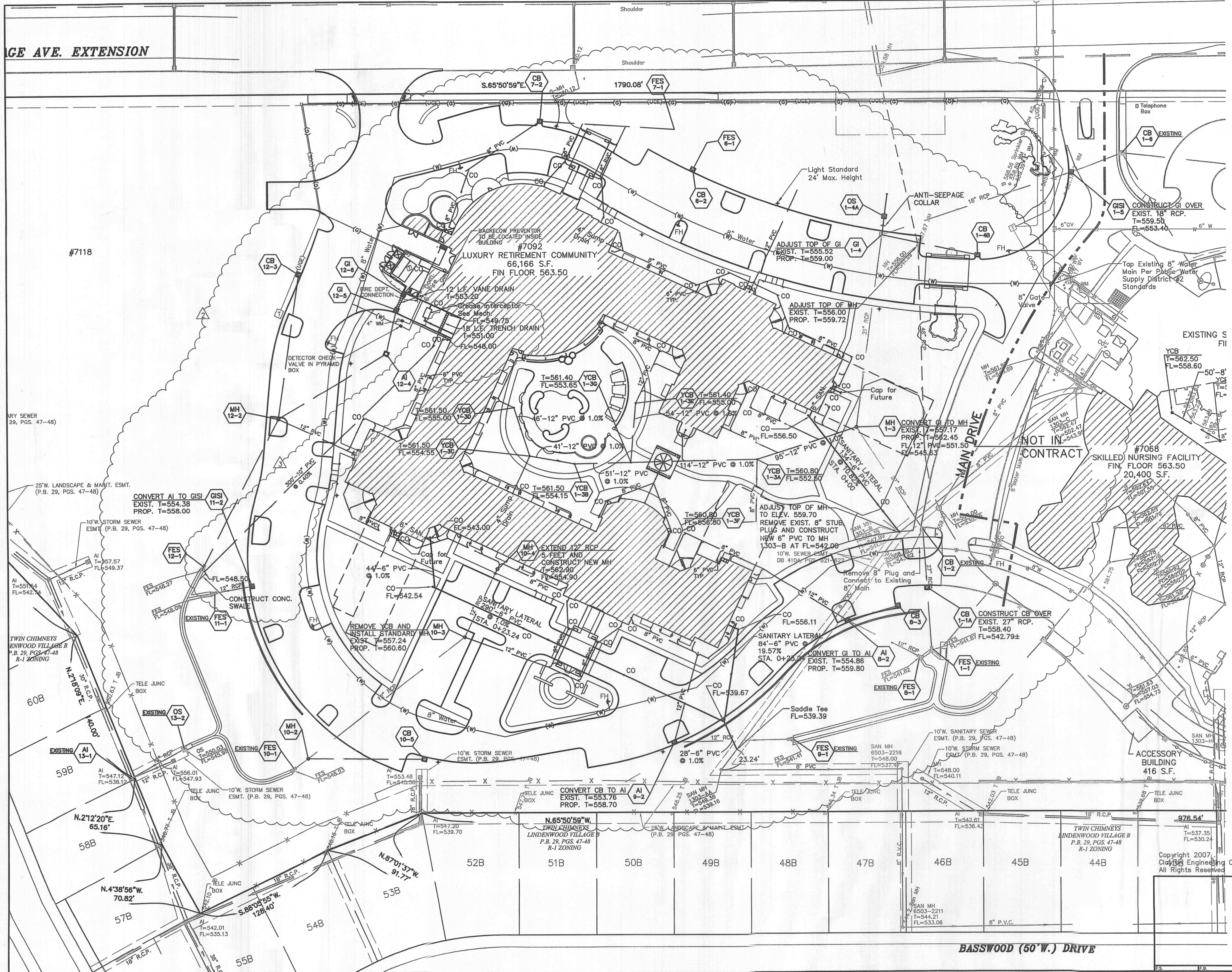
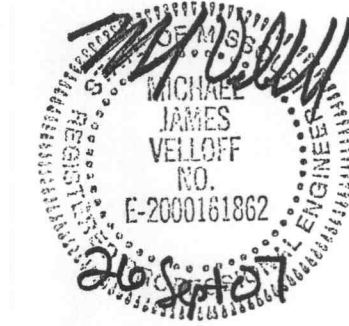

The signed and sealed original of this drawing is on file at the offices of The Clayton Engineering Company, Inc. The signed and sealed original is the official document and shall take precedence over any digital version.

REVISIONS		
3	09/05/07	RKF Added 10" PVC pipe/remove pump
2	08/20/07	RKF Revise tops and flowlines of structures
1	05/07/07	RKF BID SET

**UTILITY PLAN-VILLAS
 GARDEN VILLAS OF O'FALLON**
 Highway N and Twin Chimneys Boulevard O'Fallon, Missouri 63368
 Prepared for:
DELMAR GARDENS ENTERPRISES, INC.
 14805 N. Outer 40
 Chesterfield, MO 63017
 636-733-7000

the clayton engineering company, inc.
 ENGINEERS • SURVEYORS • PLANNERS
 11920 WESTLINE INDUSTRIAL DRIVE
 ST. LOUIS, MISSOURI 63146
 (314) 692-8888 FAX: (314) 692-8688
 clayton-engineering.com

Designed _____ RKF
 Drawn _____ RKF
 Checked _____ MJV
 Date _____ 04/25/07
 Project Number _____ 00228.10
 Sheet Number _____ C-8 of 17

BASSWOOD (50'W.) DRIVE