

ENTRANCE DETAIL
N.T.S.

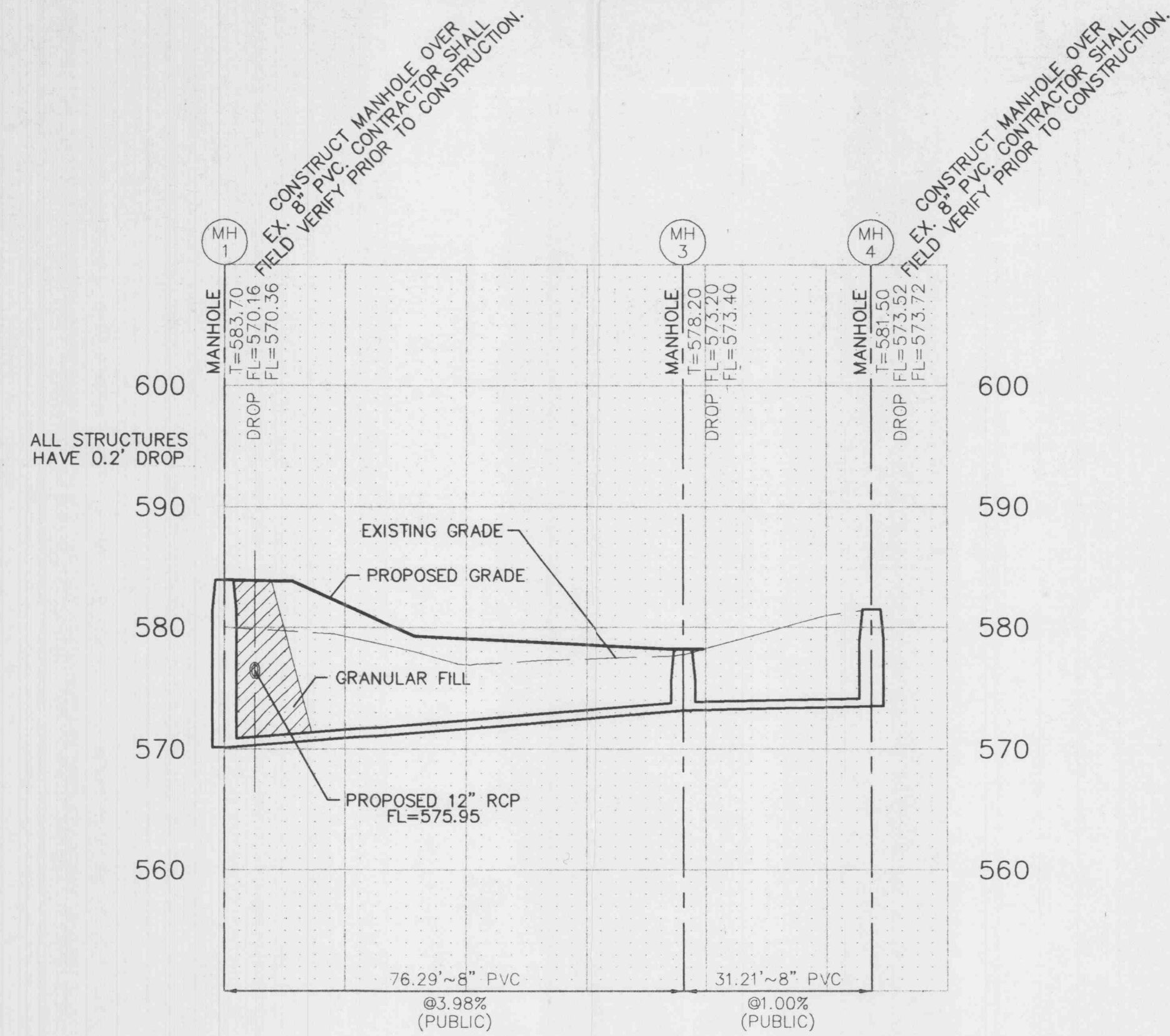

SANITARY PROFILES

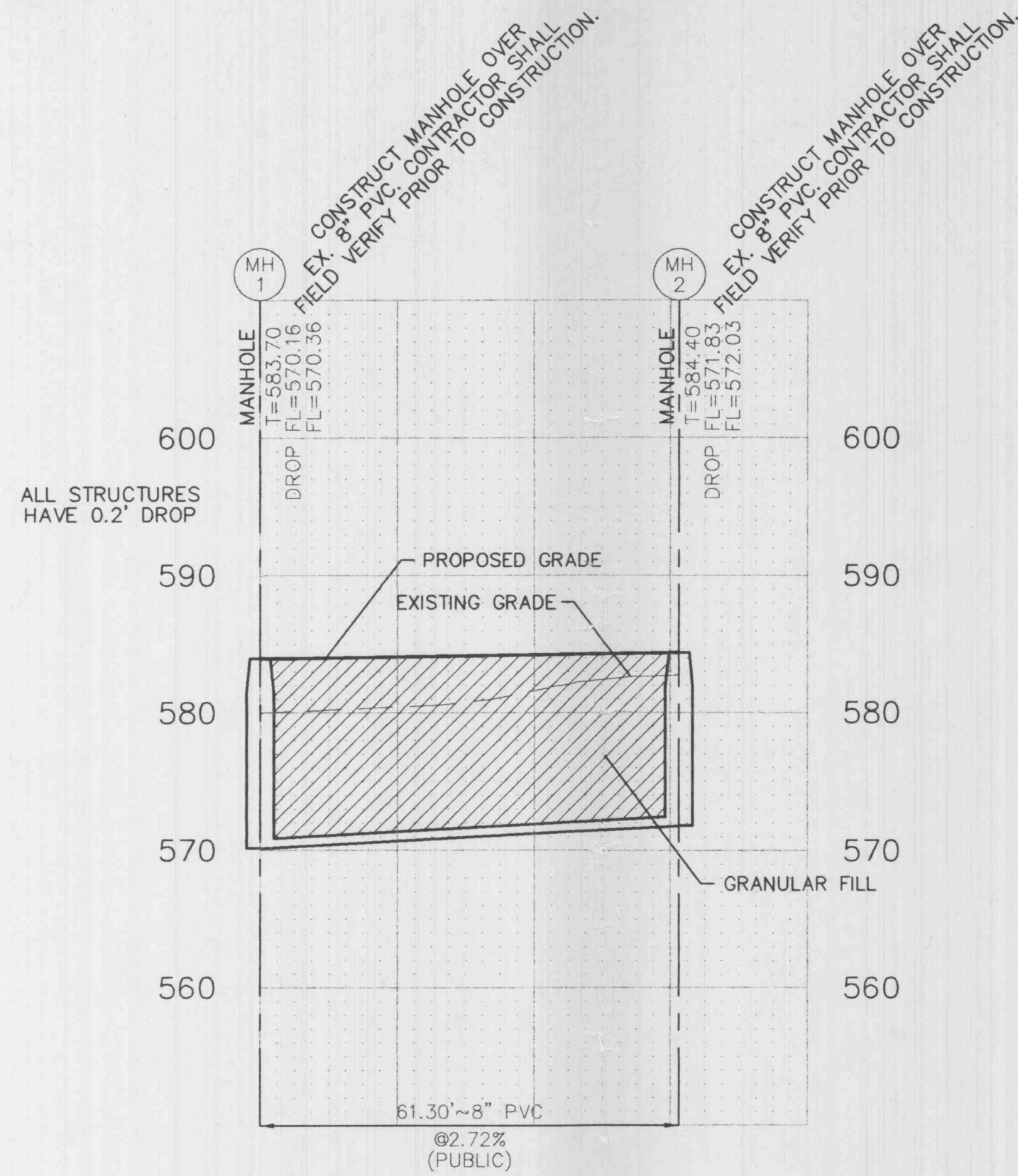
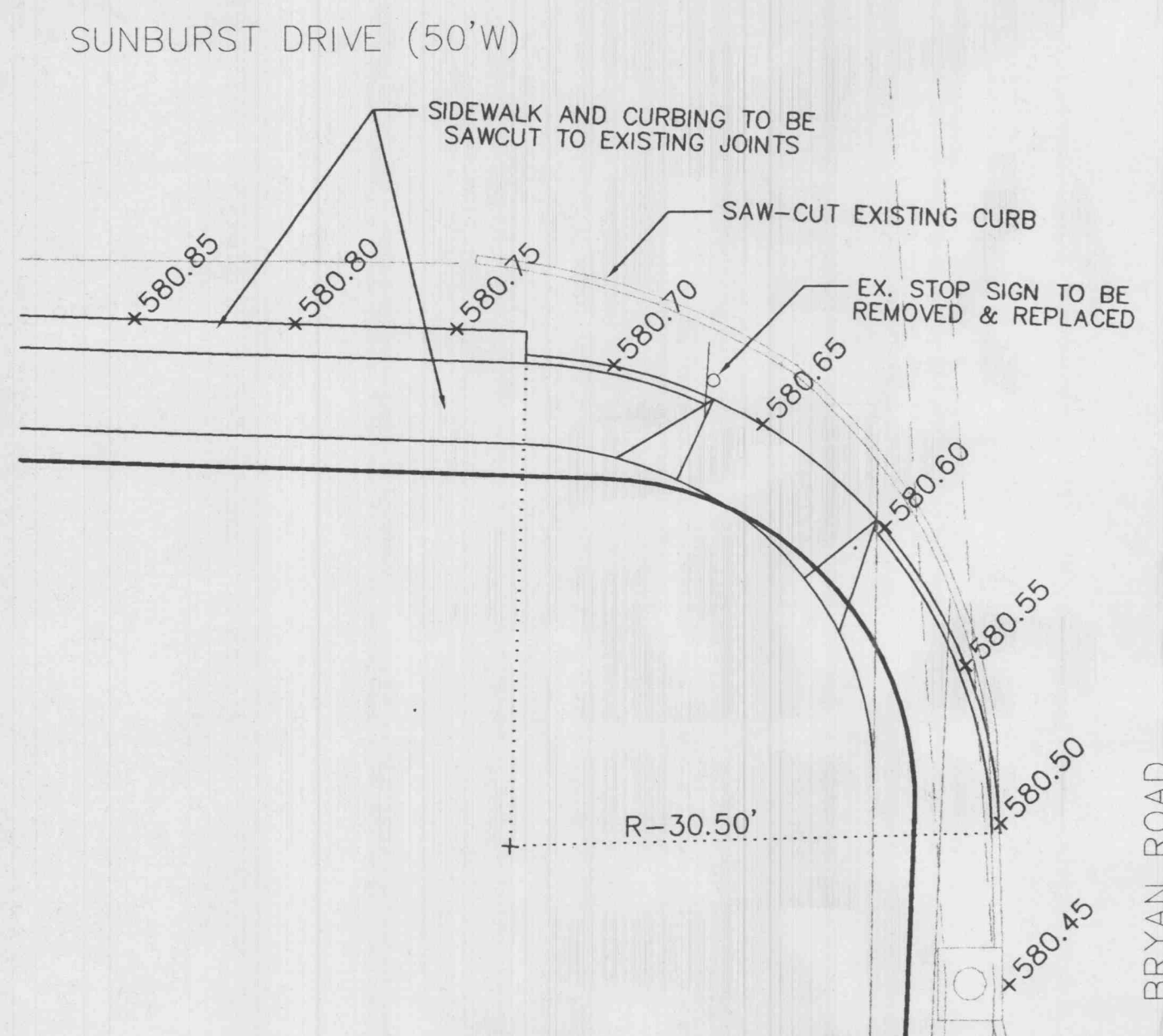

WARPING DETAIL
SOUTHWEST CORNER OF SUNBURST DRIVE AND BRYAN ROAD
N.T.S.

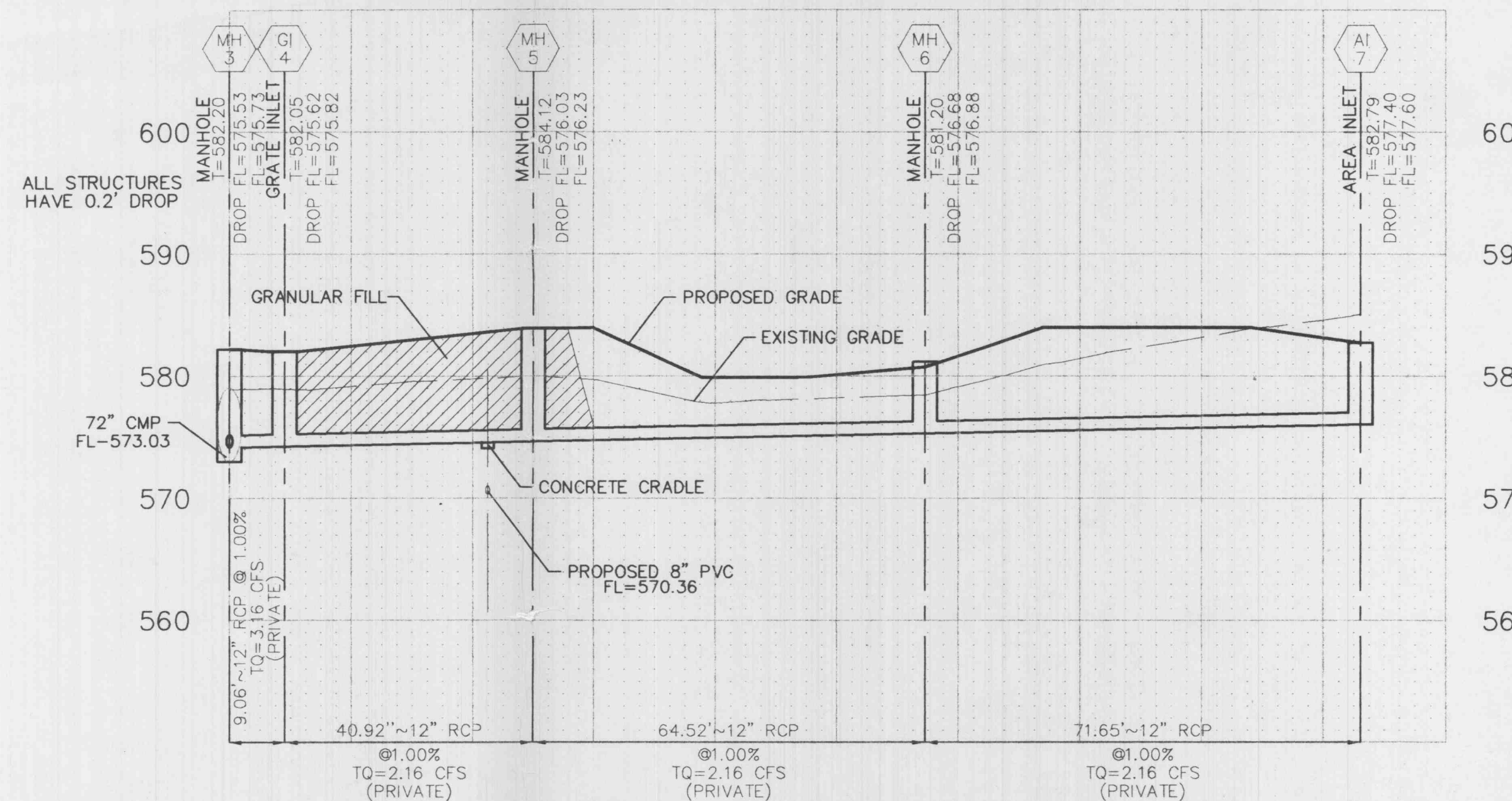
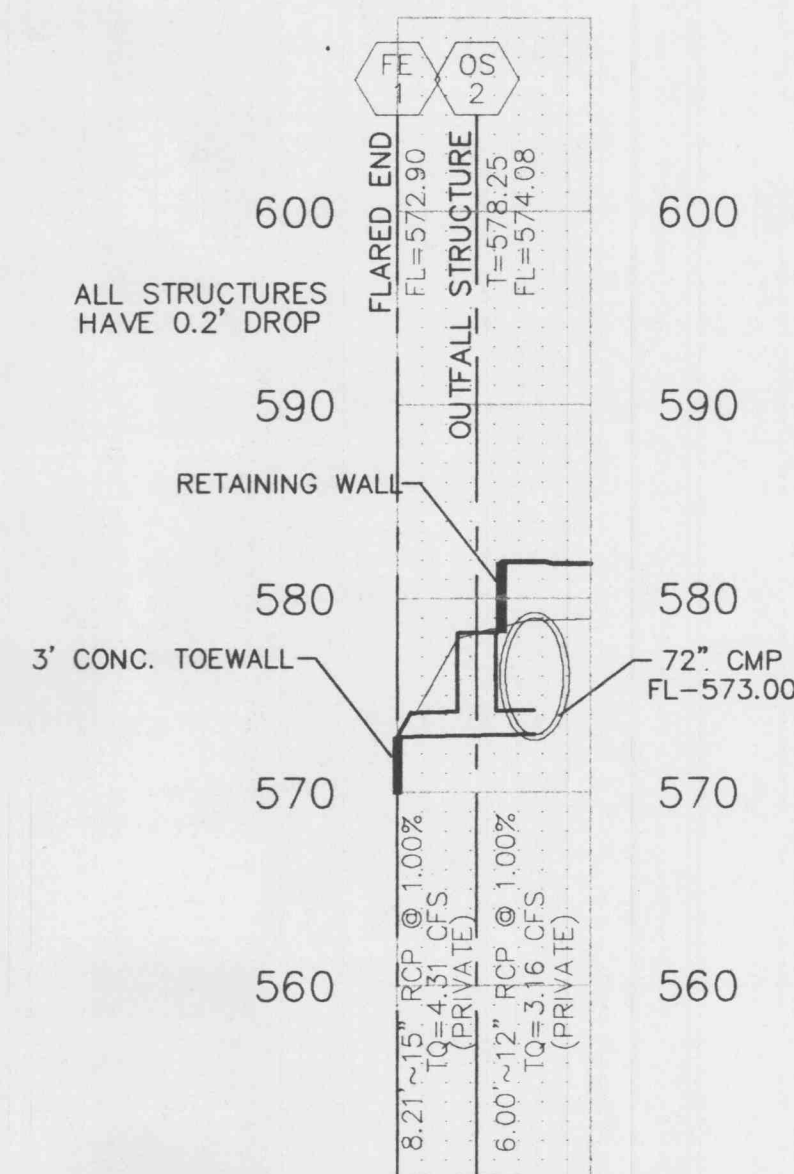

STORM PROFILES

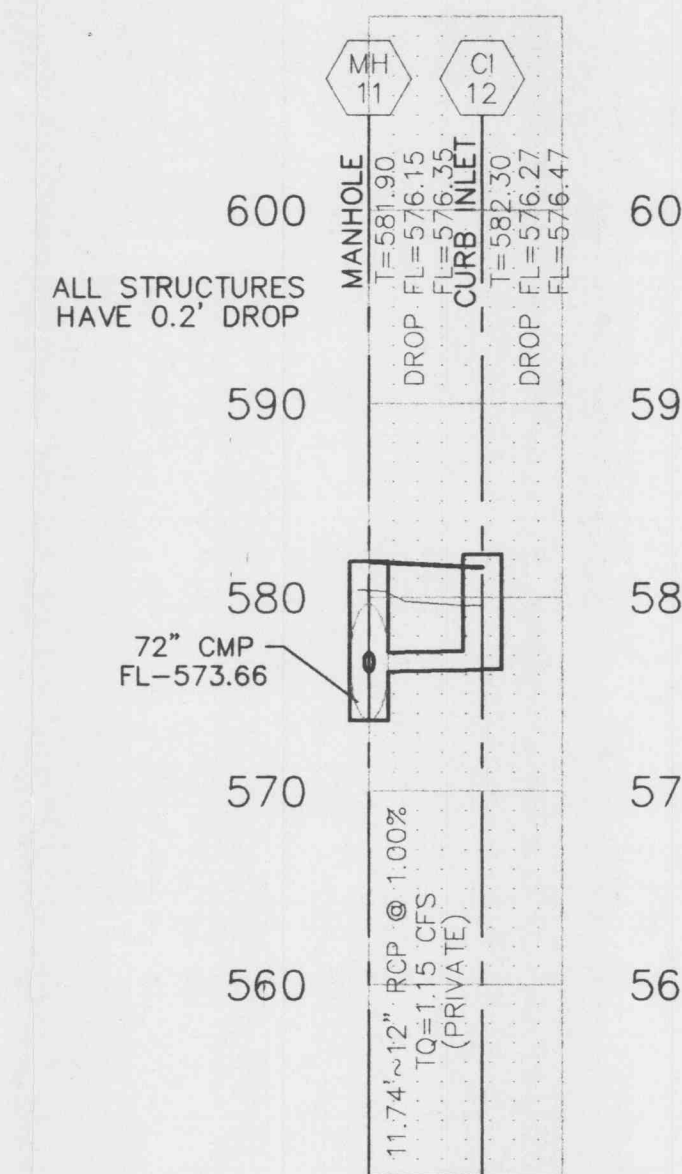

VERT. -1"=10'
HOR. -1"=20'

PICKETT RAY & SILVER

CIVIL ENGINEERS
PLANNERS
LAND SURVEYORS

333 Mid Rivers Mall Drive
St. Peters, MO 63376
Phone (636) 397-1211
Fax (636) 397-1104

GILMAN PLAZA
PROFILE SHEET
O'FALLON, MISSOURI

America's Best
2244 W. State
Stoughton, WI 53589
(608) 877-4146

Prepared For:
Mr. Kraig Williams

NO.	DATE	PER O'FALLON'S COMMENTS
1	12.02.02	PER O'FALLON'S COMMENTS
2	12.17.02	PER O'FALLON'S COMMENTS
3	12.26.02	PER O'FALLON'S COMMENTS

ENGINEERS AUTHENTICATION
The responsibility for professional engineering liability on this project is hereby limited to the set of plans authenticated by the seal, signature, and date hereunder attached. Responsibility is disclaimed for all other engineering plans involved in this project and specifically excludes revisions after this date unless reauthenticated.

PICKETT, RAY & SILVER, INC.
STATE OF MISSOURI
REGISTERED PROFESSIONAL ENGINEER
J. M. WILSON
NUMBER 11751

DRAWN	DATE
J.M.W.	10.03.02
CHECKED	DATE
D.W.B.	10.10.02
PROJECT # 02151.ABBL.01C	
TASK # 1	FIELD BOOK 561B

GILMAN PLAZA
PROFILE SHEET

SHEET 7 OF 8