

NORTH OUTER ROAD

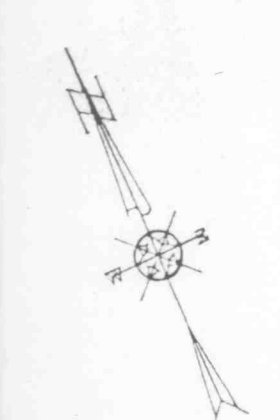
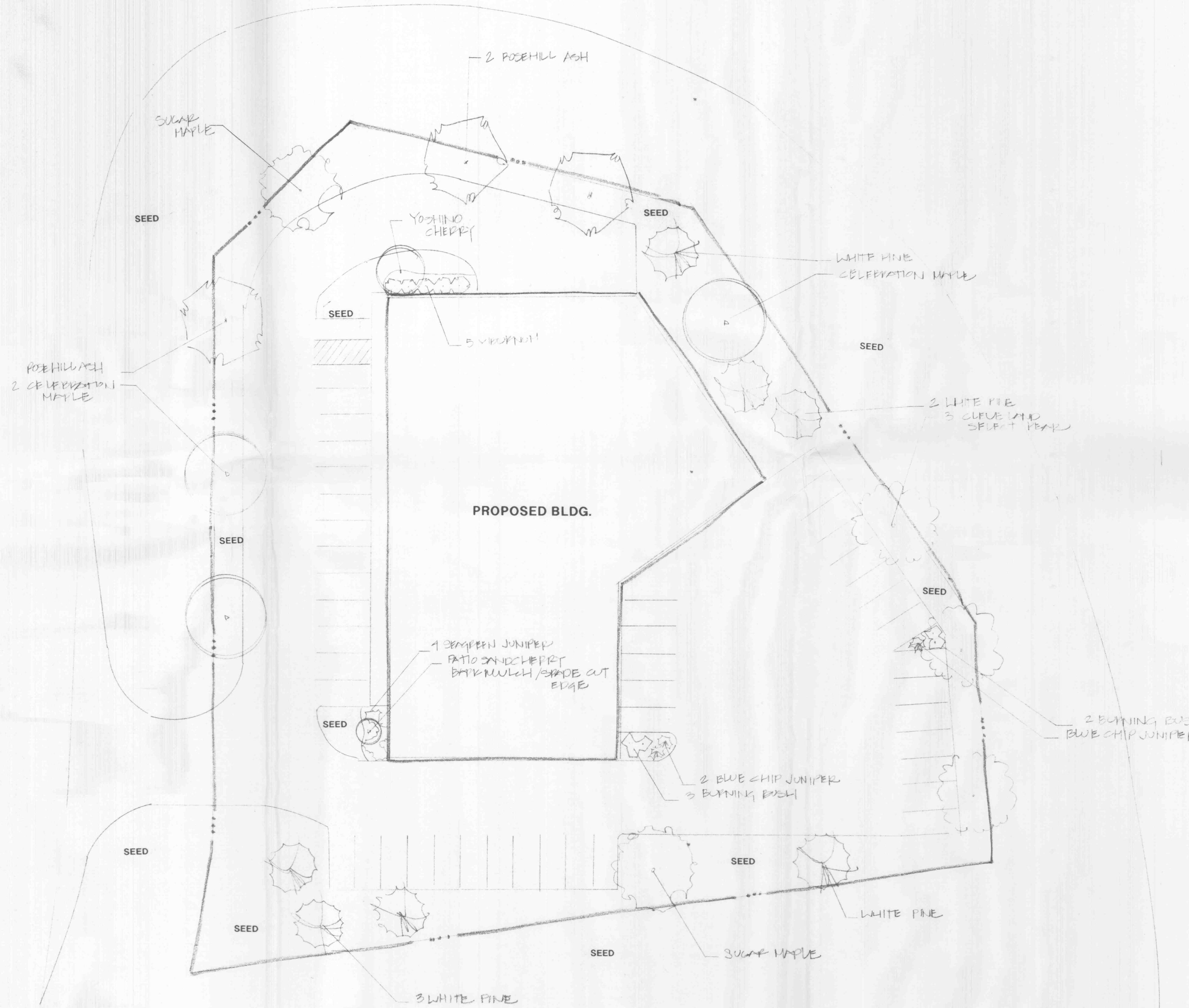

SCALE: 1" = 20' 0"

LEGEND

QUANTITY	VARIETY	SIZE
1	PATIO SANDCHERRY	1.5-2"
3	CELEBRATION MAPLE	2-2.5"
3	CLEVELAND SELECT PEAR	2-2.5"
2	SUGAR MAPLE	2-2.5"
3	ROSEHILL ASH	2-2.5"
1	YOSHINO CHERRY	2-2.5"
7	WHITE PINE	6-7"
4	SEAGREEN JUNIPER	5 gal
3	BLUE CHIP JUNIPER	5 gal
5	BURNING BUSH	18-24"
5	VIBURNUM	30-36"
5	BARK MULCH	CUL.YD.
1565	SEED inside P/L	SQ.YD.
SEED outside P/L to be determined once construction completed		

HWY. 79

NOTICE
 This drawing is the property of A. Waldbart and Sons Nursery. Each plan formulated by our firm involves original thought and ideas; therefore, we reserve the copyright to any design prepared by our staff. Use of this plan and/or any portion thereof for competitive bids, pricing, or related purposes is illegal without our written permission.

GLASSTEK

Date	4-3-00	Revised	7/25/00	Sheet	L-1
Scale	1" = 20' 0"	Approved		1 of 1	Drawn by LH

895-4589

A. WALDBART and SONS Nursery
 Established 1872

Landscape Designers, Landscape Contractors & Nurserymen
 1420 Teon Rd., Hazelwood, MO 63042