

PHOTOMETRIC PLAN

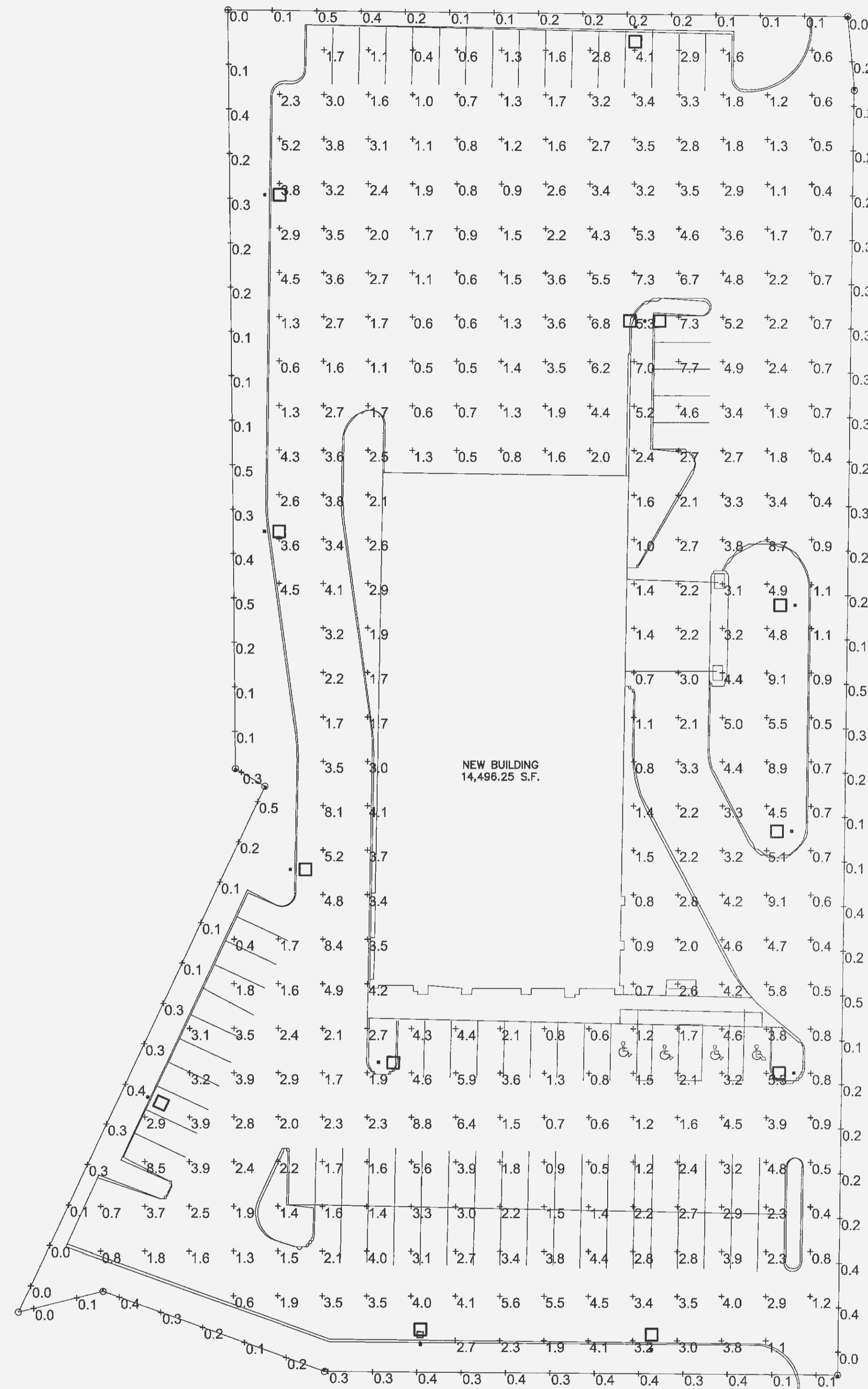

NEW BUILDING
14,496.25 S.F.

LUMINAIRE SCHEDULE								
Symbol	Label	Qty	Catalog Number	Description	Lamp	Lumens	LLF	Watts
□	F1a	1	AME-2-T3-400-P-6-BOA10-XX-LS	Visioaire American Series 400w Metal Halide Area Unit (Type 3 Distribution) w/ House Side Light Shield (20ft. Pole w/ 2.5ft. Base)	(1) - 400w MH Lamp	44000	0.78	452
□	F1b	9	AME-2-T3-400-P-6-BOA10-XX-LS-LS	Visioaire American Series 400w Metal Halide Area Unit (Type 3 Distribution) w/ House Side Light Shield & Internal Light Shield (20ft. Pole w/ 2.5ft. Base)	(1) - 400w MH Lamp	44000	0.78	452
□	F1c	1	AME-2-T4-400-P-6-BOA10-XX-LS	Visioaire American Series 400w Metal Halide Area Unit (Type 4 Distribution) w/ Internal Light Shield (20ft. Pole w/ 2.5ft. Base)	(1) - 400w MH Lamp	44000	0.78	0
□	F2	1	AME-2-T2-400-P-6-BOA10-XX	Visioaire American Series 400w Metal Halide Area Unit (Type 2 Distribution) (20ft. Pole w/ 2.5ft. Base)	(2) - 400w MH Lamp	44000	0.78	902.4

SCALE 1"=30'
OCTOBER 2013

MERS/GOODWILL

636-332-4574 (tel.)
636-337-0780 (fax)
wmm@cochran.com

North Office
8 East Main Street
Wentzville, Missouri 63385

COCHRAN

Civil Engineering
Land Surveying
Architecture
Site Development
Construction Management
Master Planning



DATE
Eric S. Kirchner No. E-2001004618
Registered Professional Engineer
State of Missouri
for Cochran

Developer / Owner Information:
K Properties Holdings LLC
1703 N. 4th St.
St. Charles, MO 63301
636-724-1617

City of O'Fallon Standard Sheet

P+Z No.
Approval Date: 01/03/2013
07/18/2013
City No. 18-12.02
18-12.02.01

Page No.

PI

REVISION DATE:
11-19-13 PER CITY COMMENTS