

STORM SEWER DRAINAGE AREA MAP

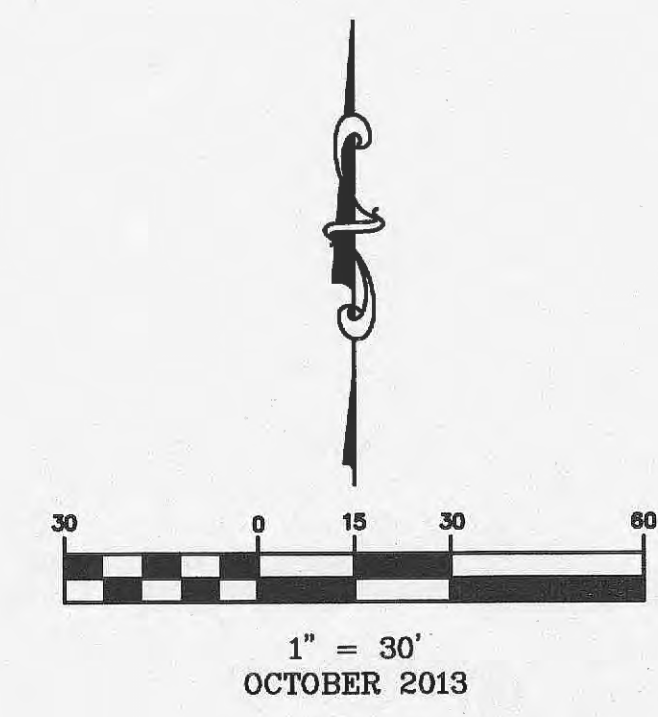
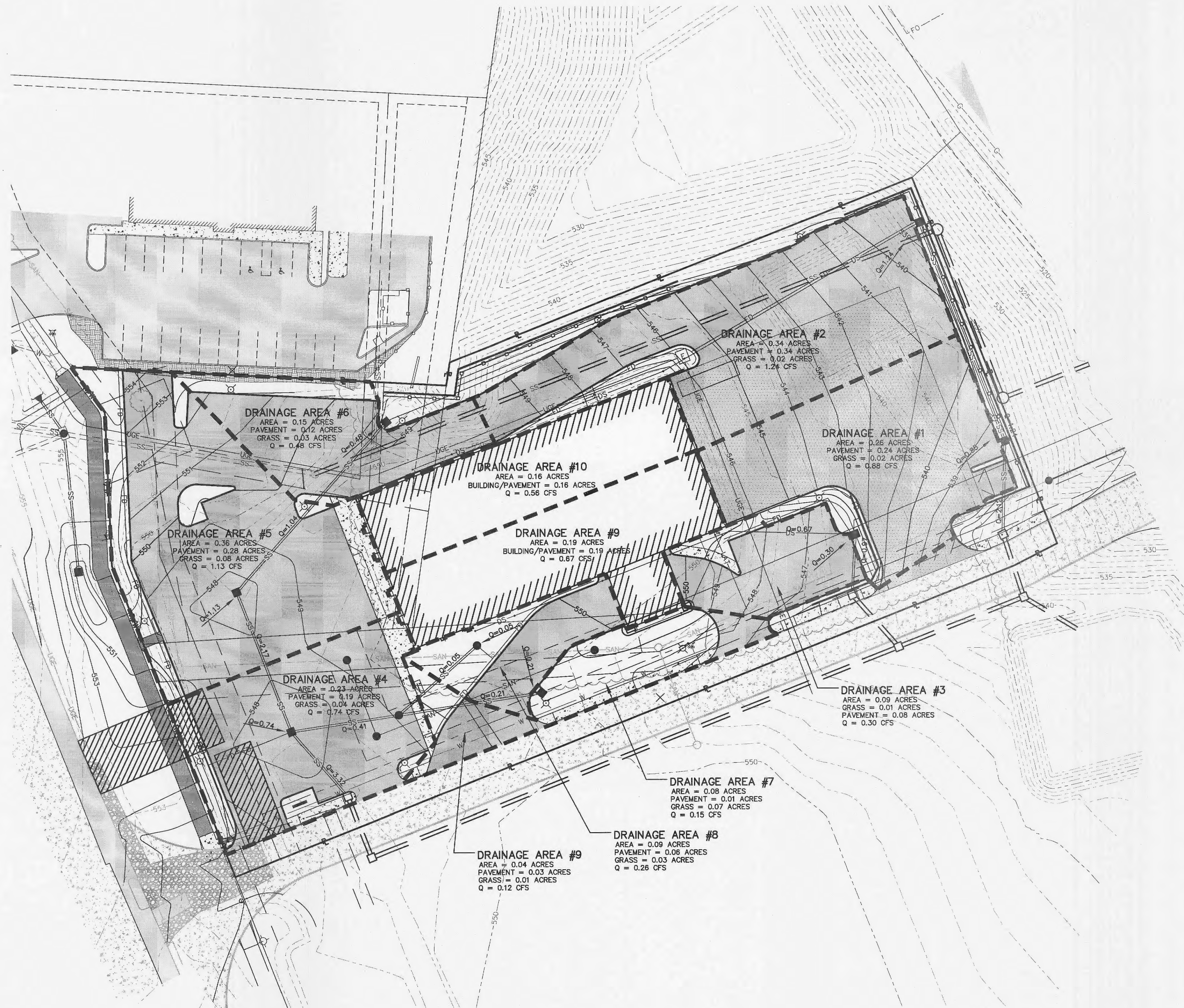

LEGEND	
PROPERTY LINE	---
RIGHT OF WAY	R/W
EXISTING SETBACK LINE	---
EXISTING EASEMENT	---
EXISTING CONTOUR	---
EXISTING CONTOUR IDX	XXX
NEW CONTOUR	---
NEW CONTOUR IDX	XXX
EXISTING STORM MANHOLE	○
EXISTING STORM LINE	SS
EXISTING SANITARY MAIN	SAN
EXISTING SANITARY MANHOLE	○
TREES	○
EXISTING ASPHALT PAVEMENT	▨
NEW ASPHALT PAVEMENT	▨
EXISTING CONCRETE	▨
NEW CONCRETE	▨
NEW DRAINAGE AREA	▨

MERS/GOODWILL

636-339-4574 (tel)
636-327-0765 (fax)
www.mersgoodwill.com

COCHRAN

North Office
1000 North Street
Wentzville, Missouri 63385

- Civil Engineering
- Land Surveying
- Architecture
- Site Development
- General Consulting
- Master Planning

ERIC SCOTT
KIRCHNER
E-2001004618

STATE OF MISSOURI
REGISTERED PROFESSIONAL ENGINEER

DATE
Eric S. Kirchner No. E-2001004618
Registered Professional Engineer
State of Missouri
for Cochran Engineering & Surveying

Developer / Owner Information:
Mers/Goodwill
1727 Locust St.
St. Louis, MO 63103
314-241-3464

City of O'Fallon Standard Sheet

P+Z No.
Approval Date: 01/03/2013
07/18/2013
City No. 18-12.02
18-12.02.01

Page No.
C7

REVISION DATE:
11-19-13 PER CITY COMMENTS