

GENERAL NOTES

- UNDERGROUND UTILITIES HAVE BEEN PLOTTED FROM AVAILABLE INFORMATION AND THEREFORE THEIR LOCATIONS SHALL BE CONSIDERED APPROXIMATE ONLY. THE VERIFICATION OF THE LOCATION OF ALL UNDERGROUND UTILITIES, EITHER SHOWN OR NOT SHOWN ON THESE PLANS SHALL BE THE RESPONSIBILITY OF THE CONTRACTOR, AND SHALL BE LOCATED PRIOR TO ANY GRADING OR CONSTRUCTION OF THE IMPROVEMENTS.
MISSOURI ONE CALL: 1-800-DIG-RITE (1-800-344-7483)
CITY OF O'FALLON: (636) 240-2000
MODOT: (314) 340-4100
- NO AREA SHALL BE CLEARED WITHOUT THE PERMISSION OF THE PROJECT ENGINEER.
- THE CITY OF O'FALLON SHALL BE NOTIFIED 48 HOURS PRIOR TO CONSTRUCTION FOR COORDINATION AND INSPECTION.
- ALL EXISTING SITE IMPROVEMENTS DISTURBED, DAMAGED OR DESTROYED SHALL BE REPAIRED OR REPLACED TO CLOSELY MATCH PRE-CONSTRUCTION CONDITIONS.
- ALL CONSTRUCTION AND MATERIALS SHALL CONFORM TO THE REQUIREMENTS OUTLINED IN THE "INFORMATION FOR BIDDERS AND SPECIFICATIONS".
- ALL DIMENSIONS ARE TO THE BACK OF CURB UNLESS OTHERWISE NOTED.
- ALL UTILITIES ARE EXISTING UNLESS OTHERWISE NOTED. ALL NEW UTILITIES SHALL BE LOCATED UNDERGROUND.
- ALL CONSTRUCTION METHODS AND PRACTICES SHALL CONFORM WITH OSHA STANDARDS.
- CONTRACTOR SHALL PROVIDE AND MAINTAIN EROSION CONTROL MEASURES AS REQUIRED BY THE ENGINEER. EROSION CONTROL SHALL CONSIST OF BUT NOT LIMITED TO STAKE STRAW BALES AND EROSION CONTROL FENCING.
- CONTRACTOR SHALL BE RESPONSIBLE FOR TRAFFIC CONTROL DURING CONSTRUCTION, INCLUDING ALL NECESSARY SIGNAGE FOR THE DETOUR PLAN. ACCESS TO ALL DRIVEWAYS AS APPROVED BY THE ENGINEER SHALL BE PROVIDED AT ALL TIMES.
- CONTRACTOR SHALL BE RESPONSIBLE FOR ALL ROADWAY MAINTENANCE DURING CONSTRUCTION.
- ALL VEGETATED AREAS DISTURBED DURING CONSTRUCTION SHALL BE SOODED, UNLESS OTHERWISE NOTED.
- DESIGN CRITERIA: POSTED SPEED: 35 MPH, DESIGN SPEED: 35 MPH (PRACTICAL DESIGN).
- ACCORDING TO THE FLOOD INSURANCE RATE MAP OF CITY OF O'FALLON AND ST. CHARLES COUNTY, MISSOURI (COMMUNITY PANEL NUMBER 2918300210G, DATED JAN. 20, 2016) THIS PROJECT IS LOCATED IN ZONE 'X', WHICH IS DEFINED AS AREA OF MINIMAL FLOOD HAZARD.
- ALL JOINTS AND JOINT LOCATIONS SHALL BE PER MODOT DETAILS C502.05M.
- MAILBOX REMOVAL, RELOCATION, NEW SUPPORTS (IF REQUIRED) AND ANY REPLACEMENT OF MAILBOXES DAMAGED BY THE CONTRACTOR SHALL BE CONSIDERED PART OF THE "REMOVE & RELOCATE MAIL BOX" PAY ITEM. NEW SUPPORTS SHALL MATCH AS CLOSE AS POSSIBLE THE EXISTING SUPPORTS. THE CONTRACTOR SHALL TEMPORARILY SET A MAILBOX WHERE IT IS ACCESSIBLE TO BOTH THE CARRIER AND THE PATRON DURING CONSTRUCTION. NEW MAILBOX LOCATION IS SHOWN ON THE STRIPING & SIGNAGE PLANS.
- ALL SIDEWALKS AND RAMPS SHALL BE CONSTRUCTED PER ADA REQUIREMENTS.
- ALL TRUNCATED DOMES AT NEW RAMP LOCATIONS MUST BE THE PRE-CAST STYLE. THE ADHERED-TYPE MAY BE USED IN RAISED ISLAND CUT-OUTS. NO CAST IN PLACE ARE ALLOWED.
- BRICK IS NOT ALLOWED IN THE CONSTRUCTION OF ANY INLETS.
- CONCRETE SEWER LIDS ARE NOT ALLOWED.
- GOVERNING STANDARD SPECIFICATIONS FOR THIS PROJECT:
STORM AND SANITARY SEWAGE FACILITIES: METROPOLITAN ST. LOUIS SEWER DISTRICT STANDARD CONSTRUCTION SPECIFICATIONS FOR SEWERS AND DRAINAGE FACILITIES, 2009 EDITION OR LATEST VERSION THEREOF.
ROADWAY CONSTRUCTION: DIVISIONS 200 THROUGH 1000 ST. LOUIS COUNTY TRANSPORTATION STANDARD SPECIFICATIONS FOR ROAD AND BRIDGE CONSTRUCTION OR LATEST VERSION THEREOF. SOME 100 DIVISIONS MAY BE ADOPTED, HOWEVER THE ENTIRE 100 DIVISION IS NOT ADAPTED AS A WHOLE.

GUTHRIE ROAD IMPROVEMENTS

CITY OF O'FALLON, MO

FINAL PLANS - CONSTRUCTION SET
MARCH 14, 2023

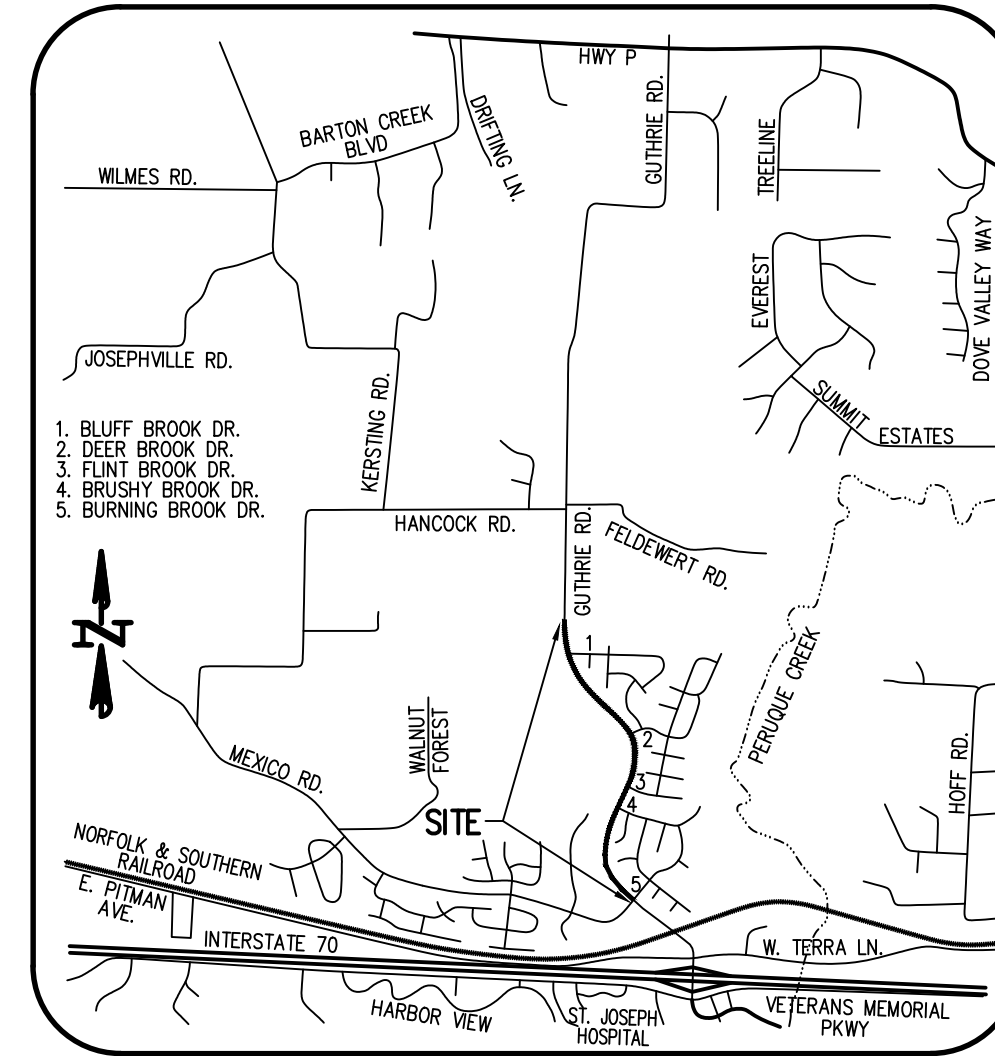

LOCATION MAP
NOT TO SCALE

BID # 23-011

CONTROL DATUM NOTES

THE HORIZONTAL COORDINATES WERE ESTABLISHED AND VERIFIED BY GPS OBSERVATIONS USING A CELLULAR EQUIPPED TRIMBLE R8 GNSS ROVER AND TRIMBLE TSC3 DATA COLLECTOR AND BASED ON THE MISSOURI HIGHWAYS AND TRANSPORTATION COMMISSION GLOBAL NAVIGATION SATELLITE REAL TIME NETWORK FOR CONTINUOUS OPERATING REFERENCE STATIONS, WHICH UTILIZES THE NAD83(2011) EPOCH 2010.00 GPS NETWORK.

THE OBSERVED HORIZONTAL CHECK STATION UTILIZED IS LISTED ON WWW.NGS.NOAA.GOV AS DESIGNATION "C-149" WITH A PID OF JC0544 AND A PUBLISHED VALUE OF N: 329907.953M, E: 226247.119M AND A CHECK VALUE OF N: 329907.967M, E: 226247.171M.

A SITE GRID AZIMUTH AND COMBINED GRID FACTOR WAS CALCULATED UTILIZING THE TRIMBLE TSC3 DATA COLLECTOR SURVEY CONTROLLER SOFTWARE ON FIELD CONTROL POINT #1.

PROJECT COORDINATES ARE MODIFIED "MISSOURI COORDINATE SYSTEM OF 1983, EAST ZONE" COORDINATES AND WERE GENERATED BY SCALING THE COORDINATES BY THE INVERSE OF SAID COMBINED GRID FACTOR (1.000738307) ABOUT ONSITE POINT #1. THE COORDINATES WERE THEN CONVERTED TO FEET BY MULTIPLYING THE METRIC VALUES BY 3.280833333 (39.37 INCHES PER METER / 12 INCHES PER FOOT).

THE GEOD UTILIZED TO OBTAIN PROJECT COORDINATES IS G12B9.

TO THE BEST OF OUR KNOWLEDGE, THE MODIFIED MISSOURI STATE PLANE, EAST ZONE, COORDINATES MEET THE ACCURACY STANDARDS OF THE CURRENT MISSOURI STANDARDS FOR PROPERTY BOUNDARY SURVEYS (2 CSR 90-60) AS AN URBAN CLASS SURVEY.

PROJECT ELEVATIONS UTILIZE THE NAVD 88 VERTICAL DATUM AND WERE GENERATED BY GPS OBSERVATIONS USING A CELLULAR EQUIPPED TRIMBLE R8 GNSS ROVER AND TRIMBLE TSC3 DATA COLLECTOR AND ARE BASED ON THE MISSOURI HIGHWAYS AND TRANSPORTATION COMMISSION GLOBAL NAVIGATION SATELLITE REAL TIME NETWORK FOR CONTINUOUS OPERATING REFERENCE STATIONS.

REFERENCE BENCHMARK: THE OBSERVED VERTICAL CHECK STATION UTILIZED IS LISTED ON WWW.NGS.NOAA.GOV AS DESIGNATION "C-149" WITH A PID OF JC0544 AND A PUBLISHED ELEVATION OF 545.45 (NAVD88) DESCRIBED BY COAST AND GEODETIC SURVEY 1935 AS FOLLOWS: 1.8 MILES EAST FROM GILMORE, 1.8 MILES EAST ALONG THE WABASH RAILROAD FROM THE STATION AT GILMORE, ST. CHARLES COUNTY, 80 FEET WEST OF A TOWNSHIP ROAD CROSSING, 48 FEET NORTH OF THE CENTERLINE OF THE TRACK, 12 FEET WEST OF THE RIGHT-OF-WAY FENCE CORNER, AND 2 FEET SOUTH OF THE RIGHT-OF-WAY FENCE. A STANDARD DISK, STAMPED C 149 1935, AND SET IN THE TOP OF A CONCRETE POST PROJECTING 6 INCHES ABOVE GROUND.



Mark E. Collins
Surveyor
MO PLS 200600173

APPROVED FOR CONSTRUCTION
Wade Monty
CITY ENGINEER
CITY OF O'FALLON, MO
DATE: 3-14-23

INDEX OF SHEETS

SHEET NO.	DESCRIPTION
1	COVER SHEET
2	SUMMARY & DETAILS
3	TYPICAL SECTIONS
4-9	PLAN & PROFILE
10-30	CROSS SECTIONS
31-32	STORM SEWER PROFILES
33	WALL & STREET PROFILES
34-35	WARPING DETAILS
36	CONSTRUCTION DETAILS
37-39	REFERENCE DETAILS
40-42	STRIPING & SIGNAGE PLAN
43-44	SILTATION CONTROL PLAN
45	DETOUR PLAN
46-49	RIGHT OF WAY PLAN

LEGEND

SCI	SINGLE CURB INLET
DCI	DOUBLE CURB INLET
AI	AREA INLET
MH	MANHOLE
FE	FLARED END SECTION
EP	END PIPE
CP	CONCRETE PIPE
RCP	REINFORCED CONCRETE PIPE
CMP	CORRUGATED METAL PIPE
CPP	CORRUGATED PLASTIC PIPE
PVC	POLY VINYL CHLORIDE (PLASTIC)
CO	CLEAN OUT
TBR	TO BE REMOVED
TBR&R	TO BE REMOVED AND REPLACED
TBR&REL	TO BE REMOVED AND RELOCATED
UIP	USE IN PLACE
BO	BY OTHERS
TCE	TEMPORARY CONSTRUCTION EASEMENT
PDE	PERMANENT DRAINAGE EASEMENT
.....	SLOPE LIMITS
—	DRAINAGE SWALE
—	STORM SEWER

SITE BENCHMARKS:

- SITE BENCHMARK #1
CROSS IN CONC. WALK AT STATION 33+04.93(31.43'-RT.)
ELEV.=491.98
N. 1084830.8737, E. 741988.2763
- SITE BENCHMARK #2
"O" IN OPEN ON FIRE HYDRANT LOCATED AT INTERSECTION OF BLUFF BROOK DRIVE AND BLUFF BROOK COURT
ELEV.=578.82
- SITE BENCHMARK #3
CROSS IN CURB AT EAST FRONT CORNER OF 801 BLUFF BROOK DRIVE
ELEV.=570.34
N. 1087116.9280, E. 741083.9244

UTILITIES:

- TELEPHONE: CENTURYTEL TELEPHONE OPERATIONS
1151 CENTURYTEL DRIVE
WENTZVILLE, MO 63385
(636) 332-7318
- GAS: SPIRE
3950 FOREST PARK
ST. LOUIS, MO 63108
(314) 658-5418
- SEWER: CITY OF O'FALLON
100 N. MAIN STREET
O'FALLON, MO 63366
(636) 240-2000
- WATER: CITY OF O'FALLON
100 N. MAIN STREET
O'FALLON, MO 63366
(636) 240-2000
- CABLE: CHARTER COMMUNICATIONS
4160 OLD MILL PARKWAY
ST. PETERS, MO 63376
(636) 441-7737

DESIGN CRITERIA

GUTHRIE ROAD

DESIGN DESIGNATION: COLLECTOR
POSTED SPEED LIMIT: 35 mph
DESIGN SPEED: 35 mph (Practical Design)
CREST MINIMUM "K": 55
SAG MINIMUM "K": 50
MINIMUM CENTERLINE RADIUS: 540'
MAXIMUM SUPERELEVATION: 4%
MAXIMUM STREET GRADE: 8% (per City of O'Fallon requirements)
MINIMUM STREET GRADE: 2% (per City of O'Fallon requirements)



CALL BEFORE YOU DIG!
1-800-DIG-RITE
*FIBER OPTICS MAY BE PRESENT

BAX ENGINEERING CO., INC.
221 Point West Blvd.
St. Charles, MO 63301
Phone: 636-928-5552
Fax: 636-928-1718

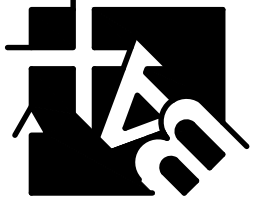

Missouri State Certificate of Authority, Engineering #089845
Missouri State Certificate of Authority, Surveying #000144

PROJECT NAME:
GUTHRIE ROAD IMPROVEMENTS
BURNING BROOK DR. TO BLUFF BROOK DR.
O'FALLON, ST. CHARLES COUNTY, MO, 63366

PREPARED FOR:
CITY OF O'FALLON
100 N. MAIN STREET
O'FALLON, MO, 63366
636-240-2000

REVISIONS

DATE	DESCRIPTION
01/03/20	REVISED PER CITY COMMENTS
03/06/20	PRELIMINARY PLAN SUBMITTAL
01/12/23	PRELIMINARY PLAN SUBMITTAL
01/24/23	FINAL PLAN SUBMITTAL
01/28/23	FINAL PLANS - BID SET
03/14/23	ADDENDUM 1 / CLARIFICATION

DISCLAIMER OF RESPONSIBILITY
I hereby disclaim any responsibility for all other drawings, specifications, estimates, reports or other documents or instruments relating to or intended to be used for any part or parts of the architectural or engineering project or survey other than those authenticated by my seal.

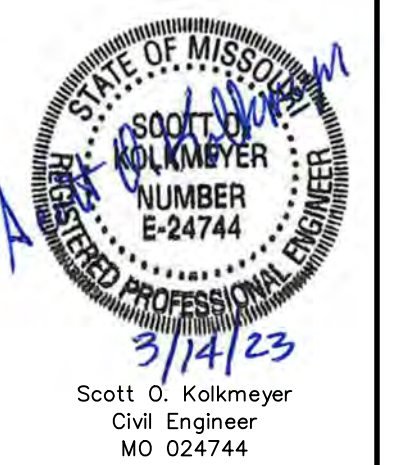

COVER SHEET

SHEET
1 OF 49