

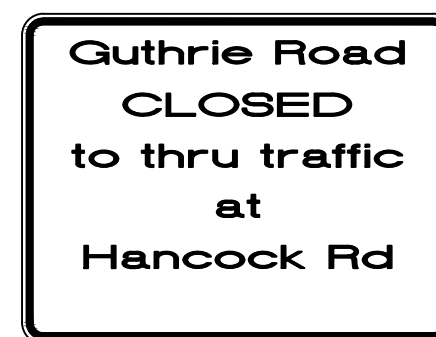

SP-1 (54x48)  
ORANGE BACKGROUND  
W/BLACK LETTERS

1



SP-1 (54x48)  
ORANGE BACKGROUND  
W/BLACK LETTERS

1a



M04-9L (36x30)

2



SP-3L (36x36)

2a



R11-2 (48x30)

3\*



R11-3a (60x30) & M4-10L (48x18)

4

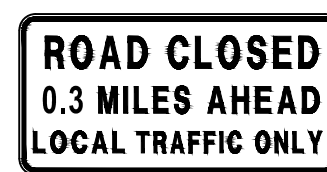

R11-3a (60x30) & M4-10R (48x18)

4a



M04-9R (36x30)

5



SP-4R (36x36)

5a



SP-2 (36x36)

6

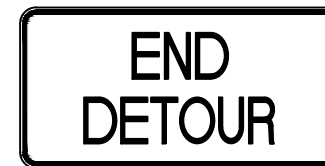

M4-8a (24x18)

7

NOT TO SCALE

NOTE:  
1. CONTRACTOR TO PROVIDE ACCESS TO LOCAL RESIDENTS AT ALL TIMES.

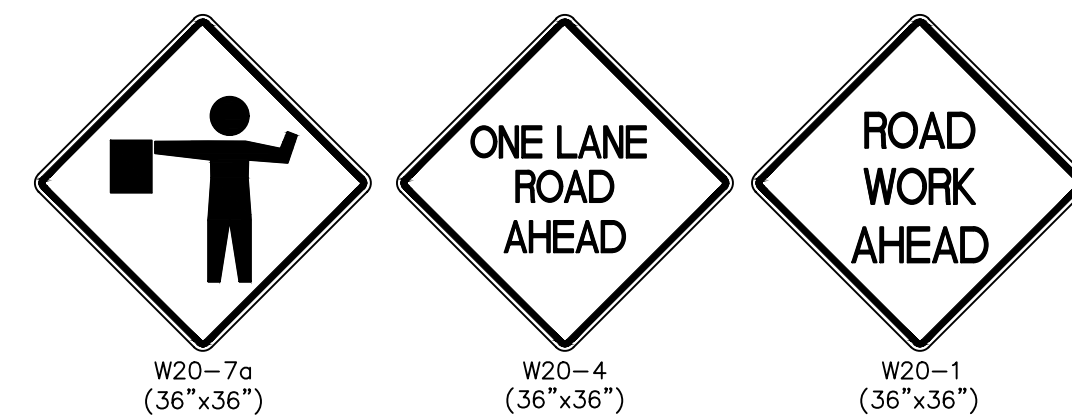
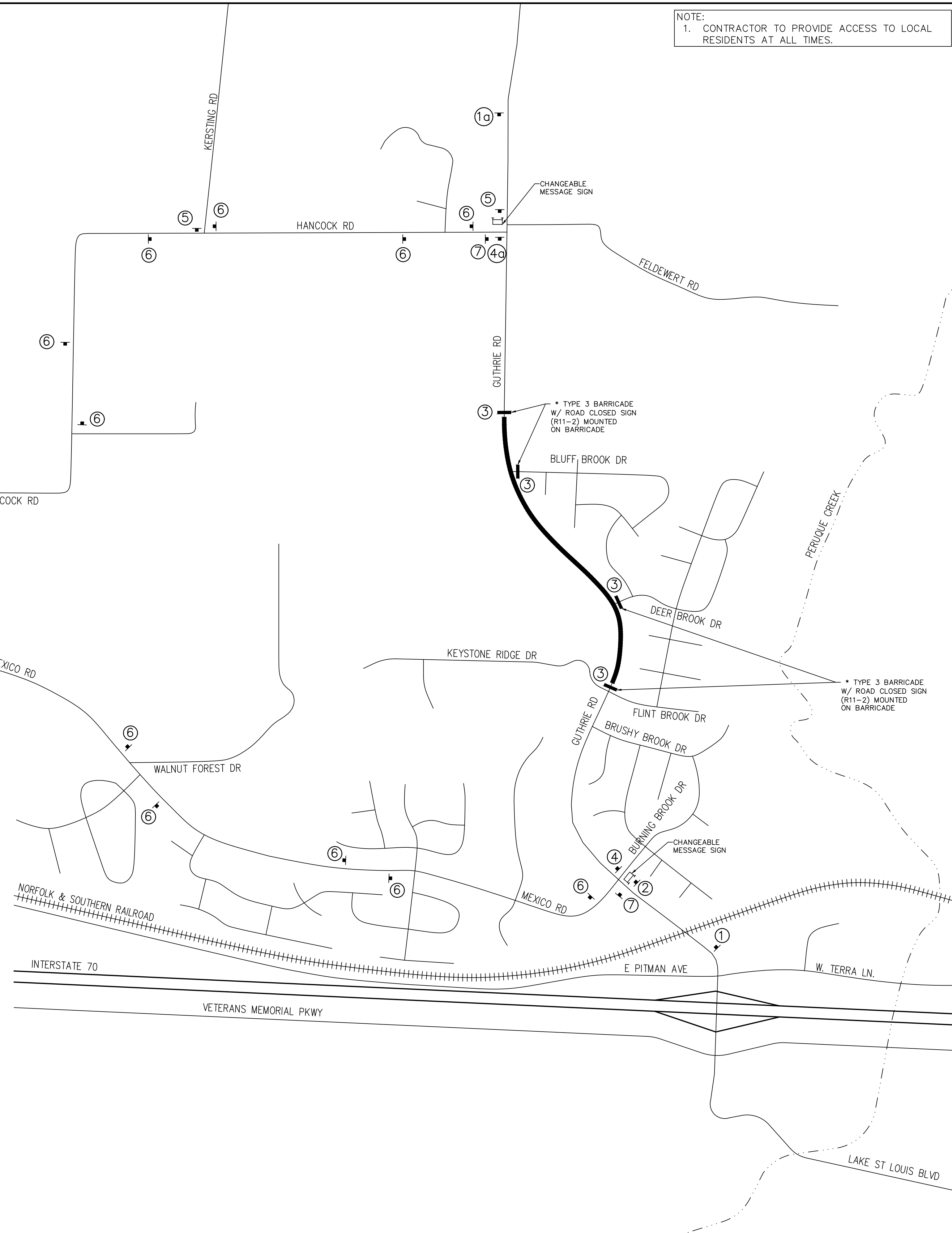

CONSTRUCTION SIGNAGE  
ALL CONSTRUCTION SIGN SHALL BE ORANGE

FLAGGER W20-7a W20-4 W20-1

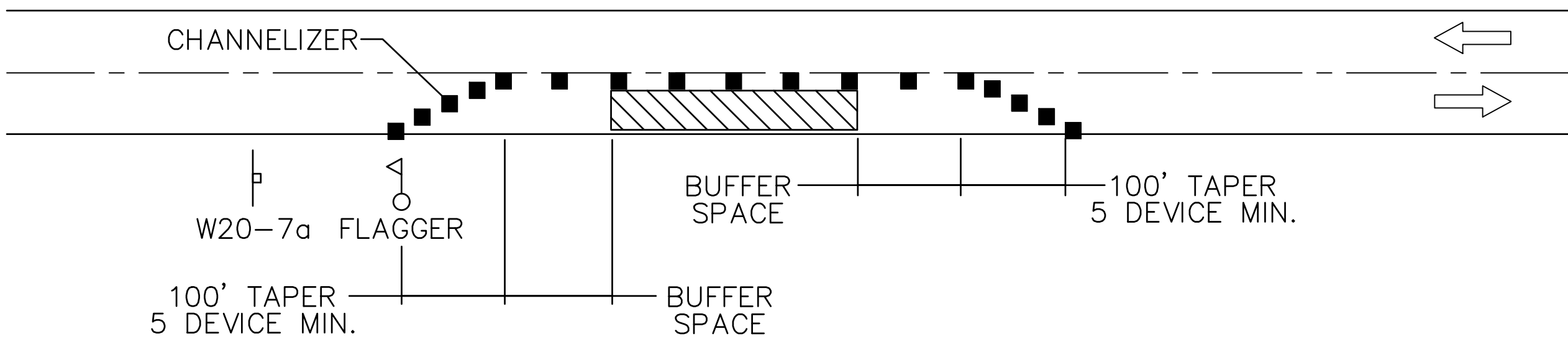

FLAGGER CONTROL FOR STATIONARY OPERATION  
ONE-LANE TWO-WAY OPERATION  
ALL OPERATIONS TO CONFORM TO CURRENT M.U.T.C.D.

BAX ENGINEERING CO., INC.  
221 Point West Blvd.  
St. Charles, MO 63301  
Phone: 636-928-5552  
Fax: 636-928-1718



GUTHRIE ROAD IMPROVEMENTS  
BURNING BROOK DR. TO BLUFF BROOK DR.  
O'FALLON, ST. CHARLES COUNTY, MO, 63366

PREPARED FOR:  
CITY OF O'FALLON  
100 N. MAIN STREET  
O'FALLON, MO, 63366  
636-240-2000

REVISIONS	
DATE	DESCRIPTION
01/03/20	REVISED PER CITY COMMENTS
03/06/20	PRELIMINARY PLAN SUBMITTAL
11/21/22	PRE-FINAL PLAN SUBMITTAL
01/20/23	FINAL PLAN SUBMITTAL
01/26/23	FINAL PLANS - BID SET

DISCLAIMER OF RESPONSIBILITY  
I hereby disclaim any responsibility for all other drawings, specifications, estimates, reports or other documents or instruments relating to or intended to be used for any part or parts of the architectural or engineering project or survey other than those authenticated by my seal.



DETOUR PLAN  
SHEET  
45 OF 49