

SUMMARY OF QUANTITIES						
SHEET NUMBER	43	44	TOTAL	UNITS	ITEM	SILTATION CONTROL ITEMS
696	1,376	2,072	L.F.	62	SILT FENCE	
27	13	40	EA.	63	DITCH CHECK	
1	12	13	EA.	64	DITCH CHECK WITH SEDIMENT TRAP	
46	83	129	L.F.	65	CURB INLET PROTECTION	
4	2	6	EA.	66	AREA INLET PROTECTION	

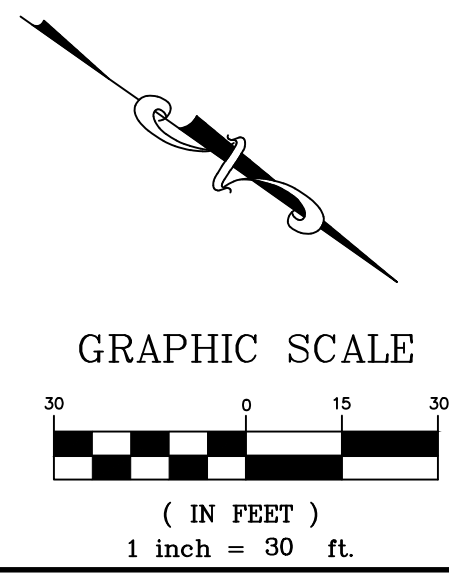
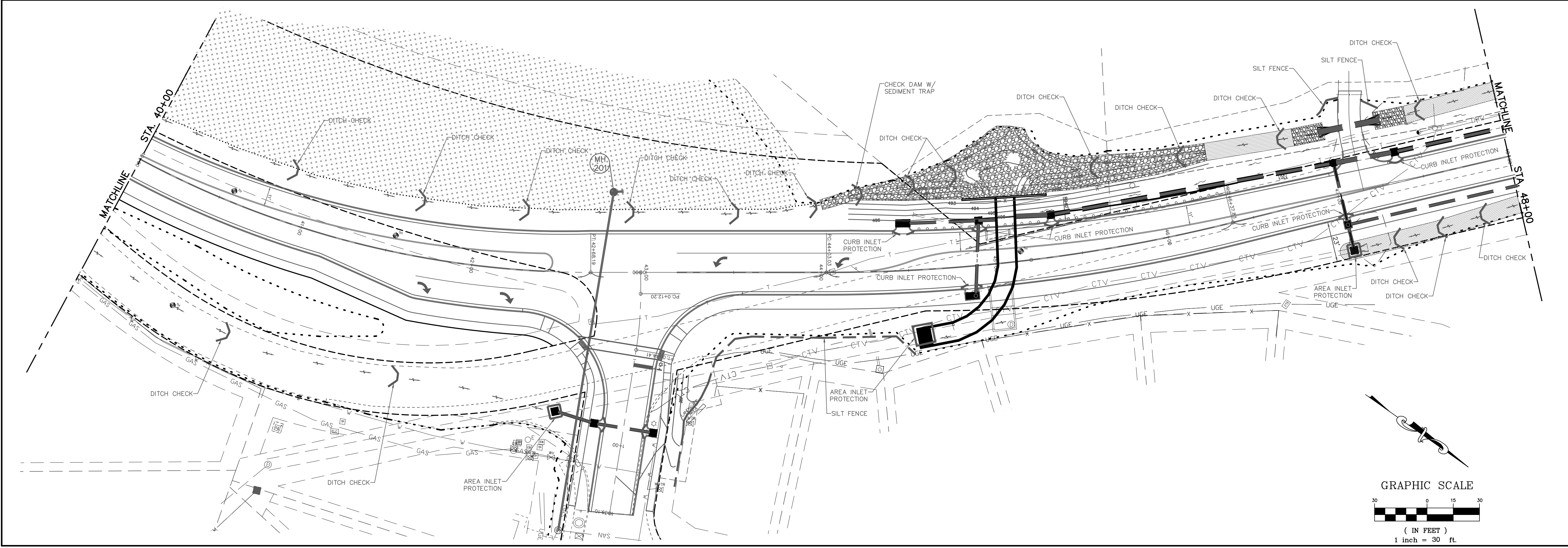
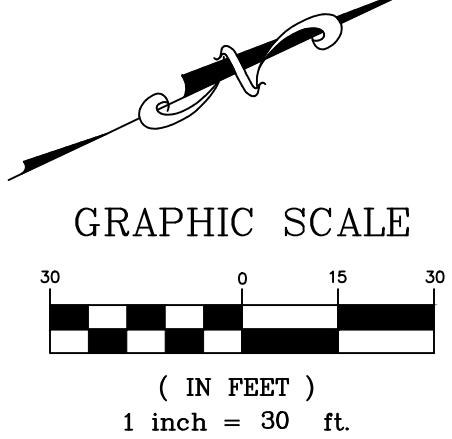

**BAX ENGINEERING CO., INC.**  
 221 Point West Blvd.  
 St. Charles, MO 63301  
 Phone: 636-928-5552  
 Fax: 636-928-1718

**GUTHRIE ROAD IMPROVEMENTS**  
 BURNING BROOK DR. TO BLUFF BROOK DR.  
 O'FALLON, ST. CHARLES COUNTY, MO, 63366

**CITY OF O'FALLON**  
 100 N. MAIN STREET  
 O'FALLON, MO, 63366  
 636-240-2000

REVISIONS

DATE	DESCRIPTION
01/03/20	REVISED PER CITY COMMENTS
03/06/20	PRELIMINARY PLAN SUBMITTAL
11/21/22	PRE-FINAL PLAN SUBMITTAL
01/20/23	FINAL PLAN SUBMITTAL
01/26/23	FINAL PLANS - BID SET

DISCLAIMER OF RESPONSIBILITY  
 I hereby disclaim any responsibility for all other drawings, specifications, estimates, reports or other documents or instruments relating to or intended to be used for any part or parts of the architectural or engineering project or survey other than those authenticated by my seal.

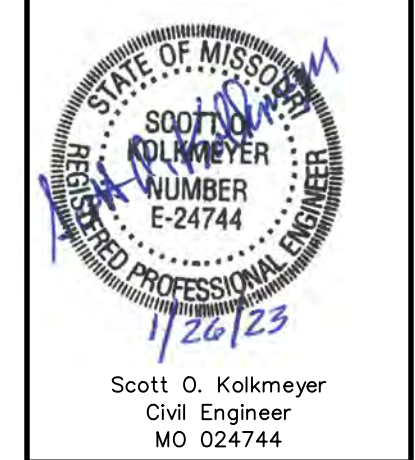

**SILTATION CONTROL PLAN**  
 SHEET  
 43 OF 49

PROJECT NO.: 19-17665 DATE: 12/28/2021