

**UTILITY NOTE:**  
 UNDERGROUND FACILITY STRUCTURES AND UTILITIES HAVE BEEN PLOTTED FROM AVAILABLE SURVEYS AND RECORDED INFORMATION AND, THEREFORE, THEIR LOCATIONS MUST BE CONSIDERED APPROXIMATE ONLY. VERIFICATION OF LOCATION OF ALL UNDERGROUND STRUCTURES AND FACILITIES EITHER SHOWN OR NOT SHOWN ON THESE PLANS, SHALL BE THE RESPONSIBILITY OF THE CONTRACTOR.

**TREE PRESERVATION (ENTIRE SITE)**

Existing trees = 17.50 Acres  
 Trees Removed = 6.01 Acres = 34% of trees removed  
 Per Ordinance, no trees need to be replaced.

**STREET TREES (ENTIRE SITE)**

1 tree shall be provided for every lot street frontage.  
 (corner lots shall require 2 trees, etc.)

230 lots	= 230 trees
25 corner lots	= 25 additional trees
46 lots fronting 2 streets	= 46 additional trees
4 lots fronting 3 streets	= 8 additional trees
<b>Total trees required</b>	<b>= 284 trees</b>

**NOTES:**

- STREET TREES SHALL NOT BE PLANTED CLOSER THAN 3 FEET TO ANY CURB.
- STREET TREES SHALL NOT BE PLACED WITHIN TWENTY-FIVE (25) FEET OF STREET LIGHTS.
- AT STREET INTERSECTIONS, NO STREET TREES SHALL BE PLACED WITHIN THE SIGHT TRIANGLE.
- STREET TREES SHALL NOT BE PLANTED WITHIN TEN (10) FEET OF STREET INLETS, MANHOLES, OR FIRE HYDRANTS.
- AFTER NORMAL WARRANTY PERIODS, TREES SHALL BE MAINTAINED IN GOOD CONDITION BY THE CORRESPONDING HOMEOWNERS ASSOCIATION AS PART OF THE COVENANTS AND RESTRICTIONS OF THE SUBDIVISION. SAID RESTRICTIONS SHALL INCLUDE LANGUAGE APPROVED BY THE CITY TO ALLOW THE CITY TO REMOVE TREES SHOULD PUBLIC SAFETY BE THREATENED.
- STREET TREES MUST BE PLANTED WITHIN ONE (1) YEAR OF ISSUANCE OF THE FINAL OCCUPANCY PERMIT.
- TREES SHALL BE AT LEAST TWO (2) INCHES IN CALIPER AND SHALL BE FROM THE FOLLOWING APPROVED SPECIES:

**Approved Large Trees (Over 70 ft):**

Blackgum	Kentucky Coffeetree	Shumard Oak
Black Oak	Northern Red Oak	Sycamore
Black Walnut	Pecan	Tulip Poplar
Bur Oak	Pin Oak	White Ash
Maple	Scarlet Oak	White Oak
Hackberry	Willow Oak	Swamp White Oak
	Red Oak	

**Approved Trees Medium/Small Trees (Less Than 70 ft.):**

Green Ash	Persimmon	River Birch
Red Mulberry	Eastern Redbud	Flowering Dogwood
Amber Maple	Wild Plum	Purple Leaf Plum

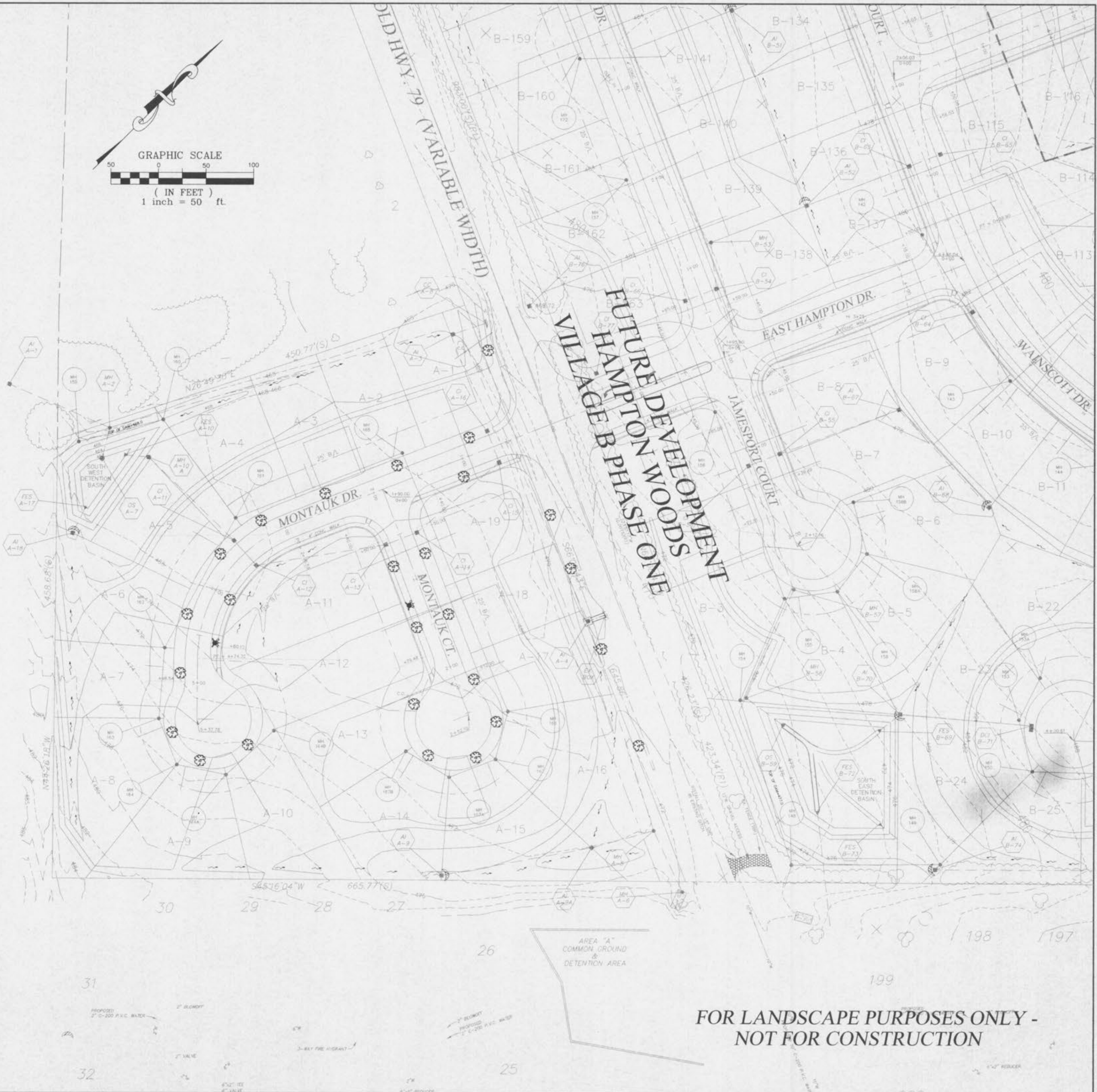
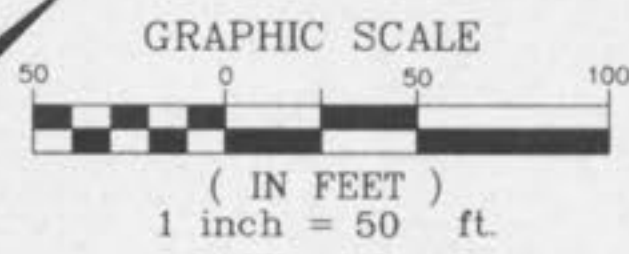

**FOR LANDSCAPE PURPOSES ONLY - NOT FOR CONSTRUCTION**

**PICKETT RAY & SILVER**

333 Mid Rivers Mall Drive  
 St. Peters, MO 63376  
 Phone (636) 397-1211  
 Fax (636) 397-1104

**CIVIL ENGINEERS  
 PLANNERS  
 LAND SURVEYORS**

**HAMPTON WOODS  
 VILLAGE A  
 LANDSCAPE PLAN**

219 FOX HILL ROAD  
 ST. CHARLES, MO 63301  
 636-940-9100

Prepared For:  
**SUMMIT POINTE L.C.**

REVISIONS	NO.	DATE	REV. PER. CITY OF O'FALLON
	1	07-31-02	REV. PER. CITY OF O'FALLON
	2	08-16-02	REV. PER. CITY OF O'FALLON
	3	08-26-02	REV. PER. CITY OF O'FALLON

**ENGINEERS AUTHENTICATION**  
 The responsibility for professional engineering liability on this project is hereby limited to the set of plans authenticated by the seal, signature, and date hereunder attached. Responsibility is disclaimed for all other engineering plans involved in this project and specifically excludes revisions after this date unless re-authorized.

PICKETT, RAY & SILVER, INC.



DRAWN ABK	DATE 05-02-02
CHECKED D.W.D.	DATE 05-02-02
PROJECT # 95067.SUPO.00R	
TASK # 4 FIELD BOOK 806	

HAMPTON WOODS  
 VILLAGE A  
 LANDSCAPE PLAN  
 SHEET 10 OF 19

© Copyright 2002 by Pickett, Ray & Silver Inc.