

UTILITY NOTE:
 UNDERGROUND FACILITY STRUCTURES AND UTILITIES HAVE BEEN PLOTTED FROM AVAILABLE SURVEYS AND RECORDED INFORMATION AND THEREFORE, THEIR LOCATIONS MUST BE CONSIDERED APPROXIMATE ONLY. VERIFICATION OF LOCATION OF ALL UNDERGROUND STRUCTURES AND FACILITIES EITHER SHOWN OR NOT SHOWN ON THESE PLANS, SHALL BE THE RESPONSIBILITY OF THE CONTRACTOR.

$\Delta = 59^{\circ}10'23''$
 $R = 770.00'$
 $L = 795.23'(S)$
 $CB = N33^{\circ}16'35''E$
 $CD = 760.36'$

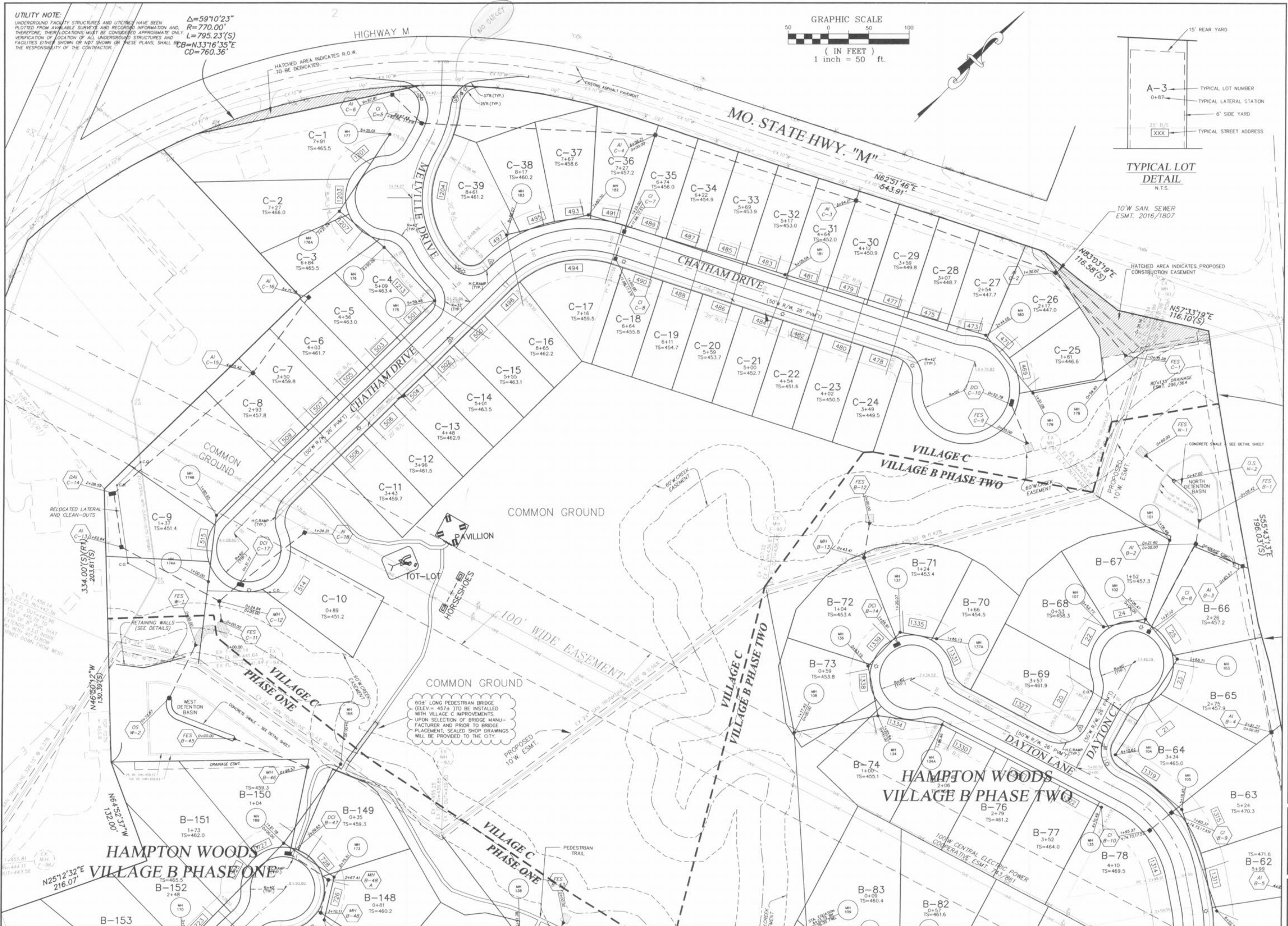
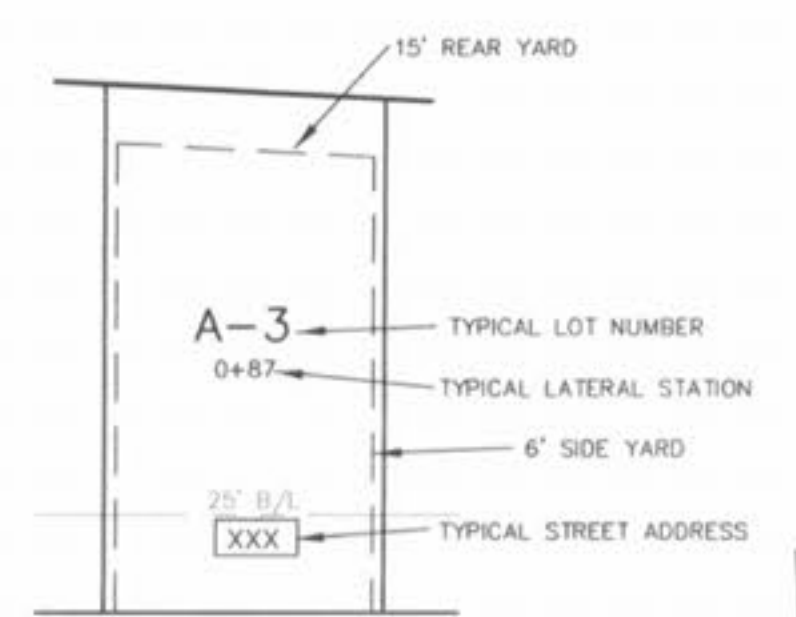
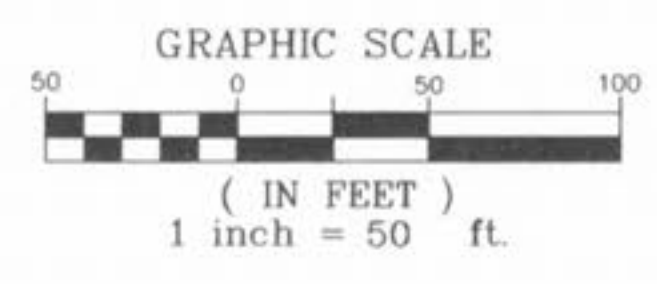

TYPICAL LOT DETAIL
N.T.S.

10' W. SAN. SEWER ESMT. 2016/1807

HATCHED AREA INDICATES PROPOSED CONSTRUCTION EASEMENT

PICKETT RAY & SILVER

CIVIL ENGINEERS
 PLANNERS
 LAND SURVEYORS

333 Mt. Rivers Mail Drive
 St. Peters, MO 63376
 Phone (636) 397-1211
 Fax (636) 397-1104

HAMPTON WOODS VILLAGE C SITE PLAN

Prepared For:
SUMMIT POINTE L.C.

219 FOX HILL ROAD
 ST. CHARLES, MO 63301
 636-465-9300

NO.	DATE	REV.	PER	REVISIONS
1	09-28-02	REV.	PER	CLIENT
2	11-15-02	REV.	PER	CITY OF FALLON
3	12-20-02	REV.	PER	CITY OF FALLON
4	02-24-03	REV.	PER	MODOT

ENGINEERS AUTHENTICATION
 The responsibility for professional engineering liability on this project is hereby limited to the set of plans authenticated by the seal, signature, and date hereunder attached. Responsibility is disclaimed for all other engineering plans involved in this project and specifically excludes revisions after this date unless reauthenticating.

PICKETT, RAY & SILVER, INC.

STATE OF MISSOURI
 J. BRANCH
 NUMBER 17751
 PROFESSIONAL ENGINEER

DRAWN	ABK	DATE	10-23-02
CHECKED	D.W.D.	DATE	10-23-02
PROJECT	# 95067.SUP0.00R		
TASK #	4	FIELD BOOK	806