

UTILITY NOTE:  
 UNDERGROUND FACILITY STRUCTURES AND UTILITIES HAVE BEEN PLOTTED FROM AVAILABLE SURVEYS AND RECORDED INFORMATION AND, THEREFORE, THEIR LOCATIONS MUST BE CONSIDERED APPROXIMATE ONLY. VERIFICATION OF LOCATION OF ALL UNDERGROUND STRUCTURES AND FACILITIES (EITHER SHOWN OR NOT SHOWN ON THESE PLANS) SHALL BE THE RESPONSIBILITY OF THE CONTRACTOR.

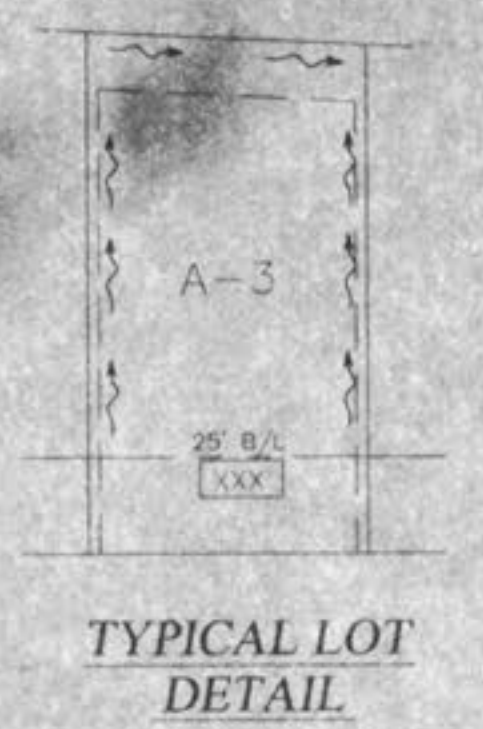
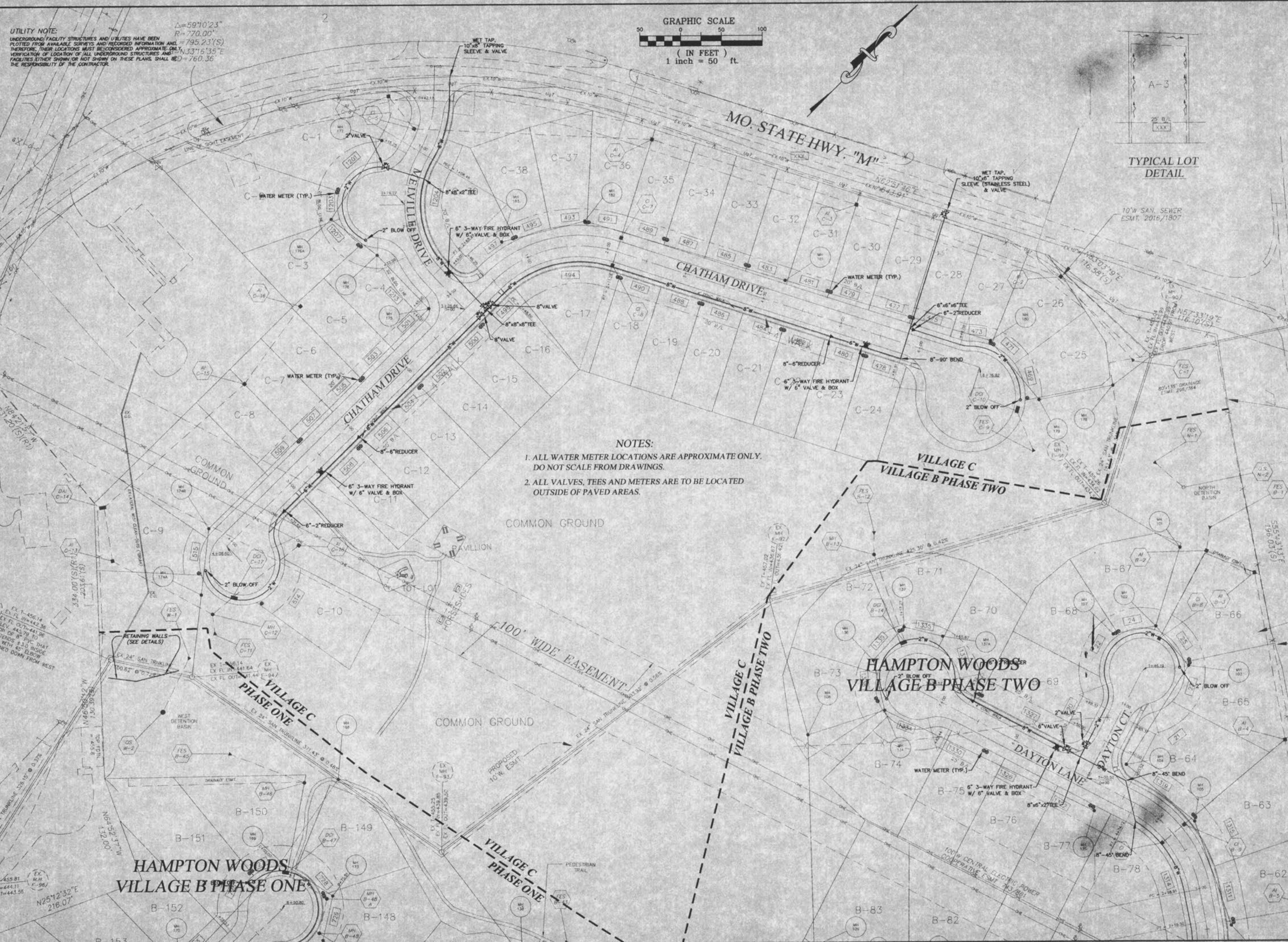
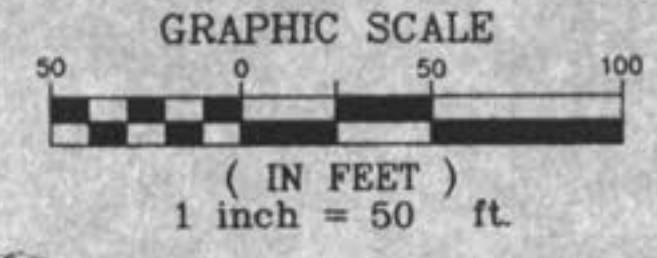

- NOTES:
1. ALL WATER METER LOCATIONS ARE APPROXIMATE ONLY. DO NOT SCALE FROM DRAWINGS.
  2. ALL VALVES, TEES AND METERS ARE TO BE LOCATED OUTSIDE OF PAVED AREAS.

**PICKETT RAY & SILVER**  
 CIVIL ENGINEERS  
 PLANNERS  
 LAND SURVEYORS

333 Mid Rivers Mall Drive  
 St. Peters, MO 63376  
 Phone (636) 387-1211  
 Fax (636) 387-1104

**HAMPTON WOODS**  
 VILLAGE C  
 WATER LAYOUT

Prepared For:  
**SUMMIT POINTE L.C.**

239 FOX HILL ROAD  
 ST. CHARLES, MO 63001  
 636-480-9200

NO.	DATE	REV.	PER CLIENT	REV. PER CITY OF O'FALLON
1	09-28-02	REV.		
2	11-15-02	REV.		

**ENGINEERS AUTHENTICATION**  
 The responsibility for professional engineering liability on this project is hereby limited to the set of plans authenticated by the seal, signature, and date hereunder attached. Responsibility is disclaimed for all other engineering plans involved in this project and specifically excludes revisions after this date unless reauthenticated.

PICKETT RAY & SILVER, INC.  
 STATE OF MISSOURI  
 HAROLD J. BARTCH  
 LICENSE NO. 51751

DRAWN	ABK	DATE	10-23-02
CHECKED	D.W.D.	DATE	10-23-02
PROJECT #	95067.SUPD.00R	TASK #	4
		FIELD BOOK	806