

ISSUE	REMARKS/DATE
1	2023-09-28, INITIAL SUBMITTAL
2	2024-02-04, CITY COMMENTS
3	2024-04-17, CITY COMMENTS
4	2024-05-20, FOR APPROVAL

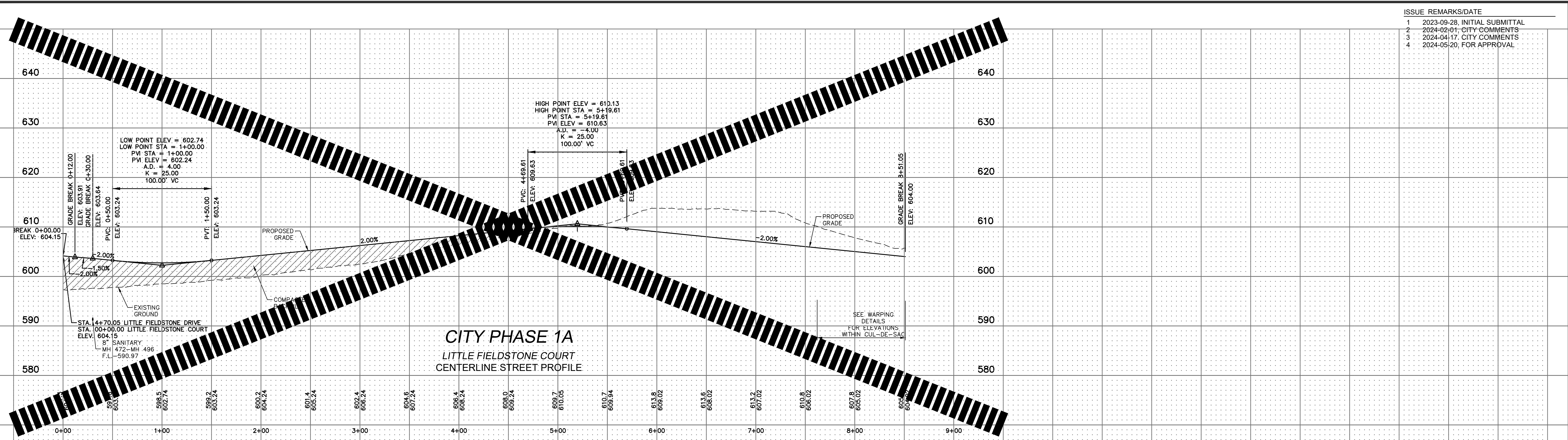

CITY PHASE 1A
LITTLE FIELDSTONE COURT
CENTERLINE STREET PROFILE

BACKFILL NOTE:
ALL SANITARY MAINS AND/OR LATERALS THAT CROSS THE PAVEMENT, LIE WITHIN TEN (10) FEET OF THE EDGE OF PAVEMENT OR WITHIN THE 1:1 SHEAR PLANE OF THE STREET MUST HAVE PROPER ROCK BACKFILL AND REQUIRED COMPACTION.

1"=10'
SCALE
1"=50'

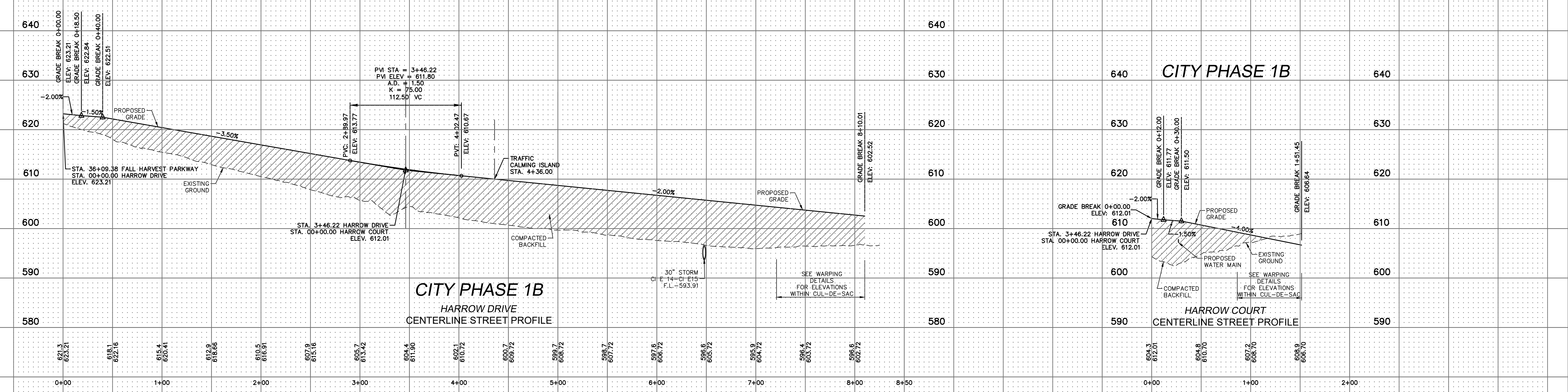

CITY PHASE 1B
HARROW DRIVE
CENTERLINE STREET PROFILE

CITY PHASE 1B

HARROW COURT
CENTERLINE STREET PROFILE

PROJECT TITLE
HARVEST AT HOPEWELL
O'FALLON PHASE 1B

THE **STERLING** CO.
ENGINEERS & SURVEYORS
5055 New Baumgartner Road
St. Louis, Missouri 63129
Ph 314-487-0440 Fax 314-487-8944
www.sterling-eng-sur.com
Corporate Certificate of Authority #001348

Date: 05-20-2024
Michael G. Boering, PE
License No. MO E-28643
Professional Engineer

HARVEST HOPEWELL, LLC
5091 New Baumgartner Road
St. Louis, Missouri 63129

P+Z No. 21-004994
City No. 21-011444
Date: 05-20-2024
Job No. 20-09-327

Page No.
5.8

Drawing name: V:\2009327 Highway N Assembly\Drawings\Engineering\Improvements\327 IMP FG.dwg. Printed on: May 20, 2024 - 11:05am. Plotted by: jacobhaus