

Drawing name: V:\2009327 Highway N Assembly\Drawings\Improvements\327 IMP Sanitary.dwg Plotted on: May 20, 2024 10:46am Plotted by: jacobmehaus

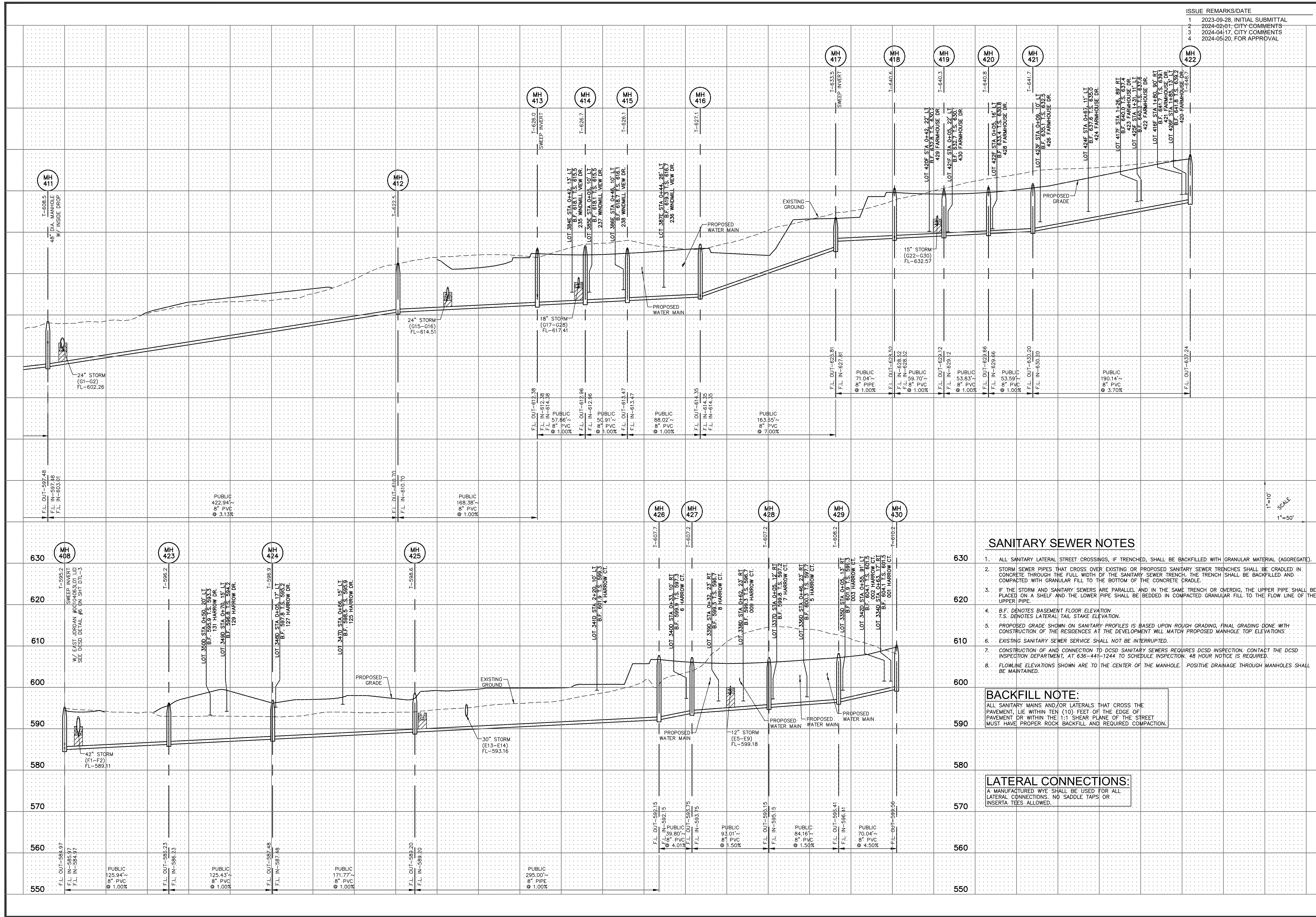

ISSUE	REMARKS/DATE
1	2023-09-28, INITIAL SUBMITTAL
2	2024-02-04, CITY COMMENTS
3	2024-04-17, CITY COMMENTS
4	2024-05-20, FOR APPROVAL

**SANITARY SEWER NOTES**

- ALL SANITARY LATERAL STREET CROSSINGS, IF TRENCHED, SHALL BE BACKFILLED WITH GRANULAR MATERIAL (AGGREGATE).
- STORM SEWER PIPES THAT CROSS OVER EXISTING OR PROPOSED SANITARY SEWER TRENCHES SHALL BE CRADLED IN CONCRETE THROUGH THE FULL WIDTH OF THE SANITARY SEWER TRENCH. THE TRENCH SHALL BE BACKFILLED AND COMPACTED WITH GRANULAR FILL TO THE BOTTOM OF THE CONCRETE CRADLE.
- IF THE STORM AND SANITARY SEWERS ARE PARALLEL AND IN THE SAME TRENCH OR OVERDIG, THE UPPER PIPE SHALL BE PLACED ON A SHELF AND THE LOWER PIPE SHALL BE BEDDED IN COMPACTED GRANULAR FILL TO THE FLOW LINE OF THE UPPER PIPE.
- B.F. DENOTES BASEMENT FLOOR ELEVATION.  
T.S. DENOTES LATERAL TAIL STAKE ELEVATION.
- PROPOSED GRADE SHOWN ON SANITARY PROFILES IS BASED UPON ROUGH GRADING, FINAL GRADING DONE WITH CONSTRUCTION OF THE RESIDENCES AT THE DEVELOPMENT WILL MATCH PROPOSED MANHOLE TOP ELEVATIONS.
- EXISTING SANITARY SEWER SERVICE SHALL NOT BE INTERRUPTED.
- CONSTRUCTION OF AND CONNECTION TO DCSD SANITARY SEWERS REQUIRES DCSD INSPECTION. CONTACT THE DCSD INSPECTION DEPARTMENT, AT 636-441-1244, TO SCHEDULE INSPECTION. 48 HOUR NOTICE IS REQUIRED.
- FLOWLINE ELEVATIONS SHOWN ARE TO THE CENTER OF THE MANHOLE. POSITIVE DRAINAGE THROUGH MANHOLES SHALL BE MAINTAINED.

**BACKFILL NOTE:**

ALL SANITARY MAINS AND/OR LATERALS THAT CROSS THE PAVEMENT, LIE WITHIN TEN (10) FEET OF THE EDGE OF PAVEMENT OR WITHIN THE 1:1 SHEAR PLANE OF THE STREET MUST HAVE PROPER ROCK BACKFILL AND REQUIRED COMPACTION.

**LATERAL CONNECTIONS:**

A MANUFACTURED WYE SHALL BE USED FOR ALL LATERAL CONNECTIONS. NO SADDLE TAPS OR INSERTA TEES ALLOWED.

1"=10'  
1"=50'

**PROJECT TITLE**  
**HARVEST AT HOPEWELL**  
 O'FALLON PHASE 1B

**THE STERLING CO.**  
 ENGINEERS & SURVEYORS  
 5055 New Baumgartner Road  
 St. Louis, Missouri 63129  
 Ph 314-487-0440 Fax 314-487-8944  
 www.sterling-eng-survey.com  
 Corporate Certificate of Authority #001548

**DATE:** 05-20-2024  
**Michael G. Boering, PE**  
 License No. MO E-28643  
 Professional Engineer

**HARVEST HOPEWELL, LLC**  
 5091 New Baumgartner Road  
 St. Louis, Missouri 63129

**SANITARY PROFILES**

**P+Z No.** 21-004994  
**City No.** 21-011444  
**Date:** 05-20-2024  
**Job No.** 20-09-327  
**Page No.** 6.13

IMP

Approval Date: Dec. 16, 2021