

LANDSCAPE GUIDELINE SPECS:

GENERAL:

- All natural vegetation shall be maintained where it does not interfere with construction or the permanent plan of operation. Every effort possible shall be made to protect existing structures or vegetation from damage due to equipment usage. Contractor shall at all times protect all materials and work against injury to public.
- The landscape contractor shall be responsible for any coordination and sequencing with other site related work being performed by other contractors. Refer to additional drawings for further coordination of work to be done.
- Underground facilities, structures and utilities must be considered approximate only. There may be others not presently known or shown. It shall be the landscape contractor's responsibility to determine or verify the existence of and exact location of the above (Call 1-800-DIG-RITE in Missouri).
- Plant material are to be planted in the same relationship to grade as was grown in nursery conditions. All planting beds shall be cultivated to 6" depth minimum and graded smooth immediately before planting of plants. Plant groundcover to within 12" of trunk of trees or shrubs planted within the area.
- It shall be the landscape contractor's responsibility to:
 - Verify all existing and proposed features shown on the drawings prior to commencement of work.
 - Report all discrepancies found with regard to existing conditions or proposed design to the landscape architect immediately for a decision.
 - Stake the locations of all proposed plant material and obtain the approval of the owner's representative or landscape architect ten (10) days prior to installation.
- Items shown on this drawing take precedence over the material list. It shall be the landscape contractor's responsibility to verify all quantities and conditions prior to implementation of this plan. No substitutions of types or size of plant materials will be accepted without written approval from the landscape architect.
- Provide single-stem trees unless otherwise noted in plant schedule.
- All plant material shall comply with the recommendations and requirements of ANSI Z60.1 "American Standards for Nursery Stock".
- It shall be the contractor's responsibility to provide for inspection of the plant material by the Landscape Architect (or Owner's Representative) prior to acceptance. Inspections may take place before, during or after installation. Plants not conforming exactly to the plant list will not be accepted and shall be replaced at the landscape contractor's expense.
- All bids are to have unit prices listed. The Owner has the option to delete any portion of the contract prior to signing the contract or beginning work. This will be a unit price contract; quotes shall be valid for 12 months.
- Should auger equipment be utilized in excavating any plant pits, vertical sides of plant pits shall be thoroughly scarified to avoid creation of "polished side walls" prior to plant material installation.
- All excess topsoil, rocks, debris and/or tainted soils shall be removed by the general contractor prior to project is turned over to the landscape contractor to commence landscape installation.
- Transplanted material will not be guaranteed by the landscape contractor.
- Keep all plant material (except turf) a minimum of 36" clear of fire hydrants.
- Landscape contractor shall kill & remove all existing weeds within the project site.
- All tags, nursery stakes, labels, etc. shall be removed by the landscape contractor at completion of all landscape installation.
- Landscape contractor shall be in compliance with all federal, state and local laws / regulations relating to insect infestation and/or plant diseases.

PRUNING:

- Lightly prune trees at time of planting. Prune only the crossover limbs, intermingled leaders and/or any broken branches. Some interior twigs and lateral branches may be pruned. However, do not remove the terminal buds of branches that extend to the edge of the crown.
- All pruning shall comply with ANSI A300 standards.

INSURANCE:

- The landscape contractor shall submit certificates of insurance for workman's compensation and general liability.

MULCH:

- All mulch to be shredded oak bark mulch at 3" depth (after compaction) unless otherwise noted. Mulch shall be clean and free of all foreign materials, including weeds, mold, deleterious materials, etc.
- No plastic sheeting or filter fabric shall be placed beneath shredded bark mulch beds. Mirafil fabric shall be used beneath all gravel mulch beds.
- Edge all beds with spade-cut edge unless otherwise noted.

TOPSOIL:

- Topsoil mix for all proposed landscape plantings shall be five (5) parts well-drained screened organic topsoil to one (1) part Canadian sphagnum peat moss as per planting details. Roto-till topsoil mix to a depth of 6" minimum and grade smooth.
- Provide a soil analysis, as requested, made by an independent soil-testing agency outlining the % of organic matter, inorganic matter, deleterious material, pH and mineral content.
- Any foreign topsoil used shall be free of roots, stumps, weeds, brush, stones (larger than 1"), litter or any other extraneous or toxic material. Landscape contractor shall be fully responsible for correcting all negative soil issues prior to plant installation. Killing and removal of all weeds shall be the responsibility of the landscape contractor as part of this task.
- Landscape contractor to apply pre-emergent herbicide to all planting beds upon completion of planting operations and before application of shredded bark mulch.
- Install siltation controls prior to commencement of any grading operations. Inspect and maintain all siltation fences on a weekly basis until vegetation is established.

TURF:

- All disturbed lawn areas to be sodded with a high quality, freshly cut Turf-Type. Lawn areas shall be unconditionally warranted for a period of 90 days from date of final acceptance. Bare areas more than one square foot per any 50 square feet shall be replaced.
- The turf contractor shall be responsible for protection of finished grade; restore and repair any erosion or water damage and obtain owner's approval prior to seeding or sod installation.
- Sod shall be cut at a uniform thickness of 3/4" with no broken pieces or torn pieces will be accepted.
- All sod shall be placed a maximum of 24 hours after harvesting.
- Recondition existing lawn areas damaged by Contractor's operations including equipment/material storage and movement of vehicles.
- Sod Contractor to ensure sod is placed below sidewalk and all paved area elevations to allow for proper drainage.

MAINTENANCE:

- Landscape Contractor shall provide a separate proposal to maintain all plants, shrubs, groundcover, perennials and annuals for a period of 12 months after acceptance.
- Contractor shall ensure that only competent and trained personnel shall provide such services and that such services be provided in a timely manner.

SIGHT TRIANGLES:

- No landscape material or other obstructions shall be placed or be maintained within the sight distance area so as not to impede the vision between a height of thirty inches (30") and ten feet (10') above the adjacent street or paving surfaces.
- Sight triangles at the intersection of a public street and a private access way (except for single family residences) shall also be formed by measuring from the point of intersection of the street frontage curbs and the entrance curb lines a distance of 25' and connecting the points so established to form the sight triangle area.

WARRANTY:

- All plant material (excluding ground cover, perennials and annuals) are to be warranted for a period of 12 months after complete installation of all landscape material at 100% of the installed price.
- Any plant material found to be defective shall be removed and replaced within 30 days of notification or in growth season determined to be best for that plant.
- Only one replacement per tree or shrub shall be required at the end of the warranty period, unless loss is due to failure to comply with warranty.
- Lawn establishment period will be in effect once the lawn has been mowed three times. Plant establishment period shall commence on the date of acceptance and 100% completion.
- A written guarantee shall be provided to the owner per conditions outlined in #1 above.

IRRIGATION:

- All planting beds and lawn areas are to be irrigated with a fully automatic, in-ground irrigation system (By Others).

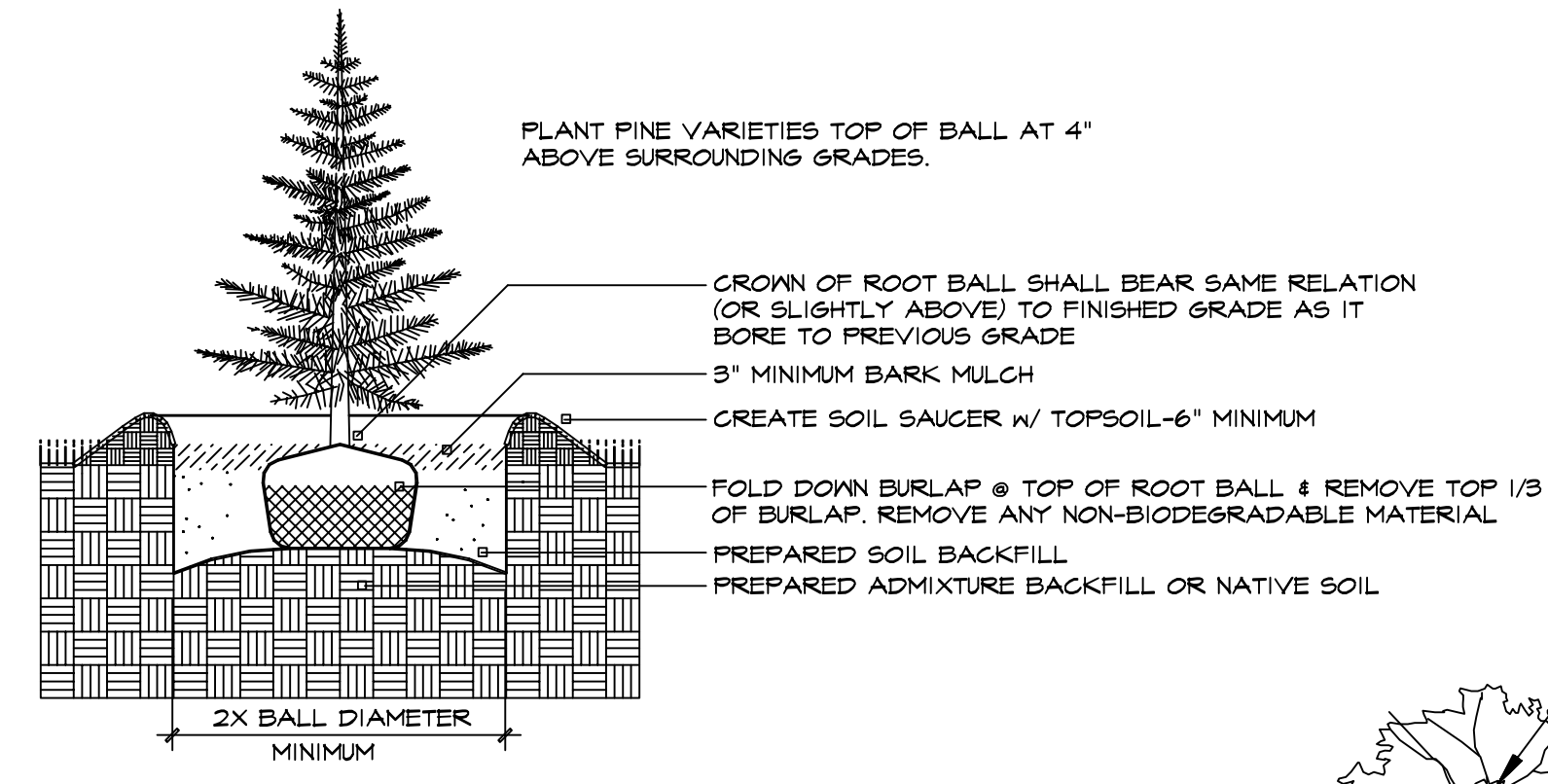

EVERGREEN TREE PLANTING

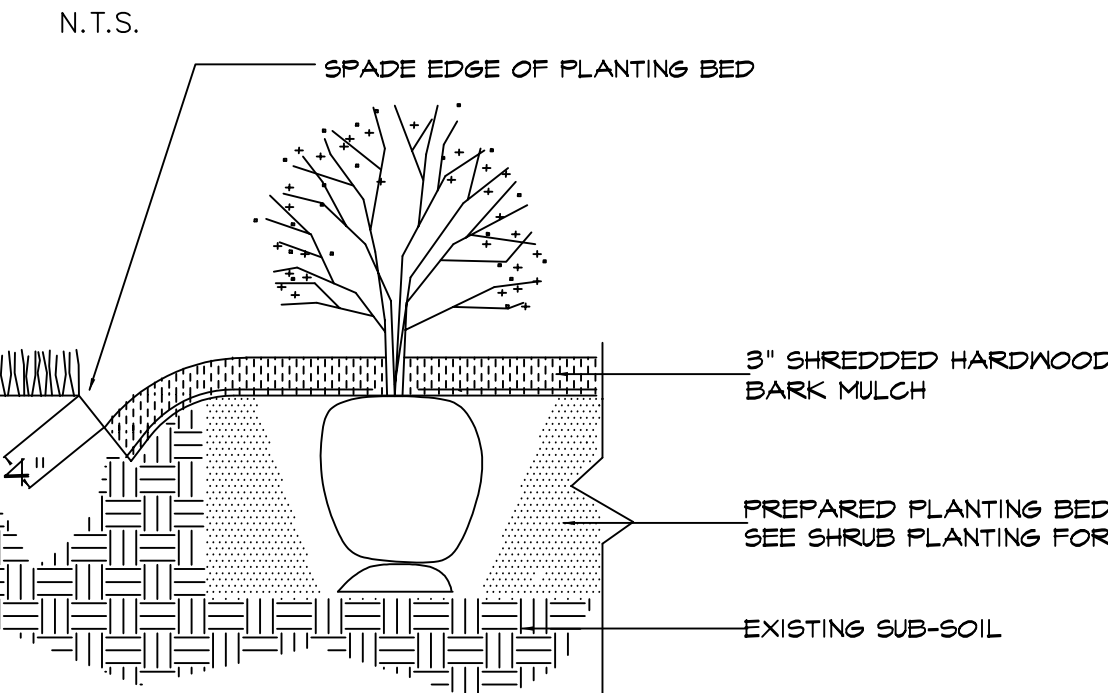

SPADE-CUT EDGE DETAIL



SHRUB PLANTING ON SLOPE

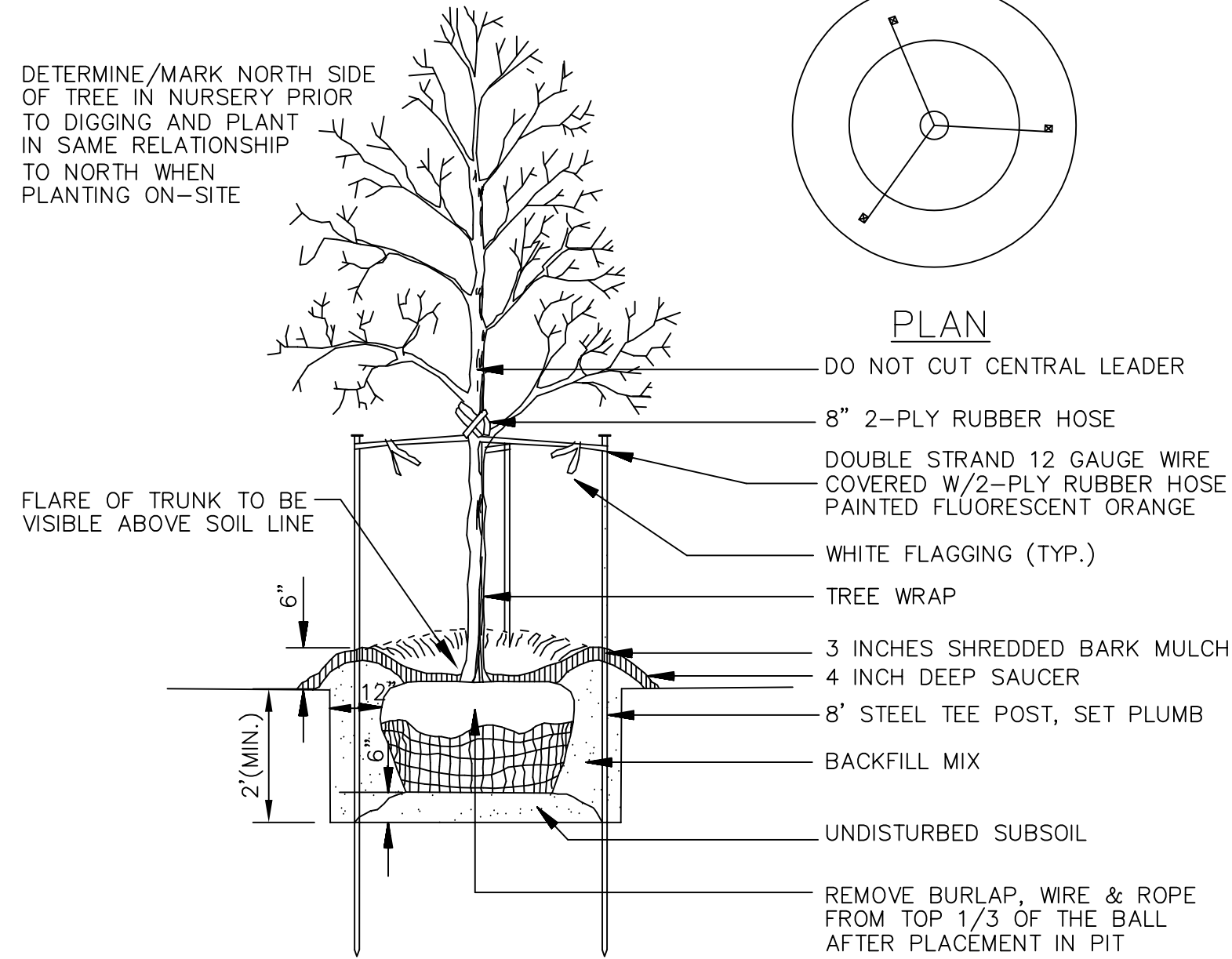

DECIDUOUS TREE PLANTING

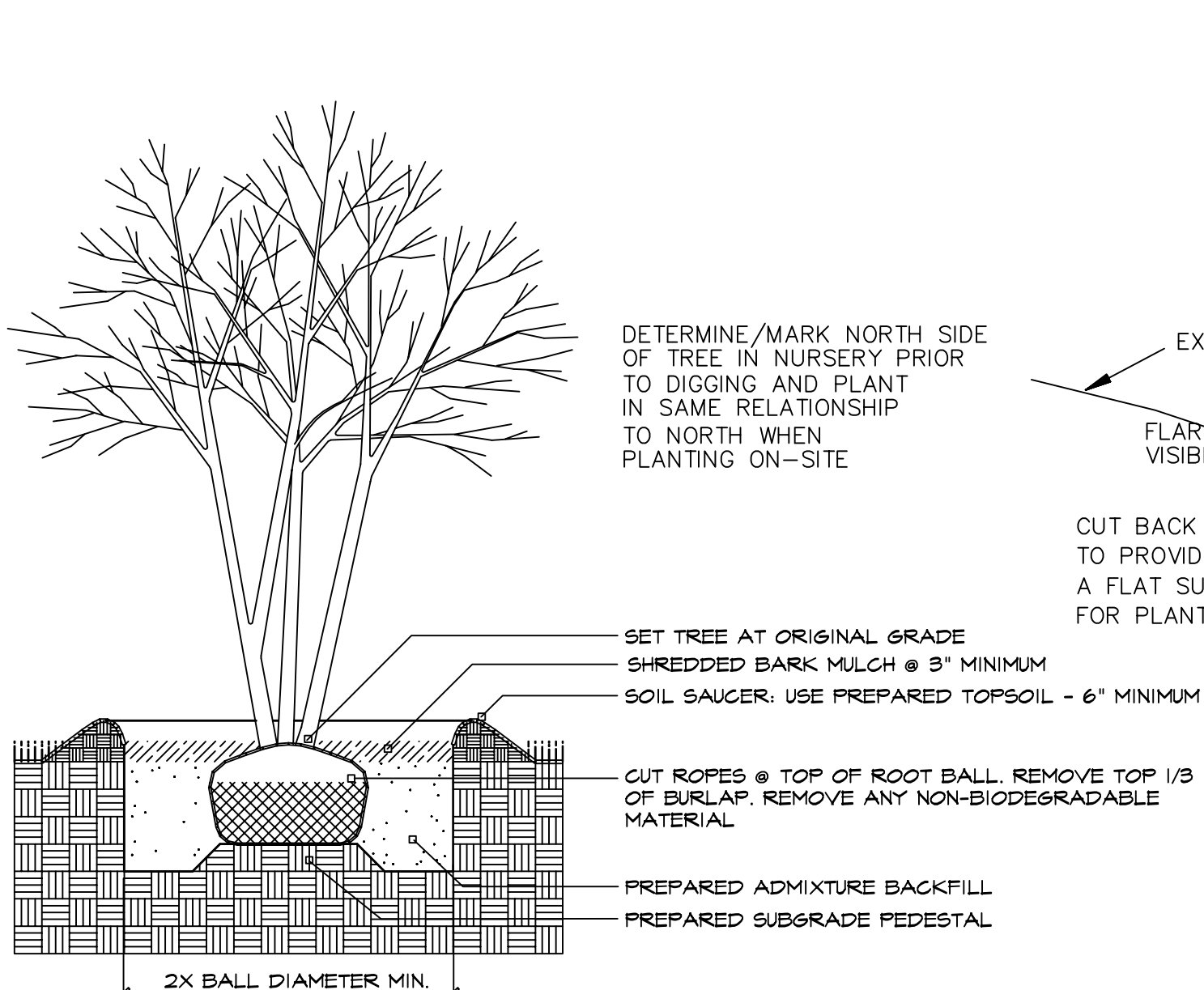

MULTI-STEM TREE PLANTING

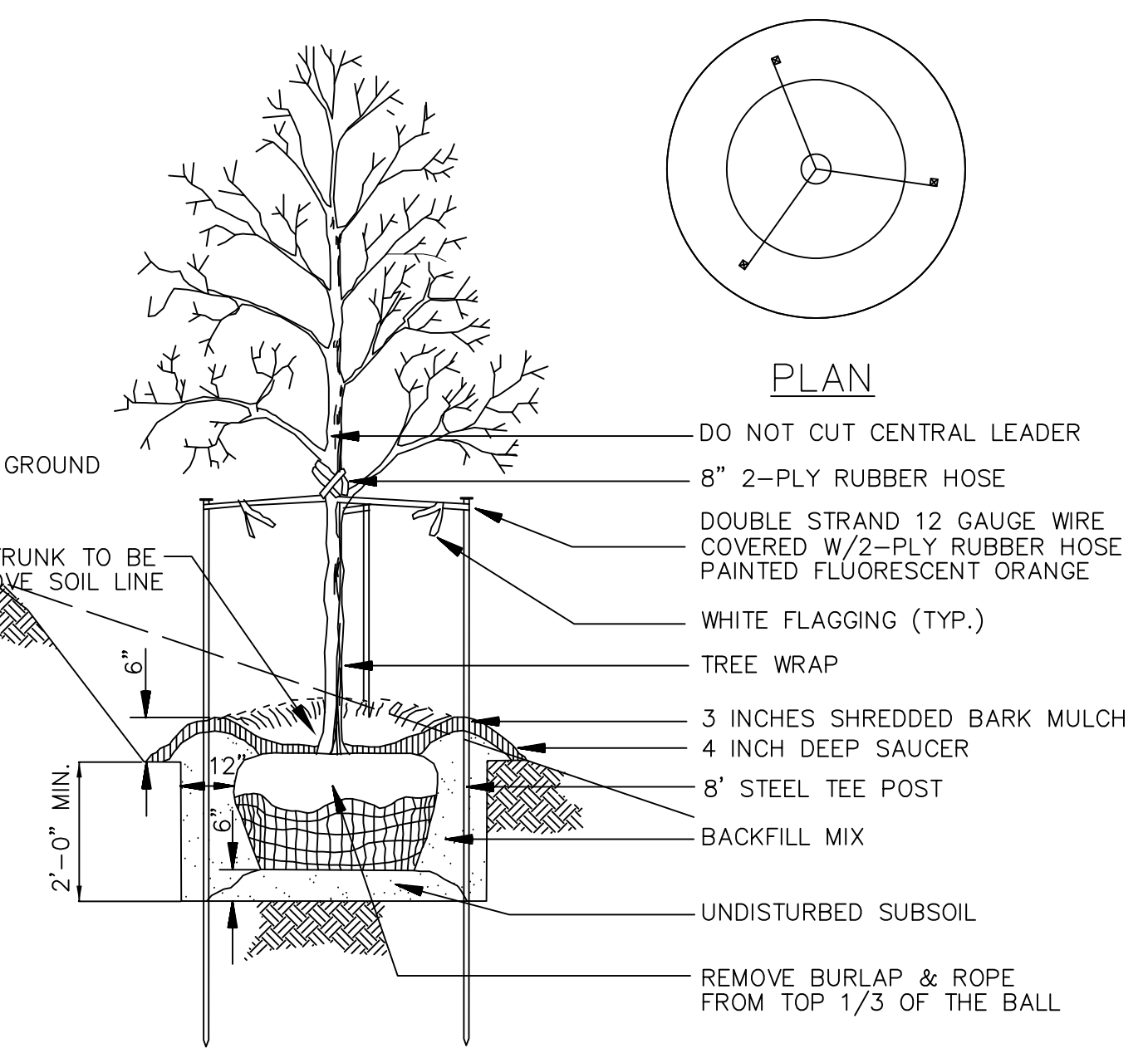

TREE PLANTING ON SLOPE

REVISIONS	BY

landscape
TECHNOLOGIES

87 Jacobs Creek Drive
St. Charles, Missouri 63044
Phone: (636) 422-1465
Fax: (636) 422-1465

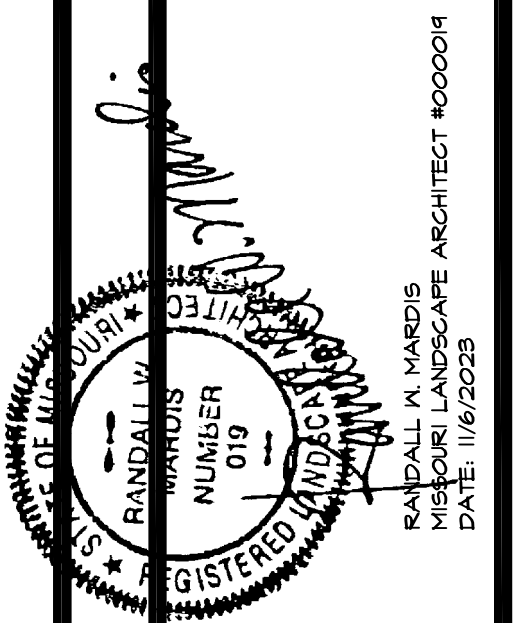

PLANTING PLAN FOR THE PROPOSED LOT 5:
Heartland Dental
O'FALLON, MISSOURI

DRAWN	R. HARDS
CHECKED	R.M.G.B.
DATE	4/30/2023
SCALE	N.A.
JOB No.	2023-170
SHEET	